

# AS BUILT PLANS

Contractor: Curtis Ledbetter  
 Inspector: Don Eddingfield, Baughman Co.  
 pdf's by: KEK, 2/16/11

Release Date: 2/22/2011  
 T. Mason - City of Wichita, Inspector  
 : APROsas 2/24/2011

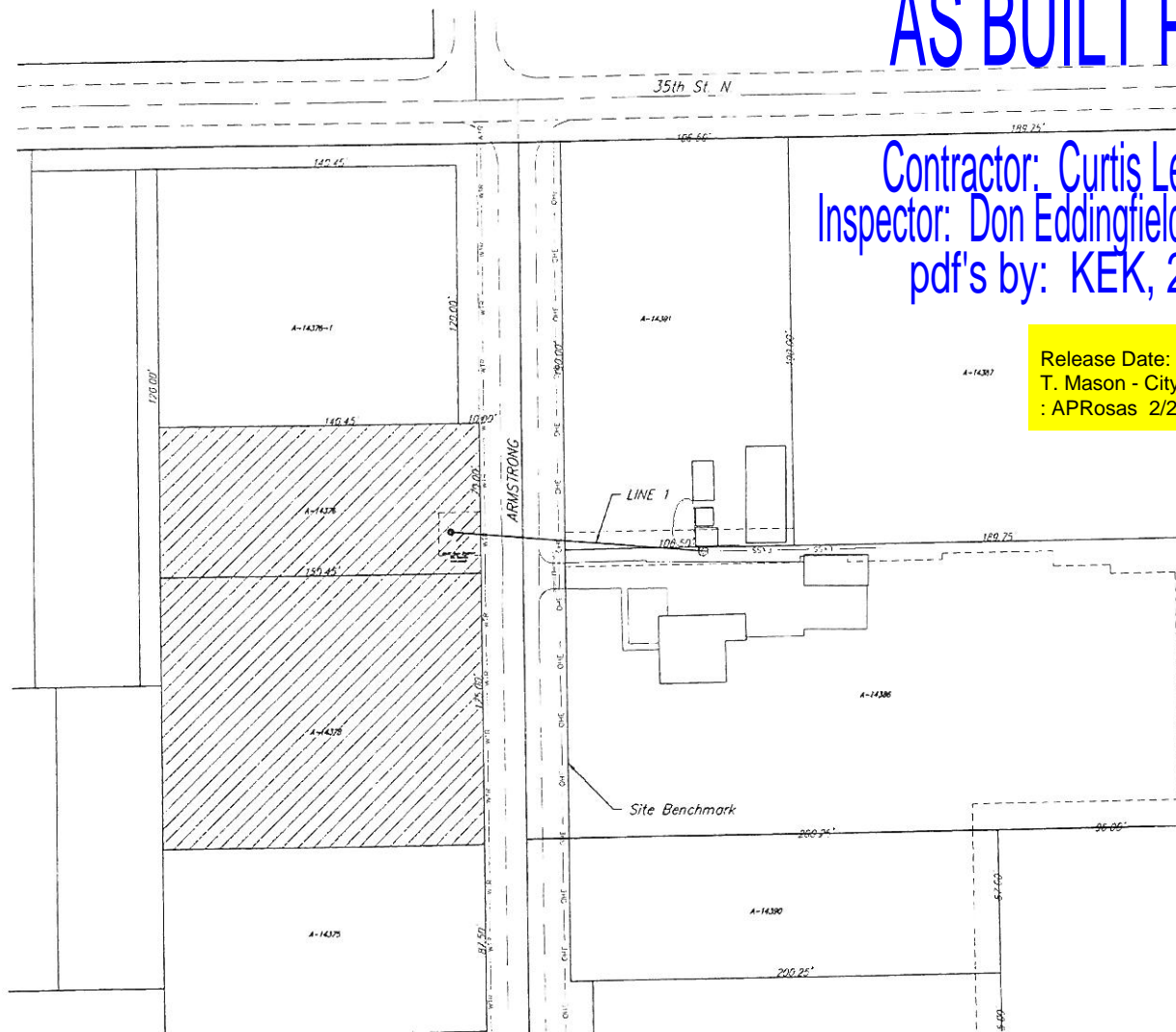

## SANITARY SEWER IMPROVEMENTS to serve Part of Lot 16 & 17, **WALNUT GROVE ADDITION**

Private Project Number: 2083 PPS (607861)

CITY OF WICHITA, KANSAS

James L. Armour, P.E. City Engineer

### Sheet Index

Title Sheet	1
Line 1/ Erosion Control Plan	2
Cleanout Riser Detail	3
Erosion Control Details	4-7
Coordinate Sheet	8
Copy of Plat	9

### GENERAL NOTES:

- Contractor will be required to provide notice to utility companies a minimum of forty-eight (48) hours prior to any excavation, as follows:  
 Kansas One-Call 687-2470  
 The Contractor must notify the following in case of an emergency:  
 Cox Communications 262-4270  
 Kansas Gas Service 1-888-482-4950  
 Westar Energy 383-8650  
 Aquila Energy 1-800-303-0357  
 SBC 268-2245  
 City of Wichita Water Dept 268-4563  
 City of Wichita Sewer Maint. 268-4024  
 City of Wichita Storm Sewer Maint 268-4090  
 City of Wichita Traffic Maint 268-4034  
 Conoco Phillips Pipeline 1-877-267-2290  
 Southern Star Pipeline 529-6600  
 Kinder Morgan Pipeline 1-888-844-5658  
 Enbridge Pipeline 1-800-323-6241
- Utility service lines, poles, valve boxes, meters, and etcetera are to be adjusted as necessary by others prior to construction unless the plans specifically call for their adjustment by the Contractor or unless the plans specifically identify a utility to be adjusted by its owner during construction. Existing utilities and their location, as shown on the plans, represent the best information obtainable for design. The Contractor will be required to work around existing utilities within the right-of-way which do not conflict with proposed construction.
- Rubble from the removal of miscellaneous structures and excess excavation which is to be wasted shall be disposed of on sites to be provided by the Contractor. These sites shall be approved by the Engineer as to suitability, appearance and site location. Locations, in the opinion of the Engineer, that will leave an unsightly appearance will not be approved. All disposal sites must be approved by the Kansas Department of Health and Environment. Material either stockpiled or disposed of in a flood plain would require a Kansas State Board of Agriculture permit. Any material dumped in waters of the United States or wetlands is subject to U.S. Corps of Engineers permitting regulations. Any material buried or stockpiled beyond approved construction limits would require additional archaeological investigations unless buried in a previously approved borrow location.
- Trees and shrubs in public right-of-way which are in direct conflict with proposed new construction shall be removed by the Contractor with the Engineer's approval. Trees and shrubs which are not in direct conflict with proposed new construction shall be saved and protected from damage.
- The Contractor shall give all property owners and/or tenants of developed property abutting the construction of this project a minimum of five (5) days notice prior to start of construction.
- The Contractor shall be responsible for preserving property irons. The Contractor will be required to re-establish any property irons which are damaged or destroyed by his construction operations. Such irons shall be re-established by a licensed land surveyor in accordance with state laws.
- All existing and proposed erosion control measures including silt fencing, erosion control mat, straw bales, inlet barriers, and const. entrance shall be maintained throughout construction by the contractor and until project is accepted by the City of Wichita. The on-site engineer shall complete weekly reports on the status of erosion control measures. The contractor shall be required to comply with maintenance and/or replacement of erosion control measures as determined by the on-site engineer until project is accepted by City of Wichita.
- The Contractor shall be responsible for maintaining continuous flow of sewage through construction. Contractor's proposed method for maintaining sewage flow shall be approved by the Engineer. Cost of maintaining flow of sewage through construction will not be paid for directly and this cost shall be considered as subsidiary to the other pay items of work.
- All areas disturbed during construction shall be seeded or sodded with like grass type immediately following construction in that area. Contractor shall prepare ground per City Specifications.

### Benchmarks

Step (60") in Light Pole East side of Armstrong Ave., 35'± North of South Line of Property A-14386. Elevation = 1321.00NAVD 88

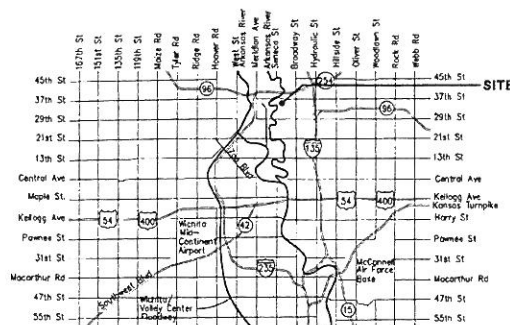

Vicinity Map

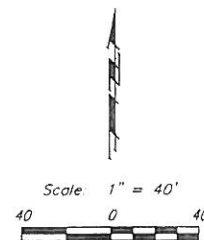

APPROVED AS NOTED  
 BY CITY ENGINEER OF WICHITA

Sanitary Sewers: *Johanna K. Kistner* 11-17-10

NOTE TO CONTRACTORS

Installation, inspection and testing for this project is to be provided by a Licensed Consulting Engineering Firm under contract with the Owner/Developer. Said inspection to be in accordance with the City of Wichita standard construction engineering practices and certified by a Licensed Professional Engineer. No work shall be performed in dedicated easements or public right-of-way by the Contractor without such inspection nor shall any work be commenced without written authorization by the City Engineer. All Construction and Materials shall comply with the City of Wichita Specifications and Standards (on file and available in the City Engineer's Office)



Baughman Company, P.A. 315 E. 4th St. Wichita, KS 67211 P 316-262-7271 F 316-262-1144  
 ENGINEERING | SURVEYING | PLANNING | LANDSCAPE ARCHITECTURE