

STATE	PROJECT NO.	YEAR	SHEET NO.	TOTAL SHEETS
KANSAS	87 N-0361-01	2011	20	169

MKEC
ENGINEERING
CONSULTANTS, INC.
411 N. WEBB ROAD
WICHITA, K.S. 67206
316-684-9600

**LINCOLN STREET BRIDGE AND
DAM IMPROVEMENTS OVER
ARKANSAS RIVER**

**PORTAGE AND
SIDEWALK
PAVING AND
GRADING PLAN**
SHEET TITLE
472-84883
PROJECT NUMBER

JRA
DESIGN BY
DPG
DRAWN BY
KJS
CHECKED BY

ISSUED
1/24/2011
REVISED

SHEET NO.
20 of 169

POINT NO.	STATION/OFFSET	NORTHING	EASTING	ELEVATION	REMARKS
DAM STATION					
41	51+61.91 / 458.42' Rt.	1679913.4249	1647219.9664	1286.06	Face of Walk
42	51+63.52 / 445.23' Rt.	1679926.1125	1647223.9281	1286.06	Face of Walk
43	51+72.94 / 367.85' Rt.	1680000.5208	1647247.1622	1288.00	Face of Walk
44	51+64.70 / 352.81' Rt.	1680016.7959	1647241.7679	1288.30	End of Wall
45	51+60.29 / 341.65' Rt.	1680028.5688	1647239.4440	1288.30	Expansion Joint
46	51+66.45 / 338.40' Rt.	1680030.6558	1647246.0957	1288.30	End of Wall
47	51+60.29 / 329.29' Rt.	1680040.7302	1647241.6789	1287.20	Back of Walk
48	51+75.26 / 348.84' Rt.	1680018.8003	1647252.8700	1288.50	Face of Walk PT
49	51+75.50 / 346.84' Rt.	1680020.7255	1647253.4711	1288.50	End of Wall
50	51+77.30 / 332.06' Rt.	1680034.9395	1647257.9095	1288.50	End of Wall
51	51+84.07 / 342.06' Rt.	1680023.8749	1647262.7618	1288.50	Expansion Joint
52	51+78.99 / 331.19' Rt.	1680035.4846	1647259.7263	1288.50	Expansion Joint
53	51+69.37 / 314.43' Rt.	1680053.7037	1647253.2924	1287.64	Back of Walk
54	51+79.30 / 315.64' Rt.	1680050.7232	1647262.8379	1288.18	Face of Walk PC
55	51+68.99 / 307.19' Rt.	1680060.8999	1647254.2260	1287.73	Back of Walk
56	51+78.74 / 304.94' Rt.	1680061.3461	1647264.2161	1287.92	Face of Walk PT
57	51+60.16 / 294.41' Rt.	1680075.0605	1647247.8436	1286.59	Back of Walk
58	51+65.70 / 286.08' Rt.	1680082.2498	1647254.7945	1286.62	Back of Walk PC, PT
59	51+60.73 / 264.13' Rt.	1680104.7393	1647253.8662	1285.23	Face of Walk PT
60	51+53.31 / 256.00' Rt.	1680114.0709	1647248.0419	1285.00	Back of Walk PT
61	51+44.14 / 279.26' Rt.	1680092.8513	1647234.8196	1285.23	Face of Walk PC
62	51+36.73 / 271.13' Rt.	1680102.1829	1647228.9953	1285.00	Back of Walk PC
63	51+41.67 / 281.66' Rt.	1680090.9363	1647231.9623	1285.23	Face of Walk PC, PT
64	51+43.88 / 291.41' Rt.	1680080.9449	1647232.3767	1285.43	Back of Walk
65	51+79.86 / 318.42' Rt.	1680047.8904	1647262.8822	-	Radius Point
66	51+17.20 / 305.37' Rt.	1680072.0356	1647203.6116	1285.00	Back of Walk PRC
67	51+27.97 / 307.61' Rt.	1680067.8856	1647213.7987	1285.23	Face of Walk
68	51+30.12 / 338.07' Rt.	1680037.5404	1647210.4165	1286.33	Back of Walk
69	51+36.45 / 329.07' Rt.	1680045.2481	1647218.2645	1286.55	Face of Walk
70	51+38.81 / 342.38' Rt.	1680031.7268	1647218.1898	1286.84	Back of Walk
71	51+48.53 / 311.89' Rt.	1680059.9630	1647233.2469	-	Radius Point
72	51+80.22 / 349.44' Rt.	1680017.3100	1647257.6427	-	Radius Point
73	51+78.41 / 345.11' Rt.	1680013.0502	1647255.0247	1288.50	Face of Walk PRC
74	51+77.91 / 368.45' Rt.	1679999.0305	1647251.9349	-	Radius Point
75	51+80.76 / 364.35' Rt.	1680002.5542	1647255.4822	1288.33	Back of Walk PRC
76	51+66.49 / 384.88' Rt.	1679984.9354	1647237.7458	-	Radius Point
77	51+89.50 / 375.09' Rt.	1679990.4106	1647262.1389	1289.15	Back of Walk PRC
78	51+96.86 / 371.96' Rt.	1679992.1626	1647269.9447	1289.73	Face of Walk PRC
79	51+20.48 / 404.45' Rt.	1679973.9851	1647188.9597	-	Radius Point
80	51+95.32 / 409.44' Rt.	1679955.5763	1647261.6654	1291.20	Back of Walk PC
81	52+03.30 / 409.97' Rt.	1679953.6127	1647269.4206	1291.54	Face of Walk PC
82	51+94.50 / 421.72' Rt.	1679943.6408	1647258.6433	1291.92	Back of Walk PT
83	52+02.48 / 422.25' Rt.	1679941.6772	1647266.3986	1292.10	Face of Walk PT
84	52+42.39 / 424.91' Rt.	1679931.8592	1647305.1750	-	Radius Point
85	51+94.87 / 431.68' Rt.	1679933.7782	1647257.2134	1292.36	Back of Walk
86	52+02.79 / 430.55' Rt.	1679933.4583	1647265.2070	1292.46	Face of Walk PRC
87	51+98.26 / 443.79' Rt.	1679921.2612	1647258.3596	1292.89	Back of Walk
88	52+05.62 / 440.64' Rt.	1679923.0275	1647266.1621	1292.91	Face of Walk PC, PT
89	52+02.65 / 451.82' Rt.	1679912.5647	1647261.2236	1293.63	Back of Walk PRC
90	52+09.27 / 447.37' Rt.	1679915.7804	1647268.5488	1293.68	Face of Walk PRC
91	52+21.69 / 438.93' Rt.	1679921.8100	1647282.2836	-	Radius Point
92	52+25.47 / 461.62' Rt.	1679898.8131	1647281.9021	1296.15	Back of Walk PC
93	52+24.15 / 453.73' Rt.	1679906.8120	1647282.0348	1295.76	Face of Walk PC
94	52+38.87 / 459.39' Rt.	1679898.5878	1647295.4873	1297.45	Match Exist.
95	52+37.56 / 451.50' Rt.	1679906.5867	1647295.6200	1297.42	Match Exist.
96	52+15.90 / 437.23' Rt.	1679924.5260	1647276.8920	1293.22	Face of Walk PT
97	52+11.45 / 433.20' Rt.	1679929.2891	1647273.2435	1292.99	Back of Walk PT
98	52+07.74 / 429.85' Rt.	1679933.2584	1647270.2030	-	Radius Point
99	52+14.79 / 419.14' Rt.	1679942.5150	1647279.0640	1293.70	Back of Walk PRC
100	52+20.57 / 417.55' Rt.	1679943.0421	1647285.0408	1294.11	Face of Walk PRC
101	52+00.33 / 423.14' Rt.	1679941.1970	1647264.1220	-	Radius Point
102	52+91.90 / 397.85' Rt.	1679949.5438	1647358.7546	-	Radius Point
103	52+12.08 / 392.51' Rt.	1679969.2039	1647281.2079	1294.96	Back of Walk PT
104	52+18.07 / 392.91' Rt.	1679967.7294	1647287.0239	1295.15	Face of Walk PT
105	52+13.98 / 364.10' Rt.	1679996.8040	1647288.2053	1296.29	Back of Walk
106	52+20.07 / 362.90' Rt.	1679996.8510	1647294.4070	1296.41	Face of Walk
107	52+12.83 / 358.23' Rt.	1680002.7807	1647288.1294	1296.24	Back of Walk
108	52+18.91 / 357.01' Rt.	1680002.8823	1647294.3304	1296.36	Face of Walk
109	52+09.18 / 333.64' Rt.	1680027.6277	1647288.9748	1296.50	End of Wall
110	52+06.89 / 321.86' Rt.	1680039.6271	1647288.8527	1296.50	End of Wall
111	52+14.12 / 332.68' Rt.	1680027.6790	1647294.0151	1296.30	Back of Walk
112	52+11.81 / 320.91' Rt.	1680039.6781	1647293.8627	1296.30	Back of Walk

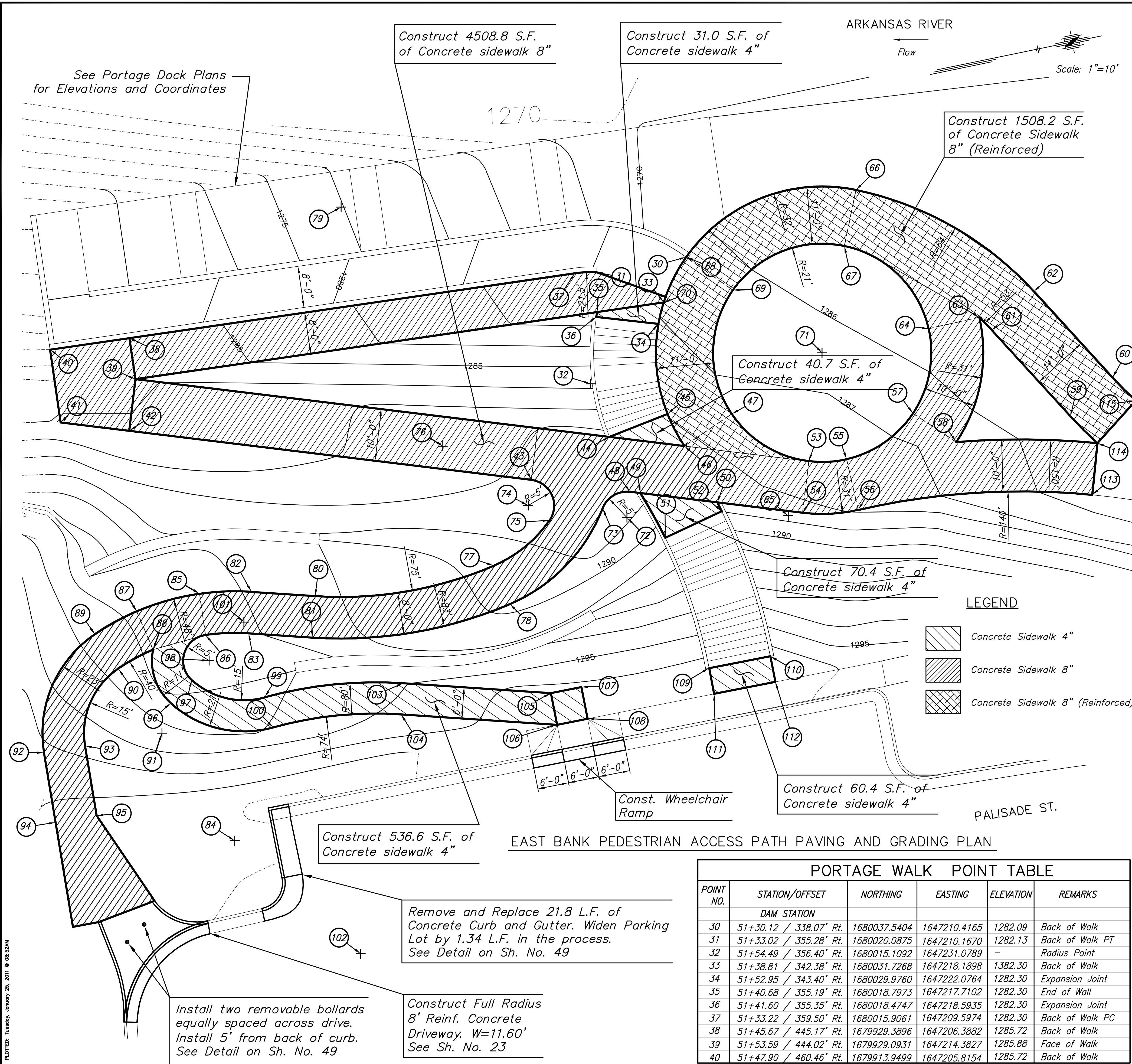

POINT NO.	STATION/OFFSET	NORTHING	EASTING	ELEVATION	REMARKS
DAM STATION					
30	51+30.12 / 338.07' Rt.	1680037.5404	1647210.4165	1282.09	Back of Walk
31	51+33.02 / 355.28' Rt.	1680020.0875	1647210.1670	1282.13	Back of Walk PT
32	51+54.49 / 356.40' Rt.	1680015.1092	1647231.0789	-	Radius Point
33	51+38.81 / 342.38' Rt.	1680031.7268	1647218.1898	1382.30	Back of Walk
34	51+52.95 / 343.40' Rt.	1680029.9760	1647222.0764	1282.30	Expansion Joint
35	51+40.68 / 355.19' Rt.	1680018.7973	1647217.7102	1282.30	End of Wall
36	51+41.60 / 355.35' Rt.	1680018.4747	1647218.5935	1282.30	Expansion Joint
37	51+33.22 / 359.50' Rt.	1680015.9061	1647209.5974	1282.30	Back of Walk PC
38	51+45.67 / 445.17' Rt.	1679929.3896	1647206.3882	1285.72	Back of Walk
39	51+53.59 / 444.02' Rt.	1679929.0931	1647214.3827	1285.88	Face of Walk
40	51+47.90 / 460.46' Rt.	1679913.9499	1647205.8154	1285.72	Back of Walk

PLOTTED: Tuesday, January 25, 2011 8:52AM