

STATE	PROJECT NO.	YEAR	SHEET NO.	TOTAL SHEETS
KANSAS	87 N-0361-01	2011	86	169

MKEC
ENGINEERING
CONSULTANTS, INC.
411 N. WEBB ROAD
WICHITA, K.S. 67206
316-684-9600

* See Sheet No. 102 for location of reinforcing in pier diaphragm.

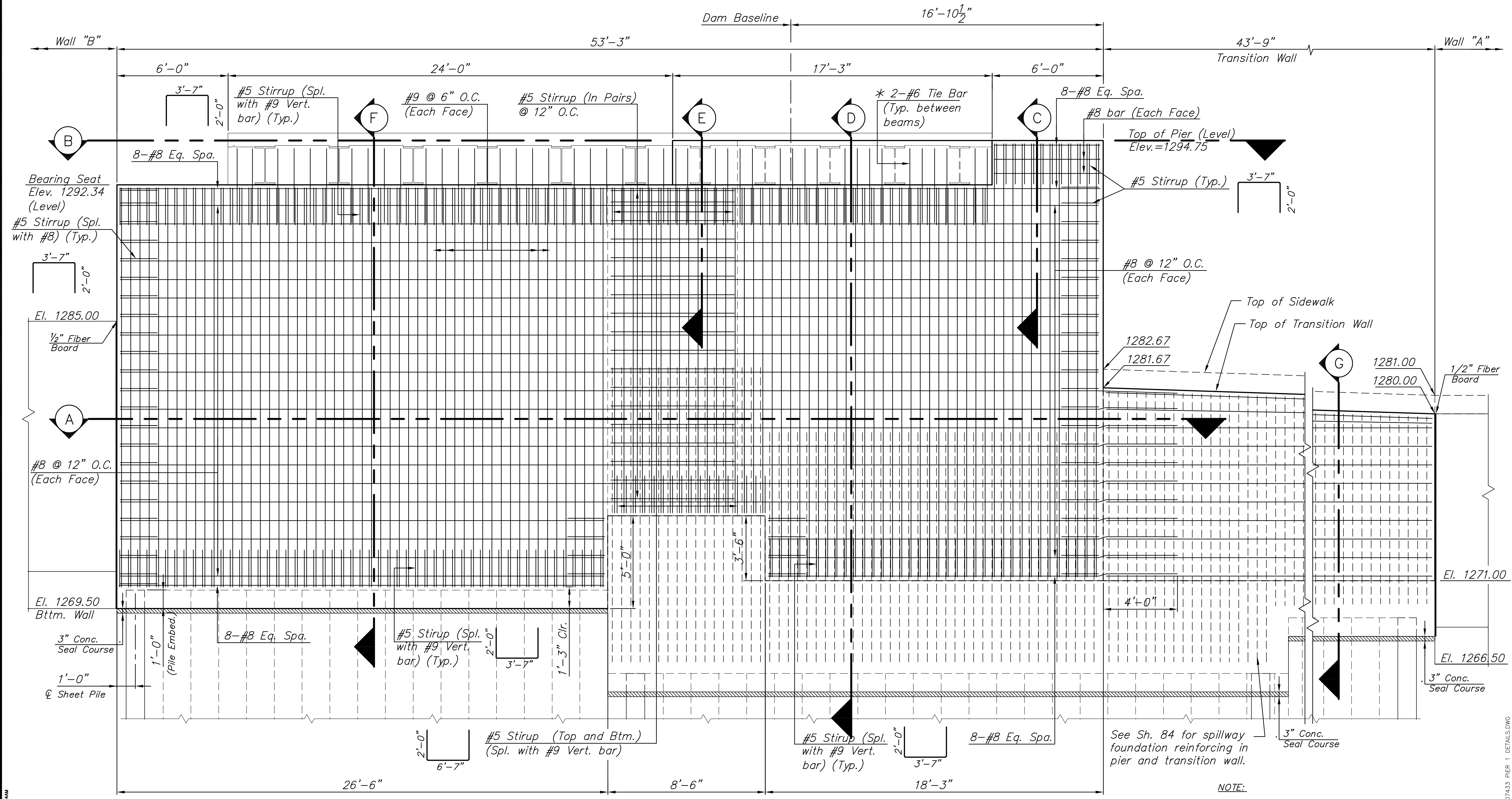

ELEVATION - PIER NO. 1 & TRANSITION WALL
(Elevation Shown Looking East)

See Sh. 84 for spillway foundation reinforcing in pier and transition wall.

NOTE:

See Sheet No. 36-38 for details of Retaining Walls "A" and "B".

See Sheet No. 85 for reinforcing in spillway foundation.

Refer to Sheet No. 94-102 for Maintenance Structure details.

**LINCOLN STREET BRIDGE AND
DAM IMPROVEMENTS OVER
ARKANSAS RIVER**

**PIER #1
REINFORCING
DETAILS**
SHEET TITLE
472-84883
PROJECT NUMBER

DESIGN BY: JAG
DRAWN BY: DMU
CHECKED BY: KJS

ISSUED: 1/24/2011
REVISED:

SHEET NO.
86 of 169

PLOT: Tuesday, January 25, 2011 8:44 AM

J:\CIVIL\07433\DWG\DA\PLANS\07433_PIER 1 DETAILS.DWG