

| | | | | |
|--------|--------------|------|-----------|--------------|
| STATE | PROJECT NO. | YEAR | SHEET NO. | TOTAL SHEETS |
| KANSAS | 87 N-0361-01 | 2011 | 136 | 169 |

MKEC
ENGINEERING
CONSULTANTS, INC.
411 N. WEBB ROAD
WICHITA, KS. 67206
316-684-9600

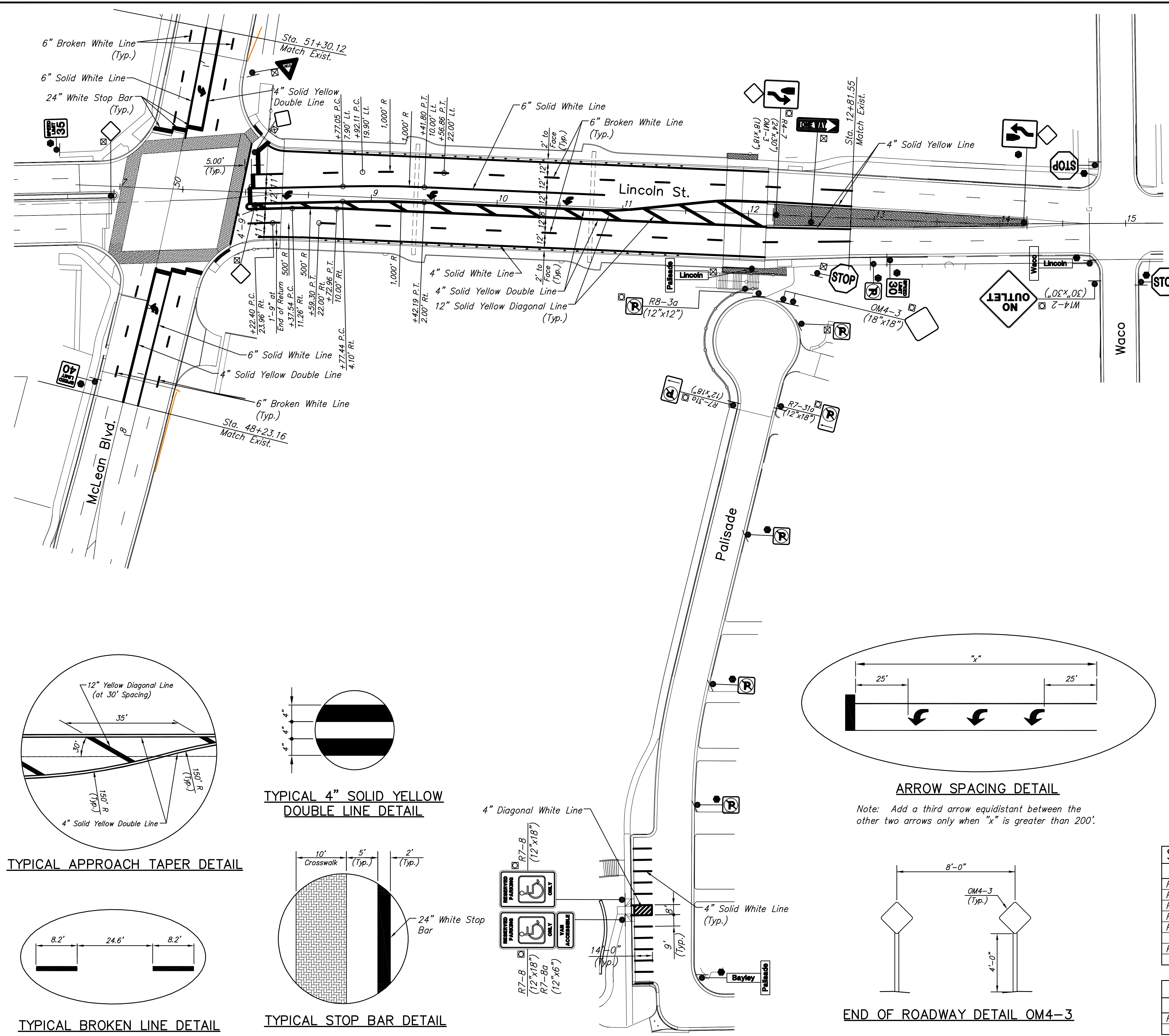

Scale: 1"=30'

NOTE:
Existing Pavement Marking removed for Temporary Traffic Control purposes beyond the limits of construction shall be replaced, in-kind on McLean and Lincoln. Quantities for this are not reflected in the Summary of Quantities. 4,935 L.F. of 4" Yellow, 900 L.F. of 6" White and 135 L.F. of 12" Yellow is anticipated.

Pavement Markings - All pavement markings shall be epoxy, unless otherwise approved by the Engineer. Pavement markings shall be installed per manufacturer's recommendations and shall meet KDOT's 2007 Edition of the Standard Specification Section 806. Full traffic may not be restored (and substantial project completion achieved) until all pavement markings are in place. Should construction timing be such that restoration of traffic becomes necessary during temperatures prohibiting the installation of thermoplastic markings, the contractor shall install and maintain temporary markings until such time that thermoplastic markings may be properly installed. Except for the material requirement, temporary pavement markings shall be placed equivalent, in every manner (i.e. dimension, frequency, spacing, etc.), to the permanent marking layout. The cost for temporary pavement markings will not be paid for directly, but shall be considered Subsidiary to the bid item for "Pavement Markings".

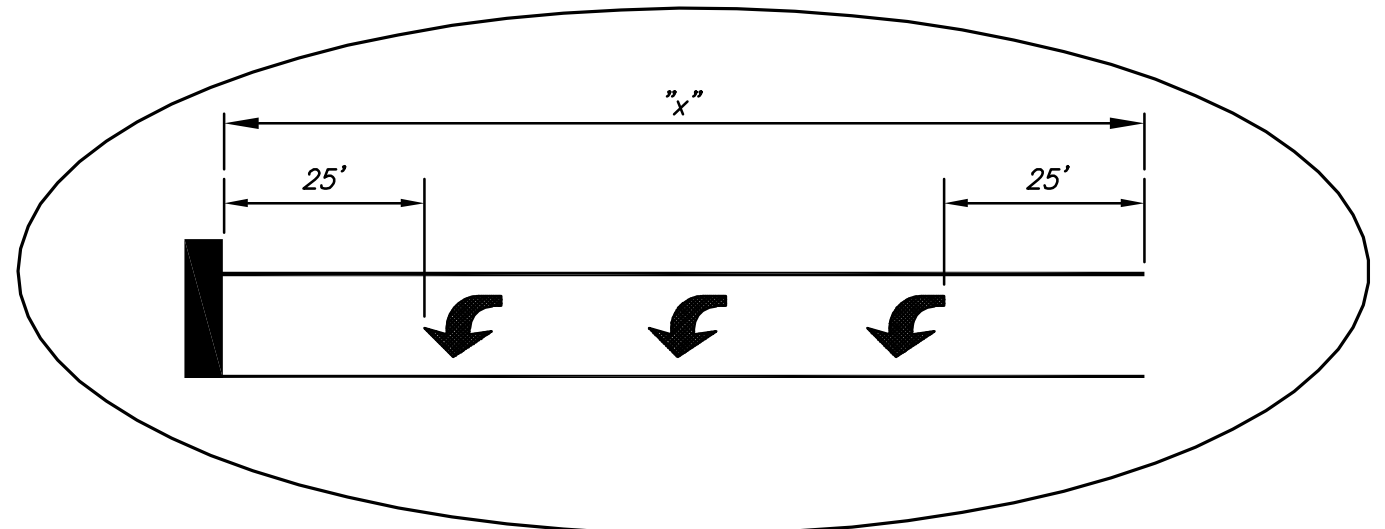

ARROW SPACING DETAIL
Note: Add a third arrow equidistant between the other two arrows only when "x" is greater than 200'.

LEGEND

- Not in project
- ☒ Remove and return to City
- ☑ New sign on new post

SUMMARY OF QUANTITIES (FOR INFORMATION ONLY)

| ITEMS | QUANTITY | UNIT |
|-------------------------------------|----------|------|
| Pavement Marking (White)(4") | 1,035 | L.F. |
| Pavement Marking (White)(6") | 760 | L.F. |
| Pavement Marking (White)(24") | 127 | L.F. |
| Pavement Marking (Yellow)(4") | 2,180 | L.F. |
| Pavement Marking (Yellow)(12") | 210 | L.F. |
| Pavement Marking Symbol (Left Turn) | 5 | Each |

RECAPITULATION OF QUANTITIES

| BID ITEM | QUANTITY | UNIT |
|------------------|----------|------|
| Pavement Marking | Lump Sum | L.S. |

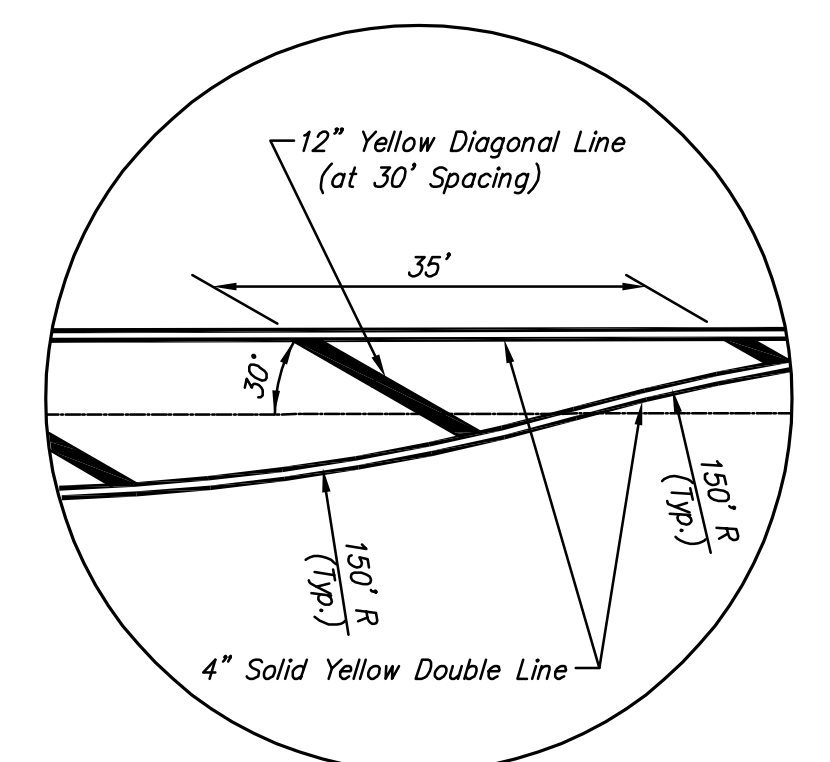

TYPICAL APPROACH TAPER DETAIL

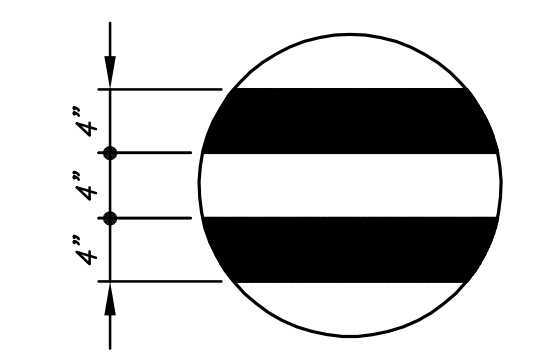

TYPICAL 4" SOLID YELLOW DOUBLE LINE DETAIL

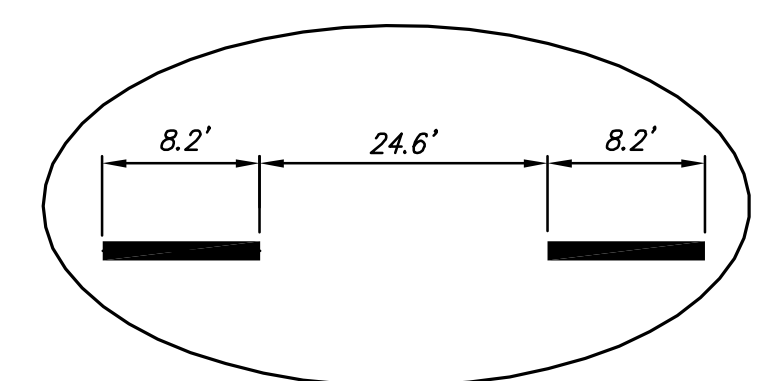

TYPICAL BROKEN LINE DETAIL

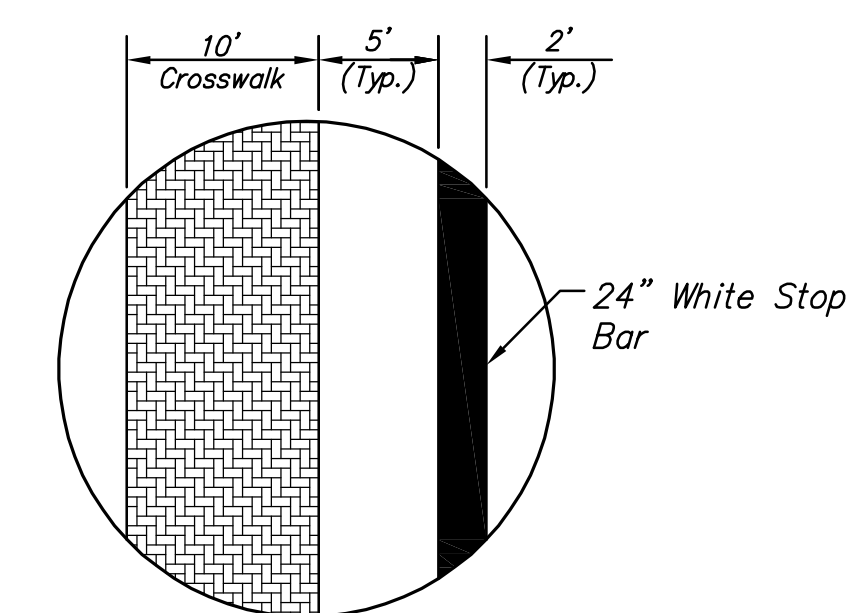

TYPICAL STOP BAR DETAIL

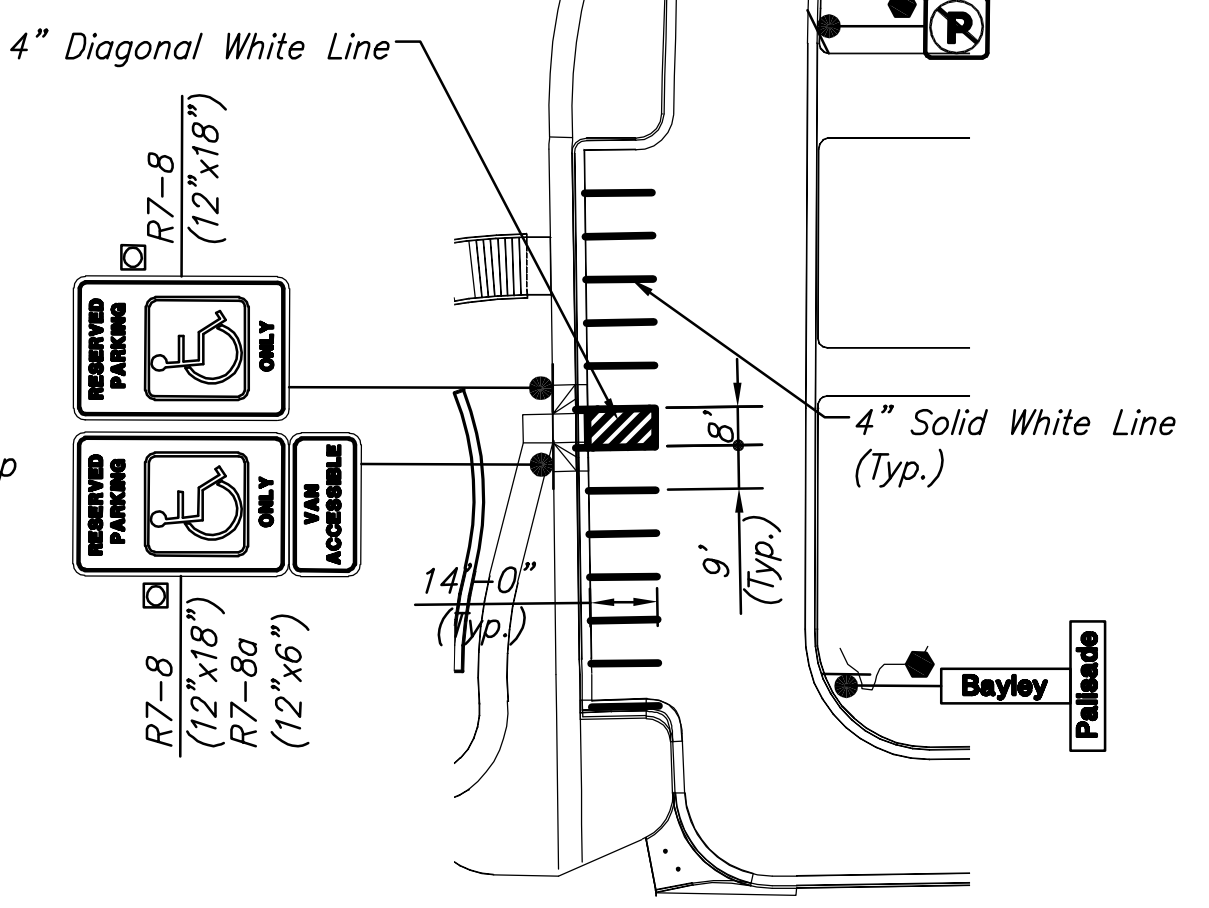

END OF ROADWAY DETAIL OM4-3

PLOTED: Tuesday, January 25, 2011 8:58 AM

**LINCOLN STREET BRIDGE AND
DAM IMPROVEMENTS OVER
ARKANSAS RIVER**

PAVEMENT MARKING & SIGNING PLAN

SHEET TITLE
472-84883
PROJECT NUMBER

JRA
DESIGN BY
WJN
DRAWN BY
KJS
CHECKED BY

ISSUED
1/24/2011
REVISED

SHEET NO.
136 of 169