

STATE	PROJECT NO.	YEAR	SHEET NO.	TOTAL SHEETS
KANSAS	472 84614	.	108	534

Sta. 0+54.62 Line D2=
Sta. 722+78.89 60.80' Rt.
Const. Conc. Grate Inlet

Sta. 0+54.62 Line D6=
Sta. 724+78.97 60.80' Rt.
Const. Conc. Grate Inlet

Sta. 0+54.62 Line D10=
Sta. 726+79.91 60.80' Rt.
Const. Conc. Grate Inlet

Sta. 0+54.62 Line E24=
Sta. 734+96.93 60.80' Rt.
Const. Conc. Grate Inlet

Sta. 0+54.62 Line E22=
Sta. 735+94.91 60.80' Rt.
Const. Conc. Grate Inlet

Sta. 12+72.21 Line D=
Sta. 0+00 Lines D2 & D3=
Sta. 722+78.88 6.18' Rt.
Const. Type P (Std.) Manhole
Install 18" x 66.98' RCP (N)
Install 30" x 99.99' RCP (E)
Install 18" x 54.62' RCP (S)

Sta. 14+72.28 Line D=
Sta. 0+00 Lines D6 & D7=
Sta. 724+78.97 6.18' Rt.
Const. Type P (Std.) Manhole
Install 18" x 66.98' RCP (N)
Install 30" x 99.99' RCP (E)
Install 18" x 54.62' RCP (S)

Sta. 16+73.23 Line D=
Sta. 0+00 Lines D10 & D11=
Sta. 726+79.91 6.18' Rt.
Const. Type P (Std.) Manhole
Install 18" x 66.98' RCP (N)
Install 18" x 54.62' RCP (S)

Sta. 21+65.27 Line E=
Sta. 0+00 Lines E23 & E24=
Sta. 734+96.93 6.18' Rt.
Const. Type P (Std.) Manhole
Install 18" x 66.98' RCP (N)
Install 18" x 54.62' RCP (S)

Sta. 20+67.28 Line E=
Sta. 0+00 Lines E21 & E22=
Sta. 735+94.91 6.18' Rt.
Const. Type P (Std.) Manhole
Install 18" x 66.98' RCP (N)
Install 24" x 97.99' RCP (W)
Install 18" x 54.62' RCP (S)

Sta. 0+66.98 Line D3=
Sta. 722+78.88 60.80' Lt.
Const. Conc. Grate Inlet

Sta. 0+66.98 Line D7=
Sta. 724+78.97 60.80' Lt.
Const. Conc. Grate Inlet

Sta. 0+66.98 Line D11=
Sta. 726+79.91 60.80' Lt.
Const. Conc. Grate Inlet

Sta. 0+66.98 Line E23=
Sta. 734+96.93 60.80' Lt.
Const. Conc. Grate Inlet

Sta. 0+66.98 Line E21=
Sta. 735+94.91 60.80' Lt.
Const. Conc. Grate Inlet

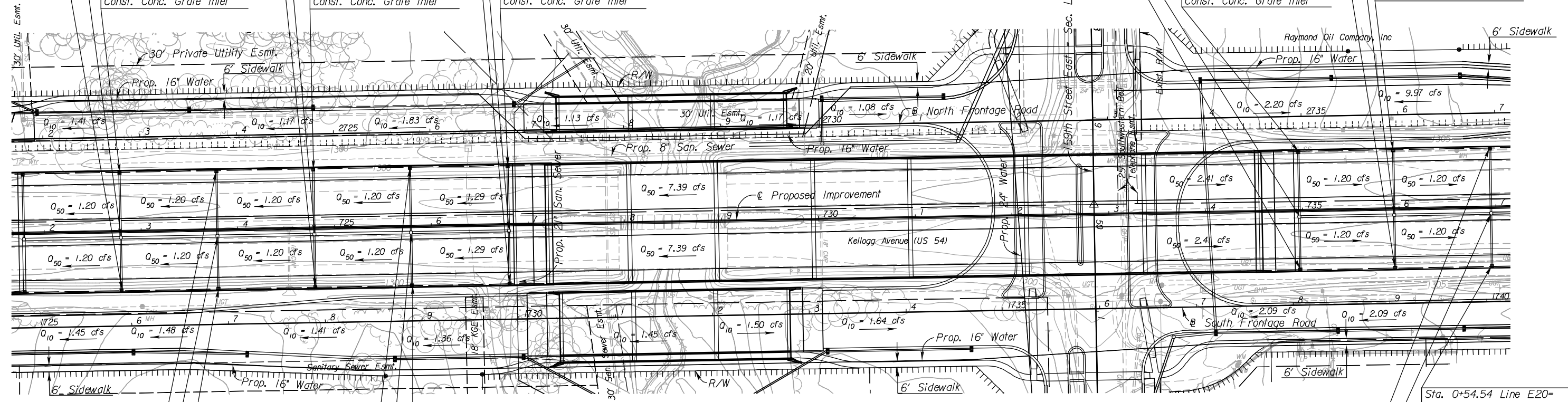

Sta. 0+54.62 Line D4=
Sta. 723+78.87 60.80' Rt.
Const. Conc. Grate Inlet

Sta. 0+54.62 Line D8=
Sta. 725+78.95 60.80' Rt.
Const. Conc. Grate Inlet

Sta. 0+54.54 Line E20=
Sta. 736+94.90 60.80' Rt.
Const. Conc. Grate Inlet

Sta. 13+72.20 Line D=
Sta. 0+00 Lines D4 & D5=
Sta. 723+78.87 6.18' Rt.
Const. Type P (Std.) Manhole
Install 18" x 66.98' RCP (N)
Install 30" x 100.09' RCP (E)
Install 18" x 54.62' RCP (S)

Sta. 15+72.27 Line D=
Sta. 0+00 Lines D8 & D9=
Sta. 725+78.95 6.18' Rt.
Const. Type P (Std.) Manhole
Install 18" x 66.98' RCP (N)
Install 24" x 100.96' RCP (E)
Install 18" x 54.62' RCP (S)

Sta. 19+67.30 Line E=
Sta. 0+00 Lines E19 & E20=
Sta. 736+94.90 6.18' Rt.
Const. Type P (Std.) Manhole
Install 18" x 67.07' RCP (N)
Install 24" x 99.99' RCP (W)
Install 18" x 54.54' RCP (S)

Sta. 0+66.98 Line D5=
Sta. 723+78.86 60.80' Lt.
Const. Conc. Grate Inlet

Sta. 0+66.98 Line D9=
Sta. 725+78.95 60.80' Lt.
Const. Conc. Grate Inlet

Sta. 0+67.07 Line E19=
Sta. 736+94.90 60.80' Lt.
Const. Conc. Grate Inlet

- UTILITIES**
- Cable Cox Communications
 - Gas₁ Kansas Gas Service
 - Power Westar
 - Sanitary Sewer Wichita Water & Sewer
 - Storm Water Sewer Wichita Water & Sewer
 - Telephone AT&T
 - Traffic Signal City of Wichita
 - Water Wichita Water & Sewer

$Q_{50} = x.xx$ cfs - DESIGN YEAR FLOW PER INLET
See Sh. No's. 136-139 for San. Sewer Plans.
See Sh. No's. 140-162 for Water Plans.

CITY OF WICHITA
EAST KELLOGG
STORM WATER SEWER PLAN
STA. 722+00 TO STA. 737+00

3:01 PM
 2/18/2011
 J:\CIVIL\07432\DWG\SWS\EK2ML PLAN\EK2ML_SWPLO8.DWG
 SURV. - PLOT CADD DES. - DR. - APP. - CKD. - TR.