

| | | | | |
|--------|-------------|------|-----------|--------------|
| STATE | PROJECT NO. | YEAR | SHEET NO. | TOTAL SHEETS |
| KANSAS | 472 84614 | . | 109 | 534 |

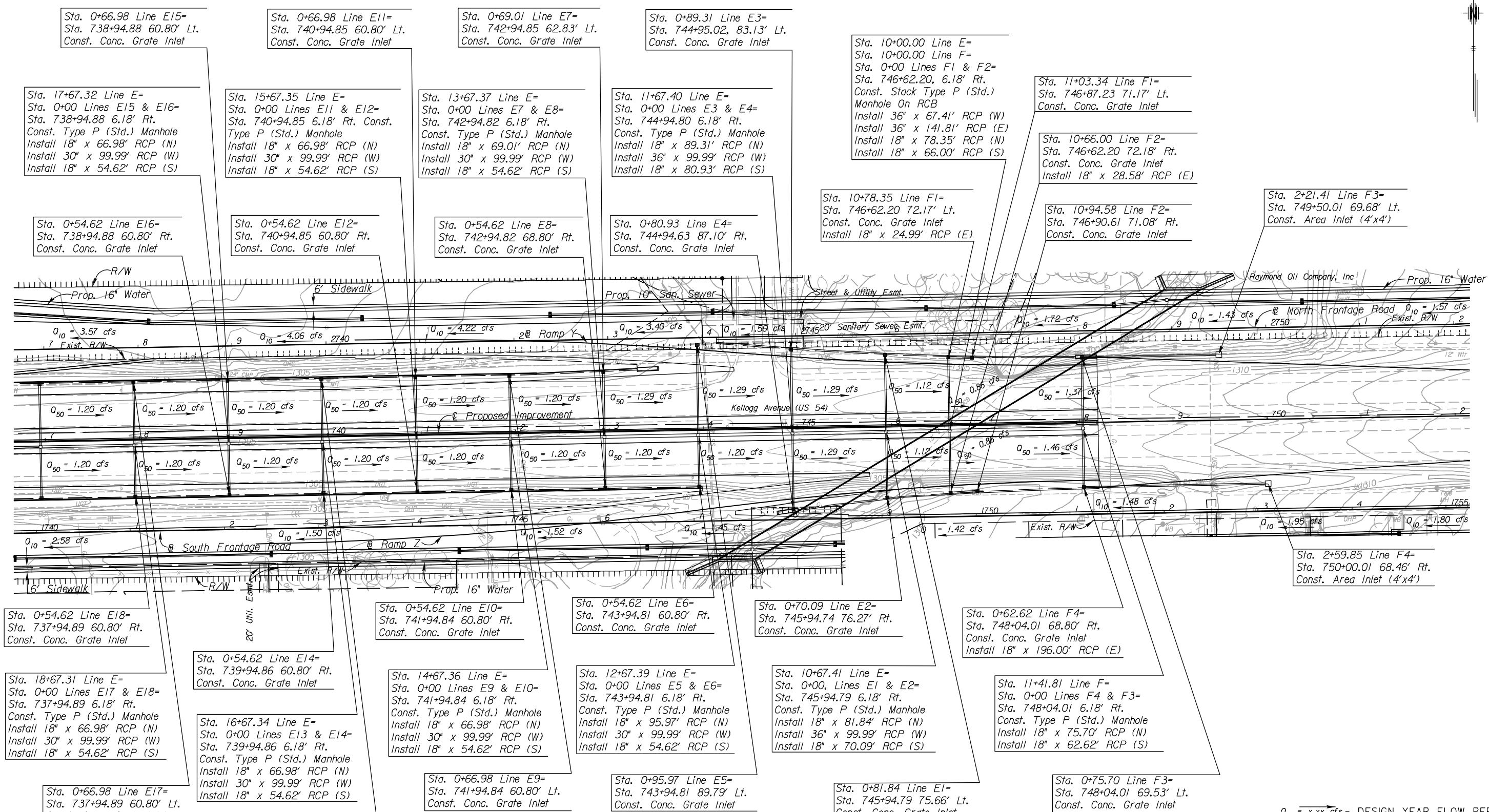

Sta. 0+66.98 Line E15=
Sta. 738+94.88 60.80' Lt.
Const. Conc. Grate Inlet

Sta. 0+66.98 Line E11=
Sta. 740+94.85 60.80' Lt.
Const. Conc. Grate Inlet

Sta. 0+69.01 Line E7=
Sta. 742+94.85 62.83' Lt.
Const. Conc. Grate Inlet

Sta. 0+89.31 Line E3=
Sta. 744+95.02, 83.13' Lt.
Const. Conc. Grate Inlet

Sta. 10+00.00 Line E=
Sta. 10+00.00 Line F=
Sta. 0+00 Lines F1 & F2=
Sta. 746+62.20, 6.18' Rt.
Const. Stack Type P (Std.)
Manhole On RCB
Install 36" x 67.41' RCP (W)
Install 36" x 141.81' RCP (E)
Install 18" x 78.35' RCP (N)
Install 18" x 66.00' RCP (S)

Sta. 11+03.34 Line F1=
Sta. 746+87.23 71.17' Lt.
Const. Conc. Grate Inlet

Sta. 10+66.00 Line F2=
Sta. 746+62.20 72.18' Rt.
Const. Conc. Grate Inlet
Install 18" x 28.58' RCP (E)

Sta. 10+94.58 Line F2=
Sta. 746+90.61 71.08' Rt.
Const. Conc. Grate Inlet

Sta. 2+21.41 Line F3=
Sta. 749+50.01 69.68' Lt.
Const. Area Inlet (4'x4')

Sta. 17+67.32 Line E=
Sta. 0+00 Lines E15 & E16=
Sta. 738+94.88 6.18' Rt.
Const. Type P (Std.) Manhole
Install 18" x 66.98' RCP (N)
Install 30" x 99.99' RCP (W)
Install 18" x 54.62' RCP (S)

Sta. 15+67.35 Line E=
Sta. 0+00 Lines E11 & E12=
Sta. 740+94.85 6.18' Rt. Const.
Type P (Std.) Manhole
Install 18" x 66.98' RCP (N)
Install 30" x 99.99' RCP (W)
Install 18" x 54.62' RCP (S)

Sta. 13+67.37 Line E=
Sta. 0+00 Lines E7 & E8=
Sta. 742+94.82 6.18' Rt.
Const. Type P (Std.) Manhole
Install 18" x 69.01' RCP (N)
Install 30" x 99.99' RCP (W)
Install 18" x 54.62' RCP (S)

Sta. 11+67.40 Line E=
Sta. 0+00 Lines E3 & E4=
Sta. 744+94.80 6.18' Rt.
Const. Type P (Std.) Manhole
Install 18" x 89.31' RCP (N)
Install 36" x 99.99' RCP (W)
Install 18" x 80.93' RCP (S)

Sta. 10+78.35 Line F1=
Sta. 746+62.20 72.17' Lt.
Const. Conc. Grate Inlet
Install 18" x 24.99' RCP (E)

Sta. 0+54.62 Line E16=
Sta. 738+94.88 60.80' Rt.
Const. Conc. Grate Inlet

Sta. 0+54.62 Line E12=
Sta. 740+94.85 60.80' Rt.
Const. Conc. Grate Inlet

Sta. 0+54.62 Line E8=
Sta. 742+94.82 68.80' Rt.
Const. Conc. Grate Inlet

Sta. 0+80.93 Line E4=
Sta. 744+94.63 87.10' Rt.
Const. Conc. Grate Inlet

Sta. 0+54.62 Line E18=
Sta. 737+94.89 60.80' Rt.
Const. Conc. Grate Inlet

Sta. 0+54.62 Line E14=
Sta. 739+94.86 60.80' Rt.
Const. Conc. Grate Inlet

Sta. 0+54.62 Line E10=
Sta. 741+94.84 60.80' Rt.
Const. Conc. Grate Inlet

Sta. 0+54.62 Line E6=
Sta. 743+94.81 60.80' Rt.
Const. Conc. Grate Inlet

Sta. 0+70.09 Line E2=
Sta. 745+94.74 76.27' Rt.
Const. Conc. Grate Inlet

Sta. 0+62.62 Line F4=
Sta. 748+04.01 68.80' Rt.
Const. Conc. Grate Inlet
Install 18" x 196.00' RCP (E)

Sta. 18+67.31 Line E=
Sta. 0+00 Lines E17 & E18=
Sta. 737+94.89 6.18' Rt.
Const. Type P (Std.) Manhole
Install 18" x 66.98' RCP (N)
Install 30" x 99.99' RCP (W)
Install 18" x 54.62' RCP (S)

Sta. 16+67.34 Line E=
Sta. 0+00 Lines E13 & E14=
Sta. 739+94.86 6.18' Rt.
Const. Type P (Std.) Manhole
Install 18" x 66.98' RCP (N)
Install 30" x 99.99' RCP (W)
Install 18" x 54.62' RCP (S)

Sta. 14+67.36 Line E=
Sta. 0+00 Lines E9 & E10=
Sta. 741+94.84 6.18' Rt.
Const. Type P (Std.) Manhole
Install 18" x 66.98' RCP (N)
Install 30" x 99.99' RCP (W)
Install 18" x 54.62' RCP (S)

Sta. 12+67.39 Line E=
Sta. 0+00 Lines E5 & E6=
Sta. 743+94.81 6.18' Rt.
Const. Type P (Std.) Manhole
Install 18" x 95.97' RCP (N)
Install 30" x 99.99' RCP (W)
Install 18" x 54.62' RCP (S)

Sta. 10+67.41 Line E=
Sta. 0+00, Lines E1 & E2=
Sta. 745+94.79 6.18' Rt.
Const. Type P (Std.) Manhole
Install 18" x 81.84' RCP (N)
Install 36" x 99.99' RCP (W)
Install 18" x 70.09' RCP (S)

Sta. 11+41.81 Line F=
Sta. 0+00 Lines F4 & F3=
Sta. 748+04.01 6.18' Rt.
Const. Type P (Std.) Manhole
Install 18" x 75.70' RCP (N)
Install 18" x 62.62' RCP (S)

Sta. 0+66.98 Line E17=
Sta. 737+94.89 60.80' Lt.
Const. Conc. Grate Inlet

Sta. 0+66.98 Line E13=
Sta. 739+94.86 60.80' Lt.
Const. Conc. Grate Inlet

Sta. 0+66.98 Line E9=
Sta. 741+94.84 60.80' Lt.
Const. Conc. Grate Inlet

Sta. 0+95.97 Line E5=
Sta. 743+94.81 89.79' Lt.
Const. Conc. Grate Inlet

Sta. 0+81.84 Line E1=
Sta. 745+94.79 75.66' Lt.
Const. Conc. Grate Inlet

Sta. 0+75.70 Line F3=
Sta. 748+04.01 69.53' Lt.
Const. Conc. Grate Inlet
Install 18" x 145.71' RCP (E)

$Q_{50} = x.xx$ cfs - DESIGN YEAR FLOW PER INLET
See Sh. No's. 27-28 for Crossroad Structures
See Sh. No's. 136-139 for San. Sewer Plans.
See Sh. No's. 140-162 for Water Plans.

- UTILITIES
- Cable Cox Communications
 - Gas Kansas Gas Service
 - Power Westar
 - Sanitary Sewer Wichita Water & Sewer
 - Storm Water Sewer Wichita Water & Sewer
 - Telephone AT&T
 - Water Wichita Water & Sewer

CITY OF WICHITA
EAST KELLOGG
STORM WATER SEWER PLAN
STA. 737+00 TO STA. 752+00

3:01 PM
 2/18/2011
 J:\CIVIL\07432\DWG\SWS\EK2ML PLAN\EK2ML_SWPLO9.DWG
 SURV. - PLOT CADD DES. - DR. - TR. - APP. - CKD.