

STATE	PROJECT NO.	YEAR	SHEET NO.	TOTAL SHEETS
KANSAS	472 84614	-	119	534

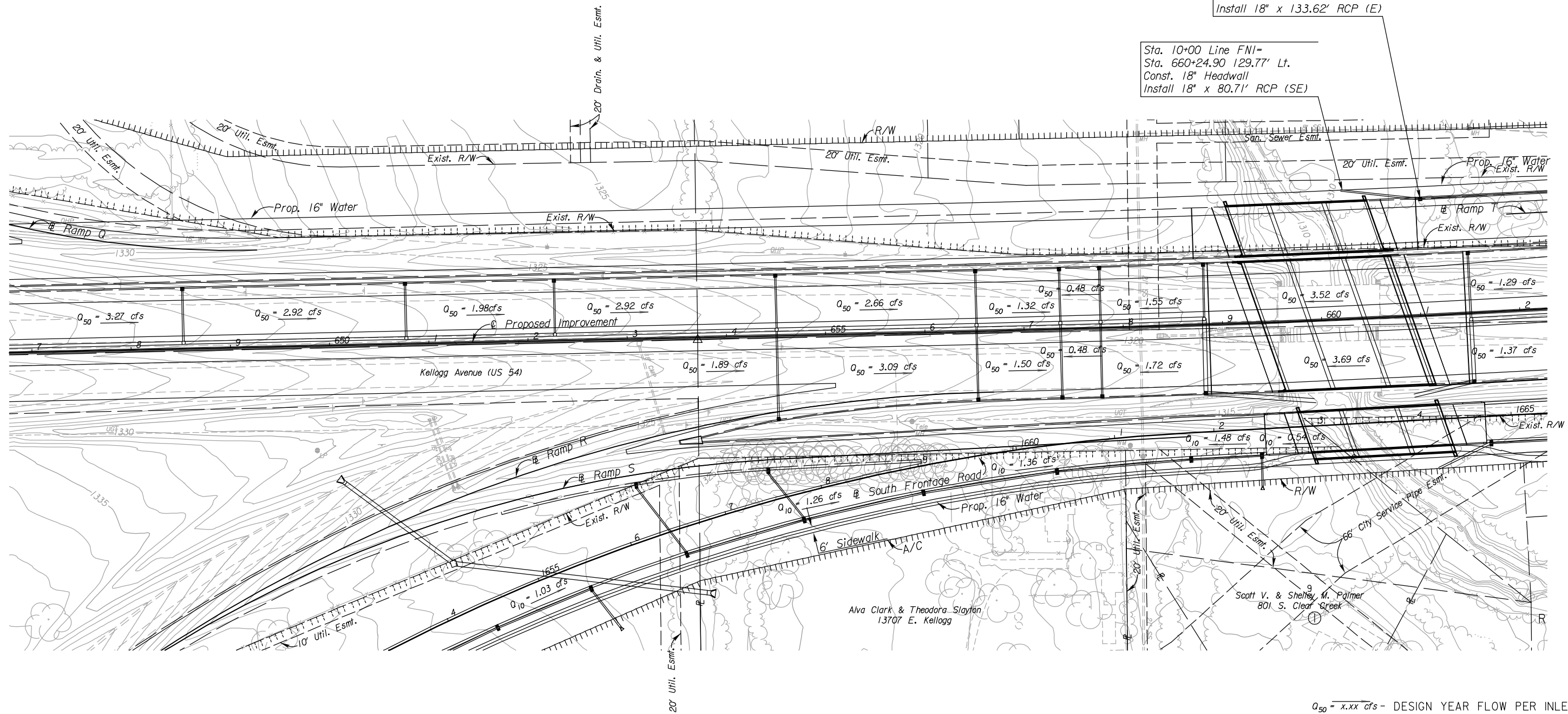

Sta. 10+80.71 Line FNI=
Sta. 661+05.25 117.49' Lt.
Const. Conc. Grate Inlet
Install 18" x 133.62' RCP (E)

Sta. 10+00 Line FNI=
Sta. 660+24.90 129.77' Lt.
Const. 18" Headwall
Install 18" x 80.71' RCP (SE)



$Q_{50} = x.xx$ cfs - DESIGN YEAR FLOW PER INLET
See Sh. No's. 136-139 for San. Sewer Plans.
See Sh. No's. 140-162 for Water Plans.

UTILITIES

- | | |
|-------------------|------------------------|
| Gas2 | Southern Star Pipeline |
| Power | Westar |
| Sanitary Sewer | Wichita Water & Sewer |
| Storm Water Sewer | Wichita Water & Sewer |
| Telephone | AT&T |
| Water | Wichita Water & Sewer |

CITY OF WICHITA
NORTH FRONTAGE ROAD
STORM WATER SEWER PLAN
STA. 647+00 TO STA. 662+00

8:19 AM
 2/22/2011
 J:\CIVIL\07432\DWG\SWS\EK2ML PLAN\EK2FNSWPL03.DWG
 SURV. - PLOT CADD DES. - I.D.R. - C.K.D. - APP.