

STATE	PROJECT NO.	YEAR	SHEET NO.	TOTAL SHEETS
KANSAS	472 84614	.	182	534

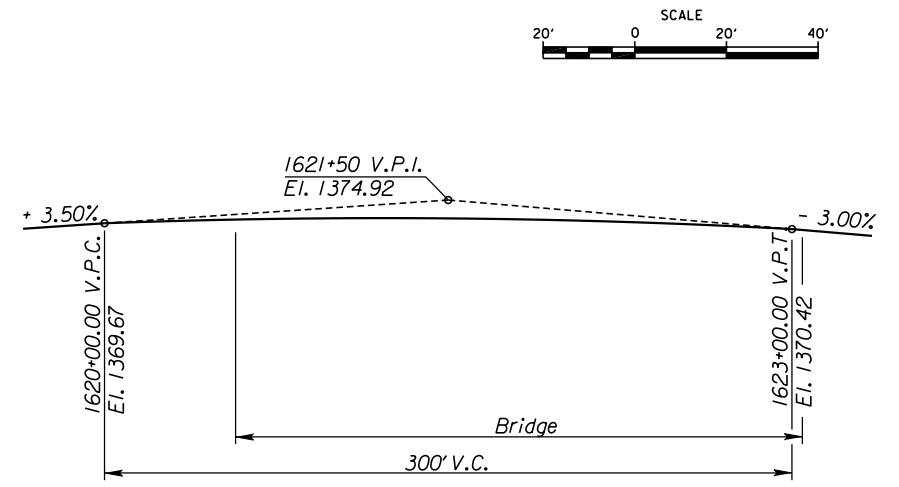

**ELEVATION**  
 122'-122'  
 Continuous Prestressed Concrete Beam Spans;  
 Pile Bent Abutments & Column Bent Pier,  
 1-40' Roadway, 1-6' Sidewalk, 26°17'31" Skew Rt.

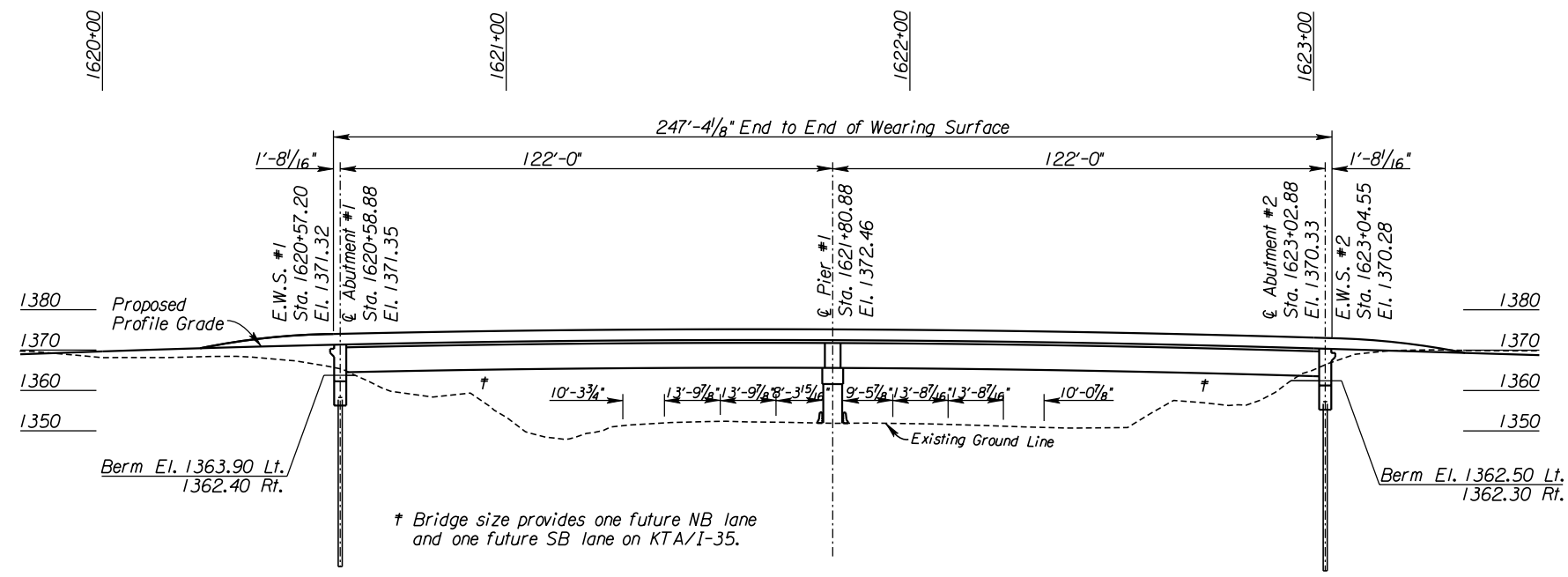
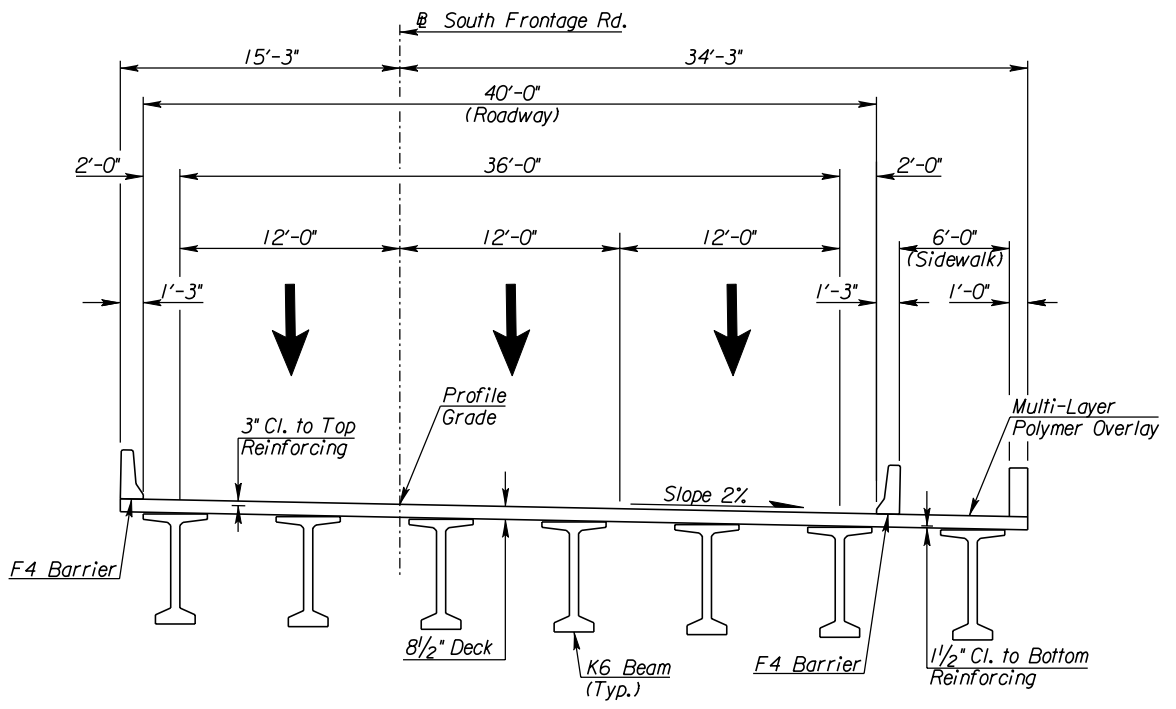

**SOUTH FRONTAGE ROAD OVER KTA/I-35**  
 Proposed Section

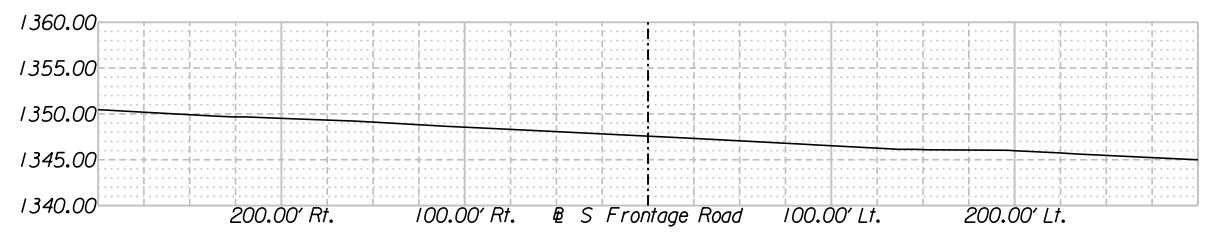

**EXISTING PROFILE OF KTA/I-35**  
 (Along KTA/I-35)

**DESIGN LOADING:**  
 HL-93

**UNIT STRESSES:**  
 Concrete  $f'_c = 4,000 \text{ psi}$   
 Reinforcing Steel  $f_y = 60,000 \text{ psi}$

CITY OF WICHITA  
 SOUTH FRONTAGE ROAD OVER KTA/I-35  
 CONSTRUCTION LAYOUT II  
 BR. NO. STA. 1621+80.88

10:48:17 AM  
 2/9/2011  
 I:\35766A\Cadd\Sheets\Structures\Bridges\KOKTA\SFR\K2SKCLY02.dgn  
 SURV. - PLOT CADD DES. - DR. - TR. - APP. - CKD.