

STATE	PROJECT NO.	YEAR	SHEET NO.	TOTAL SHEETS
KANSAS	472 84614	.	188	534

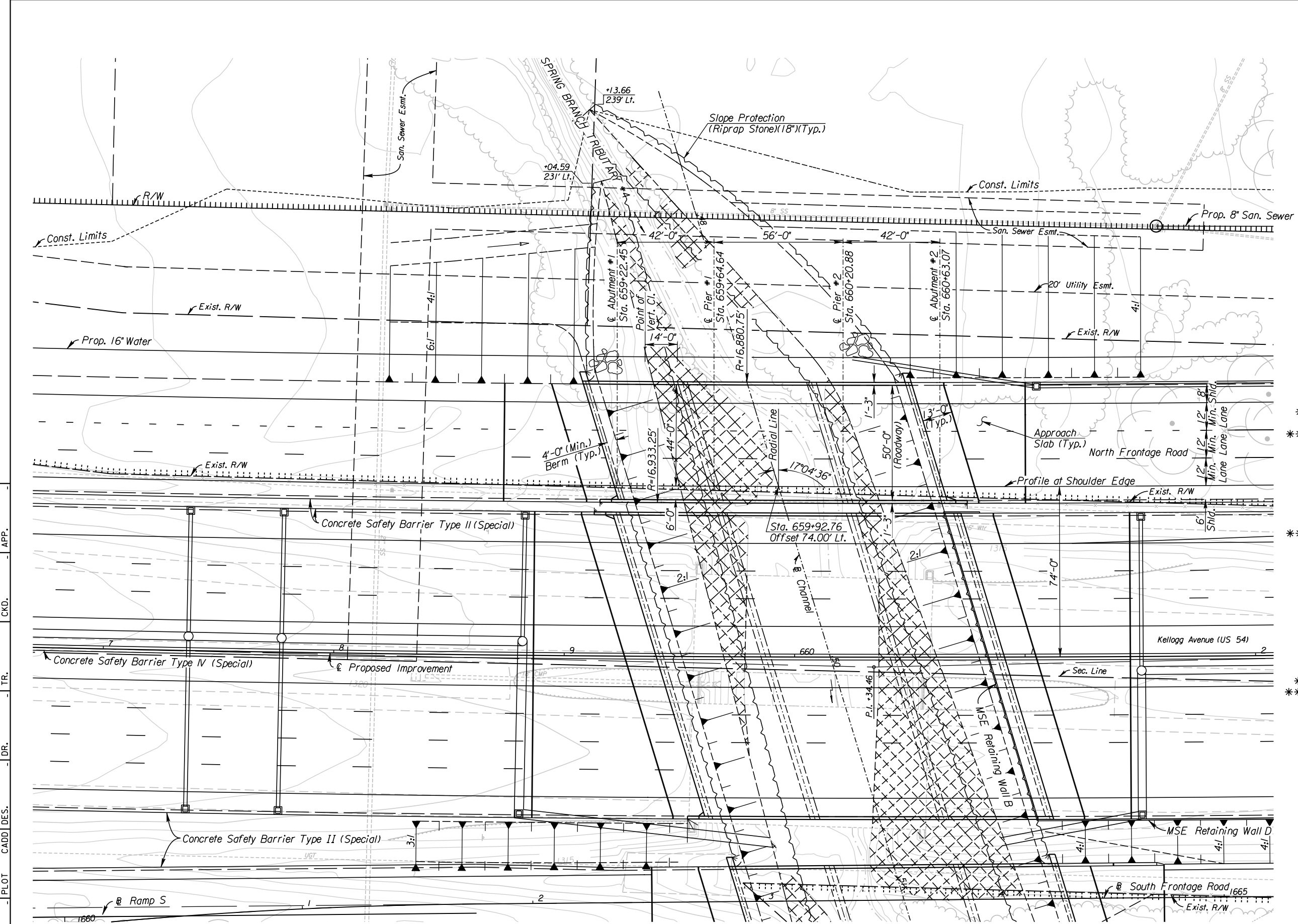
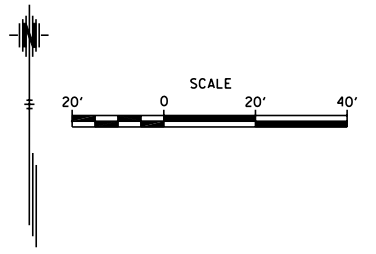

**DRAINAGE DATA**

* Drainage Area	3.3 Sq. Mi.
Design Frequency	100 Years
** Design Discharge (Q <sub>100</sub> )	3,813 cfs
Design High Water Elevation	1317.09 Ft.
Design Backwater	N/A Ft.
Design Backwater Elevation	1317.71 Ft.
Overtopping Elevation (Sta. N/A)	N/A Ft.
Overtopping Discharge	N/A cfs
Overtopping Frequency	>500 Years
* Discharge at Q <sub>100</sub>	3,813 cfs
Backwater at Q <sub>100</sub>	N/A Ft.
Backwater Elevation at Q <sub>100</sub>	1317.71 Ft.
Historic High Water Elevation	N/A Ft.
Ordinary High Water Elevation	1309.0 Ft.
Total Waterway Provided	823 Sq. Ft.
Design Waterway Provided	219 Sq. Ft.
100 Yr. Floodplain Elev. (FEMA)	N/A Ft.
Average Velocity at Q <sub>des</sub>	3.4 fps
Average Velocity at Q <sub>100</sub>	3.4 fps
* Drainage Area for Spring Branch Tributary #4	
** Discharge is controlled and published by FEMA	

⊕ PROPOSED IMPROVEMENT CURVE DATA  
 P.I. Sta. 660+34.46 Bk. = 660+34.34 Ahd.  
 $\Delta = 02^{\circ}34'29"$  (Lt.) L = 763.93'  
 R = 17000.00' E = 4.29'  
 T = 382.03'

**CITY OF WICHITA**  
 NORTH FRONTAGE ROAD OVER  
 SPRING BRANCH TRIBUTARY #4  
 CONSTRUCTION LAYOUT I  
 BR. NO. STA. 659+92.76

10:49:29 AM  
 2/9/2011  
 T:\35766A\Cadd\Sheets\Structures\Bridges\SBT4\NFR\EK25BNCLY01.dgn  
 SURV. - PLOT CADD DES. - DR. - TR. - CKD. - APP.

**PLAN**