

STATE	PROJECT NO.	YEAR	SHEET NO.	TOTAL SHEETS
KANSAS	472 84614	-	III	534

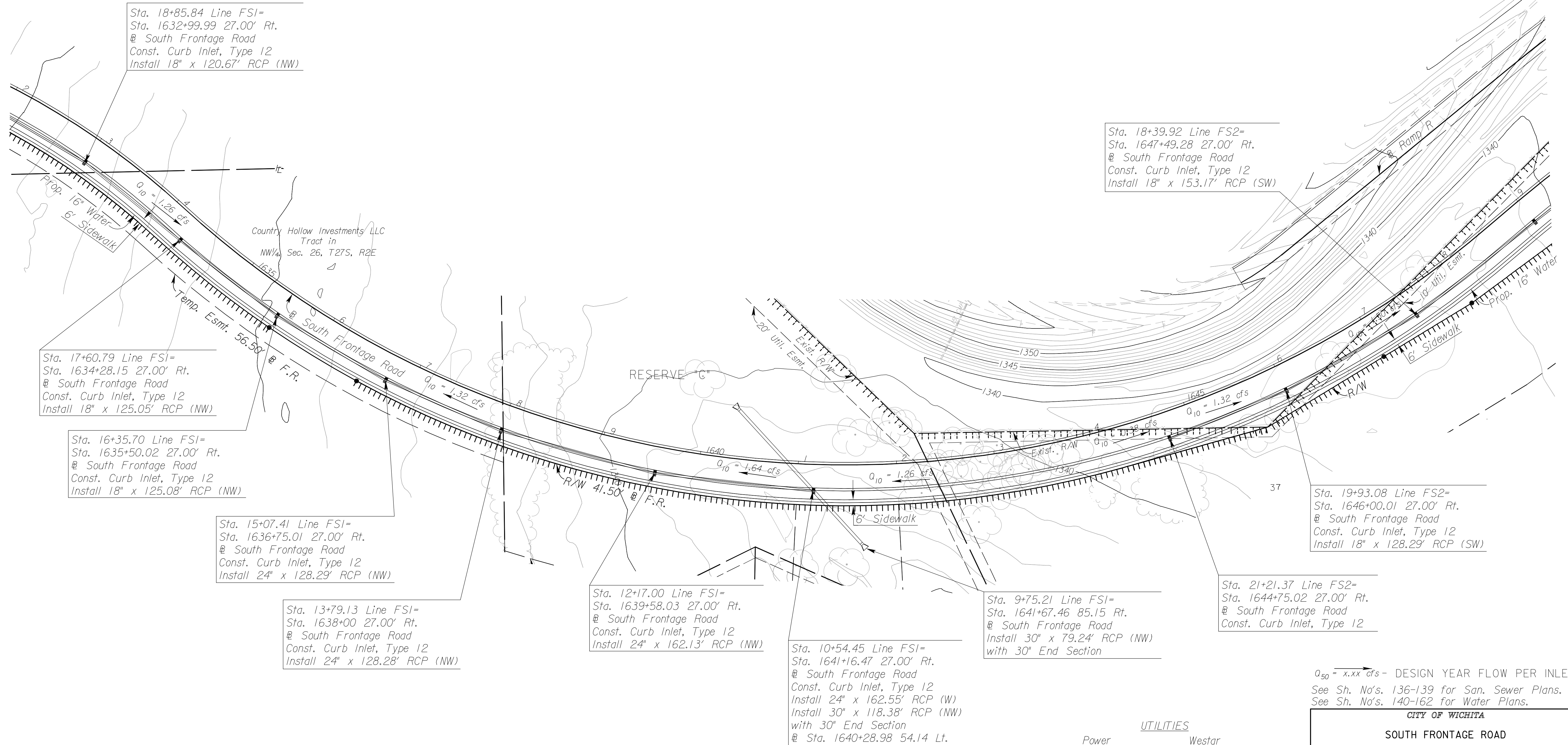
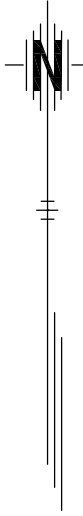

Sta. 17+60.79 Line FS1=
Sta. 1634+28.15 27.00' Rt.
@ South Frontage Road
Const. Curb Inlet, Type 12
Install 18" x 125.05' RCP (NW)

Sta. 16+35.70 Line FS1=
Sta. 1635+50.02 27.00' Rt.
@ South Frontage Road
Const. Curb Inlet, Type 12
Install 18" x 125.08' RCP (NW)

Sta. 15+07.41 Line FS1=
Sta. 1636+75.01 27.00' Rt.
@ South Frontage Road
Const. Curb Inlet, Type 12
Install 24" x 128.29' RCP (NW)

Sta. 13+79.13 Line FS1=
Sta. 1638+00 27.00' Rt.
@ South Frontage Road
Const. Curb Inlet, Type 12
Install 24" x 128.28' RCP (NW)

Sta. 12+17.00 Line FS1=
Sta. 1639+58.03 27.00' Rt.
@ South Frontage Road
Const. Curb Inlet, Type 12
Install 24" x 162.13' RCP (NW)

Sta. 10+54.45 Line FS1=
Sta. 1641+16.47 27.00' Rt.
@ South Frontage Road
Const. Curb Inlet, Type 12
Install 24" x 162.55' RCP (W)
with 30" End Section
@ Sta. 1640+28.98 54.14 Lt.

Sta. 9+75.21 Line FS1=
Sta. 1641+67.46 85.15 Rt.
@ South Frontage Road
Install 30" x 79.24' RCP (NW)
with 30" End Section

Sta. 21+21.37 Line FS2=
Sta. 1644+75.02 27.00' Rt.
@ South Frontage Road
Const. Curb Inlet, Type 12

Sta. 18+39.92 Line FS2=
Sta. 1647+49.28 27.00' Rt.
@ South Frontage Road
Const. Curb Inlet, Type 12
Install 18" x 153.17' RCP (SW)

Sta. 19+93.08 Line FS2=
Sta. 1646+00.01 27.00' Rt.
@ South Frontage Road
Const. Curb Inlet, Type 12
Install 18" x 128.29' RCP (SW)

$Q_{50} = x.xx$ cfs - DESIGN YEAR FLOW PER INLET
See Sh. No's. 136-139 for San. Sewer Plans.
See Sh. No's. 140-162 for Water Plans.

UTILITIES

Power	Westar
Storm Water Sewer	Wichita Water & Sewer
Telephone	AT&T
Water	Wichita Water & Sewer

CITY OF WICHITA
SOUTH FRONTAGE ROAD
STORM WATER SEWER PLAN
STA. 1632+00 TO STA. 1649+00

8:26 AM
 2/22/2011
 J:\CIVIL\07432\DWG\SWSEK2ML PLAN\K2FSSWPLO2.DWG
 SURV. - PLOT CADD DES. - TR. - CKD. - APP.