

STATE	PROJECT NO.	YEAR	SHEET NO.	TOTAL SHEETS
KANSAS	472 84614	.	123	534

Sta. 10+58.83 Line FN8=
Sta. 2721+94.35 27.00' Lt.
@ North Frontage Road
Const. Curb Inlet, Type 12
Install 18" x 157.28' RCP (E)

Sta. 10+00 Line FN8=
Sta. 2721+40.54 50.56' Lt.
@ North Frontage Road
Const. 18" Headwall
Install 18" x 58.83' RCP (SE)

Sta. 10+00 Line FN7=
Sta. 2720+28.37 50.09' Lt.
@ North Frontage Road
Const. 30" Headwall
Install 30" x 84.95' RCP (SW)

Sta. 10+84.95 Line FN7=
Sta. 2719+46.66 27.00' Lt.
@ North Frontage Road
Const. Curb Inlet, Type 12
Install 30" x 201.75' RCP (W)

Sta. 12+86.70 Line FN7=
Sta. 2717+45 27.00' Lt.
@ North Frontage Road
Const. Curb Inlet, Type 12
Install 24" x 225.29' RCP (W)

Sta. 15+11.98 Line FN7=
Sta. 2715+19.63 27.00' Lt.
@ North Frontage Road
Const. Curb Inlet, Type 12
Install 24" x 239.98' RCP (W)

Sta. 17+51.97 Line FN7=
Sta. 2712+79.64 27.00' Lt.
@ North Frontage Road
Const. Curb Inlet, Type 12
Install 24" x 234.34' RCP (W)

Sta. 19+86.31 Line FN7=
Sta. 2710+44.04 27.00' Lt.
@ North Frontage Road
Const. Curb Inlet, Type 12
Install 24" x 239.90' RCP (W)

Sta. 22+26.20 Line FN7=
Sta. 2708+04.14 27.00' Lt.
@ North Frontage Road
Const. Curb Inlet, Type 12
Install 18" x 179.95' RCP (W)

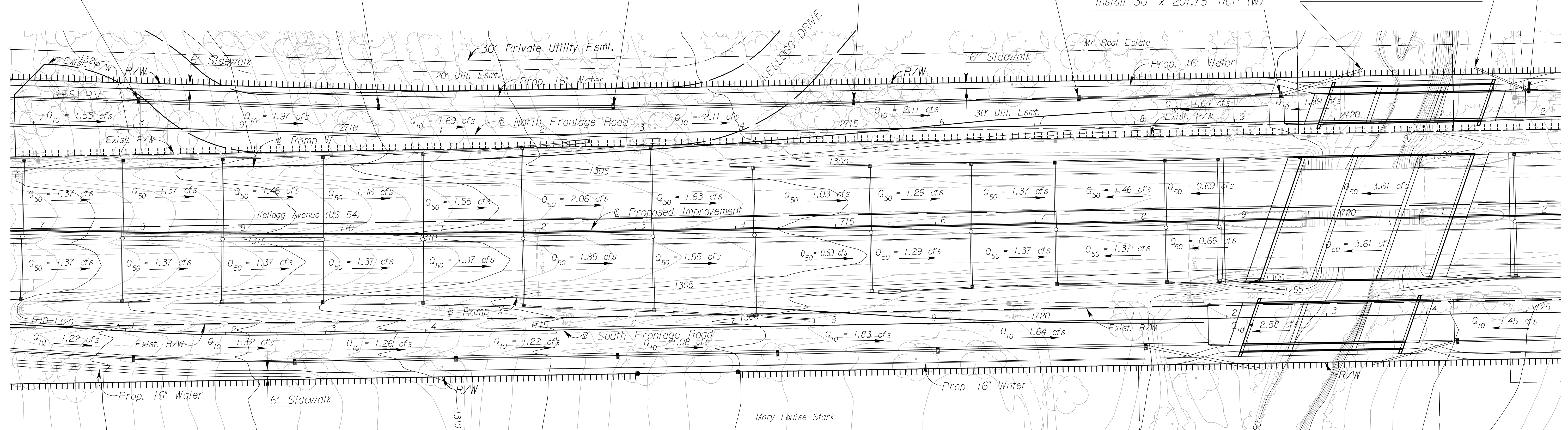

$Q_{50} = x.xx$ cfs - DESIGN YEAR FLOW PER INLET
See Sh. No's. 136-139 for San. Sewer Plans.
See Sh. No's. 140-162 for Water Plans.

- UTILITIES**
- | | |
|-------------------|-----------------------|
| Cable | Cox Communications |
| Gas | Kansas Gas Service |
| Power | Westar |
| Sanitary Sewer | Wichita Water & Sewer |
| Storm Water Sewer | Wichita Water & Sewer |
| Telephone | AT&T |
| Water | Wichita Water & Sewer |

CITY OF WICHITA
NORTH FRONTAGE ROAD
STORM WATER SEWER PLAN
STA. 2707+00 TO STA. 2722+00

2:44 PM
 2/18/2011
 J:\CIVIL\07432\DWG\SWSEK2ML PLAN\K2FNSWPLOT.DWG
 SURV. - PLOT CADD DES. - DR. - TR. - CKD. - APP.