

MH-1 moved 17.5' N of plan location.

MH-2 moved 5.5' N of the S b/c or 9.5' S of C_L of 2nd Street.

0+17.50
Sta ~~0+00.00~~, Begin SS LINE 1 =
Sta 28+23.60, ~~27.00~~ Rt. BL D
Construct Std. Type "P" Manhole
(4' Dia.) Over Ex. 8" SS
Top Elev. = ~~119.93~~ 118.53

0+61.5
Sta ~~0+43.99~~, SS LINE 1 =
Sta 27+79.61, ~~27.00~~ Rt. BL D
Construct Std. Type "P"
Manhole (4' Dia.)
Top Elev. = ~~120.75~~ 118.5

SCALE:
1" = 20' HORIZONTAL
1" = 5' VERTICAL

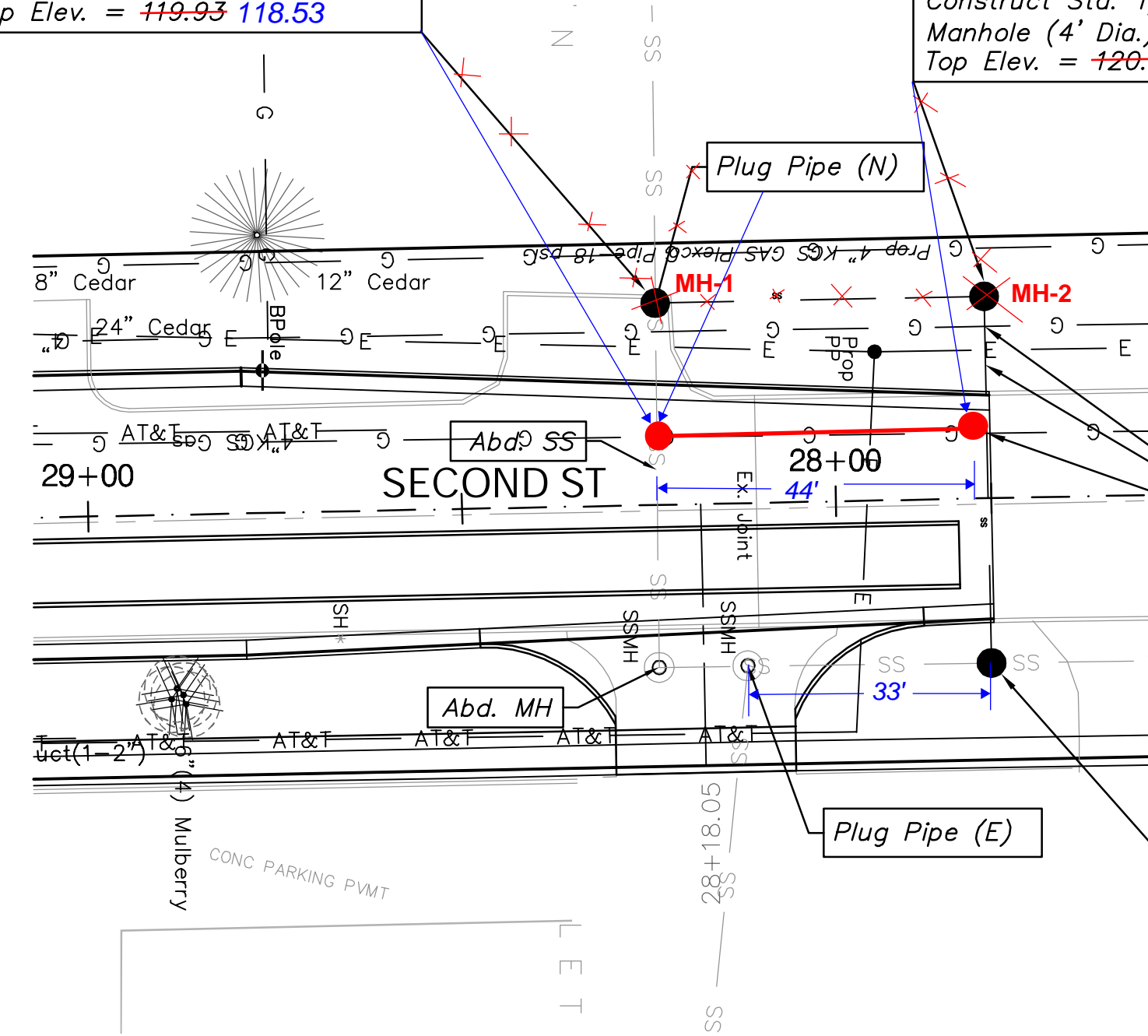

Note: SS line and manholes moved to new location due to gas and power pole conflict.

CAUTION!
2-4" GAS
OH ELEC
Crosses

Sta 0+93.03, End SS LINE 1 =
Sta 27+79.61, 22.04' Lt. BL D
Construct Std. Type "P" Manhole
(4' Dia.) Over Ex. 8" SS
Top Elev. = 119.38

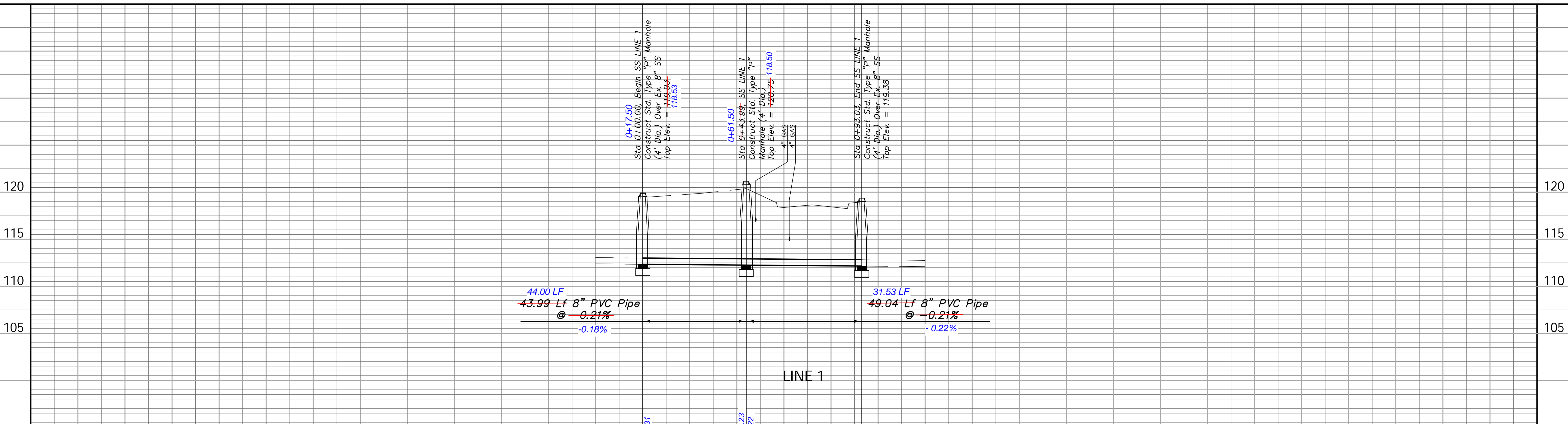

Drawing File: E:\West St.\Land\Draw\ssBase
Design: T. Aziere
Drawn: Sonny
Approved: J. F. Bradley
Scale: 1:20

Project No. 04-04-E859 CAPITAL IMPROVEMENT PROJECT
WEST STREET SANITARY SEWER LINE 1
2nd STREET RELOCATION
STORM WATER SEWER IMPROVEMENTS

Baughman Company, P.A.
315 Ellis St. Wichita, KS 67211 P 316-262-7271 F 316-262-0149
ENGINEERING | SURVEYING | PLANNING | LANDSCAPE ARCHITECTURE

November 2008
SHEET
OF
51
131