

- LEGEND**
- ⊕ PP UTILITY POLE
 - ⊕ LP LIGHT POLE
 - ⊕ DM DEAD MAN
 - ⊕ WM WATER METER
 - ⊕ WV WATER VALVE
 - ⊕ GV GAS VALVE
 - ⊕ SS MH SANITARY SEWER MANHOLE
 - ⊕ SWS MH STORM SEWER MANHOLE

- NOTES:**
- UNLESS OTHERWISE INDICATED, DIMENSIONS ARE MEASURED TO CENTERLINE OF FITTINGS IN PLAN VIEW AND TOP OF PIPE IN PROFILE VIEW.
 - WL NO. 7 BASELINE = CENTERLINE OF DODGE AVENUE RIGHT-OF-WAY.
 - REFER TO SHEET 2, NOTE NO. 8, FOR DIRECTIONAL DRILLING REQUIREMENTS.

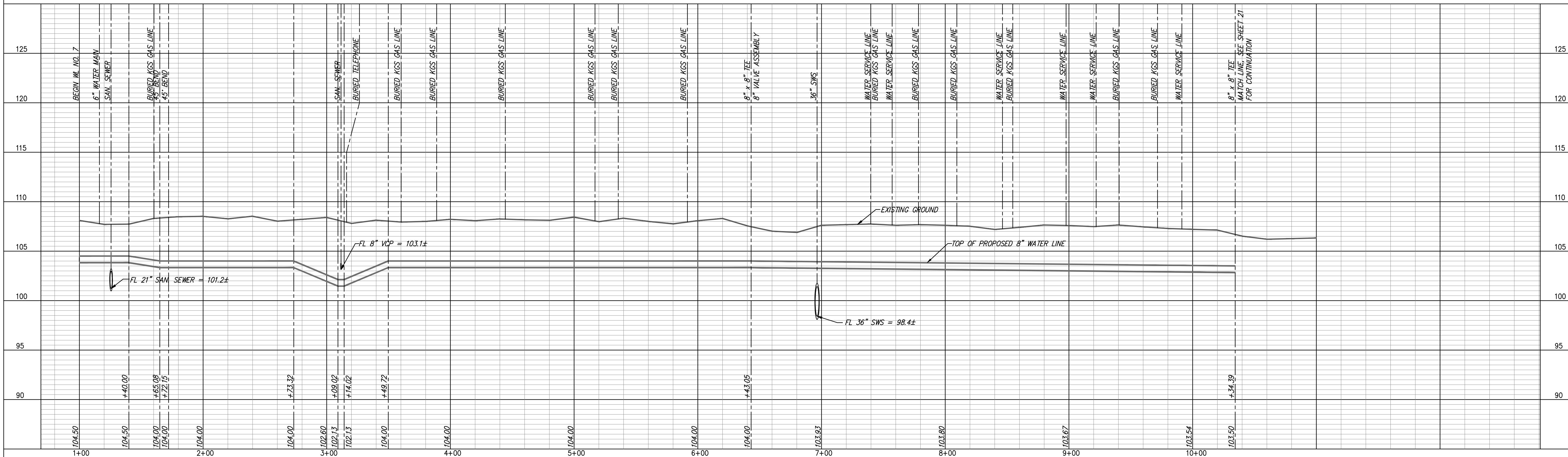

PROJECT NO. 06-228
DATE: 2-15-07
DRAWN: DMS
DESIGNED: DAS
CHECKED: GRY
APPROVED:

REVISIONS

NO.	DATE	COMMENTS	BY

WATER LINE NO. 7
PLAN AND PROFILE

McCormicks Water Main Replacement

City of Wichita, Sedgwick County, Kansas

YOUNG & ASSOCIATES, P.A.
 Civil and Environmental Engineers
 100 S. Georgia, Derby, KS 67037
 Tele: (316)788-2552 Fax: (316)788-4408 Email: young@yandemah.com

Copyright 2006, by Young & Associates, P.A., all rights reserved. Prepared in the United States of America. This drawing is the property of Young & Associates, P.A. and may not be reproduced in any form without the specific written permission of Young & Associates, P.A. This plan and design is the exclusive property of Young & Associates, P.A. The accuracy of the original or copied printed data not constitute a warranty.

SHEET 20 of 37