

WL No. 10, BL Sta. 36+72.13, 24' Lt. =
 WL No. 10, Sta. 1+00
 Existing Water Line
 Remove Existing 2" Blowoff Assembly
 Connect to Existing 8" Pipe
 Provide Couplers and Adapters as Required
 Install 1 - 2" IPT Plug in Existing 2" Valve
 Remove & Cap Existing 2" Valve as Required.

WL No. 10, BL Sta. 36+77.12, 24' Lt. =
 WL No. 10, Sta. 1+04.99
 1 - Fire Hydrant Assembly
 L = 4.5'
 Top of Valve Box = Match Existing
 FH Bury Elev. = 107.37

WL No. 10, BL Sta. 15+24.81 =
 Walnut Bl. Sta. 13+70.93

WL No. 10, BL Sta. 43+20.84, 24' Lt. =
 WL No. 10, Sta. 7+48.67
 1 - 8" x 8" DI CL MJ Tee
 1 - 8" Valve Assembly (S)
 Top of Valve Box = Match Existing

WL No. 10, BL Sta. 43+54.76, 24' Lt. =
 WL No. 10, Sta. 7+82.72
 Horiz. Defl. = 0'11"15" (Rt.)

WL No. 10, BL Sta. 43+72.05, 24' Lt. =
 WL No. 10, Sta. 8+00.00
 Match Line, See Sheet 25 for Continuation.

WL No. 10, BL Sta. 17+45.63 =
 WL No. 11, BL Sta. 10+00.00

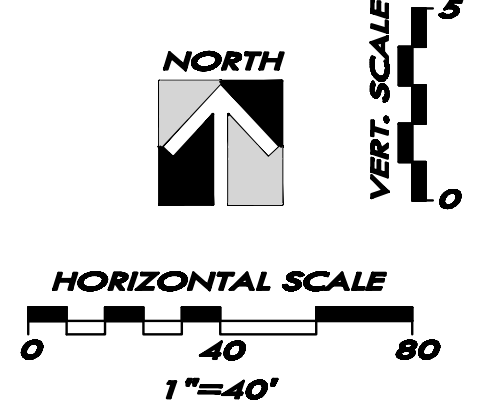

- LEGEND**
- ⊕ PP UTILITY POLE
 - ⊕ LP LIGHT POLE
 - ⊕ DM DEAD MAN
 - ⊕ WM WATER METER
 - ⊕ WV WATER VALVE
 - ⊕ GV GAS VALVE
 - ⊕ SS MH SANITARY SEWER MANHOLE
 - ⊕ SWS MH STORM SEWER MANHOLE

FIRE HYDRANTS REQUIRED			
STATION	BURY LINE ELEVATION	TOP OF PIPE ELEVATION	FIRE HYDRANT BURY REQUIRED*
WL NO. 10, STA. 1+04.99	107.37	103.99	4.0'

(FOR FIRE HYDRANT ASSEMBLY, SEE DETAIL, SHEET 27)

- NOTES:**
- UNLESS OTHERWISE INDICATED, DIMENSIONS ARE MEASURED TO CENTERLINE OF FITTINGS IN PLAN VIEW AND TOP OF PIPE IN PROFILE VIEW.
 - WL NO. 10 BASELINE = CENTERLINE OF IRVING AVENUE RIGHT-OF-WAY.
 - REFER TO SHEET 2, NOTE NO. 8, FOR DIRECTIONAL DRILLING REQUIREMENTS.

REMOVE & REPLACE CONCRETE SIDEWALK IN KIND, THIS SHEET = 153 LF
 REMOVE & REPLACE CONCRETE DRIVE IN KIND, THIS SHEET = 115 LF

WATER LINE NO. 10

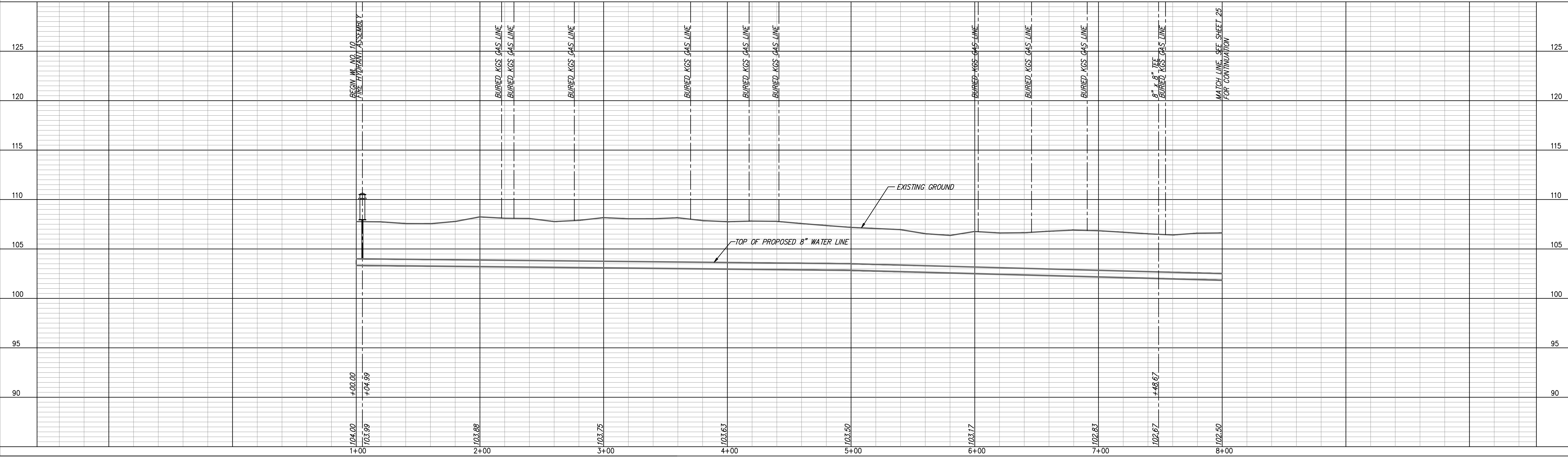

YOUNG & ASSOCIATES, P.A.
 Civil and Environmental Engineers
 100 S. Georgia, Derby, KS 67037
 Tele: (316)788-2552 Fax: (316)788-4408 Email: young@yandemah.com

**WATER LINE NO. 10
 PLAN AND PROFILE**
McCormicks Water Main Replacement
 City of Wichita, Sedgwick County, Kansas

PROJECT NO: 06-228
 DATE: 2-15-07
 DRAWN: DMS
 DESIGNED: DAS
 CHECKED: GRY
 APPROVED:

REVISIONS	DATE	COMMENTS	BY	APP.