

Sta. 301+48.7 SWS Line No. 300-  
 Sta. 5+00 SWS Line No. 301-  
 Sta. 229+75, 32.50' Lt. @ 119th St.  
 Construct Std. Type I Curb Inlet  
 L=10'-0" W=5'-0"  
 Install 15"x64.0' SWS (RCP) (E)  
 Install 30"x425.0' SWS (RCP) (N)  
 Install 36"x148.7' SWS (RCP) (S)  
 Connect to Proposed 6'-0" x 4'-0" RCB (300)  
 See Sh. No. 53, 54, 63

Sta. 5+64.0 SWS Line No. 301-  
 Sta. 229+75, 31.50' Rt. @ 119th St.  
 Construct Std. Type I Curb Inlet  
 L=10'-0" W=3'-0"  
 See Sh. No. 53, 54, 63

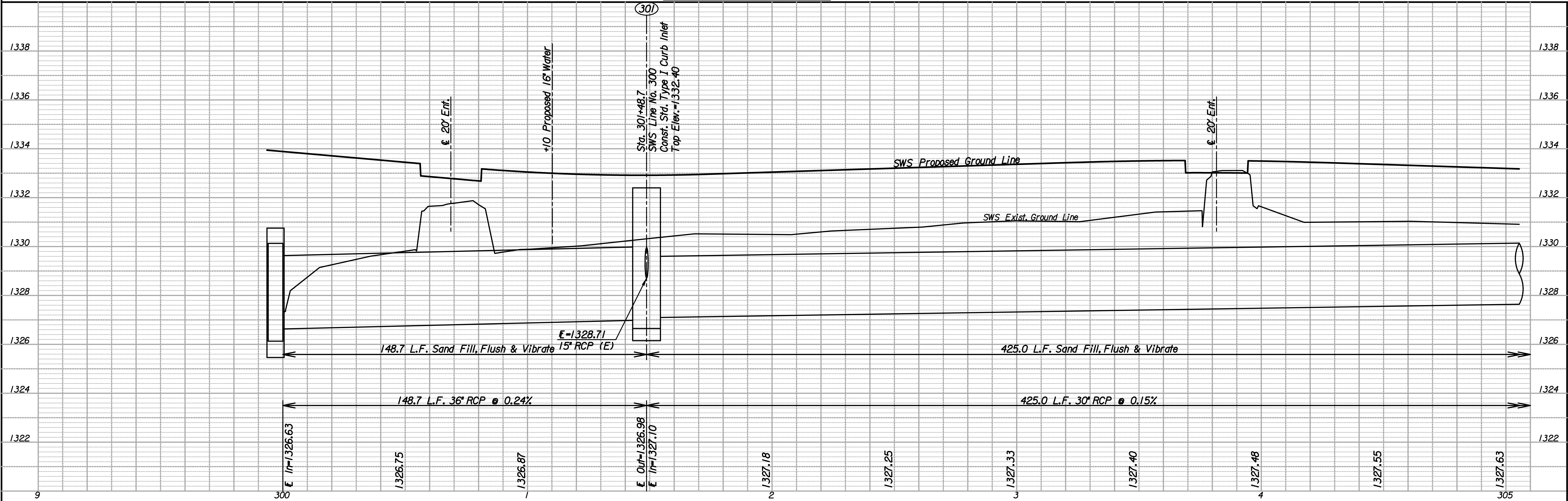

**STORM SEWER PLAN**  
 LINE NO. 300  
 STA. 300+00 TO STA. 305+00  
 C.O.W. PROJ. NO. 472-84684

Professional Engineering Consultants, P.A.  
 300 S. TORRECA AVENUE, KANSAS CITY, MO 64108  
 316.266.2591 • FAX 316.266.0600  
 Job No. 08208  
 Date: Sept., 2010  
 Designed by: JPS  
 Drawn by: SVB  
 Sheet 33 of 149

Plotted By: sub  
 Date: 1/21/2011 2:04:39 PM  
 FILE: I:\2008\08208\SWS\08208-SWS System 300-1.dgn