

Plotted By: svb Date: 1/24/2011 5:52:10 PM
 FILE: I:\2008\08208\Traffic Control\08208-TC Stage 2 234.dgn

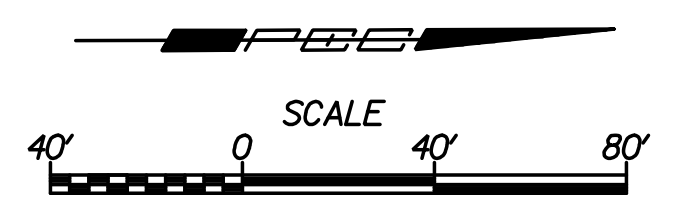
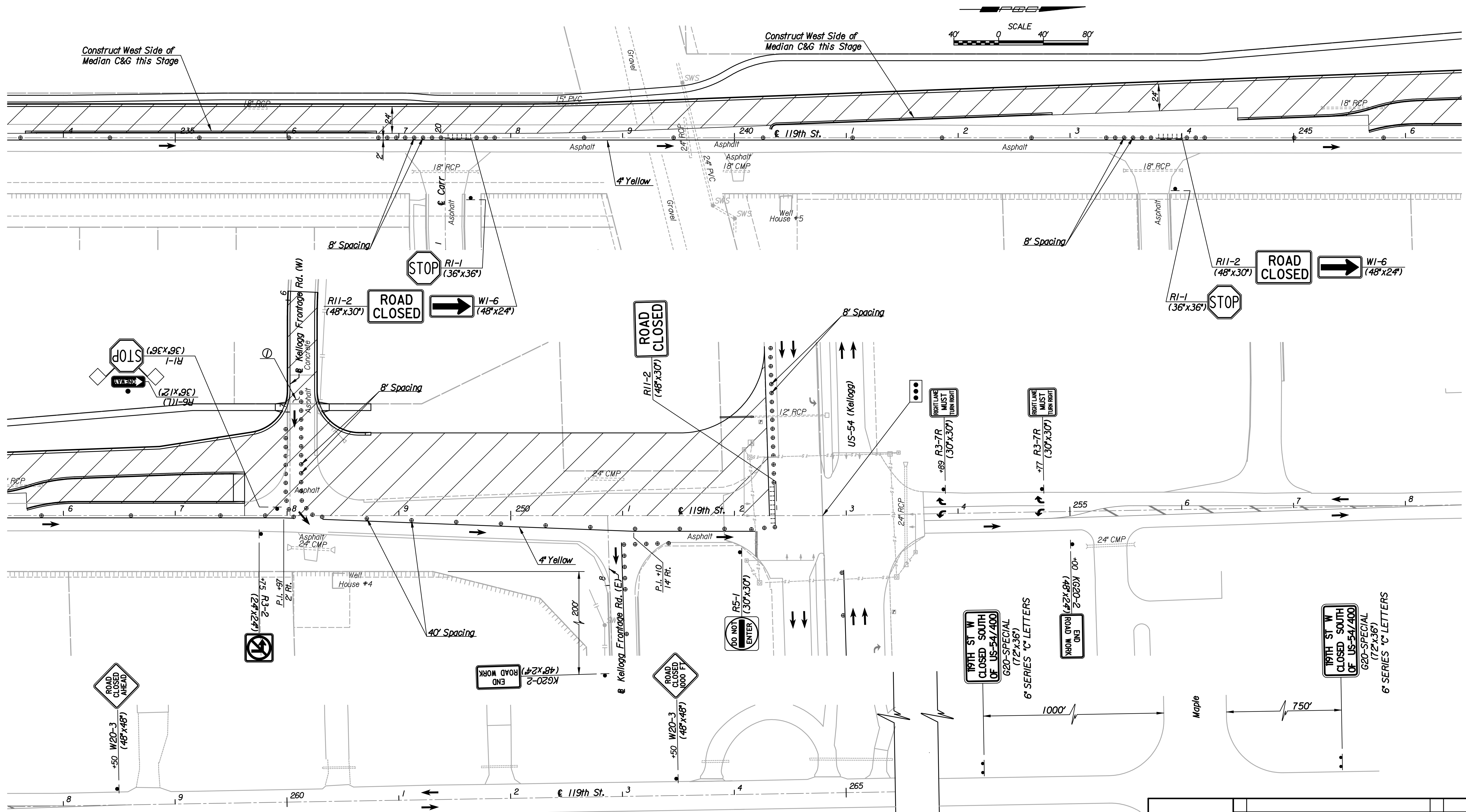

① Construct entrance half at a time. Provide traffic control per MUTCD (Latest Edition). Maintain all weather access at all times during construction. Additional traffic control required is Subsidiary.

Note: Utilities are not shown on Traffic Control Plans. The Contractor is responsible for verification as to type and location of underground utilities as may be necessary to avoid damage thereto. The Contractor is responsible for repairing any damage to underground utilities.

- LEGEND**
- × Tubular Marker
 - ⊙ Channelizing Device at 80' Spacing unless otherwise noted.
 - Traffic Control Sign
 - Red Type "B" High Intensity Warning Light
 - Contractor shall install Temporary Traffic Signal as required so that the intersection of Kellogg and 119th St. has a working signal at all times.

- ▤ Type III Barricades
- ▨ Work Area (New Pavement)
- Direction of Traffic

Note: Signs and barricades are shown diagrammatically only. Contractor will be responsible to install the required number of posts to support the installation.

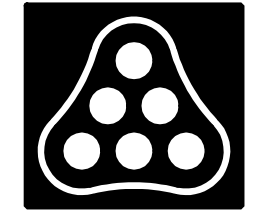

Revision		By		Date	
119TH ST.					
TRAFFIC CONTROL PLAN					
STAGE 2 - STA. 234+00 TO STA. 265+00					
JAMES L. ARMOUR, P.E. - CITY ENGINEER CITY OF WICHITA PROJECT NO. 472-84694					
Professional Engineering Consultants, P.A.					
303 S. TOPEKA - WICHITA, KANSAS 67202 316-262-2691 • FAX 316-262-3003					
Designed by	JPS	Job No.	08208		
Drawn by	SVB	Date	Sept., 2010	Sht. 97 of 149	