

Plotted By: svb Date: 1/25/2011 10:37:35 AM
 FILE: I:\2008\08208\Traffic Control\08208-TC Stage 3 210.dgn

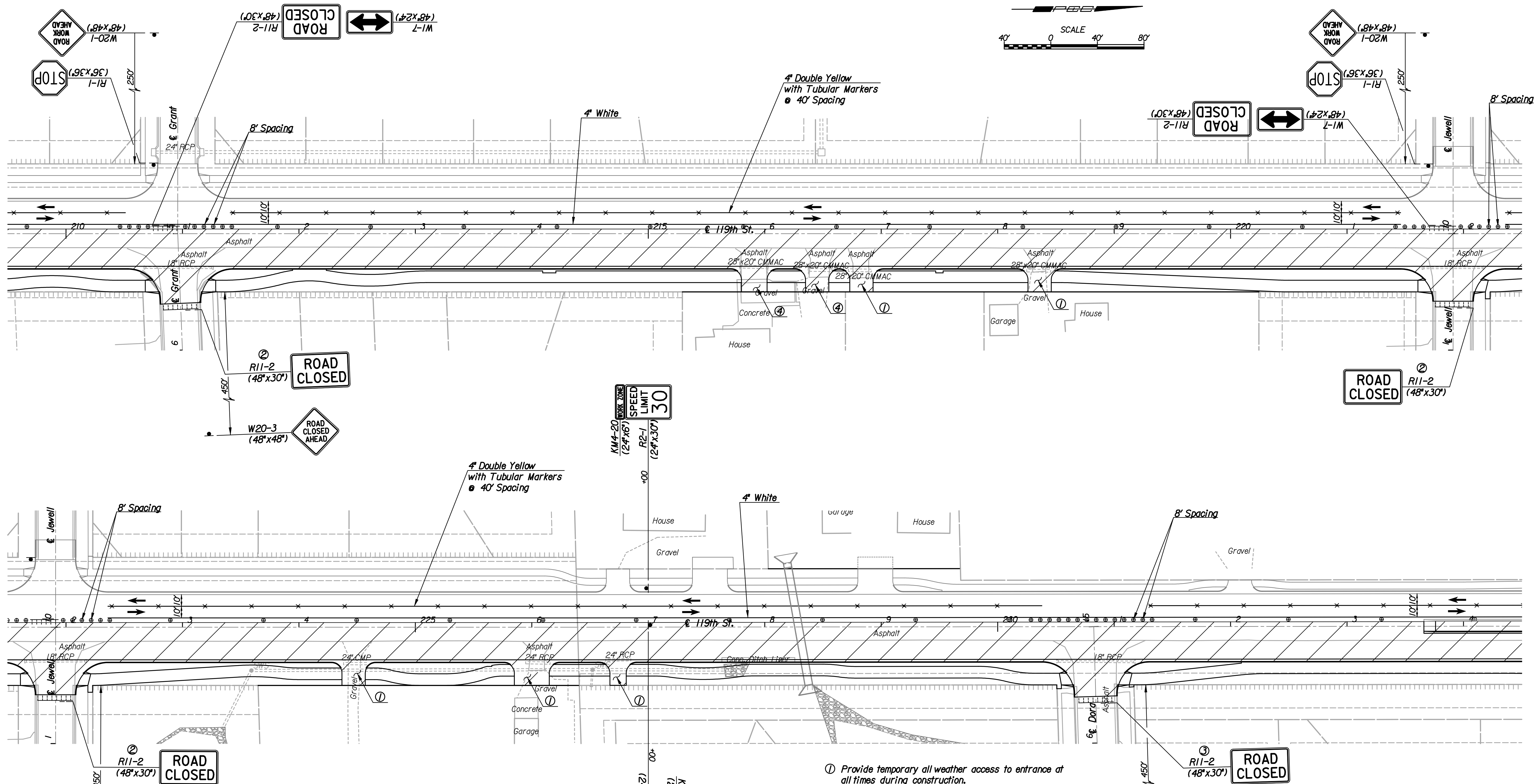

Note: Utilities are not shown on Traffic Control Plans. The Contractor is responsible for verification as to type and location of underground utilities as may be necessary to avoid damage thereto. The Contractor is responsible for repairing any damage to underground utilities.

- LEGEND**
- x Tubular Marker at 40' Spacing
 - o Channelizing Device at 80' Spacing unless otherwise Noted.
 - ▲ Traffic Control Sign
 - TTTTT Type III Barricades
 - ▨ Work Area (New Pavement)
 - Direction of Traffic

Notes: Signs and barricades are shown diagrammatically only. Contractor will be responsible to install the required number of posts to support the installation.

- ① Provide temporary all weather access to entrance at all times during construction.
- ② Contractor to provide access to neighborhood at all times via Grant and/or Jewell. Intersection work to be completed and opened to traffic as soon as possible. For traffic control when sideroad is open See Sh. No. 108. Additional traffic control required is Subsidiary.
- ③ Contractor to provide access to neighborhood at all times via Dora and/or Carr. Intersection work to be completed and opened to traffic as soon as possible. For traffic control when sideroad is open See Sh. No. 108. Additional traffic control required is Subsidiary.
- ④ Provide temporary all weather access to 1 of 2 entrances at all times during construction.

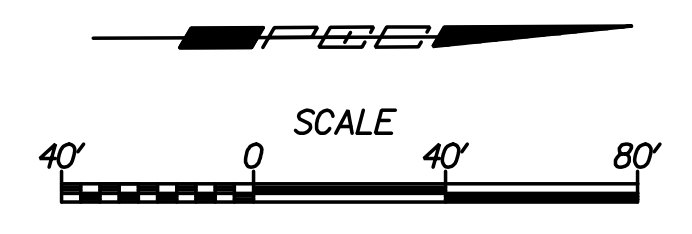

No.	Revision	By	Date
	119TH ST.		
TRAFFIC CONTROL PLAN			
STAGE 3 - STA. 210+00 TO STA. 234+00			
JAMES L. ARMOUR, P.E. - CITY ENGINEER CITY OF WICHITA PROJECT NO. 472-84694			
Professional Engineering Consultants, P.A. 303 S. TOPEKA - WICHITA, KANSAS 67202 316-262-2691 • FAX 316-262-3003			
Designed by	JPS	Job No.	08208
Drawn by	SVB	Date	Sept., 2010
			Sh. 103 of 149