

Proposed AT&T (Approx. location) AT&T to relocate and consolidate existing lines. The Contractor shall remove existing abandoned buried lines encountered, as required, that are in conflict with the proposed waterline installation. The Contractor shall coordinate with AT&T, Mr. John Fagan (316-268-2102), prior to beginning waterline installation.

N: 1,674,813.5118, E: 1,607,533.7658 @ 119th St., Sta. 226+21.56, 40.00' Lt. = WL 1, Sta. 15+78.17 1- 16" CI CL MJ 11 1/4" Bend Defl. = 11"18'40"

CAUTION !!! Buried Telephone (AT&T)

N: 1,674,839.6298, E: 1,607,528.6481 @ 119th St., Sta. 226+47.71, 45.21' Lt. = WL 1, Sta. 16+04.79 1- 16" CI CL MJ 11 1/4" Bend Defl. = 11"15'00"

CAUTION !!! Proposed 6" x 4" RCB Storm Sewer

N: 1,674,942.9963, E: 1,607,528.9431 WL 1, Sta. 17+08.15 to N: 1,675,082.8614, E: 1,607,529.3422 WL 1, Sta. 18+48.02 Install 139.87 L.F. 16" RJ DI Pipe**

N: 1,675,115.7079, E: 1,607,529.4359 @ 119th St., Sta. 229+23.79, 45.21' Lt. = WL 1, Sta. 18+80.86 1- 16" CI CL MJ 45" Bend Defl. = 45"00'00"

N: 1,675,136.8585, E: 1,607,550.7075 @ 119th St., Sta. 229+45.00, 24.00' Lt. = WL 1, Sta. 19+10.86 1- 16" CI CL MJ 45" Bend Defl. = 45"00'00"

** RJ DI Pipe shall be Griffin Snap-Lok, American Flex Ring, or approved equal, in accordance with City of Wichita Specifications.

X - Denotes Trees to be removed.

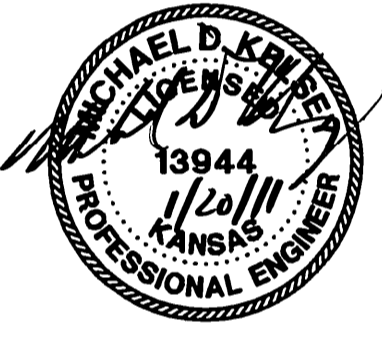

Unless noted otherwise, elevations shown are top of pipe

WATERLINE NO. 1

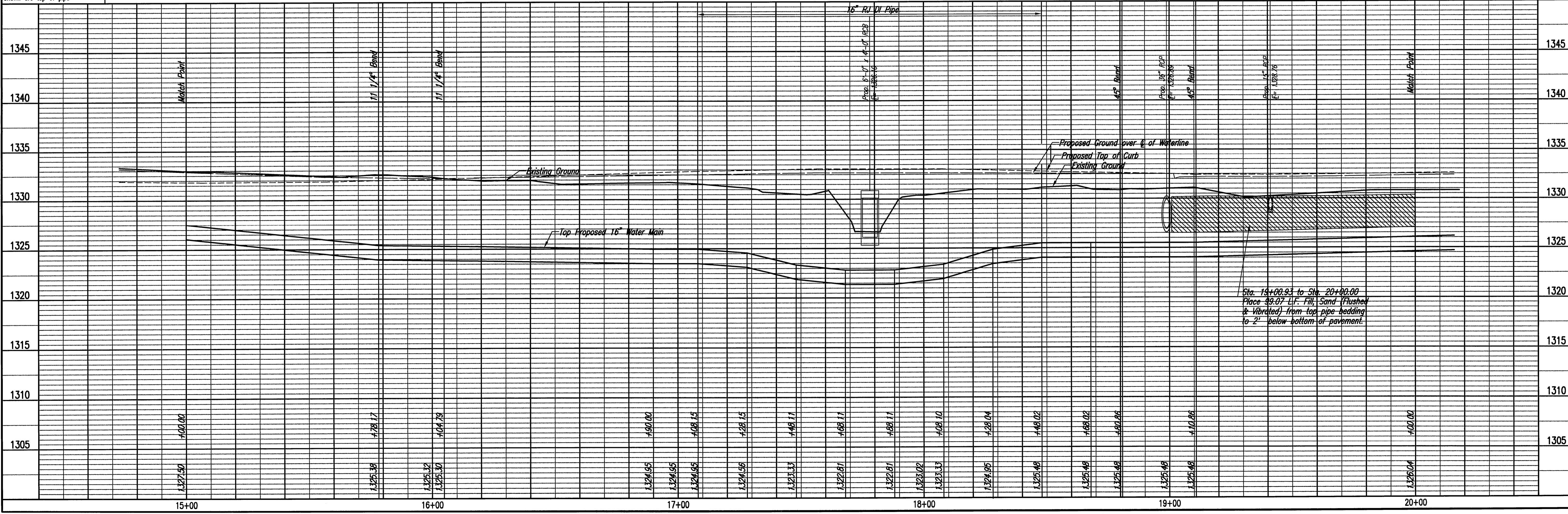

Sta. 19+00.93 to Sta. 20+00.00 Place 99.07 L.F. Fill, Sand (Flushed & Vibrated) from top pipe bedding to 2' below bottom of pavement.

DATE	BY	CHECKED

DATE	BY	CHECKED

Sheet 01 of 19 - 04-2011 8:42:47 AM by TDS
 Plot Scale: 1"=20'-0" 01-19-2011 9:33:39 AM by JED, D. SCRIEPIER
 C:\2008\08208\001\08208-001-C8.WPLOT4

Professional Engineering Consultants, P.A.
 303 S. TOPEKA AVENUE, WICHITA, KANSAS 67202
 316-262-2691 • FAX 316-262-3003

Job No. 35-08208-001
 Date April 2010

Designed By TDS
 Drawn By MDK

Sheet 88 of 15