

STORM WATER SEWER #656

TO SERVE 32ND ST. N. FROM MASCOT TO 300' EAST OF JACKSON AND MASCOT FROM N. LINE 32ND ST. N. TO 200' N. OF N. LINE 32ND ST. N.

PROJECT NUMBER 468-84678

OCA # 751492

GENERAL NOTES

- Contractor will be required to provide a minimum advance notice of seventy-two (72) hours to utility companies prior to starting any excavation as follows:

Kansas One-Call	811
-----------------	-----
- The Contractor must notify the following in case of an emergency:

Cox Communications	260-0661
Kansas Gas Service	888-482-4950
Westar	383-8600
AT&T	1-800-286-8313
Wichita Water Utilities	262-6000
Black Hills Energy	1-800-303-0357
- Rubble from the removal of miscellaneous structures and excess excavation which is to be wasted shall be disposed of on sites to be provided by the Contractor. These sites shall be approved by the Engineer as to suitability, appearance and site location. Locations that, in the opinion of the Engineer, will leave an unsightly appearance will not be approved.
- All disposal sites must be approved by the Kansas Department of Health and Environment. Material either stockpiled or disposed of in a flood plain would require a Kansas State Board of Agriculture permit. Any material dumped in waters of the United States or wetlands is subject to U.S. Corps permitting regulations. Any material buried or stockpiled beyond approved of Engineers construction limits would require additional archeological investigations unless buried in a previously approved borrow location.
- Limits of earthwork shall match existing ground elevations at the right-of-way line unless otherwise noted on the plans with a new finished grade elevation. When a new finished grade elevation is shown, the earthwork shall extend one foot beyond the right-of-way line and then sloped up or down using permissible slopes to match the existing ground surface.
- The Contractor shall be responsible for preserving property irons. The Contractor will be required to re-establish any property irons which are damaged or destroyed by his construction operations. Such irons shall be re-established by a licensed land surveyor in accordance with state laws.
- The Contractor shall give all property owners and/or tenants of developed property abutting the construction of this project a minimum of ten (10) days notice prior to start of construction and again 48 hours prior to any work actually starting.
- Contractor shall maintain local traffic only for the duration of the project. All traffic control shall be Subsidiary to the Lump Sum bid item 'Traffic Control'.
- Provide a full depth saw cut at locations where proposed construction abuts an existing surface course or pavement for which partial removal of that surface or pavement is required. Sawed joints to facilitate removal within three (3) feet of the existing joint will not be permitted and for such instances the limits of removal shall extend to the existing joint. Such saw cuts will not be paid for directly and this cost shall be considered as subsidiary to the removal of the surface or pavement.
- All lawn/turf areas disturbed by construction shall be restored with the same seed as existing. Restoration of disturbed areas shall include, but not limited to, top soil preparation and sodding. All sodding work shall be in accordance with City Standard specifications and the City Administrative Regulation No. 6.5, which governs cleanup and restoration or replacement following construction. Sod will be paid for by Lump Sum. When the weather/season prevents the installation of sod, the Contractor shall be responsible for installing Erosion Control Blanket (Curltex 1, or approved equal) at the back of curb (8' wide minimum).
- Underground utility service lines and overhead utility pole lines are to be adjusted as necessary by others prior to construction unless the plans specifically call for their adjustment by the Contractor or unless the plans specifically identify a utility to be adjusted by its owner during construction. Existing utilities and their location, as shown on the plans, represent the best information obtainable for design. Location information has been obtained from the various utility companies and is either from company record drawings or company-provided field locations. The Contractor will be required to work around existing utilities within the right-of-way which do not conflict with proposed construction.
- Trees and shrubs in public right-of-way which are in direct conflict with proposed new construction shall be removed by the Contractor with the Engineer's approval. Trees and shrubs which are not in direct conflict with proposed new construction shall be saved and protected from damage.

INDEX OF SHEETS

- TITLE SHEET
- LINE 1 PLAN AND PROFILE
- TYPE 1A INLET DETAIL
- TYPE 'P' MH DETAIL
- 4'x2' DROP INLET DETAIL
- RING & COVER DETAIL
- EROSION CONTROL PLAN
- EROSION CONTROL DETAILS

BENCHMARK

CHISELED SQUARE ON THE TOP OF CURB AT THE SOUTH CURB RETURN AT THE SOUTHEAST CORNER OF 33RD STREET N. AND ARKANSAS AVE.

ELEVATION: 1317.54 (NAVD 88)

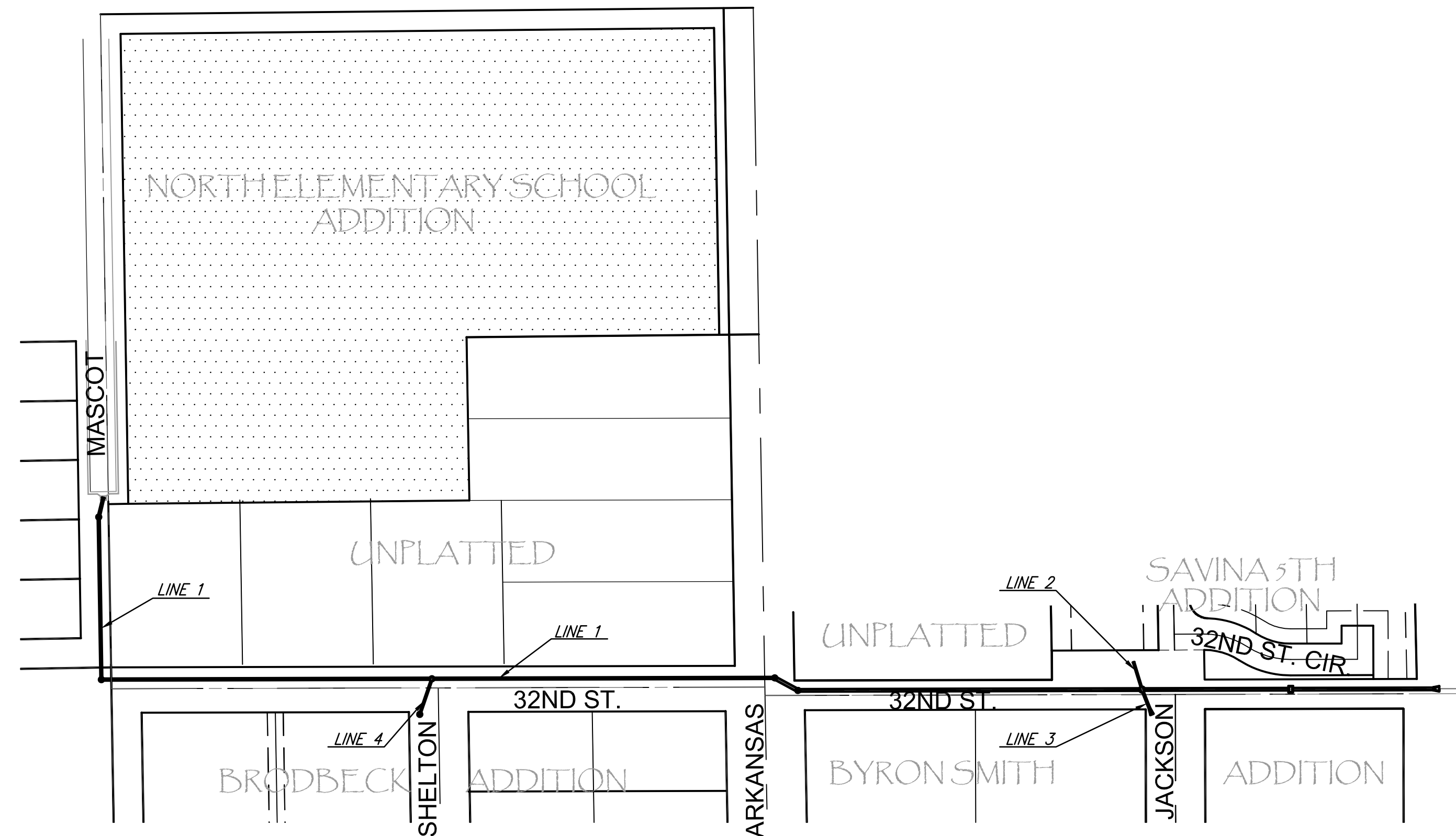

SCALE: 1"=100'

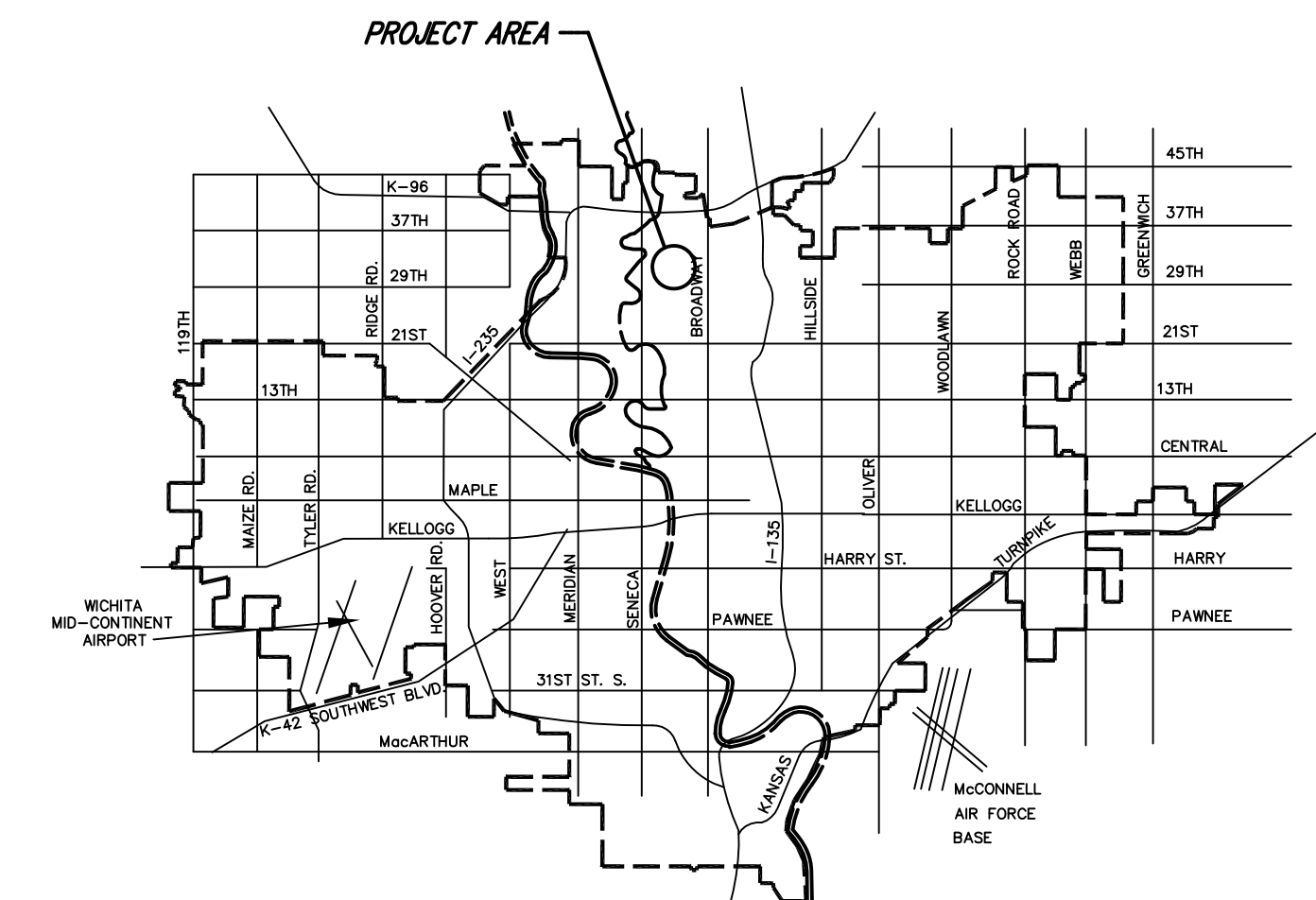

 **BENEFIT DISTRICT**



CITY OF WICHITA, KANSAS
JAMES L. ARMOUR, P.E. - CITY ENGINEER

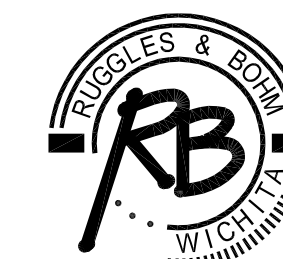

Ruggles & Bohm, P.A.
 Engineering, Surveying, Land Planning
 924 North Main (316) 264-8008
 Wichita, Kansas 67203 (316) 264-4621 fax
 www.rbkansas.com E-mail: info@rbkansas.com