

GENERAL NOTES

GEOGRID REINFORCEMENT SHALL BE B x 1100 GEOGRID AS MANUFACTURED BY TENSAR CORPORATION OR APPROVED EQUAL. GEOGRID REINFORCEMENT SHALL BE INSTALLED IN ACCORDANCE WITH MANUFACTURER'S RECOMMENDATIONS. CRUSHED ROCK SHALL BE UNIFORMLY GRADED FROM 1 1/2" MAXIMUM SIZE TO NOT MORE THAN 10% PASSING A NO. 200 SIEVE. ROCK QUALITY SHALL BE THE SAME AS SPECIFIED FOR COARSE AGGREGATE FOR CONCRETE MIXES.

ROCK BASE IS TO BE COMPACTED AND SMOOTHED WITH A STEEL FACED ROLLER PRIOR TO PLACEMENT OF ASPHALT. TACK COAT WILL NOT BE APPLIED TO ROCK BASE.

A TACK COAT OF EMULSIFIED ASPHALT (SC-1H OR CSS-1H) SHALL BE APPLIED AT AN APPROXIMATE RATE OF 0.05 GALLONS PER SQUARE YARD BETWEEN EACH LIFT OF ASPHALTIC MATERIAL.

BITUMINOUS BASE AND ASPHALTIC CONCRETE WEARING SURFACE SHALL BE PLACED WITH A LAYDOWN MACHINE HAVING AUTOMATIC CONTROLS FOR LINE AND GRADE.

TRANSVERSE CONSTRUCTION JOINTS IN EACH LIFT SHALL BE STAGGERED A MINIMUM DISTANCE OF ONE (1) FOOT FROM JOINTS IN PRECEDING LIFTS AND PLACED SO THAT A JOINT WILL BE CONSTRUCTED ON THE CENTERLINE OF THE TOP LIFT.

PUBLIC AND PRIVATE UTILITY FACILITIES SHALL BE MOVED OR ADJUSTED AS NECESSARY BY THE OWNERS TO FIT THE NEW CONSTRUCTION UNLESS OTHERWISE NOTED ON THE PLANS OR IN THE PROPOSAL.

ALL SAW CUTS SHOWN ON THE PLANS SHALL NOT BE PAID FOR DIRECTLY, BUT SHALL BE CONSIDERED SUBSIDIARY TO OTHER ITEMS OF THE CONTRACT. THE DEPTH OF THE CUT SHALL BE FULL DEPTH.

EXCAVATION SHOWN TO BE WASTED SHALL BE WASTED ON SITES PROVIDED BY THE CONTRACTOR. THESE SITES SHALL BE APPROVED BY THE ENGINEER AS TO SUITABILITY, APPEARANCE, AND SITE LOCATION. LOCATIONS THAT, IN THE OPINION OF THE ENGINEER, WILL LEAVE AN UNSIGHTLY APPEARANCE WILL NOT BE APPROVED.

CONCRETE COLLARS SHALL NOT BE PAID FOR DIRECTLY BUT SHALL BE SUBSIDIARY TO THE PROJECT.

FILL, FLUSH AND VIBRATE APPROVED SAND ALONG RCP AND UP TO 6" ABOVE RCP. ALL MATERIALS, LABOR, TOOLS, EQUIPMENT AND INCIDENTALS NECESSARY TO COMPLETE THE WORK SHALL BE SUBSIDIARY TO THE BID ITEM "SAND FILL, FLUSH & VIBRATE".

ALL DISPOSAL SITES MUST BE APPROVED BY THE KANSAS DEPARTMENT OF HEALTH AND ENVIRONMENT. MATERIAL EITHER STOCKPILED OR DISPOSED OF IN A FLOOD PLAIN WOULD REQUIRE A KANSAS STATE BOARD OF AGRICULTURE PERMIT. ANY MATERIAL DUMPED IN WATERS OF THE UNITED STATES OR WETLANDS IS SUBJECT TO U.S. CORPS OF ENGINEERS PERMITTING REGULATIONS.

ANY MATERIAL BURIED OR STOCKPILED BEYOND APPROVED CONSTRUCTION LIMITS WOULD REQUIRE ADDITIONAL ARCHEOLOGICAL INVESTIGATIONS UNLESS BURIED IN A PREVIOUSLY APPROVED BORROW LOCATION.

EXISTING PAVEMENT (CONCRETE AND ASPHALT) EXCAVATED AS PART OF THIS PROJECT SHALL BECOME THE PROPERTY OF THE CONTRACTOR AND BE DISPOSED OF ON SITES APPROVED BY THE ENGINEER.

ALL CONNECTIONS OF EXISTING PIPE TO NEW STRUCTURES OR NEW PIPE TO EXISTING STRUCTURES SHALL BE CONSIDERED SUBSIDIARY TO THE STORM SEWER BID ITEM.

EXISTING STREET SIGNS SHALL BE REMOVED AND DELIVERED INTACT TO THE CITY OF WICHITA MAINTENANCE FACILITY, 1801 S. MCLEAN, WICHITA, KS.

ALL EXISTING CULVERT PIPES NOT IDENTIFIED TO BE SALVAGED SHALL BECOME PROPERTY OF THE CONTRACTOR.

SEDIMENT IN EXISTING PIPE OR STRUCTURES CONNECTING TO NEW PIPE OR STRUCTURES SHALL BE CLEANED OUT. ALL LABOR, EQUIPMENT, AND MATERIALS USED FOR SEDIMENT REMOVAL SHALL BE SUBSIDIARY TO THE BID ITEM "CLEAN EXISTING STRUCTURES."

EXISTING UTILITIES AND THEIR LOCATIONS, AS SHOWN ON THE PLANS, REPRESENT THE BEST INFORMATION OBTAINABLE FOR DESIGN. LOCATION INFORMATION HAS BEEN OBTAINED FROM THE VARIOUS UTILITY COMPANIES AND IS EITHER FROM COMPANY RECORD DRAWINGS OR COMPANY-PROVIDED FIELD LOCATIONS. THE CONTRACTOR WILL BE REQUIRED TO WORK AROUND EXISTING UTILITIES WHICH DO NOT CONFLICT WITH PROPOSED CONSTRUCTION.

THE CONTRACTOR SHALL VERIFY UTILITY LOCATIONS PRIOR TO CONSTRUCTION OF THIS PROJECT.

UTILITY CONTACTS:

JOHN FAGEN
AT & T DISTRIBUTION
154 N. BROADWAY
WICHITA, KS 67202
316-268-2245

MILES CAPPS
WESTAR ENERGY
P.O. BOX 208
WICHITA, KS 67201
316-261-6824

MARC HENDERSON
COX COMMUNICATIONS
701 EAST DOUGLAS
WICHITA, KS 67202
316-262-4270 / 263-2061

JAMES COE
KANSAS GAS SERVICE
1021 EAST 26TH STREET NORTH
WICHITA, KS 67219
316-832-3126

GREG LOLLEY
WICHITA WATER DEPARTMENT
455 NORTH MAIN, 8TH FLOOR
WICHITA, KS 67202
316-268-4555

TRANSVERSE CONSTRUCTION JOINTS

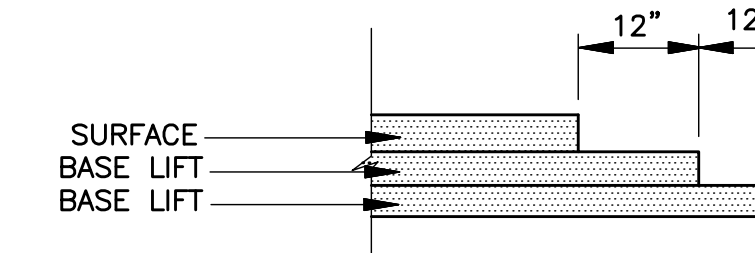

TRANSVERSE CONSTRUCTION JOINTS SHALL BE CONSTRUCTED IN FLEXIBLE BASE PAVEMENTS AT LOCATIONS WHERE PAVEMENT JOINTS EXISTING FLEXIBLE BASE PAVEMENT AS SHOWN BY THE DETAIL. ALL COSTS ASSOCIATED WITH THE CONSTRUCTION OF THE TRANSVERSE JOINT SHALL BE INCLUDED IN THE BID PRICE FOR SQUARE YARDS 5" ASPHALTIC CONCRETE PAVEMENT (3" BITUMINOUS BASE)

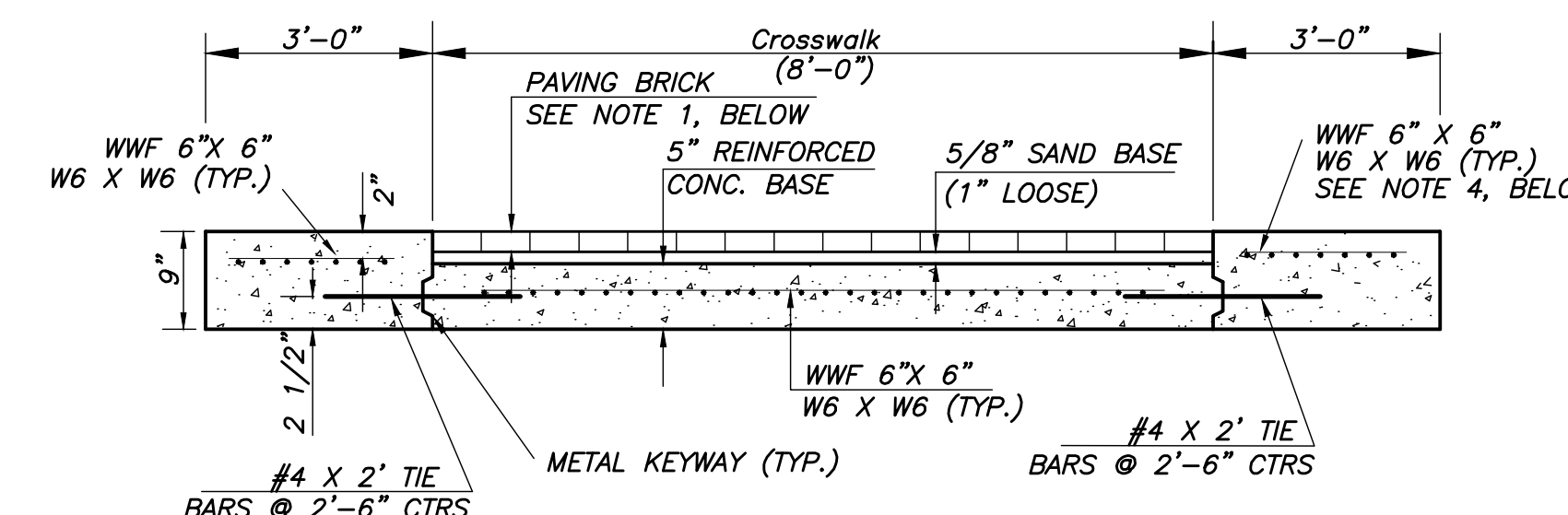

CROSSWALK SECTION w/ BRICK PAVERS
Sta. 106+74.54 to Sta. 106+88.54

GENERAL NOTES

- Interlocking Concrete Paving Stones (ASTM C936-82) used shall be Holland Stone Style consisting of full stones (8" X 4" X 3 1/8"). Color of Paving Stones shall be Charcoal-Red (natural, brown, sandstone, charcoal, red/black blend).
- 5/8" sand base shall be Subsidiary to "Brick Paver Crosswalks".
- This reinforcement to be placed in concrete panels adjacent to brick crosswalk and is Subsidiary to "Brick Paver Crosswalks".
- 5" Reinforced Concrete Base shall be paid for under Bid Item 9"-Conc. Pavement (AE)
- Additional work involved in forming pavement for Paving Brick will be Subsidiary to "Brick Paver Crosswalks".

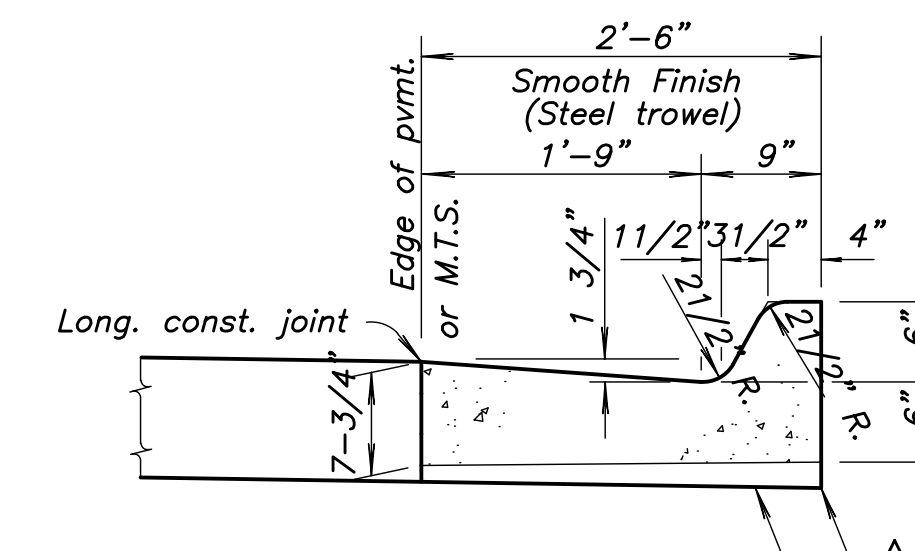

EXTENSION OF PAVEMENT SUBGRADE TYPICAL SECTION
Note: Conc. C.&G. | contains 0.060 cu. yds. Conc. Grade 3.0 (AE) per lin.ft.

COMBINED CURB & GUTTER - TYPE I (2'-6" WIDTH)

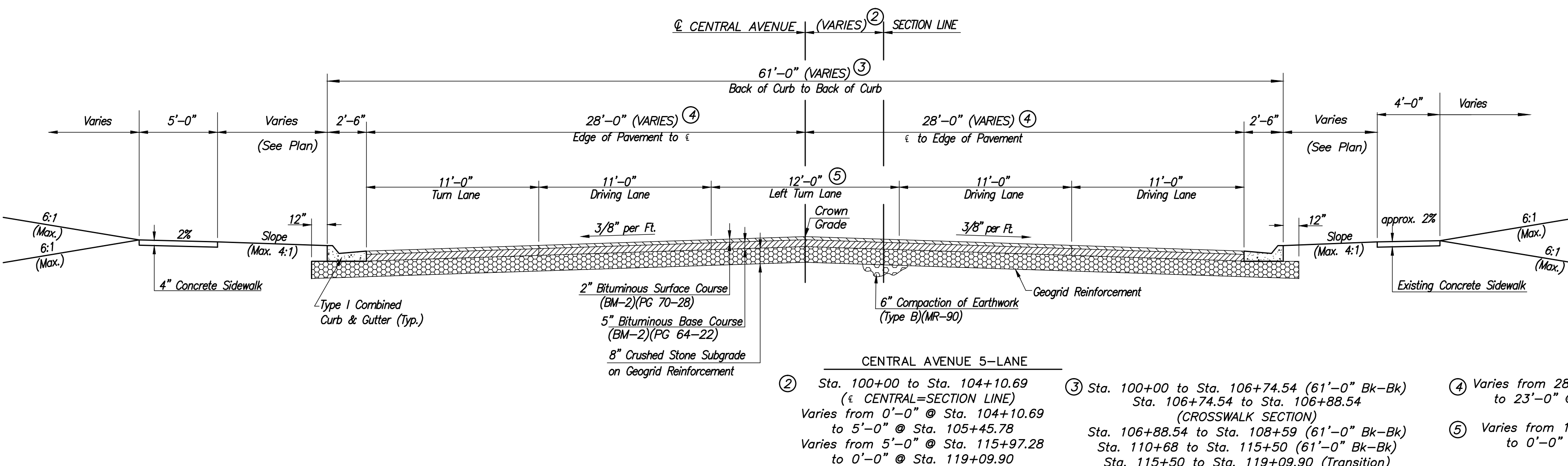

CENTRAL AVENUE 5-LANE
Sta. 100+00 to Sta. 108+59 & Sta. 110+68 to Sta. 119+09.90

NOTE:
The 6" Type-B MR-90 Compaction in cuts shall be considered similar to Foundation Treatment and paid for as Subsidiary to other items of work.

- ② Sta. 100+00 to Sta. 104+10.69 (CENTRAL=SECTION LINE)
Varies from 0'-0" @ Sta. 104+10.69 to 5'-0" @ Sta. 105+45.78
Varies from 5'-0" @ Sta. 115+97.28 to 0'-0" @ Sta. 119+09.90
- ③ Sta. 100+00 to Sta. 106+74.54 (61'-0" Bk-Bk)
Sta. 106+74.54 to Sta. 106+88.54 (CROSSWALK SECTION)
Sta. 106+88.54 to Sta. 108+59 (61'-0" Bk-Bk)
Sta. 110+68 to Sta. 115+50 (61'-0" Bk-Bk)
Sta. 115+50 to Sta. 119+09.90 (Transition)
- ④ Varies from 28'-0" @ Sta. 115+50 to 23'-0" @ Sta. 119+09.90
- ⑤ Varies from 12'-0" @ Sta. 115+50 to 0'-0" @ Sta. 119+09.90

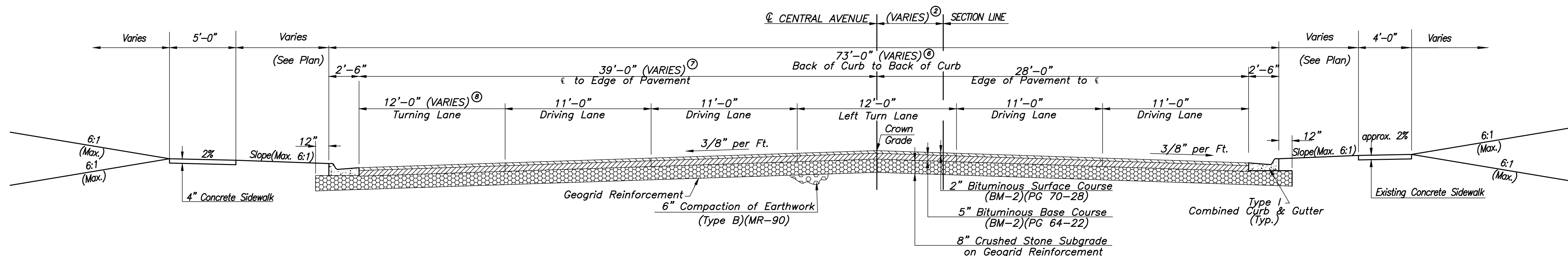

CENTRAL AVENUE 5-LANE W/LEFT TURN BAY
Sta. 108+59 to Sta. 110+68

5-LANE W/ TURN LANE TO LEFT

- ⑥ Sta. 108+59 to Sta. 109+68 (73'-0" Bk-Bk)
Sta. 109+68 to Sta. 110+68 (Transition)
- ⑦ Varies 40'-0" @ Sta. 109+68 to 28'-0" @ Sta. 110+68
- ⑧ Varies 12'-0" @ Sta. 109+68 to 0'-0" @ Sta. 110+68

CENTRAL AVENUE
 ROCK ROAD TO WEBB ROAD
 TYPICAL SECTIONS/GENERAL NOTES
 CITY OF WICHITA, KANSAS
 JAMES L. ARMOUR, P.E. - CITY ENGINEER

POE & ASSOCIATES, INC.
 CONSULTING ENGINEERS
 5940 E. Central, Suite 200 • Wichita, KS 67208-4242
 Phone: 316/685-4114 • FAX: 316/685-4444

POE

ENGINEER: P. FERGUSON
 DESIGNER: P. FERGUSON/M. TUCKER
 POE Job No.: 1972
 Date: MARCH 2011

Sheet 2 of 69