

q:\10-0992 nvr wichita panda express\dwg\project\3-city-revisions\date 020311\10-0992r5.dwg - Plotted on 2/22/2011 3:20:33 PM @ a scale of 1:1 to htp designplot 1050c by hp by Scott Magee

MAIZE ROAD N.

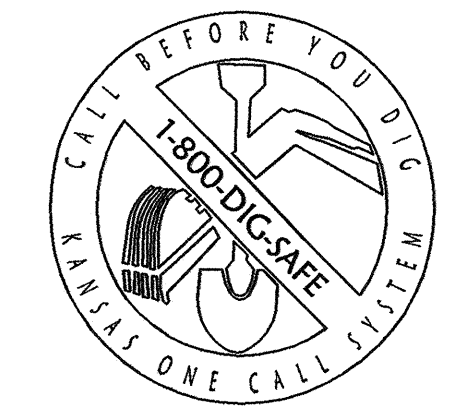
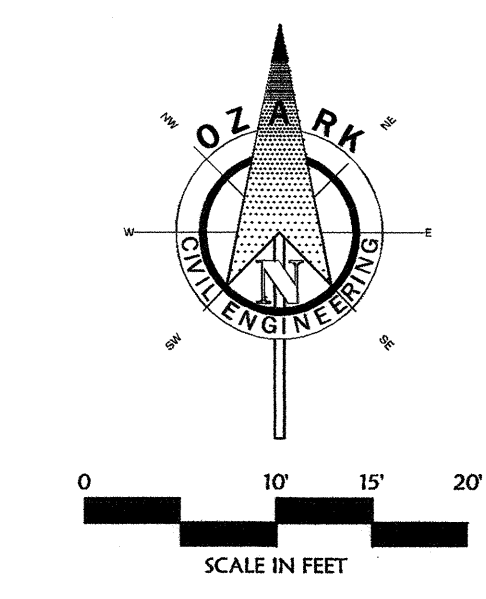
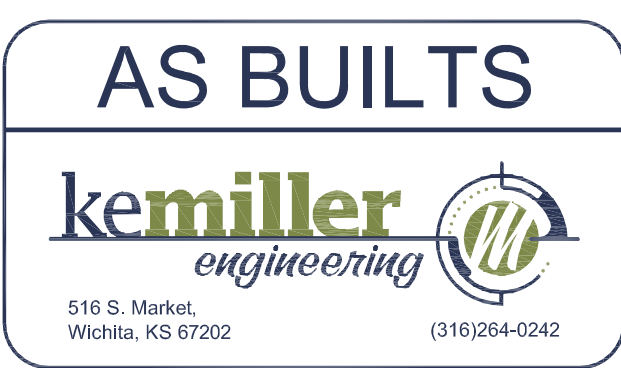

SITE DATA	
Acres:	Panda Express Proposed Acreage 0.6477 AC
	Panda Express Proposed SF 28,215 SF
Building SF:	2448 SF
Parking Requirements:	
Local Parking Required	
Standard	23
Handicapped	1
Total Parking Required (1 sp/3 Occupants)	24
(Occupancy - 72)	
Parking Provided	
Standard	35
Handicapped	2
Total Parking Provided	37

SITE PROPOSED FEATURES	
	BOUNDARY LINE
	RIGHT OF WAY LINE
	EASEMENT LINE
	CONCRETE CURB AND GUTTER
	FENCE
	GUARD RAIL
	RETAINING WALL
	LOCATION OF BUILDING CONTROL POINT
	PROPOSED PARKING SPACE COUNTER
	DROP INLETS (SEE GRADING PLAN FOR TYPES)
	SANITARY SEWER MANHOLE
	PROPOSED LIGHT POLE AND FIXTURE
	UTILITY POLE
	LIGHT DUTY CONCRETE CAR PARKING AND DRIVE AREAS
	MEDIUM DUTY CONCRETE TRUCK DRIVE AREAS
	HEAVY DUTY CONCRETE DUMPSTER APRON
	CONCRETE SIDEWALK
	DRY CONCRETE CURB AND GUTTER

SITE GENERAL NOTES:

COORDINATE LIST IF ANY ON THIS PLAN ARE FOR INFORMATION AND CHECKING PURPOSES ONLY. IT IS THE CONTRACTOR'S RESPONSIBILITY TO CALCULATE CONSTRUCTION STATIONING COORDINATES ACCORDING TO THE DIMENSIONS SHOWN ON THESE PLANS. THE CONTRACTOR SHALL VERIFY THE ACCURACY OF THE COORDINATES SHOWN ON THIS PLAN BEFORE CONSTRUCTION STARTS.

EXCEPT WHERE INDICATED OTHERWISE, PAVING SHALL BE STANDARD DUTY CONCRETE PAVING.

UNLESS OTHERWISE NOTED, ALL CURB INDICATED SHALL BE MONOLITHIC CONCRETE CURB AND GUTTER.

ALL PARKING SPACES INDICATED AS HANDICAPPED SPACES SHALL BECEP HANDICAP PAVEMENT MARKINGS AND SIGNS AS INDICATED ON THE DETAIL SHEETS PER DETAIL(S) - STALLS LABELED "VAN" TO RECEIVE A "VAN ACCESSIBLE" SIGN IN ADDITION TO THE ABOVE.

THE CONTRACTOR SHALL REFER TO THE ARCHITECTURAL PLANS FOR EXACT LOCATIONS, DIMENSIONS AND EXACT BUILDING UTILITY ENTRANCE POINTS.

PAINTED TRAFFIC ARROWS AND ALL SIGNS, PAVEMENT MARKINGS ETC. SHALL BE APPLIED ACCORDING TO REQUIREMENTS AS OUTLINED IN SECTION 3B OF THE MUTCD FOR STREET & HIGHWAYS.

GENERAL CONTRACTOR SHALL COORDINATE AND COMPLY WITH ALL UTILITY COMPANIES INVOLVED IN PROJECT AND PAY ALL REQUIRED FEES AND COSTS.

FOR SITE UTILITIES, SEE UTILITY PLAN.

ALL RADII SHALL BE 4' UNLESS OTHERWISE NOTED.

ALL DIMENSIONS, UNLESS OTHERWISE NOTED, ARE THE FACE OF CURB DIMENSIONS, ARE TO THE FACE OF CURB, FACE OF BUILDING OR CENTERLINE OF STREET.

SITE NOTES	
XXX	Items labeled by the following symbols are shown on this sheet.
	TAPER CURB TO MATCH EXISTING
	END OF CURB
	4' WIDE PAINTED STRIPES, 2' O.C. @ 45°
	EDGE OF PAVEMENT

SITE DETAILS	
	CONCRETE CURB & GUTTER FOR MONOLITHIC CONCRETE
	CONCRETE CURB & GUTTER
	ADA STALL MARKING
	TYPICAL SIDEWALK DETAIL
	HANDICAP PARKING SIGN
	PARKING STALL STRIPING
	DRIVE-THRU LANE STRIPING
	PAVEMENT MARKING STOP W/ BAR
	"DO NOT ENTER" SIGN
	STOP SIGN DETAIL
	TANGENT CURB RAMP
	LIGHT DUTY CONCRETE CAR PARKING AND DRIVE AREAS
	MEDIUM DUTY CONCRETE TRUCK DRIVE AREAS
	HEAVY DUTY CONCRETE DUMPSTER APRON
	PAVEMENT MARKING
	"DO NOT ENTER" SIGN
	STANDARD CROSSWALKS
	SIDEWALK WITH RAMP CONDITIONS

OM4-1 MUTCD - END OF PAVEMENT MARKER

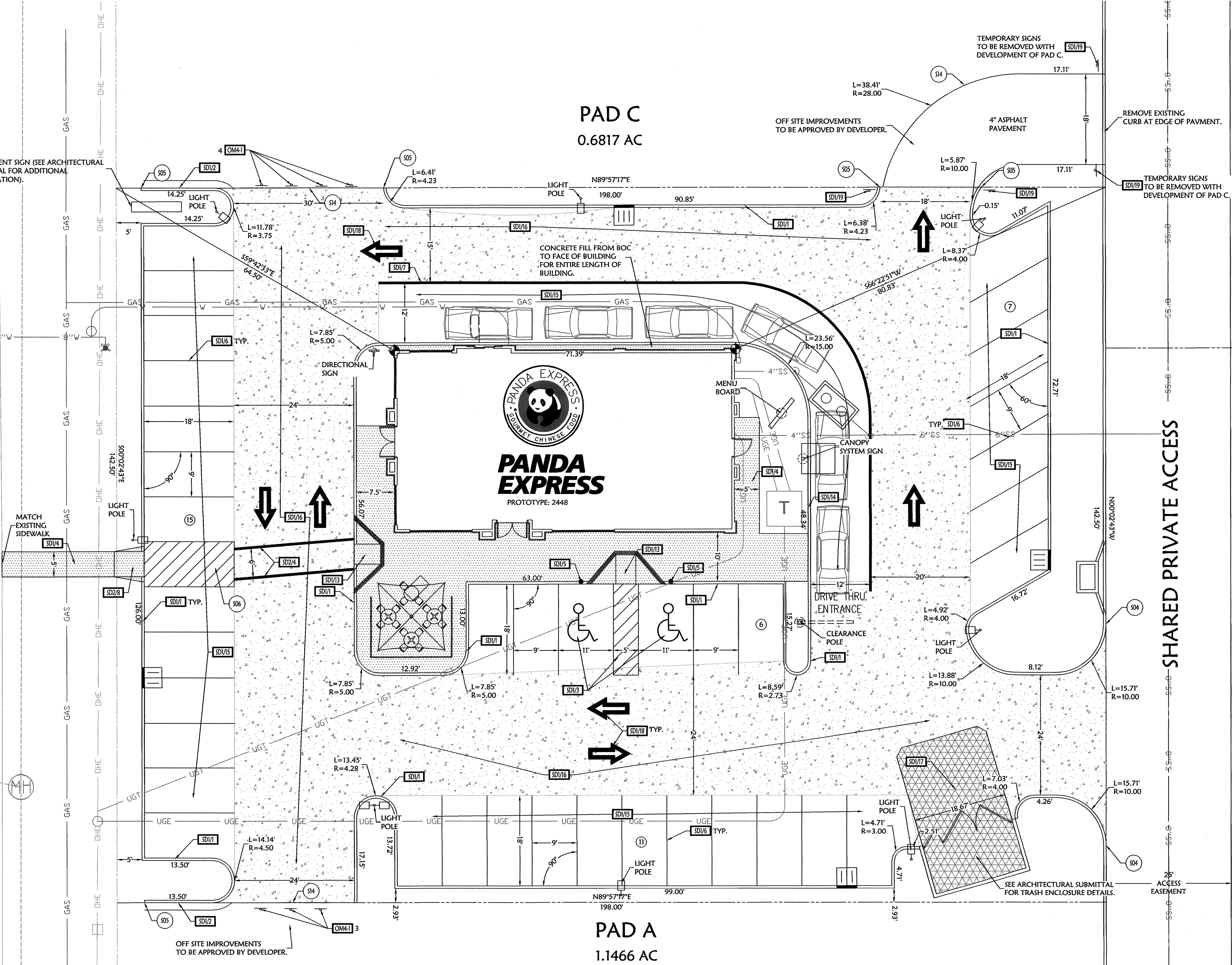

DATE	DESCRIPTION
12/17/10	ADDED PEDESTRIAN ACCES PER CITY COMMENTS

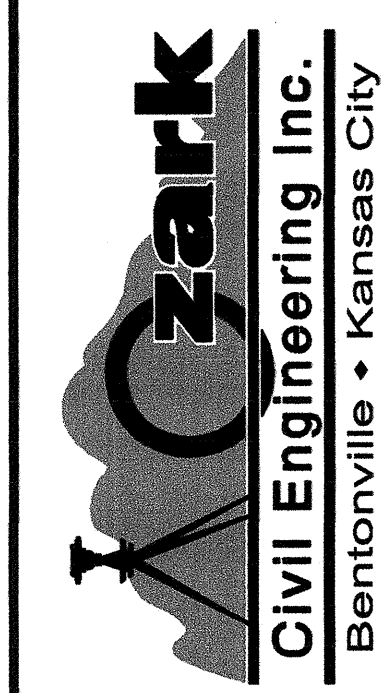
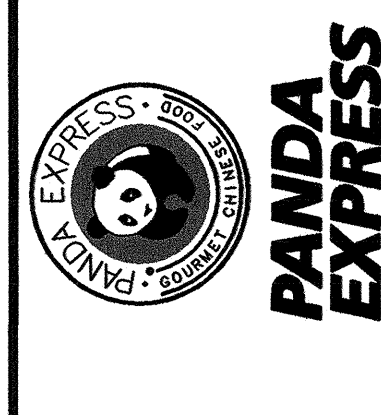
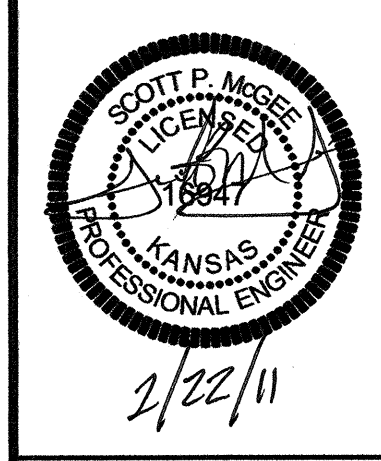

SITE PLAN

A NEW RESTAURANT FOR:
PANDA EXPRESS

2760 N. MAIZE ROAD
WICHITA, KS

DRAWN BY: EDH
APPV. BY: SPM
DWG. NAME: 10-0993PRE
DATE: 10/25/10
JOB NO.: 10-0993
SHEET NO.:

C-2