

PLAN NOTES:

1. FIELD VERIFY EXISTING CONDITIONS AND DIMENSIONS.
2. COORDINATE CONDUIT ROUTING WITH EXISTING UTILITIES AND CONDITIONS.

KEYED NOTES:

- ① (1) 2" RGS CONDUIT FOR STREET LIGHTING CIRCUITING AND POLE MOUNTED RECEPTACLE CIRCUITING.
- ② FIELD VERIFY EXACT LOCATIONS OF POLE FIXTURE WITH CITY PRIOR TO ROUGH-IN.

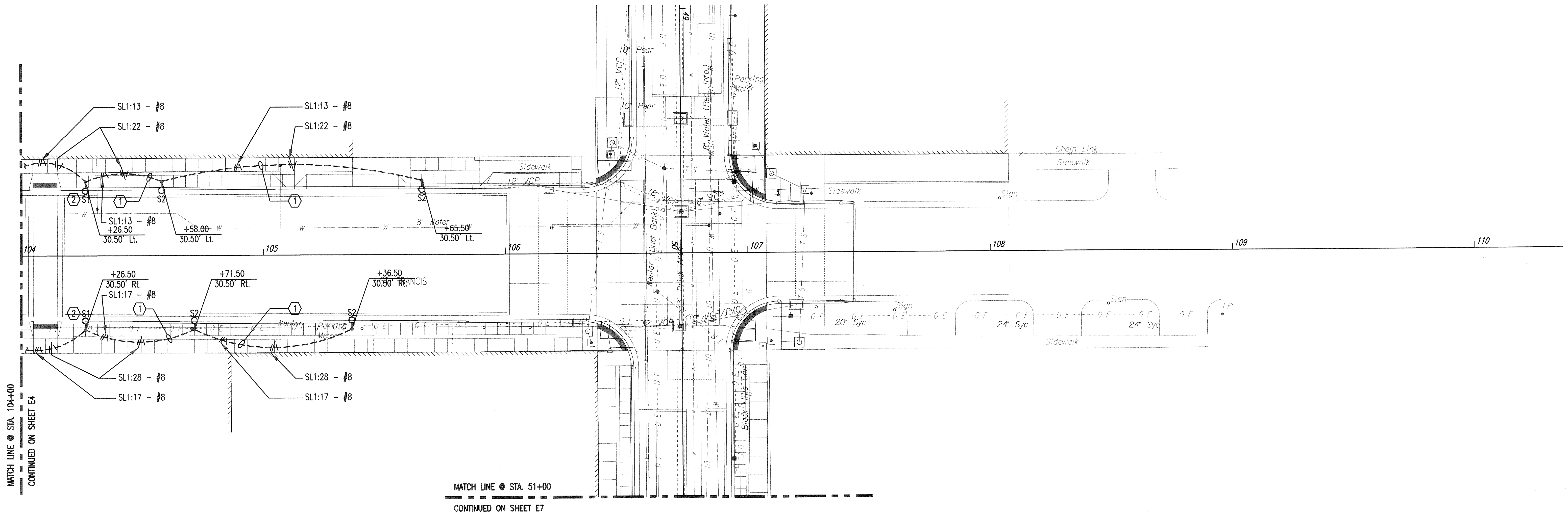

A ELECTRICAL STREET PLAN STA. 104+00 TO 110+00

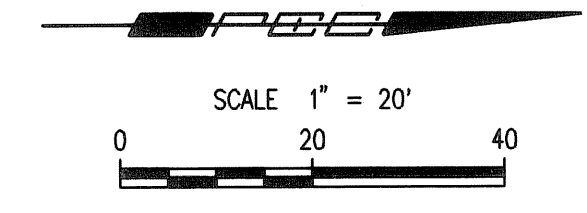

No.	Revision	By	Date
ST. FRANCIS STREET ELECTRICAL STREET PLAN STA. 104+00 TO STA. 110+00 JAMES L. ARMOUR, P.E. - CITY ENGINEER CITY OF WICHITA PROJECT NO. 472-84920			
Designed by	SMS	Job No.	10310
Drawn by	ADM	Date	JULY 2011
			Sht. E5 of 7

Saved 07-20-2011 9:59:31 AM by ADM
 Plot Scale: 1/4" = 20'
 J:\S\0101\2010\10310\2011-07-20 Revised Plans to COM\Electrical\005-ELEC STA 104 TO 110