

BENCHMARKS

BENCHMARK #1:
COW Disk at NW return 2nd St. & Anna.
Elev. = 1307.50 (NAVD 88)

BENCHMARK #2:
"X" cut in curb SW return of 1st st. & BeBee.
Elev. = 1305.47 (NAVD 88)

W.L. Sta. 0+00.00, PVI, Begin Line 3 =
B.L. Sta. 4+32.22, 124.45' Lt.
Tap Existing 8" Water Line.
1-8"x8" Tapping Sleeve.
1-8" Tapping Valve w/Valve Box
To Be Furnished & Installed By
The City Of Wichita Water Dept.
(Contractor To Reimburse Water
Dept. For Tapping Sleeve, Valve &
Installation \$1830.00)
Valve Box Elevation = 1305.90
11.25' CIMJ Bend Down.
Extend 8" Water Line South.

CAUTION!
Verify Location & Depth Of
Water Line Prior To Construction.
Make Proposed Water Line
Adjustments As Necessary.

CAUTION!
Proposed Gas Service Line.
Proposed Depth Unknown.

CAUTION! VERIFY!
15" Sanitary Sewer Crossing.
Depth By Interpellation Between
Manholes.

W.L. Sta. 0+46.31, Line 3 =
B.L. Sta. 4+78.52, 125.17' Lt.
End Directional Bore.

W.L. Sta. 0+53.89, Line 3 =
W.L. Sta. 0+00.00, Line 4 =
B.L. Sta. 4+86.11, 125.29' Lt.
1-CIMJ 8"x6" Tee. **CLOW**
1-6" Anchored Valve Assembly (W)
Valve Box Elevation = 1307.80

CAUTION! VERIFY!
Power Line. Depth Unknown.
If Conflict Exists, Contractor
To Provide Fittings, Pipe, Etc.
To Adjust Water Line Alignment
& Depth As Necessary.

W.L. Sta. 0+59.89, PVI, Line 3 =
B.L. Sta. 4+92.11, 125.38' Lt.
1-8" Line Valve Assembly **CLOW**
Valve Box Elevation = 1307.80

CAUTION!
Proposed 18" RCP.
Proposed Depth Per Plan.

W.L. Sta. 2+39.98, End Line 4 =
B.L. Sta. 6+87.20, 138.48' Lt.
Anchored 90' CIMJ Bend Up.
6" DICL Pipe w/Flanged End & 2"
Threaded Outlet. Flange To Be
Positioned No Lower Than 1' Above
FFE. 1-Temporary 2" Blow Off
Assembly. Backflow Preventor In
Building By Others.

CAUTION!
Location Of 90' Bend Up
May Not Be Exact. Contractor
Shall Coordinate With Mechanical
Contractor To Determine Exact
Location Of 90' Bend.

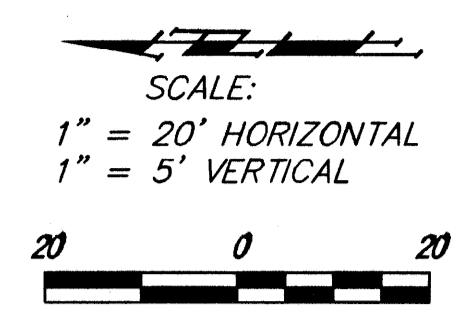

Contractor Shall Follow All Applicable
Best Management Practices (BMP)
For Erosion Control.

Contractor To Use Extreme Caution
When Excavating Near Utility Lines.
Contractor To Hand Dig To Expose
All Utility Lines Prior To Construction.
Verify Depth To Determine Conflict If Any.

CAUTION! VERIFY!
36"x72" RCBC Crossing.
Depth By Interpellation
Between Manholes.

CAUTION!
Overhead Power
Lines.

Northwest Corner Lot 1, Block A,
Dodge Elementary Addition =
B.L. Sta. 5+00.

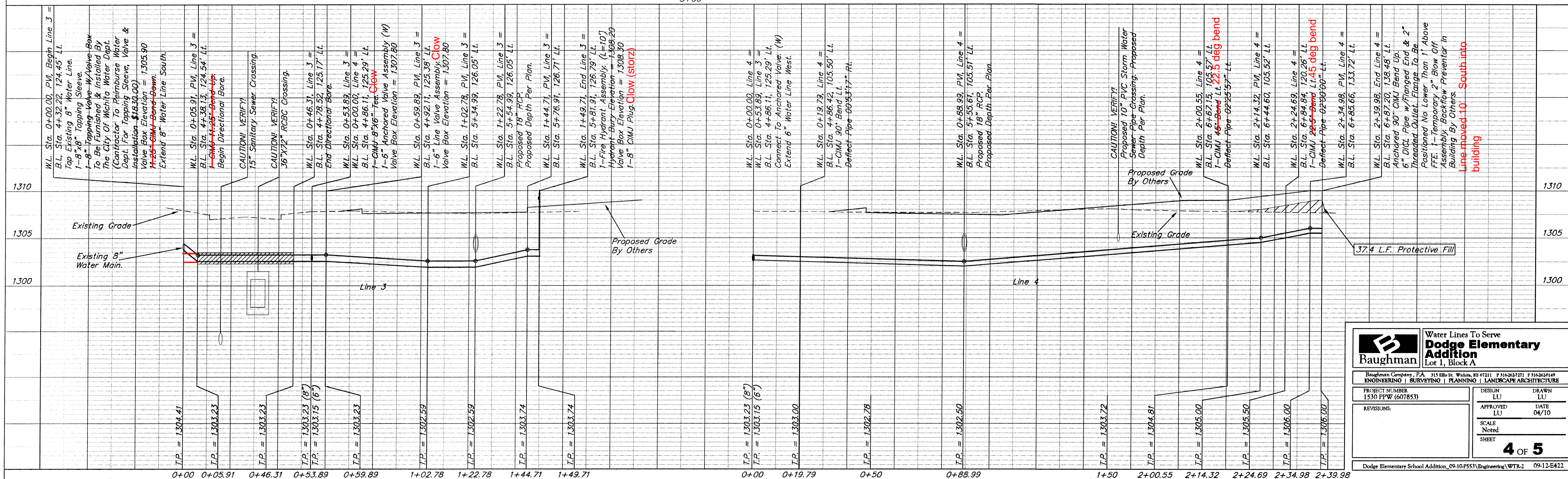
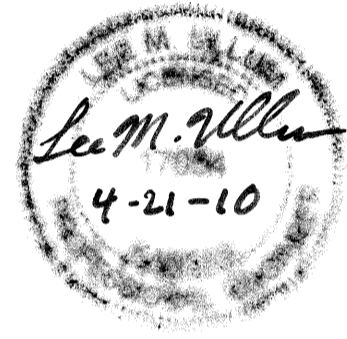

W.L. Sta. 0+00.00, PVI, Begin Line 3 = B.L. Sta. 4+32.22, 124.45' Lt. Tap Existing 8" Water Line. 1-8"x8" Tapping Sleeve. 1-8" Tapping Valve w/Valve Box To Be Furnished & Installed By The City Of Wichita Water Dept. (Contractor To Reimburse Water Dept. For Tapping Sleeve, Valve & Installation \$1830.00) Valve Box Elevation = 1305.90 11.25' CIMJ Bend Down. Extend 8" Water Line South.	W.L. Sta. 0+05.91, PVI, Line 3 = B.L. Sta. 4+38.13, 124.54' Lt. 1-CIMJ 11.25' Bend Up. Begin Directional Bore.	W.L. Sta. 0+46.31, Line 3 = B.L. Sta. 4+78.52, 125.17' Lt. End Directional Bore.	W.L. Sta. 0+53.89, PVI, Line 3 = W.L. Sta. 0+00.00, Line 4 = B.L. Sta. 4+86.11, 125.29' Lt. 1-CIMJ 8"x6" Tee. CLOW 1-6" Anchored Valve Assembly (W) Valve Box Elevation = 1307.80	W.L. Sta. 0+59.89, PVI, Line 3 = B.L. Sta. 4+92.11, 125.38' Lt. 1-8" Line Valve Assembly CLOW Valve Box Elevation = 1307.80	W.L. Sta. 1+49.71, End Line 3 = B.L. Sta. 5+81.91, 126.79' Lt. 1-Fire Hydrant Assembly, (L=10') Hydrant Bury Elevation = 1308.20 Valve Box Elevation = 1308.30 1-8" CIMJ Plug. CLOW (STORZ)	W.L. Sta. 2+00.55, Line 4 = B.L. Sta. 6+67.15, 105.57' Lt. 1-CIMJ 45' Bend Lt. 22.5 DEG BEND Defect Pipe 02'25'57" Lt.	W.L. Sta. 2+14.32, PVI, Line 4 = B.L. Sta. 6+44.60, 105.52' Lt.	W.L. Sta. 2+39.98, End Line 4 = B.L. Sta. 6+87.20, 138.48' Lt. Anchored 90' CIMJ Bend Up. 6" DICL Pipe w/Flanged End & 2" Threaded Outlet. Flange To Be Positioned No Lower Than 1' Above FFE. 1-Temporary 2" Blow Off Assembly. Backflow Preventor In Building By Others. Line moved 10' South into building
---	---	--	---	---	---	--	--	---

Baughman Water Lines To Serve
Dodge Elementary Addition
Lot 1, Block A

1530 PW (607853)

DESIGN LU
APPROVED LU
DATE 04/10

SCALE Noted
SHEET **4 OF 5**

Dodge Elementary School Addition, 09-10-F553/Engineering/WTR-2 09-12-E422