

# FIRE AND DOMESTIC SERVICES CARGILL INNOVATION CENTER LOTS 25-47, WATERMAN'S ADDITION PROJECT NUMBER 1545 PPW (607853)

## GENERAL NOTES

- Contractor will be required to provide a minimum notice of 72 hours to utility companies prior to starting any excavation as follows:  
  

|                 |          |
|-----------------|----------|
| Kansas One-Call | 687-2470 |
|-----------------|----------|

The Contractor must notify the following in case of an emergency:

|                               |                |
|-------------------------------|----------------|
| Cox Communications            | 262-0661       |
| Kansas Gas Service            | 383-8600       |
| Westar Energy                 | 383-8600       |
| AT&T                          | 1-800-286-8313 |
| City of Wichita Water Utility | 268-6000       |
| Black Hills Energy            | 1-800-303-0357 |
- All water mains and appurtenances shall be installed in accordance with City of Wichita, Kansas, Standard Specifications for the Construction of City Projects, and current policy on construction of Infrastructure improvements by private contract.
- Opening and closing water valves shall be done slowly to prevent damage to the water distribution system from water hammer. All valves closed by the Contractor must be reopened as new construction permits. Project inspector must ascertain that any valve closed by the Contractor is reopened. Contractor will be permitted to operate water valves only when the project inspector assigned to the project is present.
- The Contractor shall give all property owners and/or tenants of developed property directly abutting the construction of this project a minimum of ten (10) days advance notice prior to start of construction.
- The Contractor shall be responsible for preserving property irons. The Contractor will be required to re-establish any property irons which are damaged or destroyed by his construction operations. Such irons shall be re-established by a licensed land surveyor in accordance with state laws.
- This project is to be constructed in accordance with City of Wichita Standard Specifications for the Construction of City Projects and Policy on Construction of Infrastructure by Private Contract.
- The Contractor shall reimburse the Wichita Water Utilities for cost of tap and materials.
- No work shall be done on this project until the project inspector has been notified.
- One-lane traffic on Second St. in each direction shall be maintained at all times. Traffic control shall be positioned to the latest MUTCD standard specifications.
- At Contractor's option, pipe from Sta. 0+00 to 0+70.18 may be installed by directional drilling, in lieu of street pavement removal.

## INDEX OF SHEETS

- (CITY SUBMITTAL INDEX)
- TITLE SHEET
  - WATER PLAN & PROFILE
  - WATER ASSEMBLY DETAILS
  - WATER VAULT DETAILS

## BENCHMARKS

BENCHMARK #1: "X" CHISELED ON TOP OF SIDEWALK.  
ELEVATION = 1302.28 (NAVD88)

BENCHMARK #2: CHISELED SQUARE ON TOP OF SIDEWALK.  
ELEVATION = 1302.00 (NAVD88)

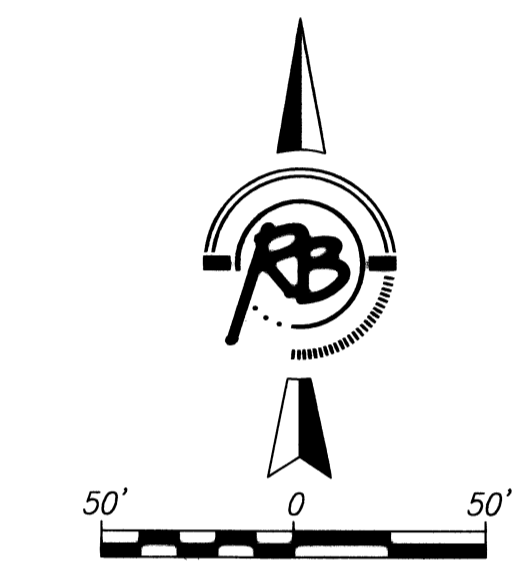
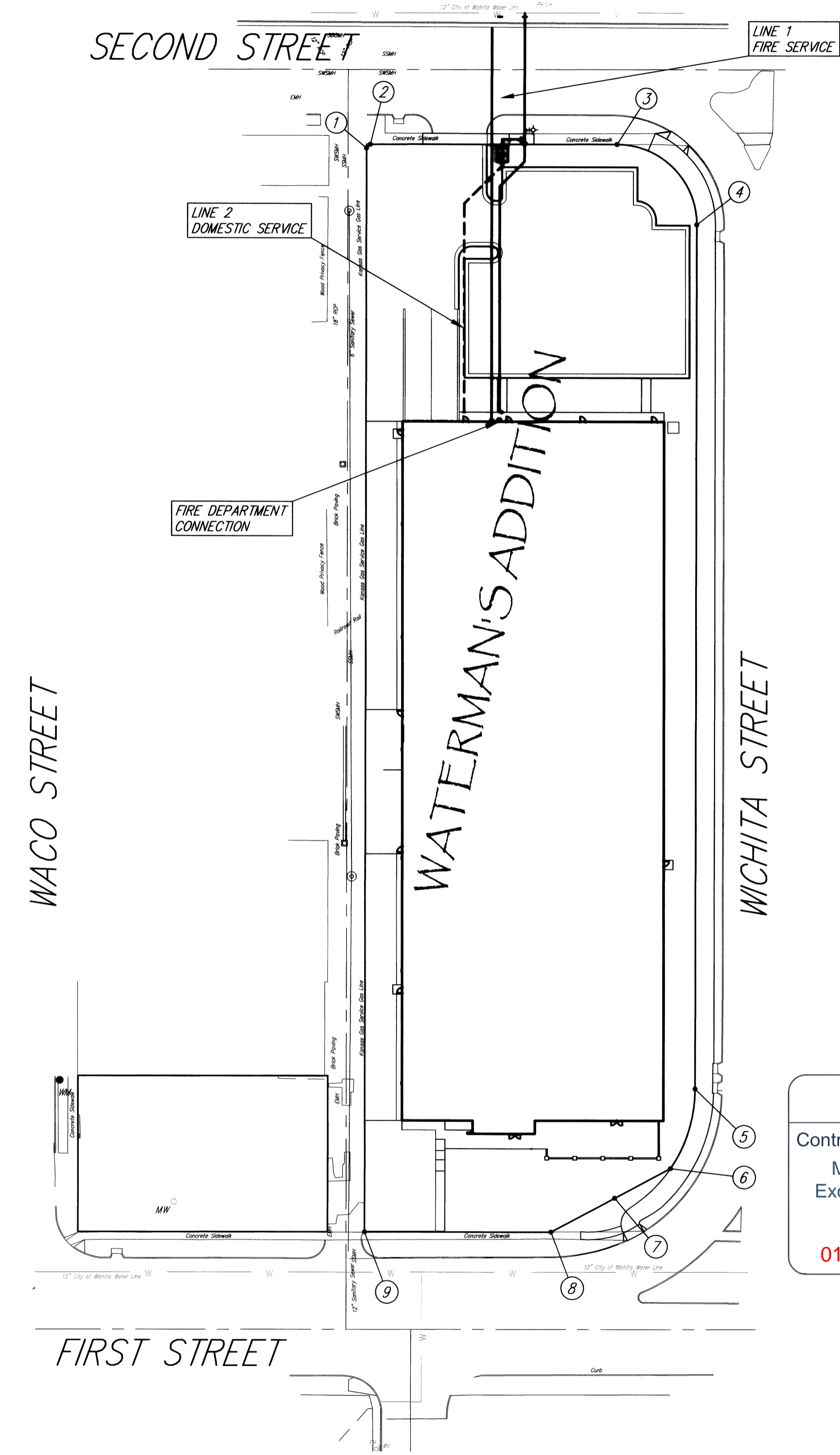

**APPROVED AS NOTED  
BY CITY ENGINEER OF WICHITA  
BY WICHITA FIRE DEPARTMENT  
BY WICHITA WATER UTILITY**

Public Works: *LJA 9-17-10*  
 Water & Sewer: *[Signature] 9-17-2010*  
 Fire Prot. Line: *[Signature] 9-21-2010*

NOTE TO CONTRACTORS

Public Property:  
Inspection and testing for the waterline is to be provided by a Licensed Consulting Engineering Firm under contract with the Owner/Developer. Said inspection to be in accordance with the City of Wichita standard construction engineering practices and certified by a Licensed Professional Engineer. No work shall be performed in dedicated easements or public right-of-way by the Contractor without such inspection nor shall any work be commenced without written authorization by the City Engineer. All Construction and Materials shall comply with the City of Wichita Specifications and Standards (on file and available in the City Engineer's Office).  
Private Property:  
Inspection and testing for the fire protection line is to be performed by a City of Wichita certified fire protection contractor in accordance with the fire codes as adopted by the City of Wichita. All materials and construction practices for the fire protection line shall comply with the fire codes as adopted by the City of Wichita (available from the City of Wichita Fire Department). The Contractor shall not commence work without notification to and approval of the Wichita Fire Department.

| COORDINATE CONTROL TABLE |   |                  |          |          |
|--------------------------|---|------------------|----------|----------|
| CONTROL NO.              | LOCATION  | DESCRIPTION      | NORTHING | EASTING  |
| 1                        | S OF THE NW CORNER OF LOT 47, WATERMAN'S ADDITION | (P-K NAIL)       | 9997.79  | 9865.82  |
| 2                        | NW CORNER OF LOT 47, WATERMAN'S ADDITION          | (V NOTCH)        | 9999.75  | 9867.88  |
| 3                        | NE CORNER OF LOT 47, WATERMAN'S ADDITION          | (CHISELED CROSS) | 10000.00 | 10000.00 |
| 4                        | NE CORNER OF PARCEL #3, WATERMAN'S ADDITION       | (MKEC REBAR)     | 9957.29  | 10042.80 |
| 5                        | SE CORNER OF PARCEL #3, WATERMAN'S ADDITION       | (MKEC REBAR)     | 9496.25  | 10042.33 |
| 6                        | S-SE CORNER OF PARCEL #3, WATERMAN'S ADDITION     | (#5 REBAR)       | 9453.60  | 10029.08 |
| 7                        | SW CORNER OF PARCEL #3, WATERMAN'S ADDITION       | (#4 REBAR)       | 9453.60  | 10029.08 |
| 8                        | SE CORNER OF LOT 25, WATERMAN'S ADDITION          | (V NOTCH)        | 9419.73  | 9865.14  |
| 9                        | SW CORNER OF LOT 25, WATERMAN'S ADDITION          | (1/2" IP)        | 9419.69  | 9865.33  |

AS BUILTS

|   |                                 |
|---|---------------------------------|
| Contractor:<br>McCullough<br>Excavation, Inc. | Project Inspector:<br>Tom Jones |
| 01/31/2011                                    |                                 |

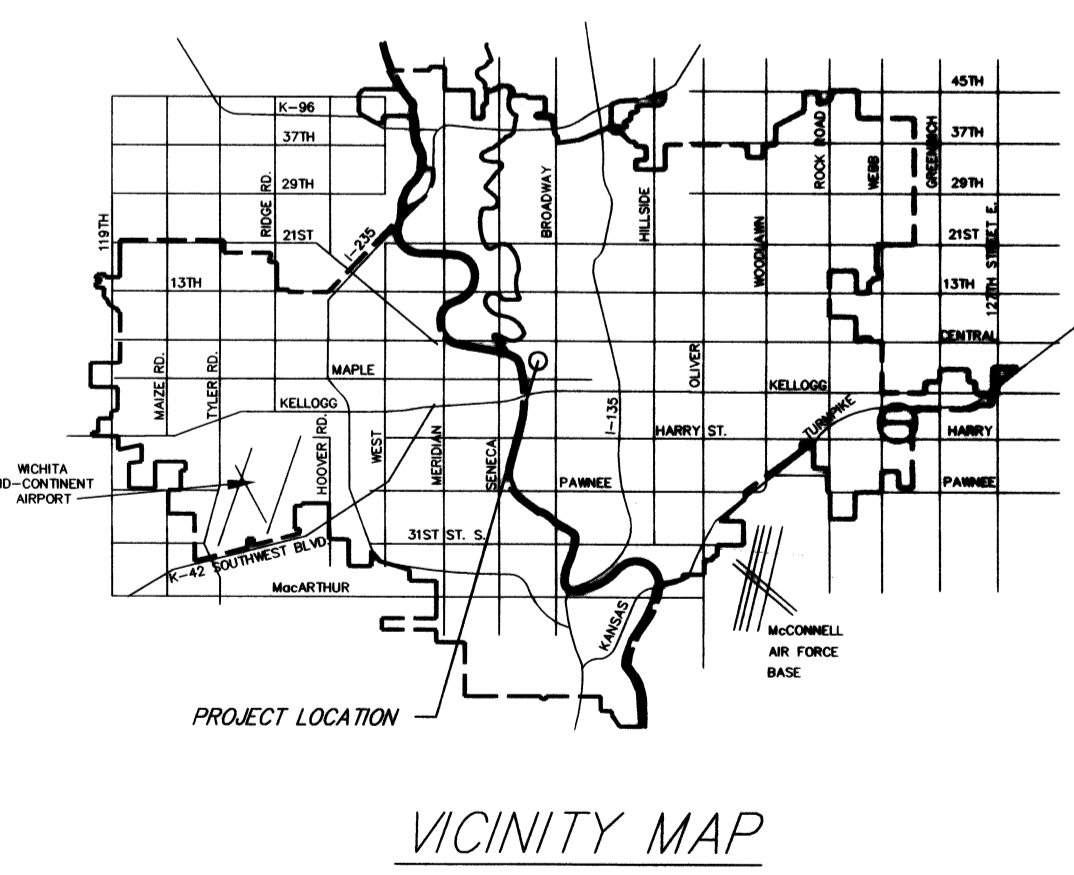

**CITY OF WICHITA, KANSAS**  
**JAMES L. ARMOUR, P.E., CITY ENGINEER**

**Ruggles & Bohm, F.A.**  
Engineering, Surveying, Land Planning

924 North Main (316) 264-8008  
 Wichita, Kansas 67203 (316) 264-4621 fax  
 www.rbkansas.com E-mail: info@rbkansas.com

INDEX OF SHEETS

(CITY SUBMITTAL INDEX)

- TITLE SHEET
- WATER PLAN & PROFILE
- WATER ASSEMBLY DETAILS
- WATER VAULT DETAILS

BENCHMARKS

BENCHMARK #1: "X" CHISELED ON TOP OF SIDEWALK.  
ELEVATION = 1302.28 (NAVD88)

BENCHMARK #2: CHISELED SQUARE ON TOP OF SIDEWALK.  
ELEVATION = 1302.00 (NAVD88)

---

AS BUILTS

|   |                                 |
|---|---------------------------------|
| Contractor:<br>McCullough<br>Excavation, Inc. | Project Inspector:<br>Tom Jones |
| 01/31/2011                                    |                                 |

---

VICINITY MAP

---

CITY OF WICHITA, KANSAS

JAMES L. ARMOUR, P.E., CITY ENGINEER

---

Ruggles & Bohm, F.A.

Engineering, Surveying, Land Planning

924 North Main (316) 264-8008  
 Wichita, Kansas 67203 (316) 264-4621 fax  
 www.rbkansas.com E-mail: info@rbkansas.com

---

SHEET NUMBER

C3.4