

# PRIVATE PROJECT WATER LINE & HYDRANT TO SERVE MEDITERRANEAN PLAZA ADDITION

Private Project Number  
**1569 PPW (607858)**

## CITY OF WICHITA, KANSAS

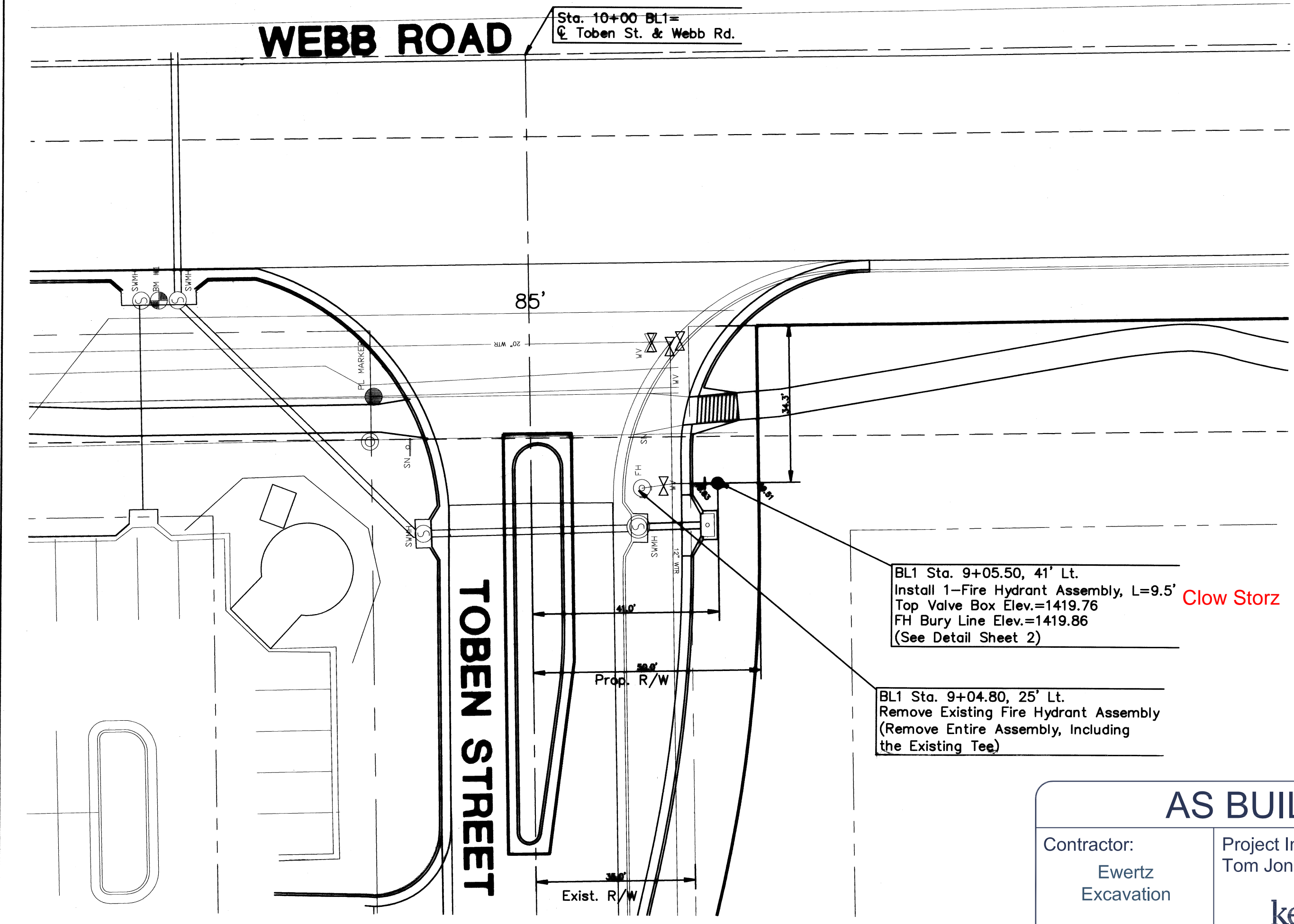

- ### LEGEND
- (C) = Calculated
  - (M) = Measured
  - (P) = Platted
  - (R) = Record
  - C.A.C. = Complete Access Control
  - R.O.W. = Right-of-Way
  - = BPIN (found)
  - = 1/2" Iron Pipe (found)
  - = 3/4" Iron Pipe (found)
  - SAV = 1/2" Rebar W/SAVOY CAP (set)
  - THIMBLE = City of Wichita Control Thimble(Found)
  - 1 IN GALV IP = 1" Galvanized Iron Pipe(Found)
  - 2 IN IP = 2" Iron Pipe(Found)
  - CROSS = Cross Chiseled in Concrete(Set)
  - V NOTCH = V-notch Chiseled in Concrete(Set)

BL1 Sta. 9+05.50, 41' Lt.  
Install 1-Fire Hydrant Assembly, L=9.5'  
Top Valve Box Elev.=1419.76  
FH Bury Line Elev.=1419.86  
(See Detail Sheet 2)

BL1 Sta. 9+04.80, 25' Lt.  
Remove Existing Fire Hydrant Assembly  
(Remove Entire Assembly, including  
the Existing Tee)

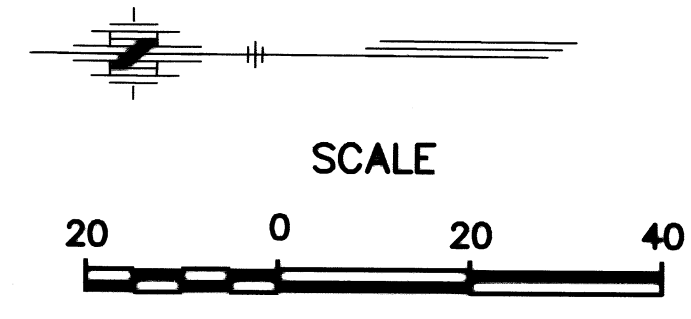

### AS BUILTS

Contractor: Ewertz Excavation	Project Inspector: Tom Jones
01/31/2011	 <small>516 S. Market Wichita, KS 67202 (316)264-0242</small>

### Benchmark

- Cut on curb.  
North side of Access Drive  
to Candlewood Motel  
Elev. = 1417.88 (MSL)

NOTE: Unless Otherwise Noted  
Elevations are Shown to Top of Pipe

NOTE: Existing Waterline Depth  
To Be Verified By Contractor Prior  
To Construction

Station	Water Line Depth (ft)	Existing Ground (ft)	Notes
1430			
1425			
1420			
1415			
1410			
1405			
1400			
0+00	1415.31	1415.69	Connect to Exst. 20" W. Fire Hydrant Clow Storz

APPROVED AS NOTED  
BY CITY ENGINEER OF WICHITA,  
BY WICHITA WATER & SEWER DEPARTMENT,  
& BY WICHITA FIRE DEPARTMENT

Public Works: *[Signature]* 12/11/10  
Water & Sewer: *[Signature]* 12/02/10  
Fire: *[Signature]*

NOTE TO CONTRACTORS

Public Property:  
Inspection and testing for the waterline is to be provided by a Licensed Consulting Engineering Firm under contract with the Owner/Developer. Said inspection to be in accordance with the City of Wichita standard construction engineering practices and certified by a Professional Engineer Licensed in the state of Kansas. No work shall be performed in dedicated easements or public right-of-way by the Contractor without such inspection prior to any work being commenced without written authorization by the City Engineer. All Construction and Materials shall comply with the City or Wichita Specifications and Standards (on file and available in the City Engineer's Office).

Private Property:  
Installation and testing for the fire protection line is to be performed by a City of Wichita licensed fire protection contractor in accordance with the fire codes as adopted by the City of Wichita. All material and construction practices for the fire protection line shall comply with the fire codes as adopted by the City of Wichita (available from the City of Wichita Fire Department). The Contractor shall not commence work without notification and approval of the Wichita Fire Department. Inspection of the fire protection line is to be provided by a licensed Engineering Firm under contract with the Owner/Developer and the Fire Department. The contractor shall not start work until the project inspector is assigned to the project and present on the site. Any work done without inspection will be required to be uncovered for inspection.

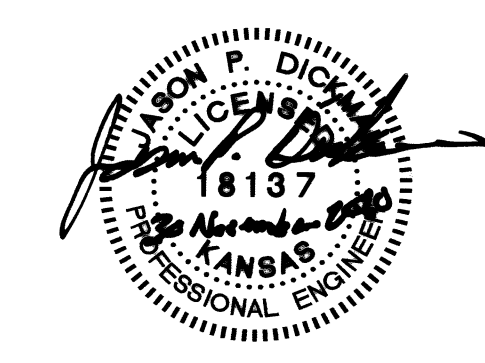

### GENERAL NOTES:

- Existing utilities, both above and below ground, and their locations as shown on the plans, represent the best information available for design. The locations of utilities as shown on the plans are not guaranteed and the Contractor shall verify all utilities and their locations before beginning construction. Additional utilities, including relocated utilities, which are not shown on the plans may be encountered. In this event, the Contractor shall adjust his schedule and cooperate with the utility companies to ensure that their facilities be adjusted as required to clear construction. The Contractor shall exercise extreme caution while working near utilities.
  - All water mains and appurtenances shall be installed in accordance with the City of Wichita, Kansas Standard Specifications for Water Main Construction.
  - The Water Department shall field locate water valves one time during construction when requested by the Contractor. It shall be the responsibility of the Contractor to preserve such field locations during the construction process. Water valves, water valve boxes, or fire hydrants damaged during construction shall be repaired at the Contractor's expense. Contact Gregolley with the Wichita Water Department for water service information at 268-4555.
  - Opening and closing water valves shall be done slowly to prevent damage to the distribution system by a water hammer. All valves that are closed by the Contractor must be reopened as new construction permits.
- The Contractor shall not start work on the project until the licensed inspector is present or authorizes the work. Any work done without inspection will be required to be uncovered for inspection.
- Power Poles within close proximity to the new water line may require temporary bracing to facilitate construction. Contractor shall contact Shane Price at Westar Energy at 261-6315 prior to construction to coordinate pole bracing.
  - Temporary Blow-off Valves necessary to flush lines at existing water line tie-ins shall not be paid directly, but shall be considered INCIDENTAL to other items bid.
  - All open cut pipe trench under new pavement shall be back-filled with sand, flushed with water and vibrated.
  - All water pipe trench in pavement or driveways which will be required to carry traffic until permanent replacement shall be topped with a minimum of 6" crushed rock (Compacted) to be INCIDENTAL to the project. Contractor shall be required to maintain temporary crushed rock until permanent pavement is installed.
  - Contractor shall give all Property Owners and/or Tenants of developed property directly abutting the construction of the project a minimum of ten (10) days notice prior to the start of construction and a 24 hour notice prior to any planned water shut down.
  - Each Bidder shall visit the site of the project before submitting a proposal in order to become better informed of the existing field condition and obstacles which might be encountered during construction. Each Bidder should understand that no additional compensation will be awarded for extra work that should have been evaluated prior to bidding.
  - The Contractor shall provide all construction staking.
  - The Owner shall provide all construction inspection, testing and shop drawing review.
  - Waste material will be disposed of off-site by the Contractor. The site will have to be approved by the Engineer.
  - The Contractor shall use Best Management Practices (BMP's) to prevent eroded soil from entering ditches, culverts, and drainage areas. Standard details for erosion BMP's are available from the Engineer. The Contractor shall follow the intent of the BMP's, which act as a guideline.
  - The Contractor will be required to provide a minimum of Seventy-Two (72) hours advanced notice to Kansas One Call (1-800-344-7233) and all utility owners within the project prior to the beginning of construction and request that any existing lines be flagged.

TYPE	OWNER	CONTACT	TELEPHONE	ALTERNATE
Locator Service	Kansas One-Call		811	(800) 344-7233
TV	Cox Communication (Cable)	Eva Moore	262-4270	260-7169
Electric	Westar Energy (Wichita)	Shane Price	261-6135	383-8600
Gas	Black Hills Energy (AKA Aquilla)	Calvin Briggs	914-1608	941-1607
Gas	Kansas Gas Service	Jim Coe	832-3126	
Telephone	AT&T Telephone	Jason Edwards	268-2008	268-2102
Water	Wichita Water Department	Gregolley	268-4555	268-4908
Storm Water Sewer	Wichita SWS Maintenance	Doug Arvidson	268-4095	
Sanitary Sewer	Wichita Sewer Maintenance	Calvin Fugit	268-4024	262-6000
Highway	KDOT	Ben Koerner	744-1271	

Revision  
 Approved By  
 Date  
 No.

MEDITERRANEAN PLAZA ADDITION  
 PRIVATE WATER LINE IMPROVEMENTS  
 WATER LINE NO. 1  
 CITY OF WICHITA, KANSAS  
 JAMES ARMOUR, P.E. - CITY ENGINEER  
 1569 PPW (607858)

POE & ASSOCIATES, INC.  
 CONSULTING ENGINEERS  
 5940 E. Central, Suite 200 ■ Wichita, KS 67208-4242  
 Phone 316/665-4114 ■ FAX 316/665-4444

FINAL  
 Designed By: J. Dickman  
 Drawn By: S. Schmitt  
 P.O. Job No.: 949/Entrance/Base-PPW.dwg  
 Date: November 2010