

PRIVATE STORM SEWER PLANS

TO SERVE



MARKET STORE #5991-00

31st ST. & S. SENECA ST.

WICHITA, SEDGWICK COUNTY, KANSAS

CITY OF WICHITA PRIVATE PROJECT NO. 0014PPD(607861)

OWNER'S ADDRESS

WALMART STORES, INC.
702 S.W. 8th STREET
BENTONVILLE, AR 72716
PH. (479) 273-4000

SHEET INDEX

C-9.0	TITLE SHEET
C-9.1	STORM SEWER LINE LOCATION PLAN
C-9.2	ERU PLAN
C-9.3	PROPOSED DRAINAGE PLAN
C-9.4	PROPOSED WATERSHED & STORM SEWER SUMMARY
C-9.5	STORM SEWER "A" PLAN & PROFILE
C-9.6	STORM SEWER "A" CONT. PLAN & PROFILE
C-9.7	STORM SEWER "B" & "C" PLAN & PROFILE
C-9.8	STORM SEWER "D" PLAN & PROFILE
C-9.9	STORM SEWER DETAILS
C-9.10	CDS3020-6-C IN LINE CDS STANDARD DETAIL
C-9.11	DESIGN #6 INLET DETAILS
C-9.12	STD TYPE I CURB INLET 5'-0" OR 10'-0" OPENING
C-9.13	SINGLE/DOUBLE DROP INLET
C-9.14	PRECAST CONCRETE MANHOLE (STORM SEWER)
C-9.15	MANHOLE/INLET FRAME AND COVER (STORM SEWER)

EROSION CONTROL PLANS ARE PROVIDED IN THE SITE DEVELOPMENT PLANS MARKET STORE #5991-00 AND ARE AVAILABLE UPON REQUEST FROM THE ENGINEER

I, Terence L. Haynes, Kansas Professional Engineer, #14583, do hereby state that these Storm Sewer line plans, prepared by me or under my direct, responsible supervision, are in strict conformance with the applicable Codes of the City of Wichita and the sound principles and practice of the Civil Engineering profession

TERENCE L. HAYNES, P.E. #14583

AS BUILTS

Contractor:

Ewertz
Excavation
9/29/2011

Project Inspector:
Larry Gann



516 S. Market,
Wichita, KS 67202
(316)264-0242

2011

APPROVED AS NOTED
BY CITY ENGINEER OF WICHITA,
& BY WICHITA FIRE DEPARTMENT,
& BY WICHITA FIRE DEPARTMENT

Public Works: Julianne Kallman 4-20-11
Water & Sewer: [Signature] 4/24/11
Fire: [Signature]

NOTE TO CONTRACTORS

Public Property:
Inspection and testing for the waterline is to be provided by a Licensed Consulting Engineering Firm under contract with the Owner/Developer. Solid inspection to be in accordance with the City of Wichita standard construction engineering practices and certified by a Professional Engineer Licensed in the state of Kansas. No work shall be performed in dedicated easements or public right-of-way by the Contractor without such inspection nor shall any work be commenced without written authorization by the City Engineer. All Construction and Materials shall comply with the City or Wichita Specifications and Standards (on file and available in the City Engineer's Office).

Private Property:

Installation and testing for the fire protection line is to be performed by a City of Wichita licensed fire protection contractor in accordance with the fire codes as adopted by the City of Wichita. All material and construction practices for the fire protection line shall comply with the fire codes as adopted by the City of Wichita (available from the City of Wichita Fire Department). The Contractor shall not commence work without notification and approval of the Wichita Fire Department. Inspection of the fire protection line is to be provided by a licensed Engineering Firm under contract with the Owner/Developer and the Fire Department. The contractor shall not start work until the project inspector is assigned to the project and present on the site. Any work done without inspection will be required to be uncovered for inspection.

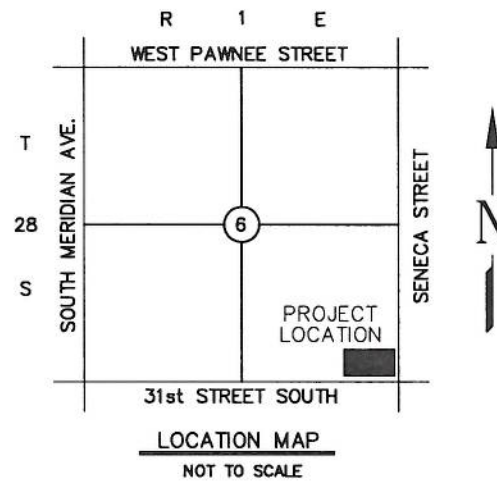

(1) An effort has been made to locate and show approximate location of underground utility lines. Buried utilities are not necessarily shown. It is the Contractors responsibility to locate and preserve all utility services.

(2) Proposed utility services have been coordinated with the local utility companies. Contractor is responsible for contacting all utility companies prior to construction.

(3) All quantity estimates shown in this set of plans are the Engineer's estimate and are provided for general information only! The contractor is solely responsible for calculating his/her own quantities!

(4) Contractor shall acquire Licensing to work in City of Wichita, shall maintain Insurance Verification per Walmart and City's requirements and shall submit necessary bonds to satisfy City of Wichita's requirements.

NOTE TO CONTRACTOR
CALL KANSAS ONE
1-800-522-6543

This number is to be used for information on the location of all underground utilities. Contact this number prior to any excavation.

ALERT TO CONTRACTOR:

1. THE SITEWORK FOR THE WALMART PORTION OF THIS PROJECT SHALL MEET OR EXCEED THE "SITE SPECIFIC SPECIFICATIONS."
2. ALL NECESSARY INSPECTIONS AND/OR CERTIFICATIONS REQUIRED BY CODES AND/OR UTILITY SERVICE COMPANIES SHALL BE PERFORMED PRIOR TO CONTRACT COMPLETION AND THE FINAL CONNECTION OF SERVICES.

CITY RESOURCE LIST

CITY MANAGER
CITY MANAGER'S OFFICE
CITY OF WICHITA
455 N. MAIN - CITY HALL
WICHITA, KS 67202
CONTACT: ROBERT LAYTON
PH: (316) 268-4351
FAX: (316) 858-7712

CITY ENGINEER
PUBLIC WORKS
CITY OF WICHITA
455 N. MAIN - CITY HALL
WICHITA, KS 67202
CONTACT: JIM ARMOUR
PH: (316) 268-4266
FAX: (316) 268-4114

PLANNING / ZONING
METROPOLITAN AREA PLANNING
DEPARTMENT
CITY OF WICHITA
455 N. MAIN - CITY HALL
WICHITA, KANSAS 67202
CONTACT: BILL LONGNECKER
PH: (316) 268-4494
FAX: (316) 268-4390

BENCH MARKS

BM #1 "a" CHISELED ON TOP OF CURB ELEV=1284.05 DATUM = NAVD 1988	BM #2 "a" CHISELED ON TOP OF CURB ELEV=1283.13 DATUM = NAVD 1988
---	---

SMC Consulting Engineers, P.C.

Oklahoma City, Oklahoma

TITLE SHEET
PRIVATE STORM SEWER PLANS
WALMART
MARKET #5991-00
31st STREET & S. SENECA STREET
WICHITA, KANSAS

SMC Consulting Engineers, P.C.
815 West Main - Oklahoma City, OK 73108
PH: 405-232-7715 Fax: 405-232-7859

DATE: 03/01/11	SCALE: NTS	SHEET NO. C-9.0
DRAWN BY: BMS		
PROJECT NO.: 4958.00		
ENGINEER: TERENCE L. HAYNES, P.E. #14583		

NOT VALID FOR CONSTRUCTION UNLESS SIGNED IN THIS BLOCK