

NOTE:
 DOTTED EXTENSION LINE TAPER LENGTH
 POSTED SPEED * 12
 FOR POSTED SPEEDS ABOVE 40 MPH

TYPICAL MARKING FOR AUXILIARY PASSING LANE

NOTE: ALL PAVEMENT MARKINGS SHALL BE BROKEN AT CROSS ROADS.

FOR HIGHWAY JUNCTIONS THE NO PASSING ZONE WILL EXTEND 1000' FROM INTERSECTION

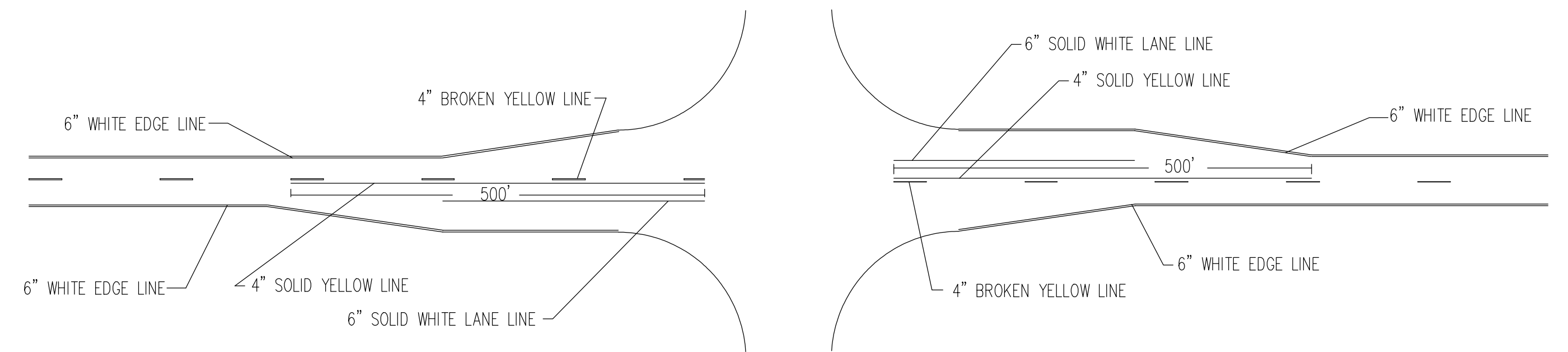

TYPICAL ROAD JUNCTION MARKINGS WITH BYPASS LANES

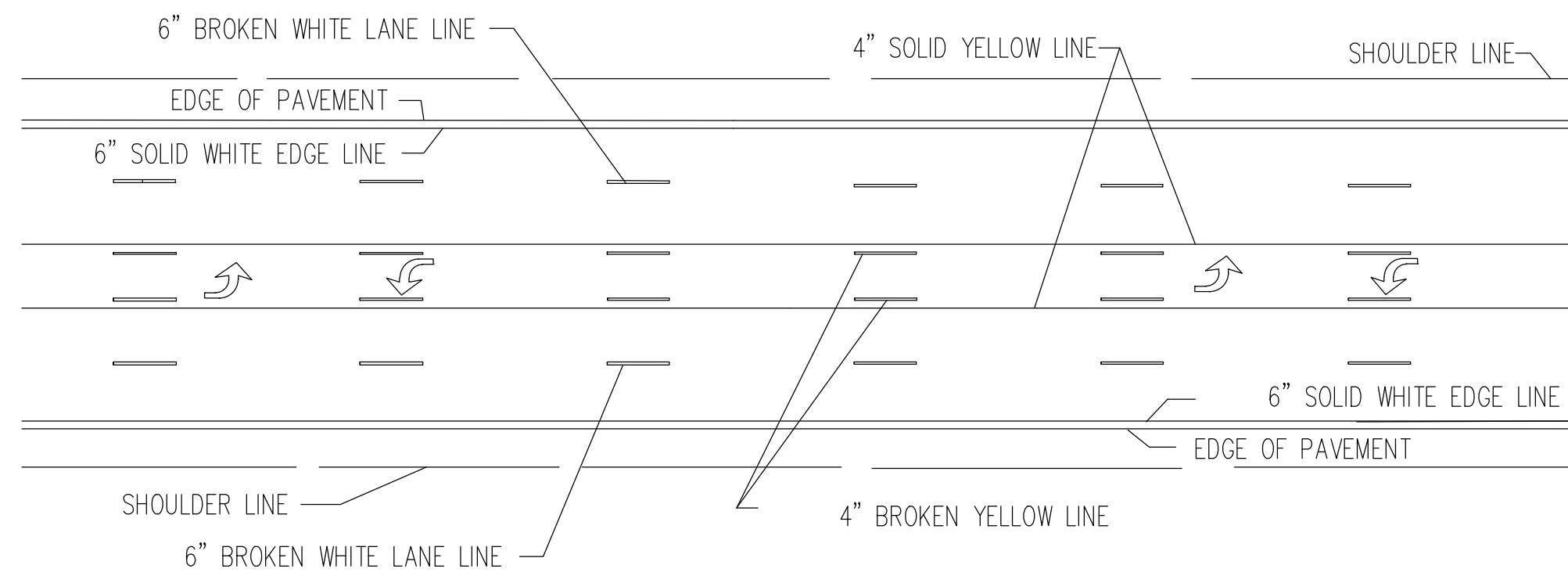

TWO-WAY LEFT TURN DETAIL FOR FIVE LANE ROADWAY

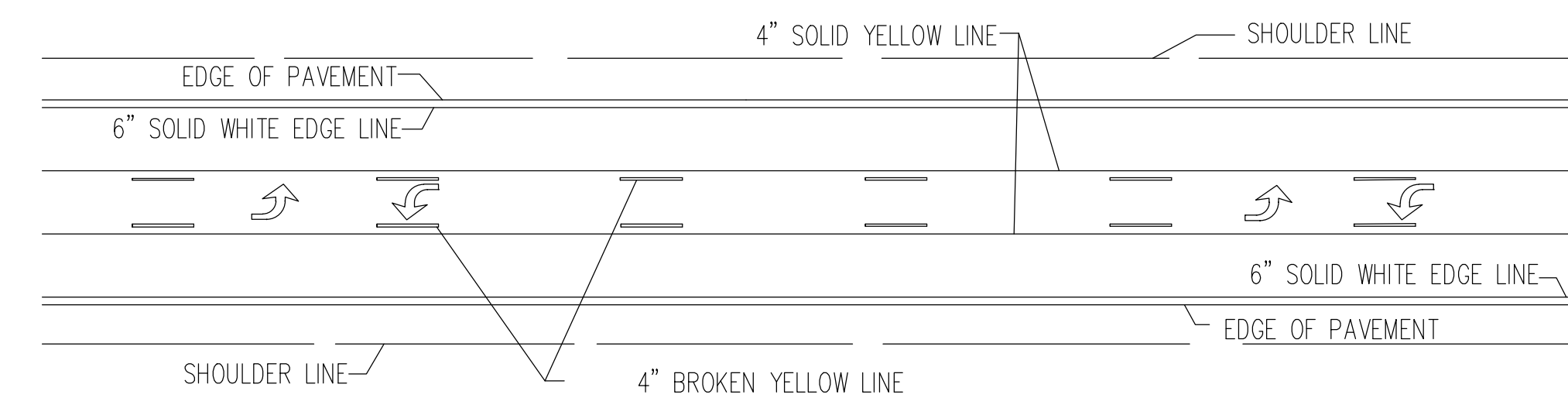

TWO-WAY LEFT TURN DETAIL FOR THREE LANE ROADWAY

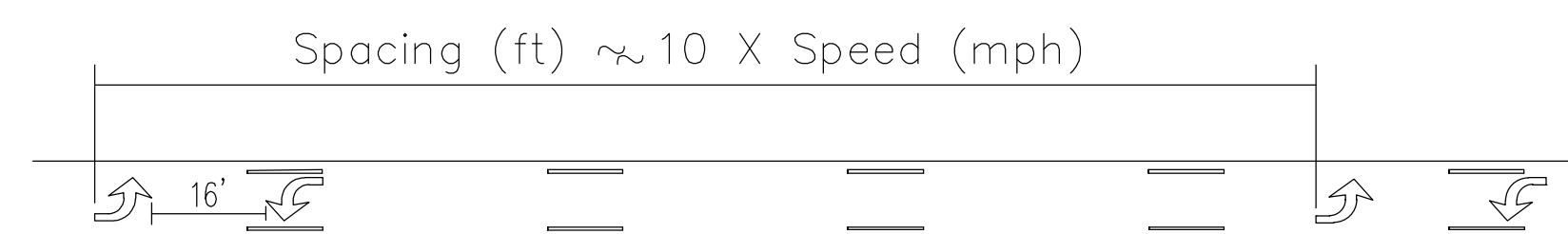

TWO-WAY LEFT TURN ARROW SPACING DETAIL

NOTE: If arrows are used space the arrows as shown in the spacing detail

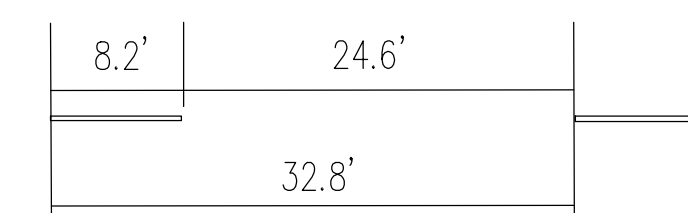

TYPICAL SPACING FOR BROKEN LINES UNLESS OTHERWISE NOTED ON PLANS

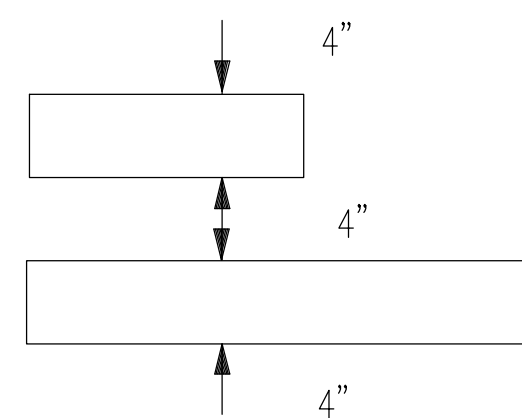

TYPICAL SPACING FOR NO PASSING LINES UNLESS OTHERWISE NOTED ON PLANS

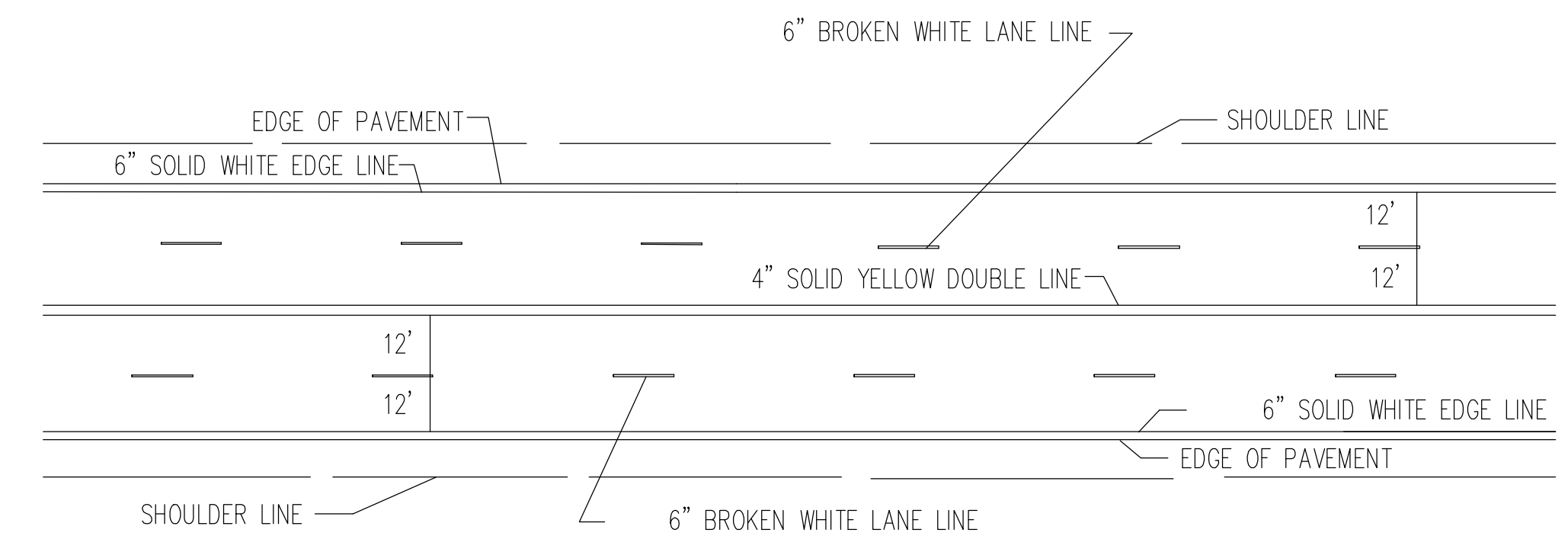

TYPICAL MARKINGS FOR FOUR LANE ROADWAY

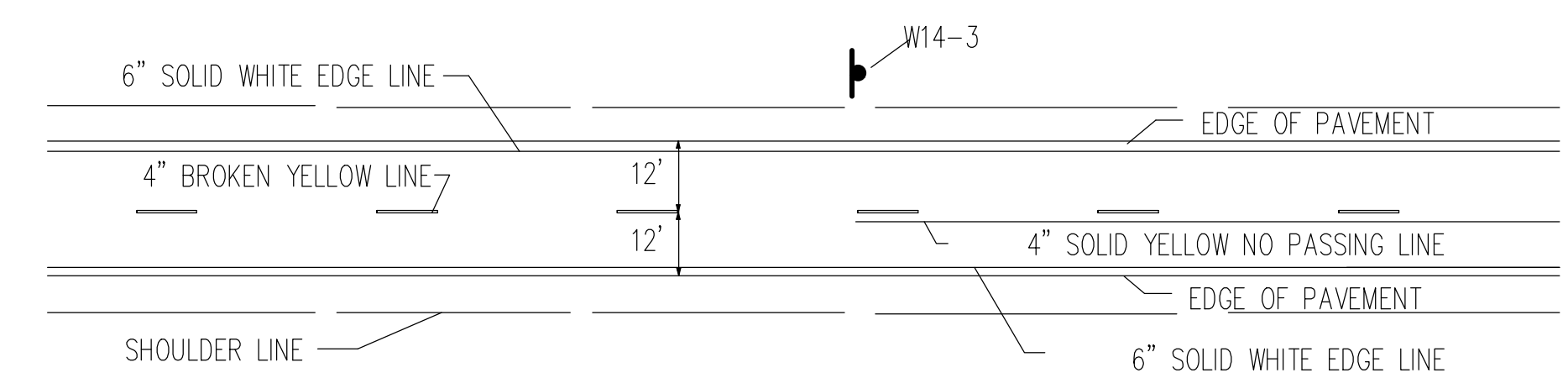

TYPICAL TWO LANE MARKINGS

NOTE: LONGITUDINAL PAVEMENT MARKING LINES SHALL BE OFFSET A MINIMUM OF 2" FROM LONGITUDINAL PAVEMENT JOINTS.

NOTE: ON NON I, US, AND K ROUTES, 4" EDGE LINES MAY BE INSTALLED. 6" EDGE LINES ARE NOT REQUIRED ON NON I, US, AND K ROUTES.

3					
2	09/20/2005	Removed auxiliary passing lane dotted extension line	JFF	BDG	
1	07/26/2005	New FHWA Approval Date	JFF	BDG	
NO.	DATE		BY	APP'D	

KANSAS DEPARTMENT OF TRANSPORTATION
 TYPICAL PAVEMENT MARKING DETAILS FOR UNDIVIDED ROADWAYS

TE 308 SH 51B/64

FHWA APPROVAL	07/26/2005	APP'D	Byron D. Gower
DESIGNED	JFF	QUANTITIES	TRACED
DESIGN CK.	BDG	QUAN. CK.	TRACE CK.