

Note:
Proposed and existing pipe lengths are approximations and are to be field-verified and adjusted by contractor.

| | | |
|------------|------------|------------|
| APPROVED | DESIGNED | DETAILED |
| DESIGN CK. | DESIGN CK. | DETAIL CK. |
| QUANTITIES | QUANTITIES | TRACED |
| QUANTITY | QUANTITY | TRACE CK. |

①
Sta. 12+71.00, 25.00' Lt.
Const. 4' x 4' Type I Area Inlet
Install 62 LF x 15" RCP (NE)

②
Sta. 13+28.00, 2.00' Lt.
Const. 4' x 4' Type I Area Inlet
Install 108 LF x 18" RCP (SE)

③
Sta. 12+80.45, 94.64' Rt.
Const. 18" RCP End Section
with Restrained Joint

LEGEND

- Native Seeding Mix
- Native Seeding Mix With Erosion Control Mat
- Stone Riprap

SCALE
10' 0 10' 20'

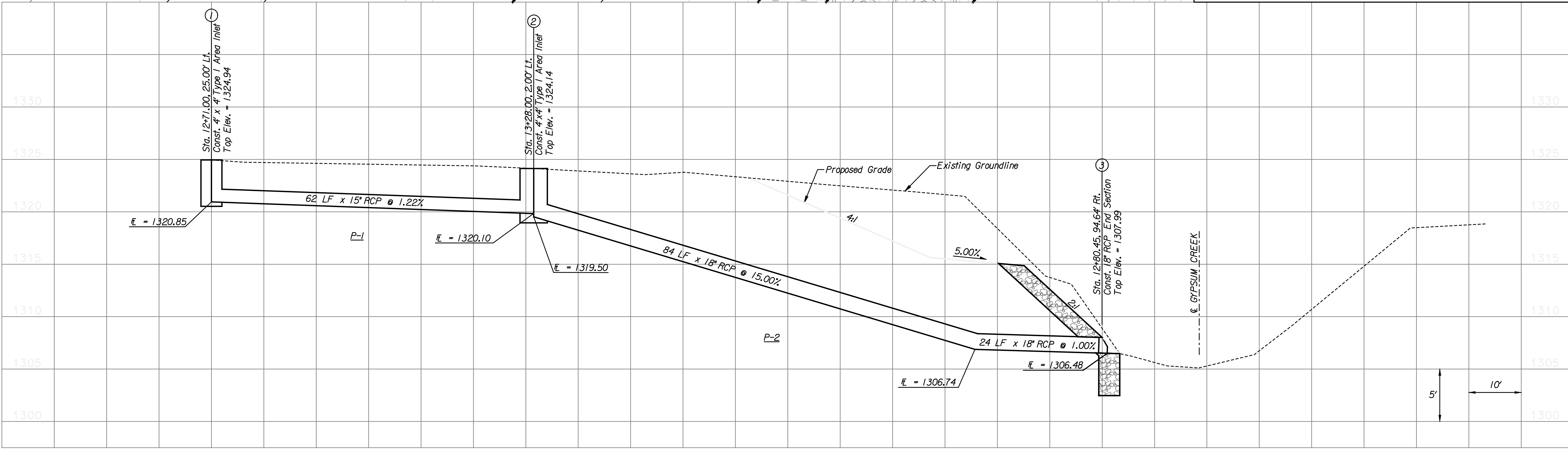

Plotted on Wednesday November 26, 2008 10:32 AM
By: amast-dagh
Design: J:\43244\CD\Profile\Syp_Arm_Pipe_Prof_01.dgn

| | |
|-----------|--------------|
| SHEET NO. | TOTAL SHEETS |
| 13 | 76 |

7450 W 130th St, Suite 400
Overland Park, KS 66213
(913) 491-9833

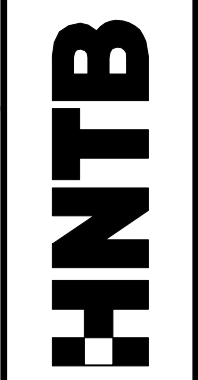

CITY OF
WICHITA, KANSAS



| | | | |
|-----|------|----|------|
| NO. | DATE | BY | APPD |
| 4 | | | |
| 3 | | | |
| 2 | | | |
| 1 | | | |

**GYPSUM CREEK BANK STABILIZATION
STORM SEWER PIPE PROFILE**