

Index

- 1 Title Sheet
- 2 Keysheet
- 3 General Notes
- 4-9 Typical Sections
- 10 Wheelchair Ramp & Paving Details
- 11 Bus Stop Pad Details
- 12 Drive Detail
- 13 Joint Dowel Detail
- 14-18 21st Street Paving Plans
- 19-21 Maize Road Paving Plans
- 22 Intersection Joint Plan
- 23 Intersection Grading Plan
- 24-27 Pavement Joint Plan
- 28-29 SWS Plan/Profiles
- 30-33 SWS Details
- 34 Pavement Underdrain Details
- 35-42 Marking and Signing Plans
- 43 Sign Details
- 44-45 Signalization Details
- 46 Signalization Plan
- 47 Wiring Diagram
- 48-49 Summary of Quantities
- 50-53 Construction Sequence
- 54-56 Traffic Control Details
- 57 Erosion Control Plan
- 58 Sodding Plan
- 59 Erosion Control BMP's
- 60-62 21st Street Cross Sections
- 63-65 Maize Road Cross Sections

CONSTRUCTION PLANS FOR PROPOSED
**21st and MAIZE ROAD
 INTERSECTION
 IMPROVEMENTS**

FOR
 THE CITY OF WICHITA,
 SEDGWICK COUNTY, KANSAS

James L. Armour, P.E., City Engineer

January, 2012

FINAL PLANS

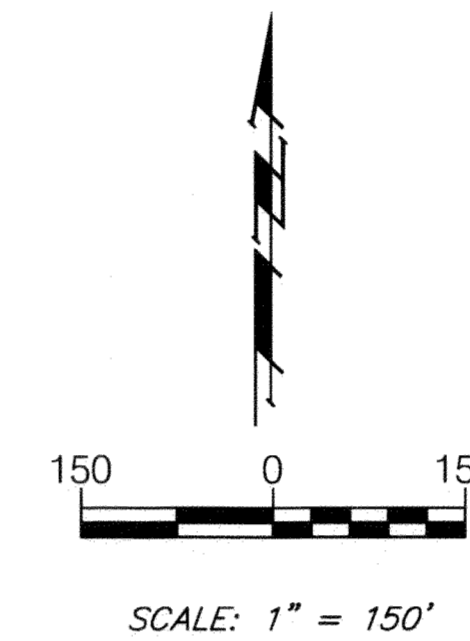

VICINITY MAP

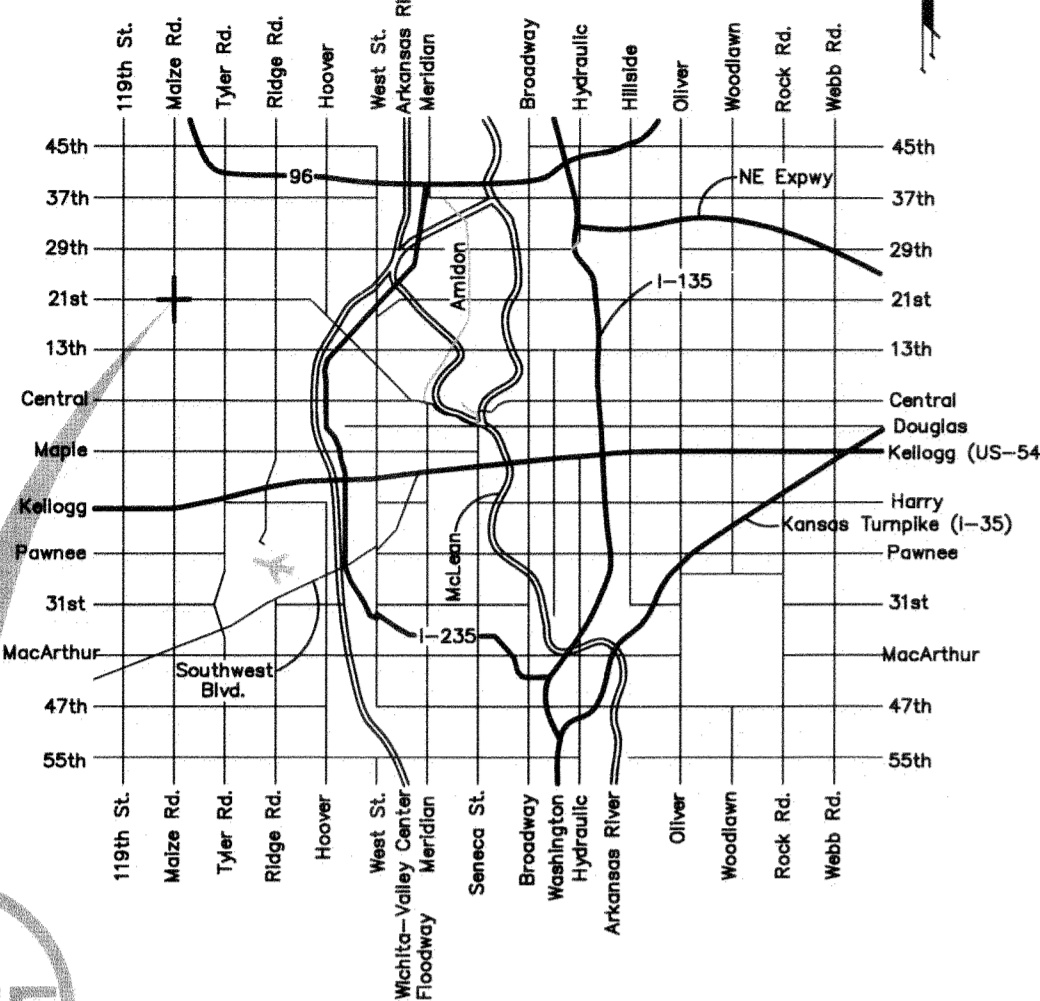

Population
366,046



Paving Project
 472-84924
 O.C.A. No. 707019

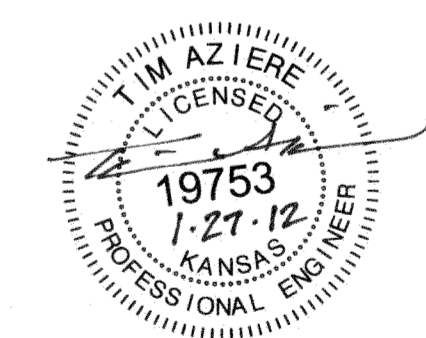
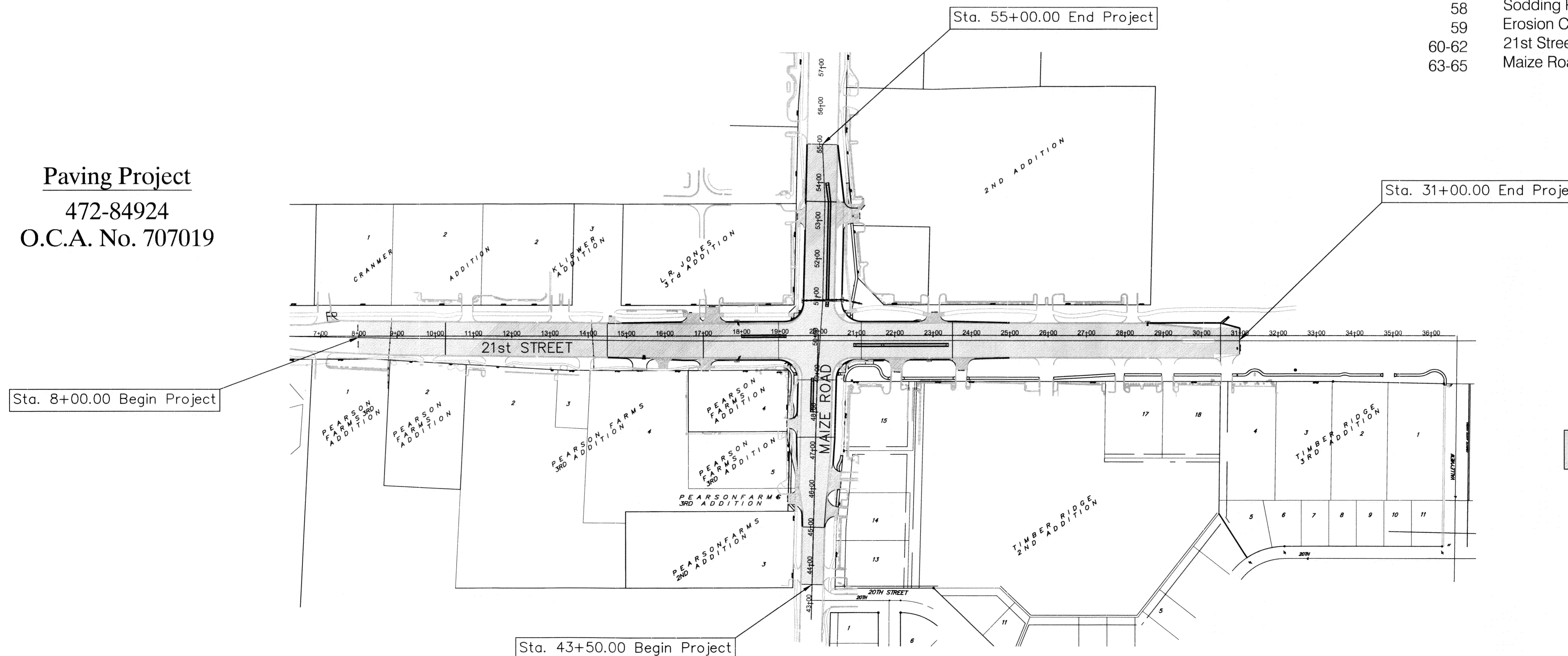

█ - Proposed Construction

APPROVED - DATE **FEB 2, 2012**
James L. Armour
 JAMES L. ARMOUR, P.E., CITY ENGINEER
 CITY OF WICHITA, KANSAS