

# TYPICAL 41' PAVEMENT DETAILS TRANSVERSE SECTION

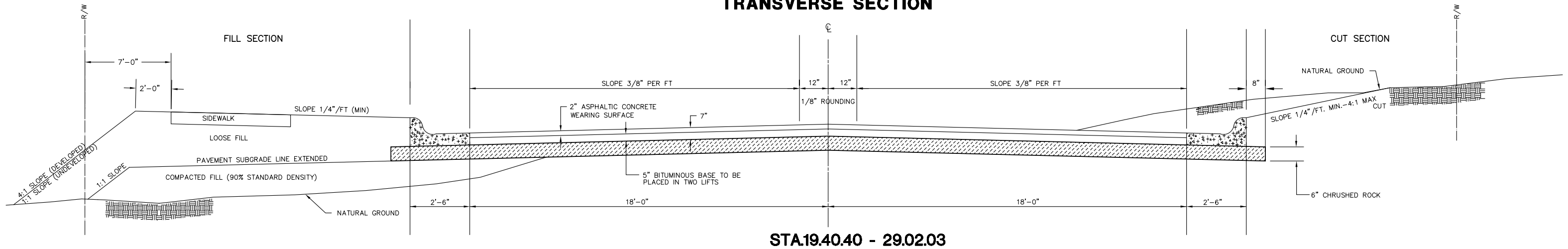

## TRANSVERSE SECTION

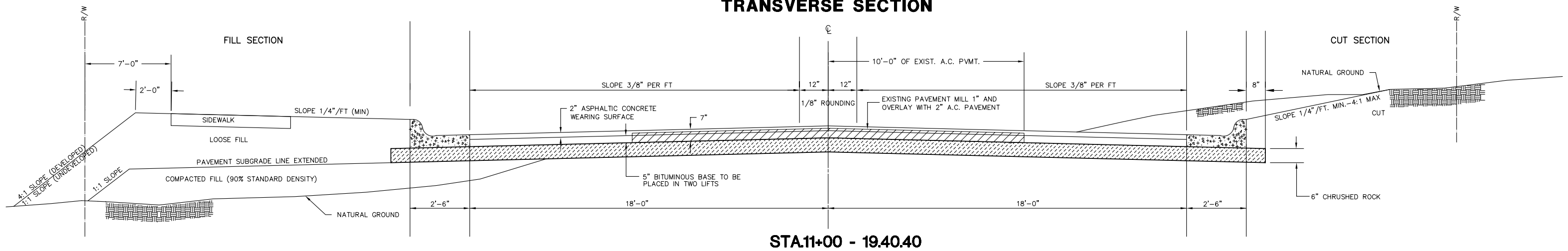

## TRANSVERSE CONSTRUCTION JOINTS

### COMBINED CURB & GUTTER

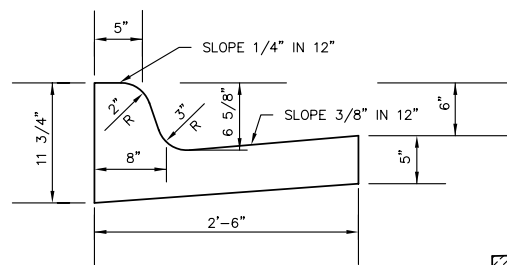

### ELEVATION OFFSETS

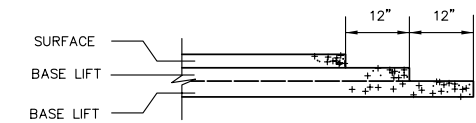
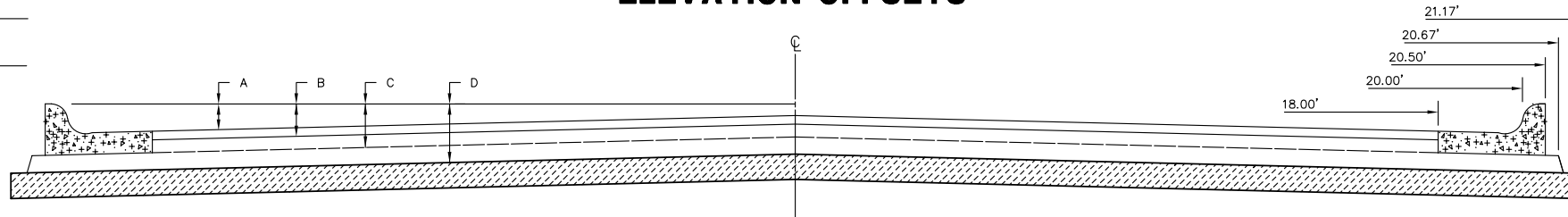

TRANSVERSE CONSTRUCTION JOINTS SHALL BE CONSTRUCTED IN FLEXIBLE BASE PAVEMENTS AT LOCATIONS WHERE PAVEMENT JOINS EXISTING FLEXIBLE BASE PAVEMENT AS SHOWN BY THE DETAIL. ALL COSTS ASSOCIATED WITH THE CONSTRUCTION OF THE TRANSVERSE JOINT SHALL BE INCLUDED IN THE BID PRICE FOR SQUARE YARDS 8" ASPHALTIC CONCRETE (6" BITUMINOUS BASE).

### GENERAL NOTES

- ROCK BASE IS TO BE COMPACTED AND SMOOTHED WITH A STEEL FACED ROLLER PRIOR TO PLACEMENT OF ASPHALT. TACK COAT WILL NOT BE APPLIED TO ROCK BASE.
- A TACK COAT OF EMULSIFIED ASPHALT (SC-1H OR CSS-1H) SHALL BE APPLIED AT AN APPROXIMATE RATE OF 0.05 GALLONS PER SQUARE YARD BETWEEN EACH LIFT OF ASPHALTIC MATERIAL.
- BITUMINOUS BASE AND ASPHALTIC CONCRETE WEARING SURFACE SHALL BE PLACED WITH A LAYDOWN MACHINE HAVING AUTOMATIC CONTROLS FOR LINE AND GRADE.
- CONSTRUCTION JOINTS IN EACH LIFT SHALL BE STAGGERED A MINIMUM DISTANCE OF ONE (1) FOOT FROM JOINTS IN PRECEDING LIFTS AND PLACED SO THAT A JOINT WILL BE CONSTRUCTED ON THE CENTERLINE OF THE TOP LIFT.

### ROLL TYPE COMBINED CURB & GUTTER

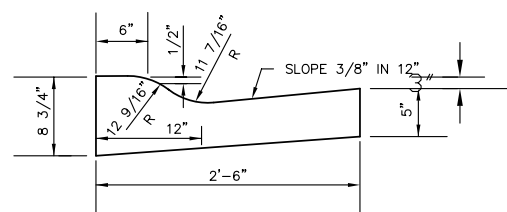

	DISTANCE FROM CENTERLINE (LT. & RT.)														
	0'	2'	4'	6'	8'	10'	12'	14'	16'	18'	20'	20.50'	20.67'	21.17'	
A: TOP OF STD. CURBS TO TOP OF SURFACE LIFT	-0.05	-0.01	0.05	0.11	0.18	0.24	0.30	0.36	0.43	0.49	--	--	--	--	
B: TOP OF STD. CURBS TO TOP OF UPPER BASE LIFT	0.11	0.16	0.22	0.28	0.34	0.40	0.47	0.53	0.59	0.65	--	--	--	--	
C: TOP OF STD. CURBS TO TOP OF LOWER BASE LIFT	0.36	0.41	0.47	0.53	0.59	0.65	0.72	0.78	0.84	0.90	0.97	0.98	0.99	--	
D: TOP OF STD. CURBS TO TOP OF SUBGRADE	0.61	0.66	0.72	0.78	0.84	0.90	0.97	1.03	1.09	1.15	1.22	1.23	1.24	1.25	