

BL Sta. 53+50.00
P.V.I. No V.C.
Tc=1352.50

-0.600%

Sta. 53+50.00
Match Line

Construct Concrete C & G,
Type 1 (6" & 1-1/2").
Both Sides

Construct 7" Asphalt
Pavement on 8" Reinforced
Crushed Rock Base

BL Sta. 55+00.00
END 7" Asphalt Pvmnt.
END Construction
END Project

BL Sta 53+57.78, 61.60 Rt.
Disconnect Existing Fire Hydrant at
East Side Existing Valve. Remove Fire
Hydrant and Deliver to City of Wichita
Water Utility.
Install 4.00 L.F. Pipe, WL 6" DI CL (E)
Install 1-6" CIMJ 90° Bend (L)
Install 3.00 L.F. Pipe, WL 6" DI CL (N)
Install 1- Fire Hydrant
Bury Line Elev. = 1352.70

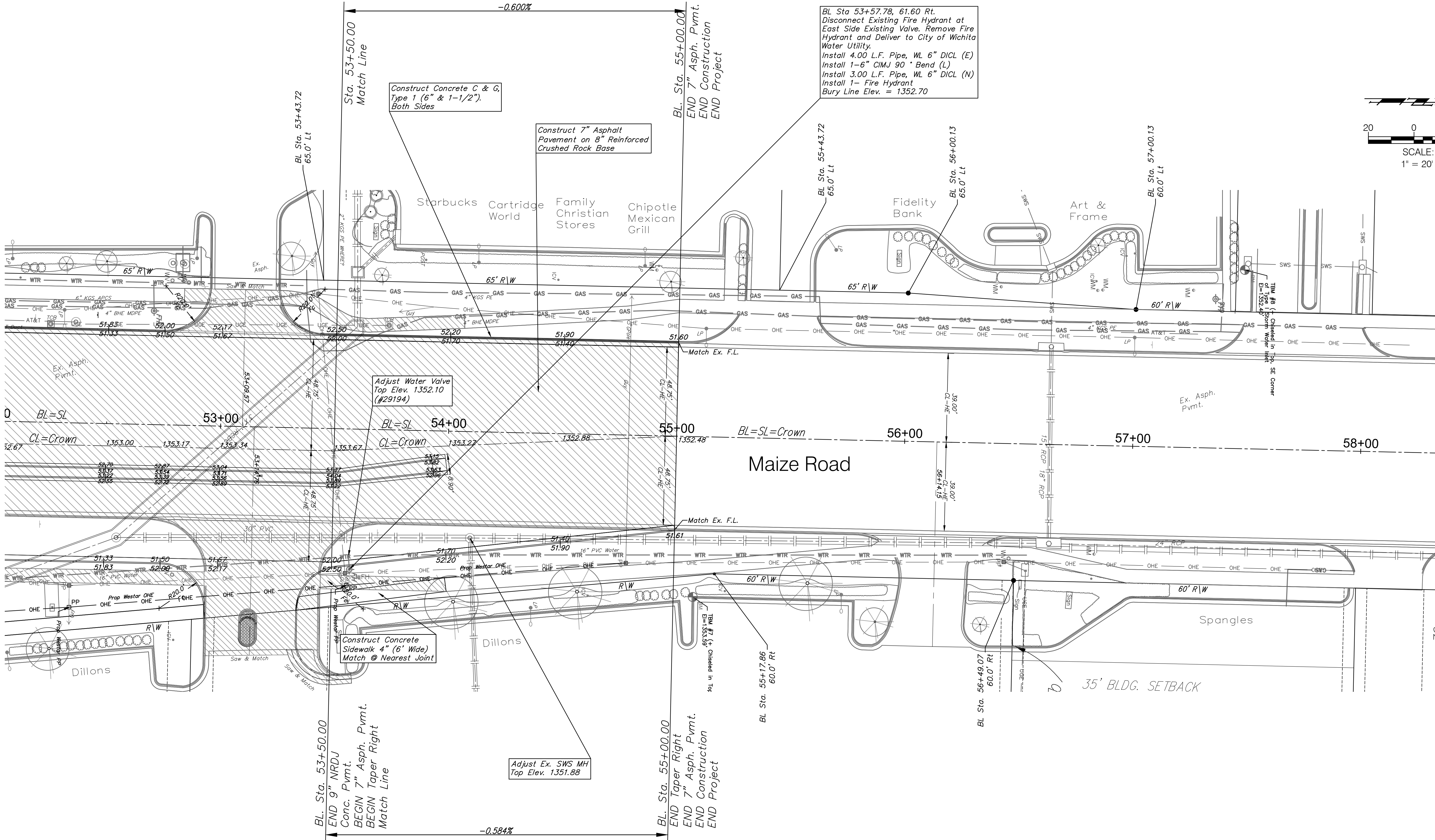
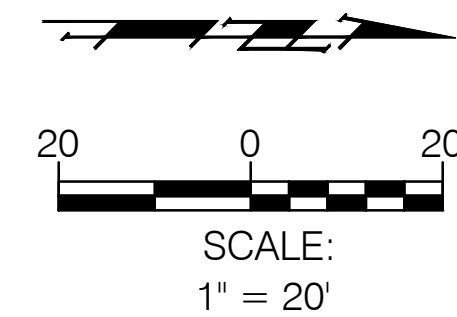

Adjust Water Valve
Top Elev. 1352.10
(#29194)

Construct Concrete
Sidewalk 4" (6' Wide)
Match @ Nearest Joint

Adjust Ex. SWS MH
Top Elev. 1351.88

BL Sta. 53+50.00
END 9" NRDJ
Conc. Pvmnt.
BEGIN 7" Asphalt Pvmnt.
BEGIN Taper Right
Match Line

BL Sta. 55+00.00
END Taper Right
END 7" Asphalt Pvmnt.
END Construction
END Project

-0.584%

BL Sta. Sta. 53+50.00
P.V.I. No V.C.
Tc=1352.50

Note:
Trees/Shrubs to be
removed are marked thus:

Note:
Pavement, Sidewalks, and
Etc. To Be Removed Are
Indicated By:

Drawing File: E:\Projects\21st & Maize_1004E492\Civil 3d\base

Design: T. Ariere
Drawn: JDM
Approved: T. Ariere
Scale: 1"=20'

Project No. 1004E492 CAPITAL IMPROVEMENT PROJECT
MAIZE ROAD PAVING
Sta.53+50.00to Sta. 55+00.00
21st STREET / MAIZE ROAD INTERSECTION

Baughman Company, P.A.
315 Ellis St. Wichita, KS 67211 P 316-262-7271 F 316-262-0149
ENGINEERING | SURVEYING | PLANNING | LANDSCAPE ARCHITECTURE

JANUARY, 2012
SHEET
21
OF
65