

BL. Sta. 50+85.28 Radius

BL. Sta. 50+89.92
END 9" Reinf. Conc. Pvmt.
BEGIN 9" NRDJ Conc. Pvmt.
Radius

BL. Sta. 50+75.83
BEGIN Raised Brick Median
BEGIN 6' Conc. Nose Ramp

BL. Sta. 18+96.13
BEGIN 9" Reinf.
Conc. Pvmt.
Radius

BL. Sta. 19+11.08
Radius

BL. Sta. 20+98.18
BEGIN Raised
Brick Median
BEGIN 6' Conc.
Ramp Nose
BL. Sta. 21+12.46
END 9" Reinf.
Conc. Pvmt.
Radius

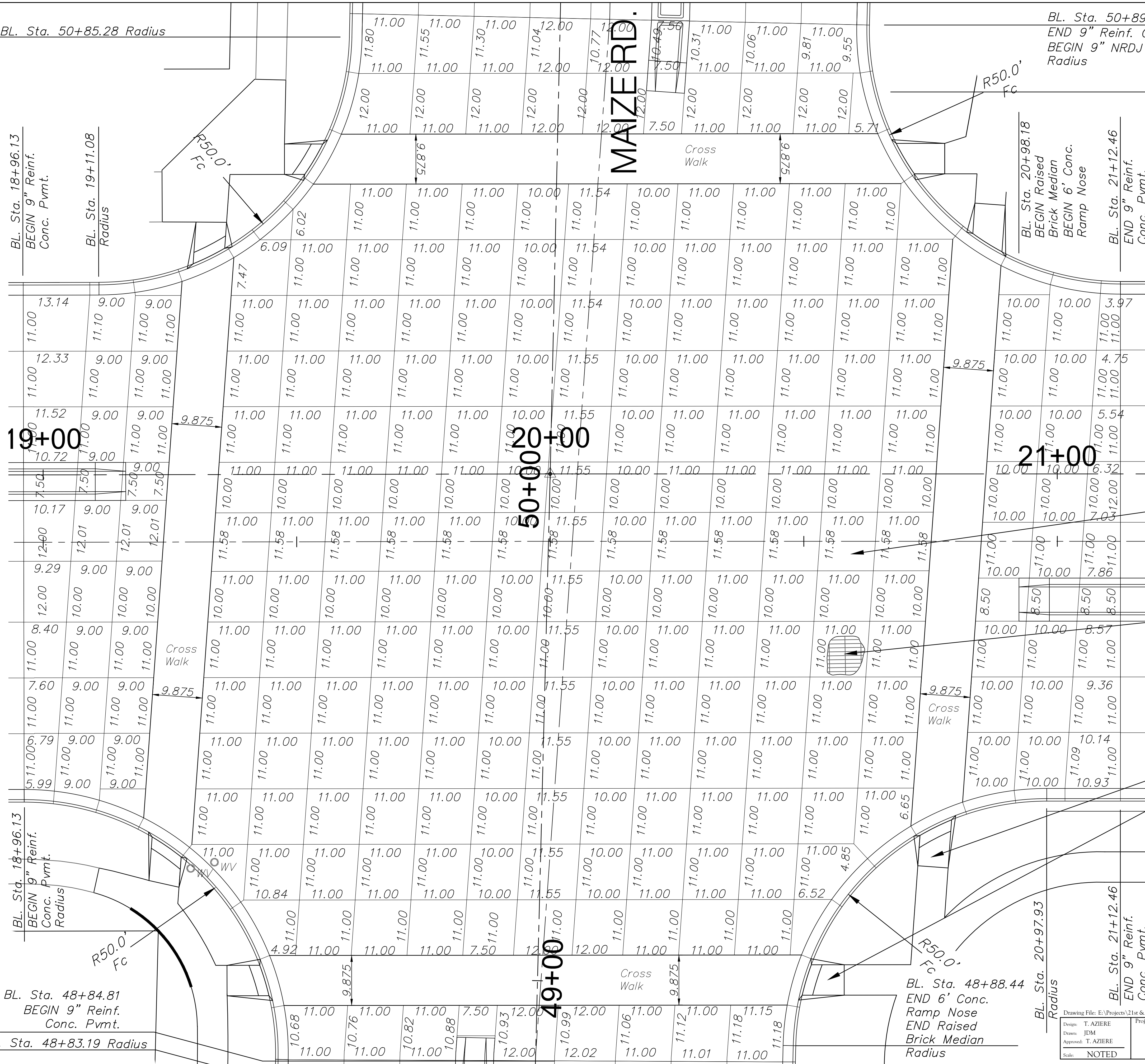
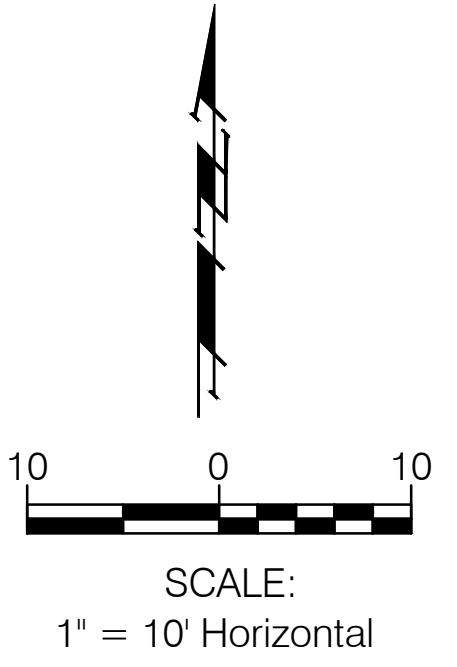

Construct 9" Reinf. Conc. Pvmt. on
6" Reinf. Crushed Rock Base.

Install 6" x 12" W4 by W4
Welded Wire Fabric

Construct Standard 6'
ADA Compliant WCR's
(Typical)(2 Each Corner)
See Detail

19+00

20+00

21+00

21st STREET

BL. Sta. 18+96.13
BEGIN 9" Reinf.
Conc. Pvmt.
Radius

BL. Sta. 48+84.81
BEGIN 9" Reinf.
Conc. Pvmt.

BL. Sta. 48+83.19 Radius

BL. Sta. 48+88.44
END 6' Conc.
Ramp Nose
END Raised
Brick Median
Radius

BL. Sta. 20+97.93
Radius
BL. Sta. 21+12.46
END 9" Reinf.
Conc. Pvmt.

Drawing File: E:\Projects\21st & Maize_1004E492\Civil 3d\base
Design: T. AZHERE
Drawn: JDM
Approved: T. AZHERE
Scale: NOTED

Project No. 1004E492 CAPITAL IMPROVEMENT PROJECT
21st Street North and Maize Road
INTERSECTION DIMENSIONS
21st STREET / MAIZE ROAD INTERSECTION

Baughman Company, P.A.
315 Ellis St. Wichita, KS 67211 P 316-262-7271 F 316-262-0149
ENGINEERING | SURVEYING | PLANNING | LANDSCAPE ARCHITECTURE

JANUARY, 2012
SHEET 22 OF 65