

SCALE:
1" = 20' HORIZONTAL
1" = 5' VERTICAL

BENCHMARKS

1. "□" Square Cut On Headwall South Side Of 53rd Street North Approximately 736.3' West Of Center Line Of Hillside. Elev. = 1369.93 NAVD 88
2. "□" Square Cut On Headwall South Side Of 53rd Street North Approximately 1522.1' West Of Center Line Of Hillside. Elev. = 1369.94 NAVD 88

Contractor Shall Follow All Applicable Best Management Practices (BMP) For Erosion Control.

Contractor To Use Extreme Caution When Excavating Near Utility Lines. Contractor To Hand Dig To Expose All Utility Lines Prior To Construction. Verify Depth To Determine Conflict If Any.

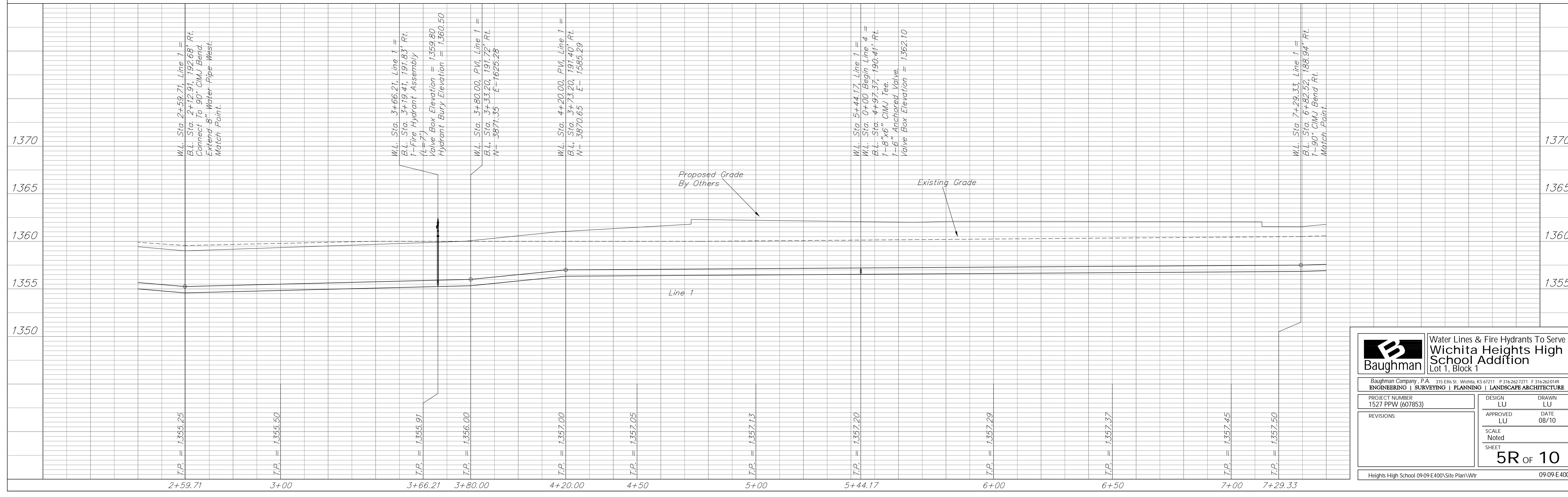

Baughman Water Lines & Fire Hydrants To Serve
Wichita Heights High School Addition
Lot 1, Block 1

Baughman Company, P.A. 315 Ellis St. Wichita, KS 67211 P 316-262-7271 F 316-262-0149
ENGINEERING | SURVEYING | PLANNING | LANDSCAPE ARCHITECTURE

PROJECT NUMBER: 1527 PPW (607853) DESIGN: LU DRAWN: LU
APPROVED: LU DATE: 08/10
REVISIONS: SCALE: Noted SHEET: 5R OF 10

Heights High School 09-09-E400\Site Plan\Wtr 09-09-E400