



STREET IMPROVEMENTS FOR
135th Street West
from 13th Street to 21st Street North

CROSS SECTIONS
STA. 58+46.04
TO
STA. 59+50.00
SHEET TITLE
MKEC PROJ #10265
PROJECT NUMBER

DESIGN BY: JRA
DRAWN BY: DPG
CHECKED BY: JRA

ISSUED: February 2012
REVISED:

SHEET NO.
227 of 231

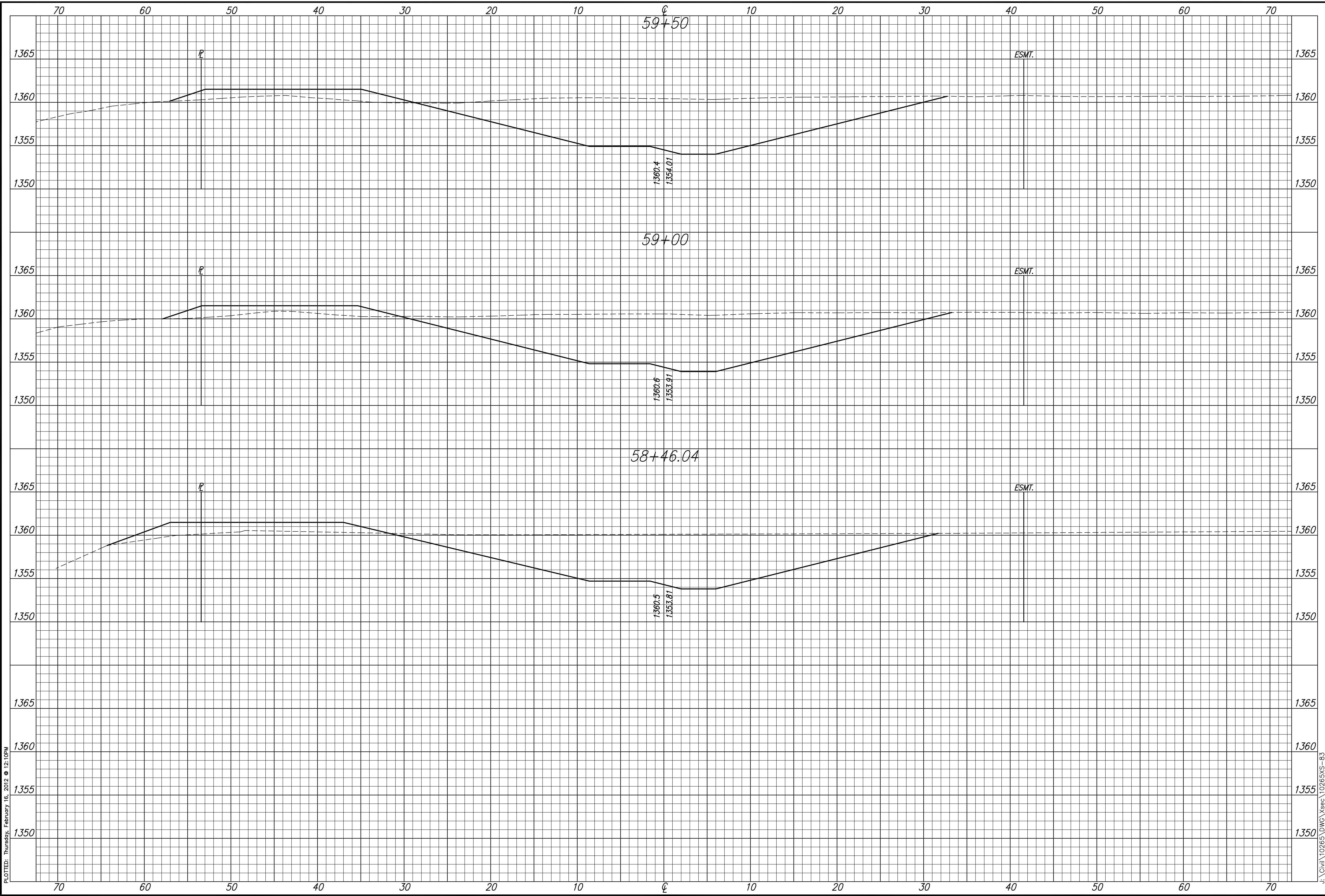

PLotted: Thursday, February 16, 2012 12:10 PM

J:\Civil\10265\DWG\Xsec\10265XS-83