



**STREET IMPROVEMENTS FOR
135th Street West**
from 13th Street to 21st Street North

**ASPHALT DRIVE
ENTRANCE
LAYOUT**

SHEET TITLE
MKEC PROJ #10265
PROJECT NUMBER

DETAILS

DESIGN BY
DPG
DRAWN BY
JRA
CHECKED BY

ISSUED
February 2012

REVISED
Revised Length of
Pipes.

SHEET NO.

63R of 231

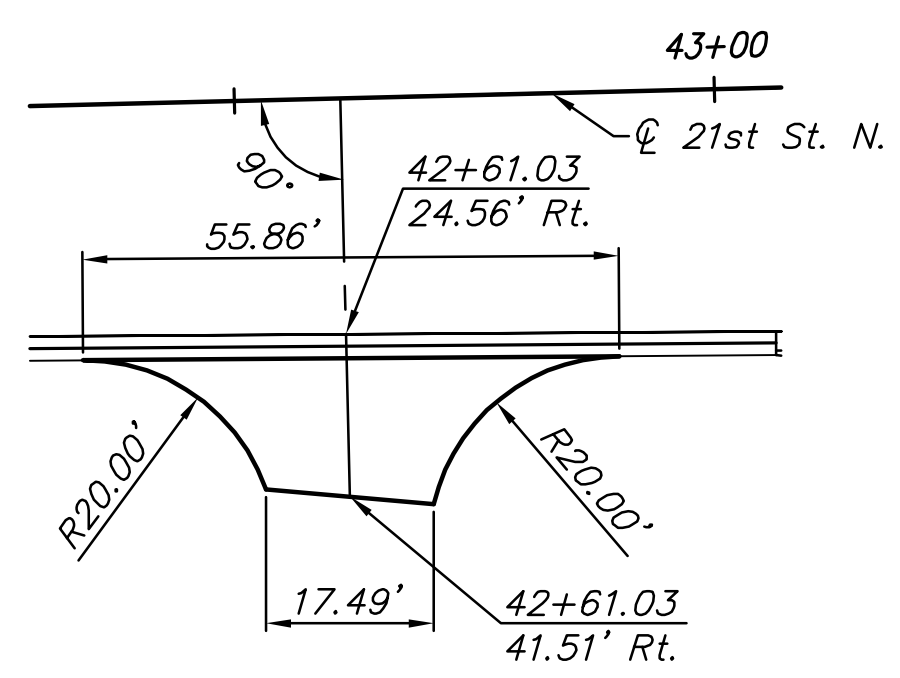

21ST STREET ENTRANCE PLAN
Sta. 42+61.03, Rt.

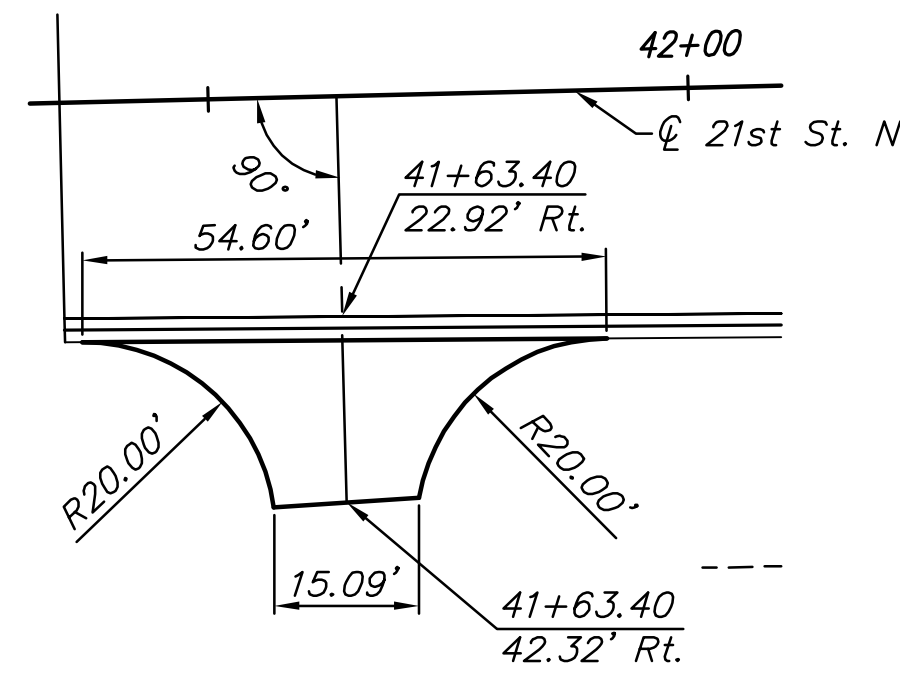

21ST STREET ENTRANCE PLAN
Sta. 41+63.40, Rt.

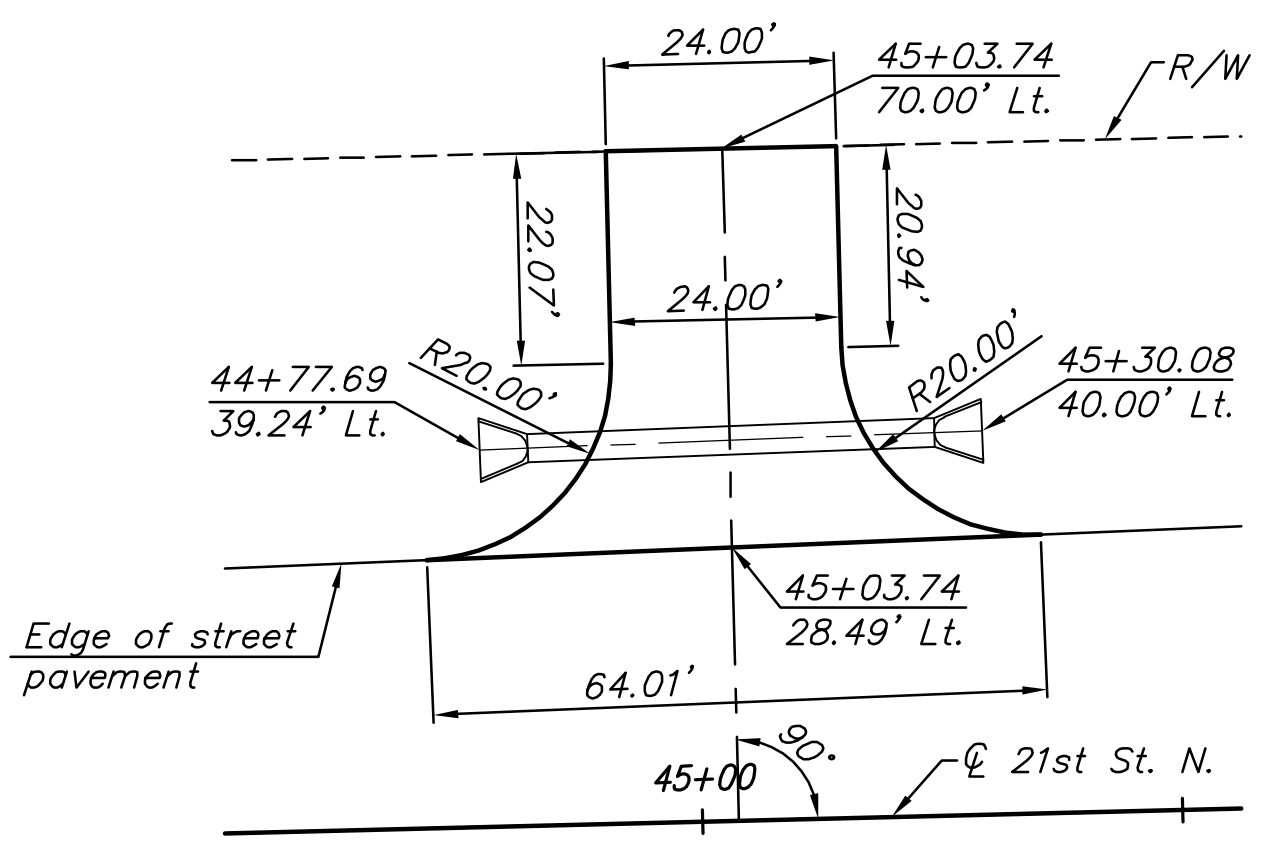

21ST STREET ENTRANCE PLAN
Sta. 45+03.74, Lt.

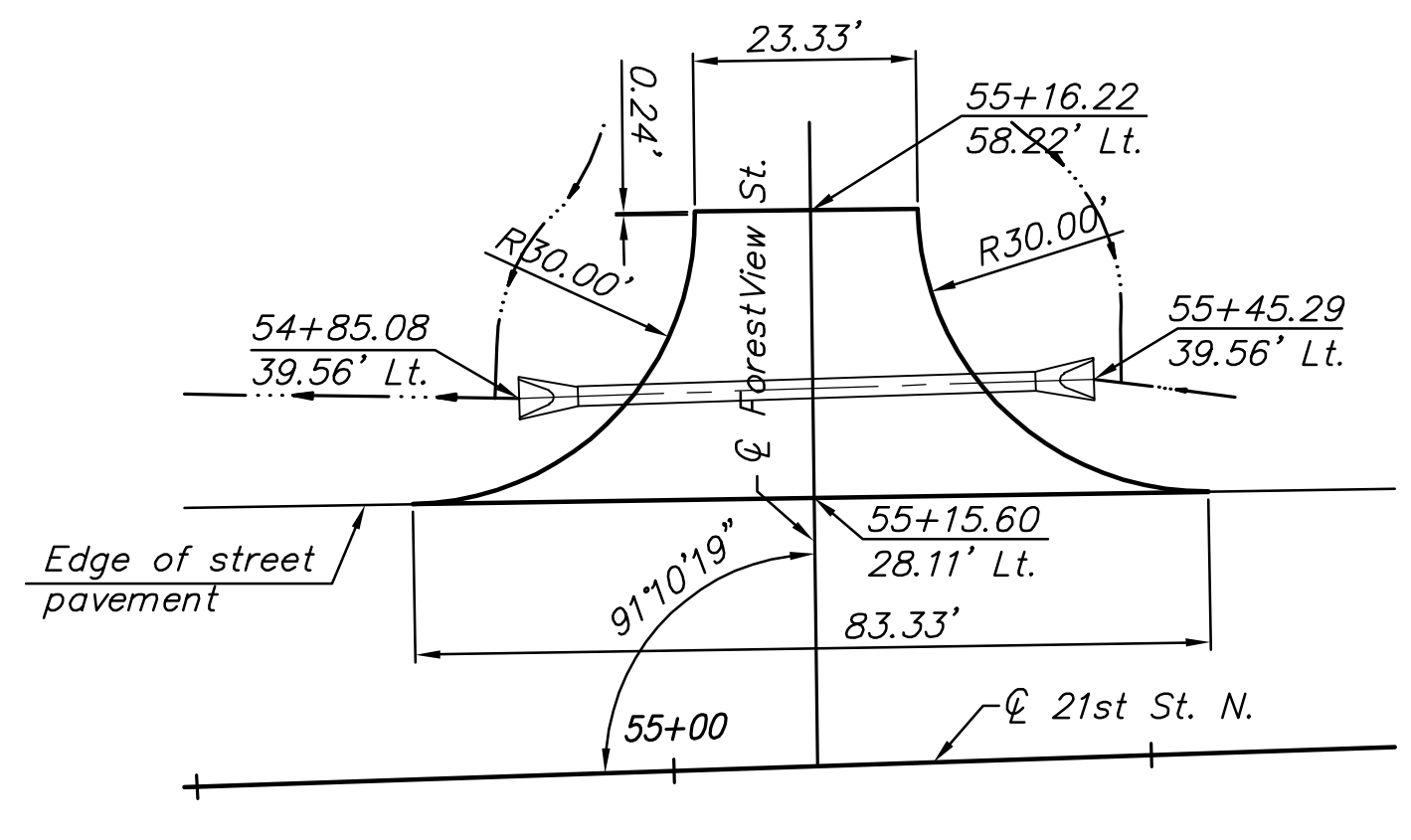

21ST STREET @ FOREST VIEW ST. PLAN
Sta. 55+15.60, Lt.

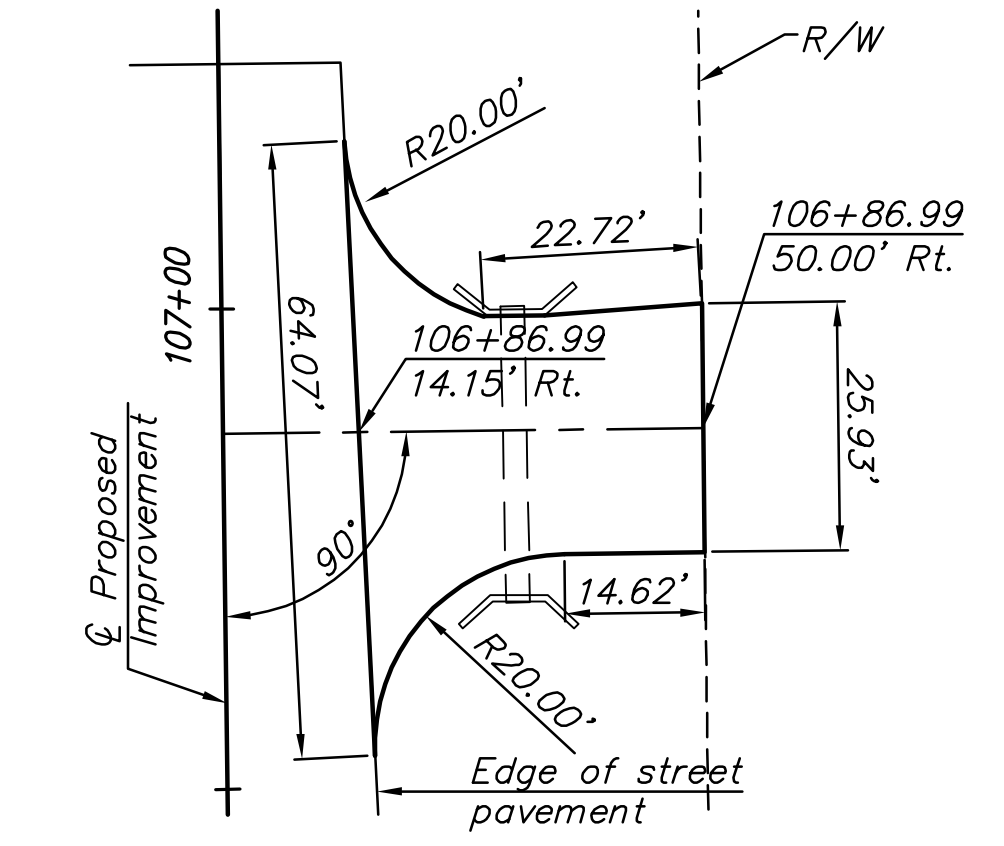

135TH STREET ENTRANCE PLAN
Sta. 106+86.99, Rt.

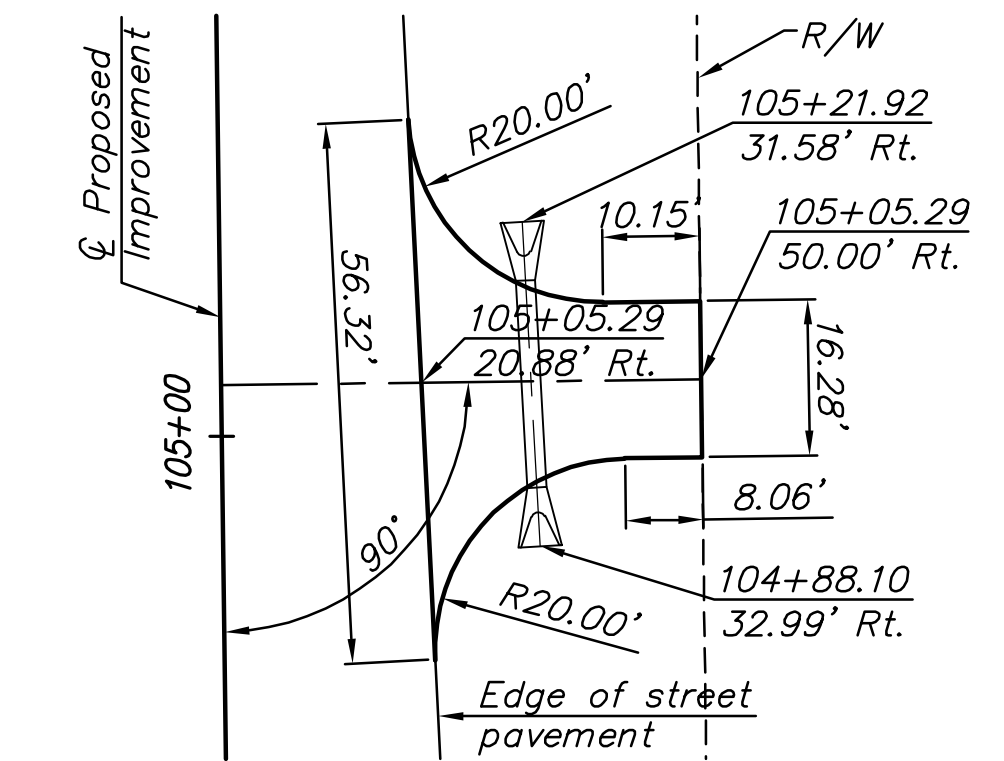

135TH STREET ENTRANCE PLAN
Sta. 105+05.29, Rt.

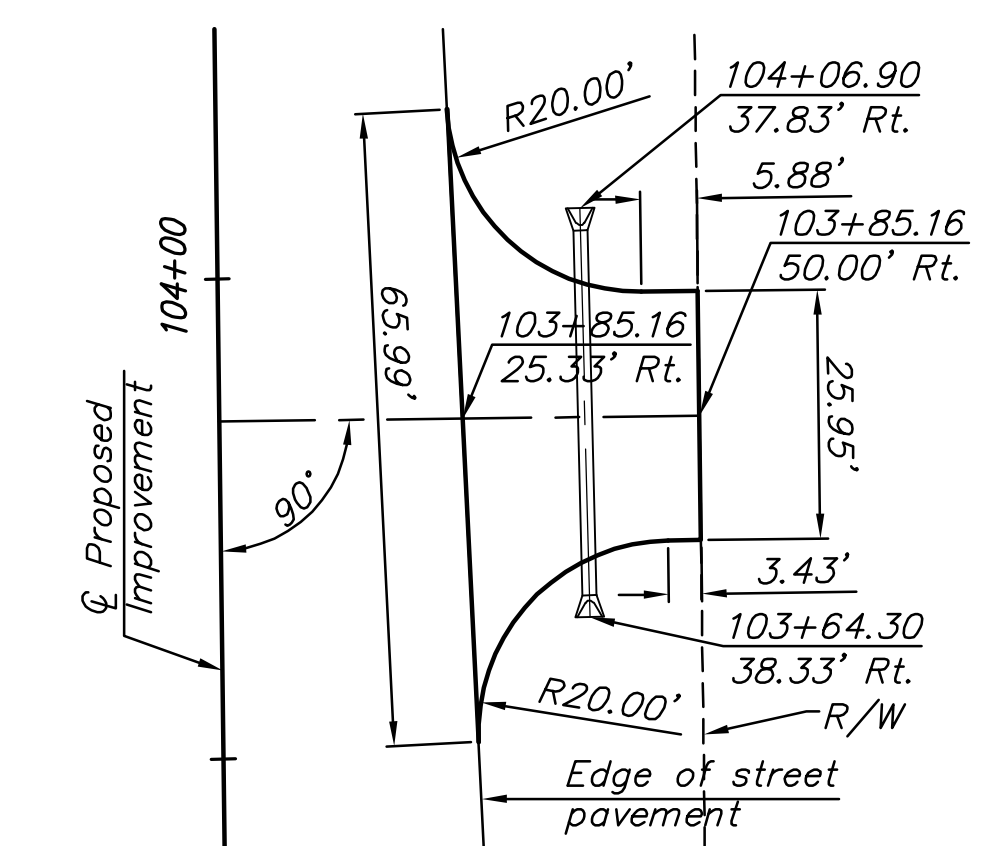

135TH STREET ENTRANCE PLAN
Sta. 103+85.16, Rt.

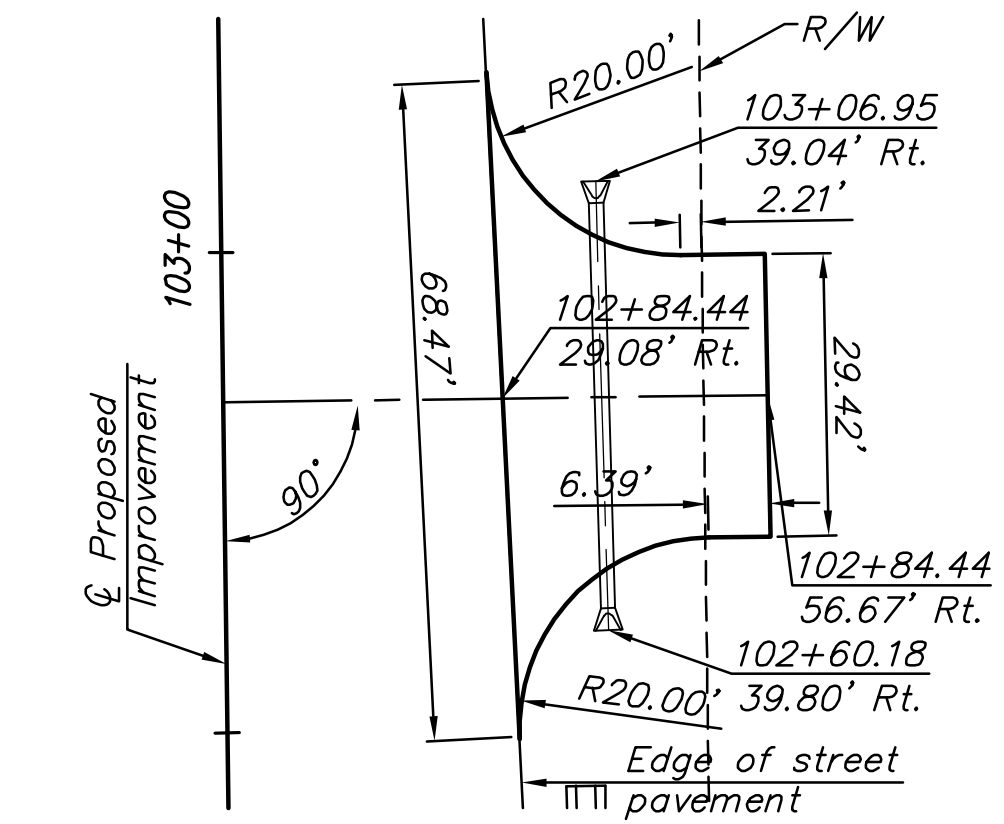

135TH STREET ENTRANCE PLAN
Sta. 102+84.44, Rt.

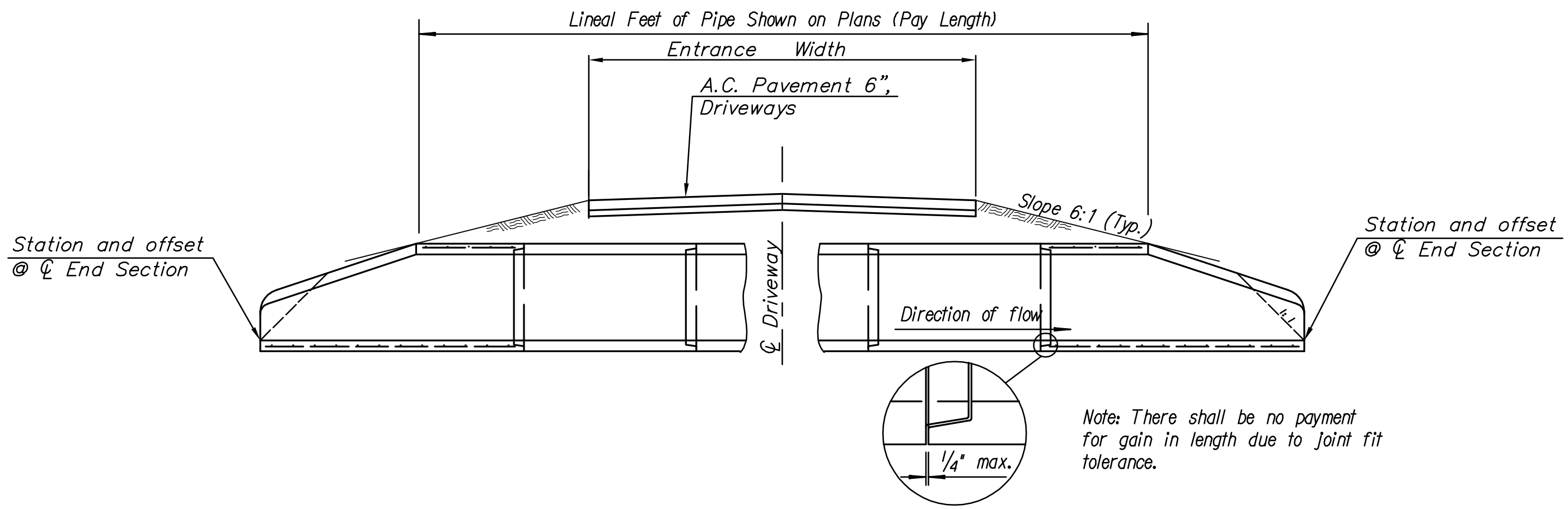

TYPICAL ENTRANCE SECTION WITH CULVERT

ENTRANCE PIPE AND ASPHALT DRIVEWAY APPROACH SUMMARY TABLE												
☐ Driveway Station	Side	Culvert Type	Size or Bid Designation Sq. Ft.	Lin. Ft. of Pipe	# of End Sections	End Section Location (See Detail)						A.C. Pavement 6", Driveways (Sq. Yds.)
						Station	Offset	Flow	Station	Offset	Flow	
135TH ST. WEST												
102+84.44	Rt.	RCP	Pipe, SWS, 18", Entrance	42.27' Δ	2	102+60.18	39.80 R	1352.36	103+06.95	39.04 R	1352.03	109.36
103+85.16	Rt.	RCP	Pipe, SWS, 18", Entrance	38.10' Δ	2	103+64.30	38.33 R	1351.63	104+06.90	37.83 R	1351.33	90.30
105+05.29	Rt.	RCP	Pipe, SWS, 24", Entrance	26.60' Δ	2	104+88.10	32.99 R	1351.19	105+21.92	31.58 R	1351.33	71.81
106+86.99	Rt.	None										120.66
21ST ST. NORTH												
41+63.40	Rt.	None										46.43
42+61.03	Rt.	None										44.25
45+03.74	Lt.	RCP	Pipe, SWS, 36", Entrance	41.89' Δ	2	44+77.69	39.24 L	1355.43	45+30.08	40.00 L	1355.21	129.78
55+15.60	Lt.	RCP	Pipe, SWS, 24", Entrance	52.95' Δ	2	54+85.08	39.56 L	1354.23	55+45.29	39.56 L	1354.42	121.00

See Sh. No. 77 for RCP Details