

Sta. 97+05.2
Exist. MH U
Match Point

Sta. 102+37.7
Exist. MH V (See Typical MH Section, sheet 12)
Seal 54" opening (N&S)
Abandon approx. 526.1 L.F. Existing 54" RCP Pipe (N)
Abandon MH and Accessway
(See Abandonment Details, sheet no. 17)

Sta. 107+63.8
Exist. MH W (See Typical MH Section, sheet 12)
Seal 54" opening (N&S)
Abandon approx. 531.5 L.F. Existing 54" RCP Pipe (N)
Abandon MH and Accessway
(See Abandonment Details, sheet no. 17)

CAUTION !!!
I-135/Kellogg Ramp
Overhead

CAUTION !!!
I-135/Kellogg Ramp
Overhead

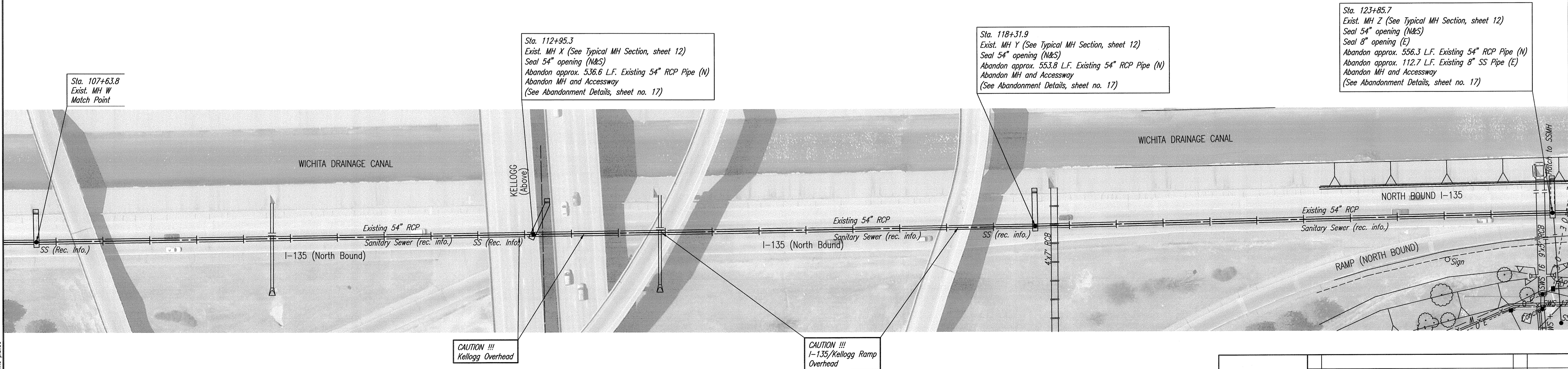

Sta. 107+63.8
Exist. MH W
Match Point

Sta. 112+95.3
Exist. MH X (See Typical MH Section, sheet 12)
Seal 54" opening (N&S)
Abandon approx. 536.6 L.F. Existing 54" RCP Pipe (N)
Abandon MH and Accessway
(See Abandonment Details, sheet no. 17)

Sta. 118+31.9
Exist. MH Y (See Typical MH Section, sheet 12)
Seal 54" opening (N&S)
Abandon approx. 553.8 L.F. Existing 54" RCP Pipe (N)
Abandon MH and Accessway
(See Abandonment Details, sheet no. 17)

Sta. 123+85.7
Exist. MH Z (See Typical MH Section, sheet 12)
Seal 54" opening (N&S)
Seal 8" opening (E)
Abandon approx. 556.3 L.F. Existing 54" RCP Pipe (N)
Abandon approx. 112.7 L.F. Existing 8" SS Pipe (E)
Abandon MH and Accessway
(See Abandonment Details, sheet no. 17)

CAUTION !!!
Kellogg Overhead

CAUTION !!!
I-135/Kellogg Ramp
Overhead

Saved: 01-13-2012 10:57:53 AM by: C:\BRYAN_S_LINK
 C:\2007\071800\001\Phase 3\071800-01-009-Demo plan06

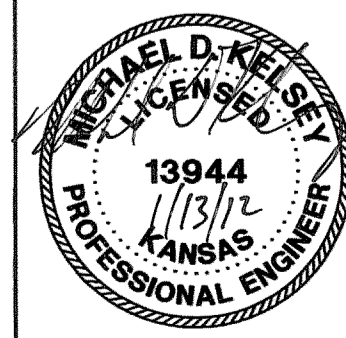
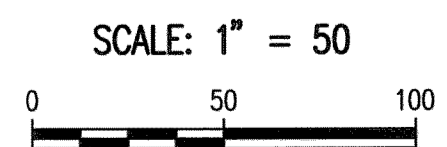

No.	Revision	By	Date

RELOCATION OF SANITARY SEWER NO. 23
PHASE 3: ABANDONMENT PLANS
SANITARY SEWER ABANDONMENT PLAN
 JAMES L. ARMOUR, P.E. - CITY ENGINEER
 CITY OF WICHITA PROJECT NO. 468-84375b

PROFESSIONAL ENGINEERING CONSULTANTS, P.A.
 303 SOUTH TOPEKA WICHITA, KS 67202
 316-262-2691 www.pec1.com

Designed by MDK, SAD	Job No. 35-07600-001	Sht. 9 of 20
Drawn by CSL, JAN	Date SEPTEMBER 2011	