

- NOTES:**
- Contractor to Field Verify location and Depth of All Utilities Prior to Construction and Report Findings to Project Engineer.
 - Contractor shall prepare a pavement jointing plan and submit to the Engineer for approval prior to commencing construction.

- TREE REMOVAL NOTES:**
- Existing trees shall be protected from damage during construction operations.
 - Trees that are damaged or destroyed by the Contractor during construction shall be removed and replaced at the contractor's expense.
 - Existing trees shall not be removed without prior approval of the Engineer.
 - Tree removal shall be in accordance with the City of Wichita Standards.
 - Cost of tree removal shall be Subsidiary to Site Clearing.

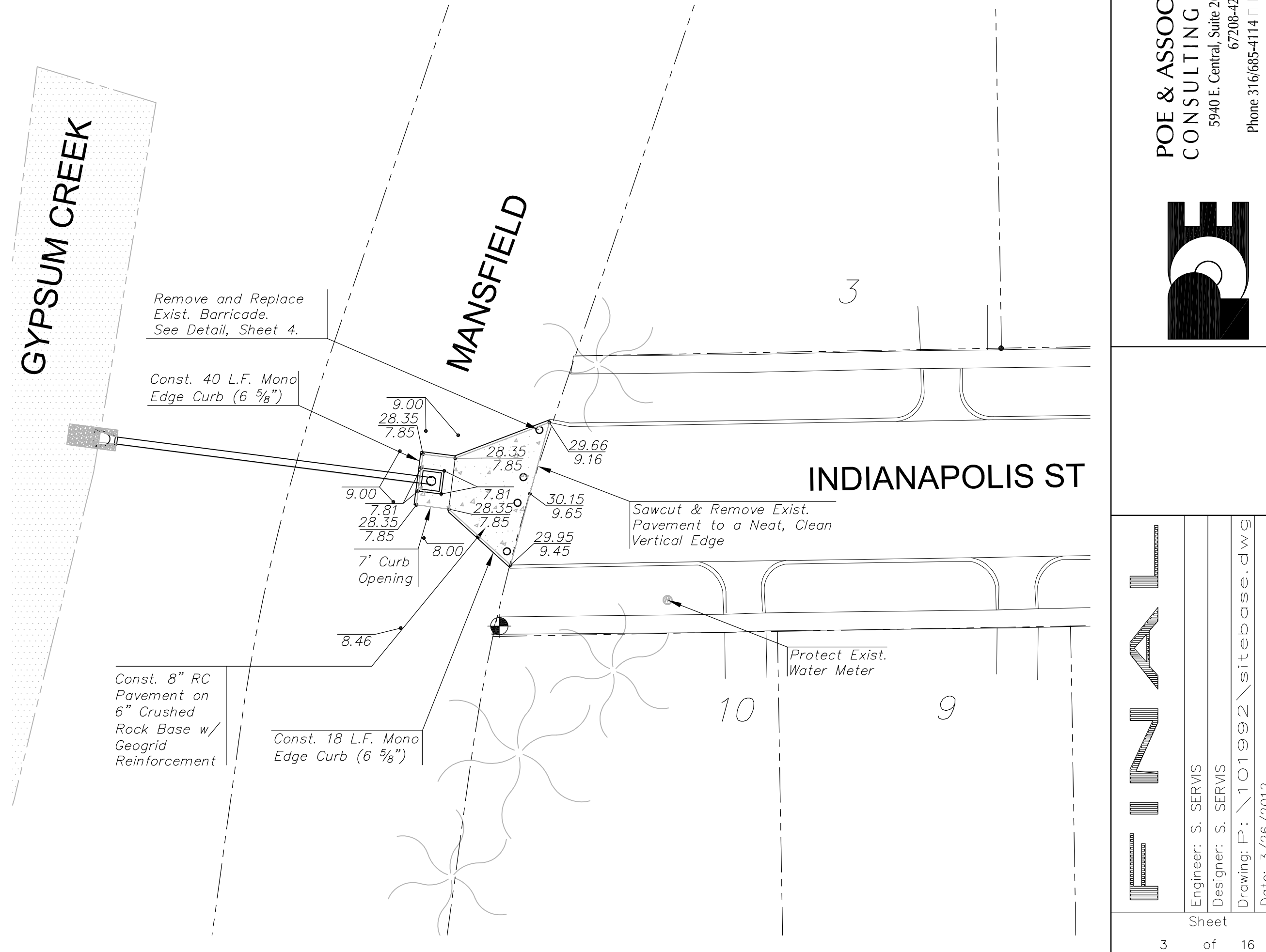
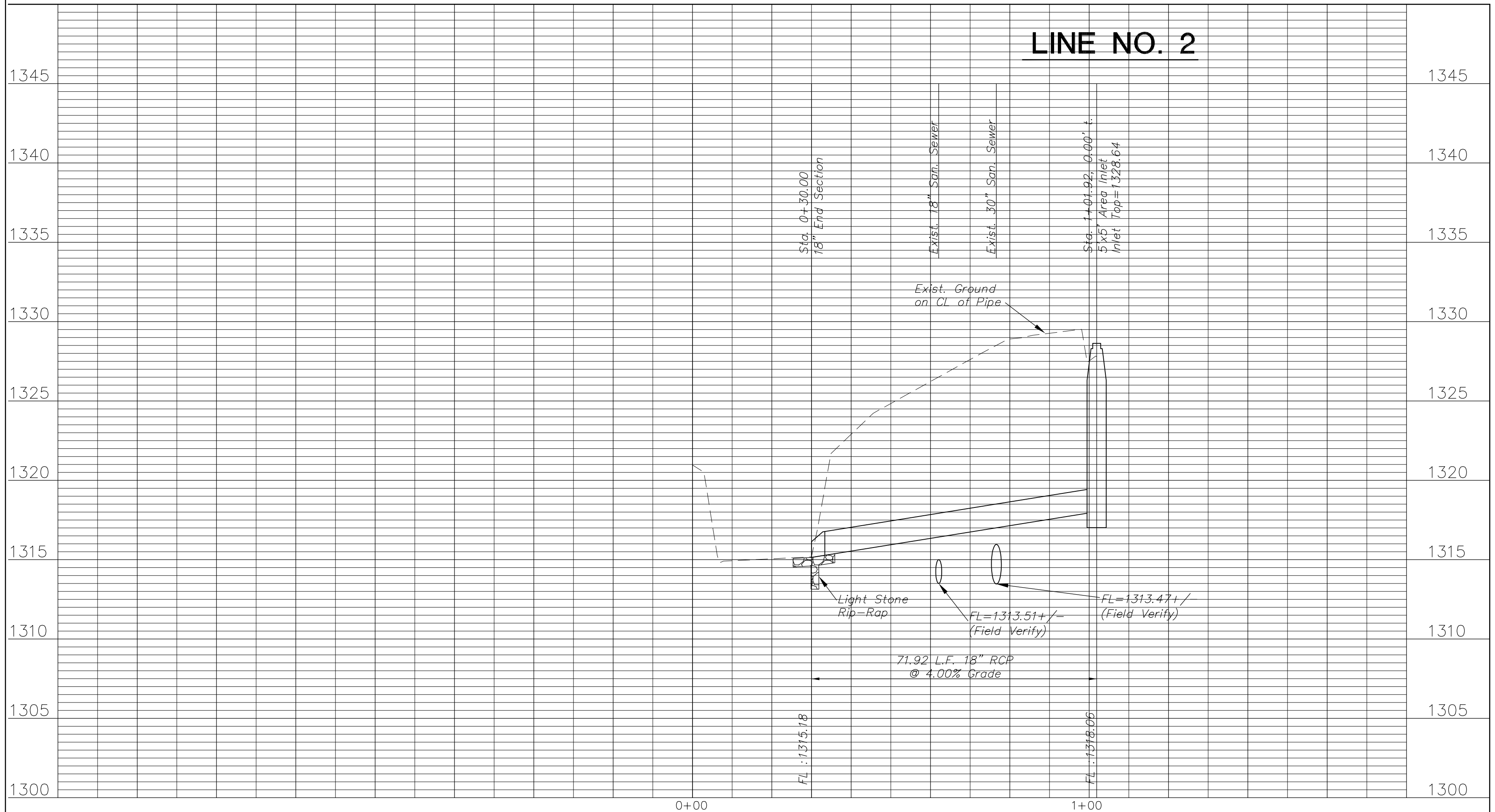
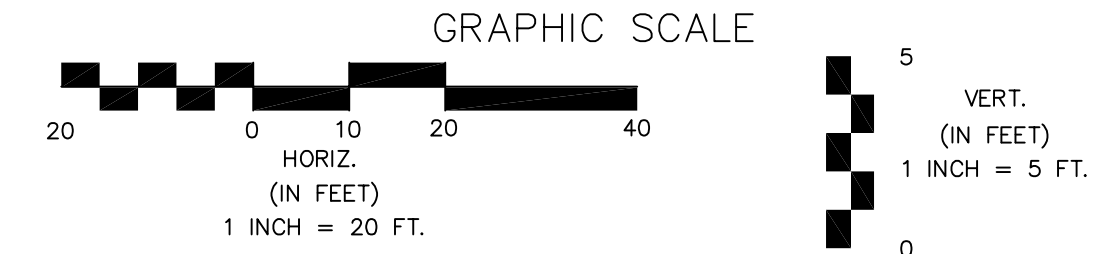

No.	Date	By	Approved	Revision

HOT SPOTS - E INDIANAPOLIS & S MANSFIELD
 STORM SEWER PLANS
 LINE 2 PLAN AND PROFILE
 CITY OF WICHITA, KANSAS
 JAMES L. ARMOUR, P.E. - CITY ENGINEER
 C.O.W. Proj. 465-84795 OCA No. 66000

POE & ASSOCIATES, INC.
 CONSULTING ENGINEERS
 5940 E. Central, Suite 200 Wichita, KS
 67206-4242
 Phone 316/685-4114 FAX 316/685-4444

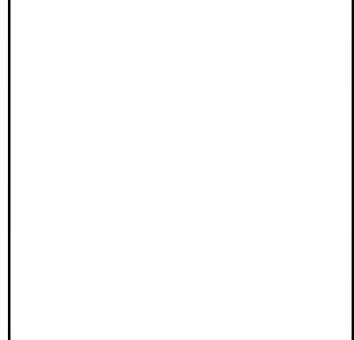

FINAL

Engineer: S. SERVIS
 Designer: S. SERVIS
 Drawing P: 101992/sitebase.dwg
 Date: 3/26/2012

Sheet 3 of 16