

FHWA REG. NO.	STATE	PROJECT NO.	YEAR	SHEET NUMBER	TOTAL SHEETS
7	KANSAS	87 TE-0282-01	2011	1	112

FED. AID NO. TEA-TQ28(201)

**INDEX OF SHEETS**

- 1 Cover Sheet
  - 2 General Notes
  - 3 Typical Detail
  - 4-56 Plan & Profile Sheets
    - Section A (4-14) (Sta 10+00 to 63+36.73)
    - Section B (15-24) (Sta 100+00 to 148+61.57)
    - (24) (Sta 700+00 to 700+83.85)
    - (25-29) (Sta 600+00 to 620+81.73)
    - Section C (30-36) (Sta 500+77.53 to 534+54.34) (Alt.+Portion not to be built)\*
    - (37)
    - Section D (38-52) (Sta 200+00 to 275+34.15)
    - Section E (53-56) (Sta 400+00 to 421+68.55)
  - 57-59 Plans and Profile of Segmental Ret Wall
  - 60 Wheelchair Ramp Details
  - 61 Railroad Crossing Details
  - 62-66 SWS Plans
  - 67-68 SWS Details
  - 69 Quantities
  - 70-96 Cross Sections
  - 97 Control & Coordinate Map
  - 98 Bike Pause Details
  - 99 Landscape Details
  - 100 Bridge Details
  - 101 Railing, Fence and Miscellaneous Details
  - 102-104 Street Marking and Sign Plans
  - 105 Sign Quantity, Details and Pmnt. Marking Quantity
  - 106-112 Erosion Control Plan & Details
- \* Alternate, Sta 500+83.51 to Sta 517+19.33 (Sheet 30 to 33).  
 Portion not to be built, Sta 517+19.33 to Sta 534+54.34  
 (Plan and profile: Part of Sheet 33, Sheet 34, 35 and 36  
 Retaining Wall: Sheet 58 and SWS Plan and Profile: Part of Sheet 64)

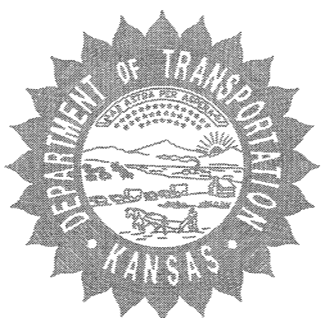

# BIKE / PEDESTRIAN PATH FROM GARVEY PARK TO PLANEVIEW COMMUNITY CENTER

CITY OF WICHITA PROJECT NUMBER 472-84932

COW OCA #: 707030

KDOT PROJECT: 87TE 0282-01

FEDERAL PROJECT: TEA-TQ28(201)

WICHITA, KANSAS

JIM ARMOUR PE, CITY ENGINEER

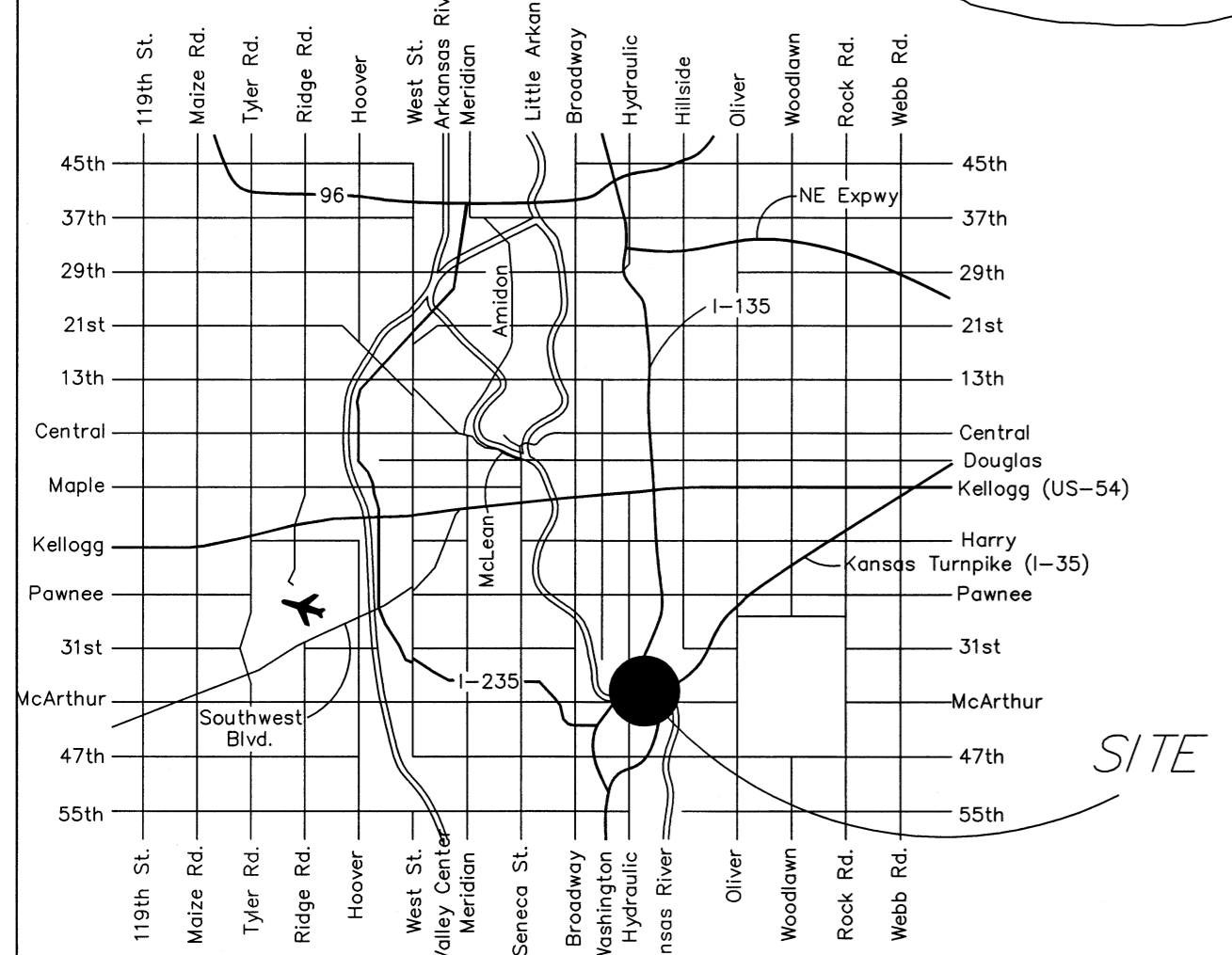
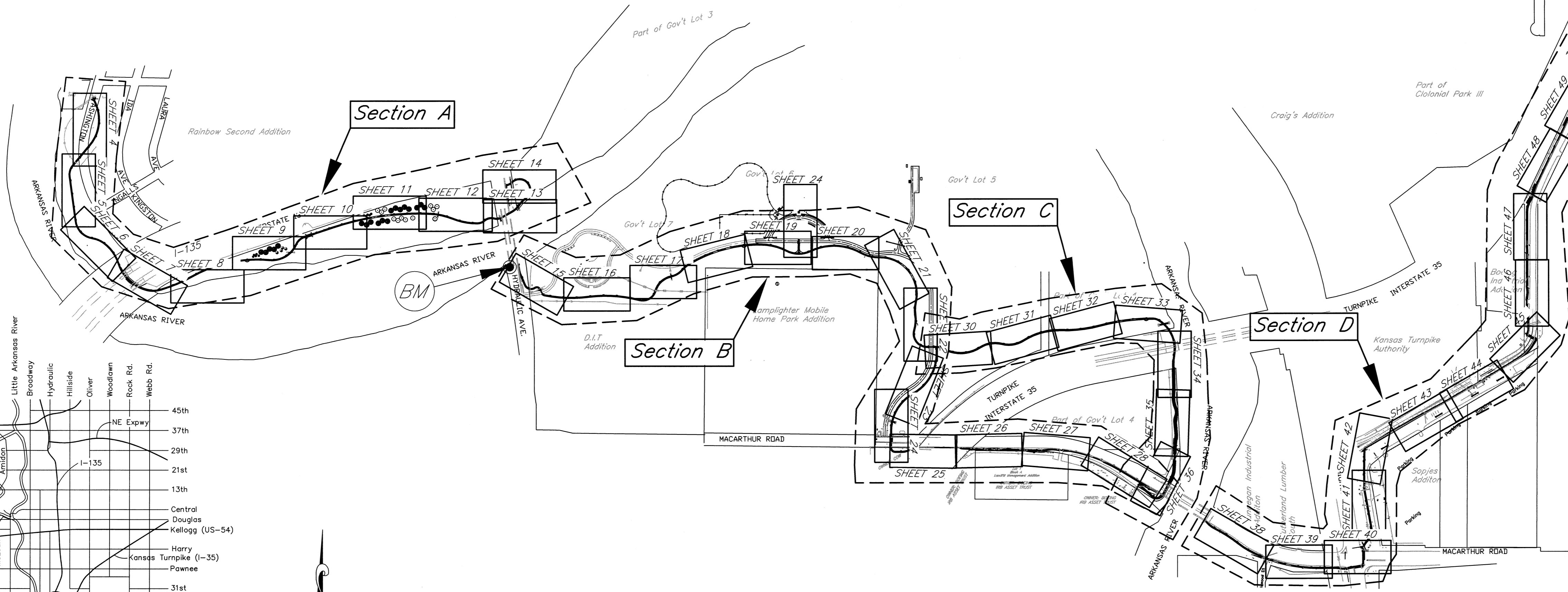
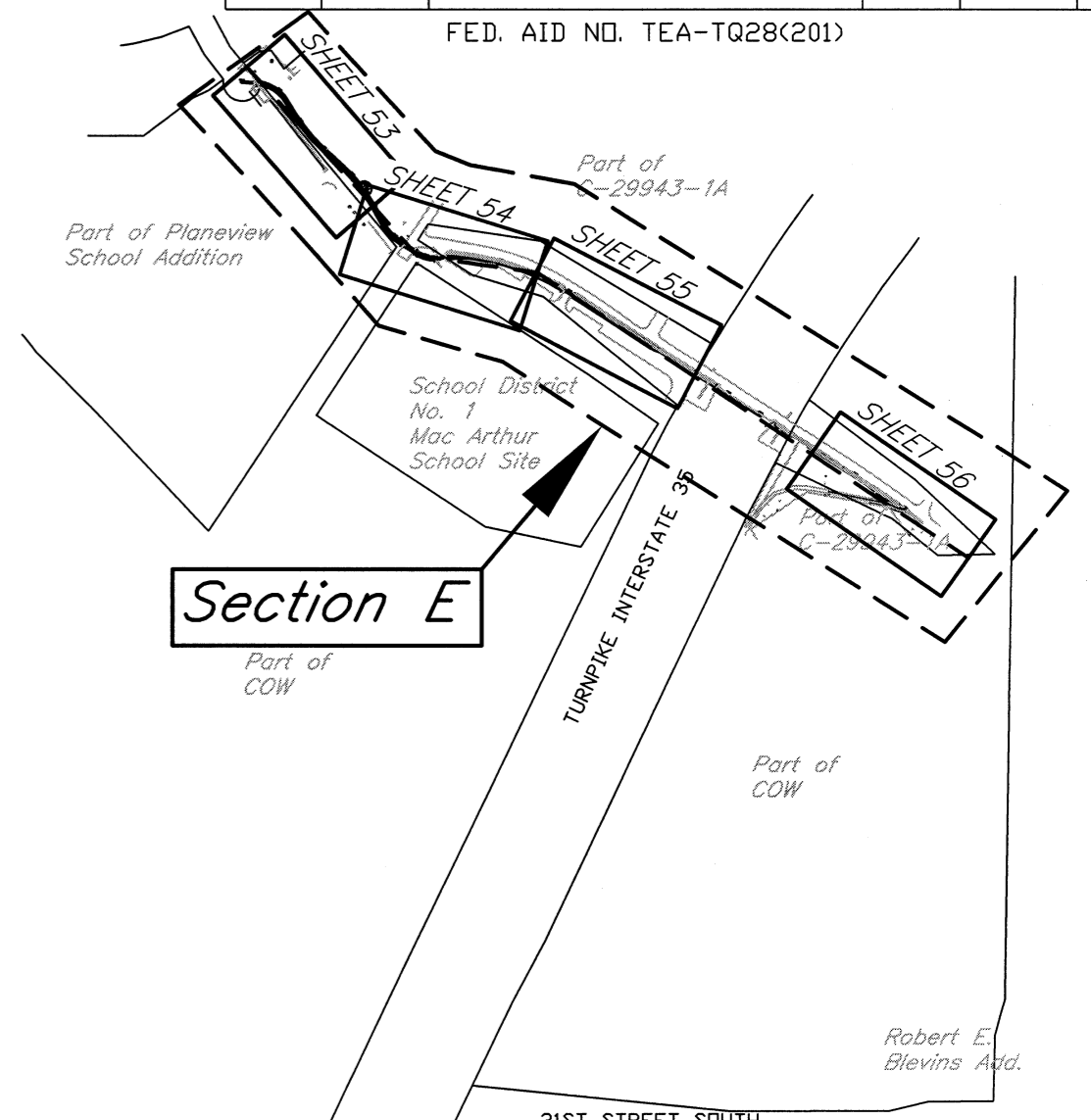

SITE

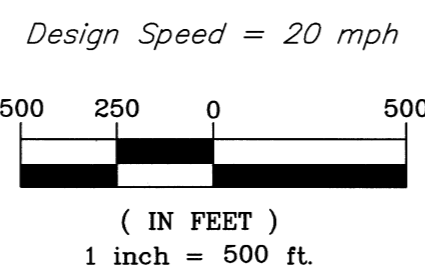

Benchmark:  
 COW Benchmark over the abutment on  
 the southwest corner of Hydraulic St.  
 bridge on Arkansas river.  
 Elevation = 1285.48  
 Refer Sheet 97 for complete listing of  
 BM and control points.

APPROVED - DATE March 16, 2012  
  
 JIM ARMOUR, P.E.  
 CITY ENGINEER  
 PROJECT NO. 472-83889



516 S. Market,  
 Wichita, KS 67202  
 316/264-0242

August 2011

LOCATION MAP