



Wichita/Sedgwick County Stormwater As-Built Certification form



A completed copy of this form must be submitted with all as-built plans, if necessary.

Submit completed form(s) to City of Wichita Engineering 455 N. Main 7th floor Wichita Ks. 67202
or to Sedgwick County Stormwater Management 1144 S. Seneca Wichita Ks. 67213

The Stormwater As-Built Certification Form must be completed when a survey is performed by a company or firm other than the engineering inspection firm.

Project Name: TRUCK FUEL STATION

Project Number/OCA: 55 PPD (607861)

Contractor: CORNEJO & SONS AND WILDCAT CONSTRUCTION

LAND SURVEYOR'S CERTIFICATION STATEMENT

To the City Engineer, City of Wichita, Kansas or County Engineer, Sedgwick County, Kansas

I, WILLIAM K. CLEVENGER of RUGGLES & BOHM, P.A., being a registered licensed surveyor in the State of Kansas, do hereby certify that I have located all stormwater features shown herein were located in accordance with the current Standards of Practice as adopted by the Kansas Society of Land Surveyors. I certify the location, elevation and description of these features.

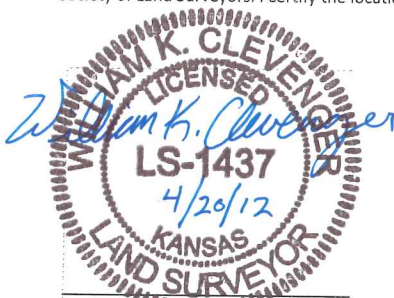

Registered Licensed Surveyor Seal/
Signature

RUGGLES & BOHM, P.A.

Land Survey Firm

City of Wichita Public Works & Utilities ♦ Engineering ♦ 455 N Main 7th floor ♦ Wichita, Kansas 67202 ♦ (316) 268-4501
City of Wichita Public Works & Utilities ♦ Stormwater Management ♦ 455 North Main 8th Floor ♦ Wichita, Kansas 67202 ♦ (316) 268-4498
Sedgwick County Public Works ♦ Stormwater Management ♦ 1144 S. Seneca ♦ Wichita, Kansas 67213 ♦ (316) 383-7901