

DEETER #2433 GRATE

24" x 24" Frame and Grate Detail

NOTE: Grates shall be imprinted on the top surface with "CITY OF WICHITA" using letters at least 1" in height. Other marking methods may be approved by the engineer.

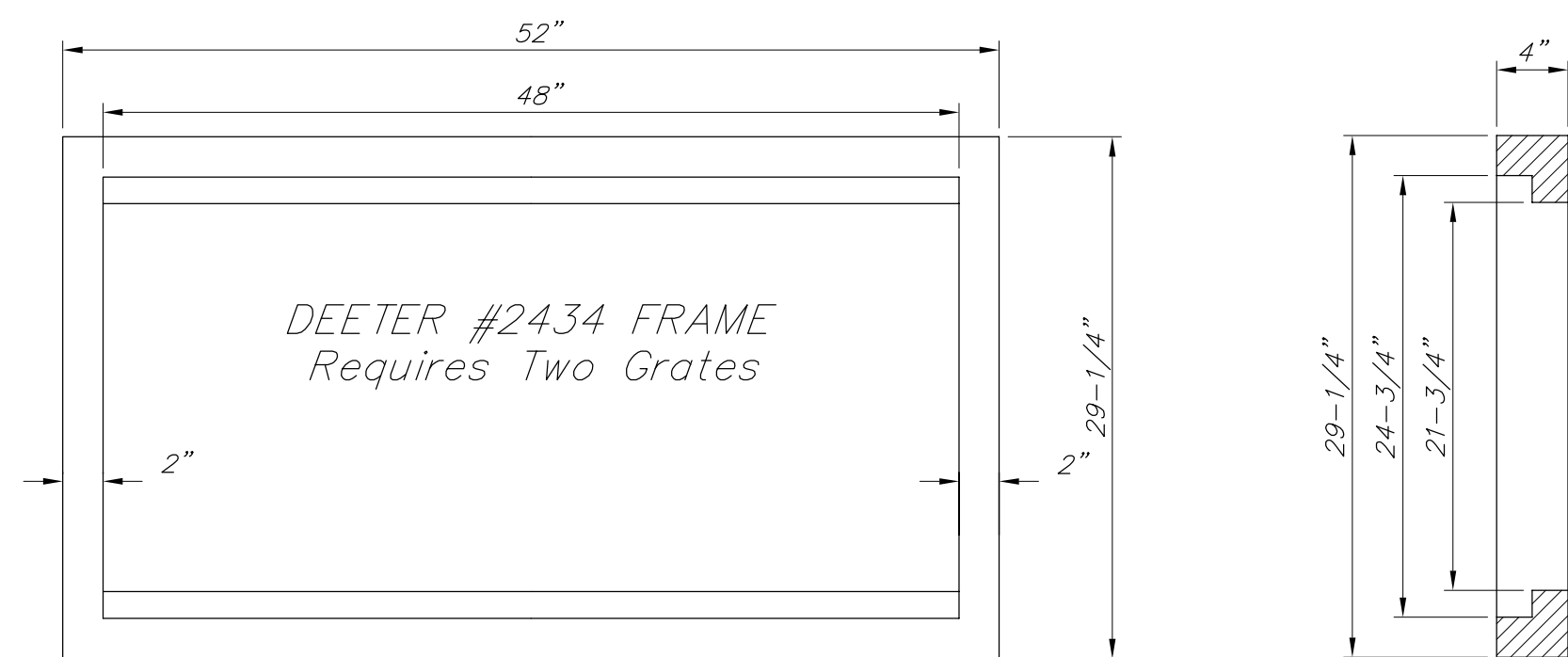

Double 24" x 24" Frame Detail

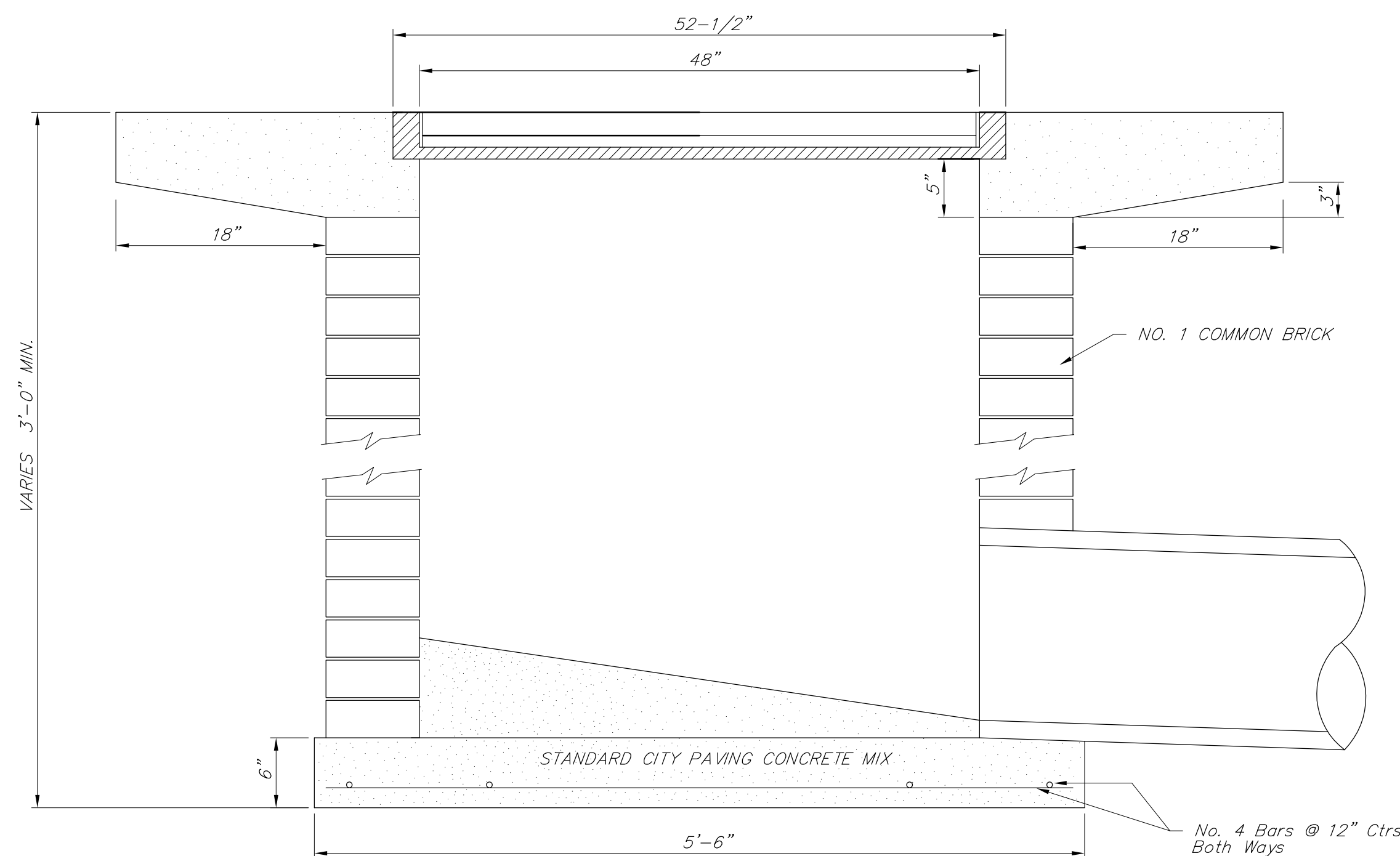
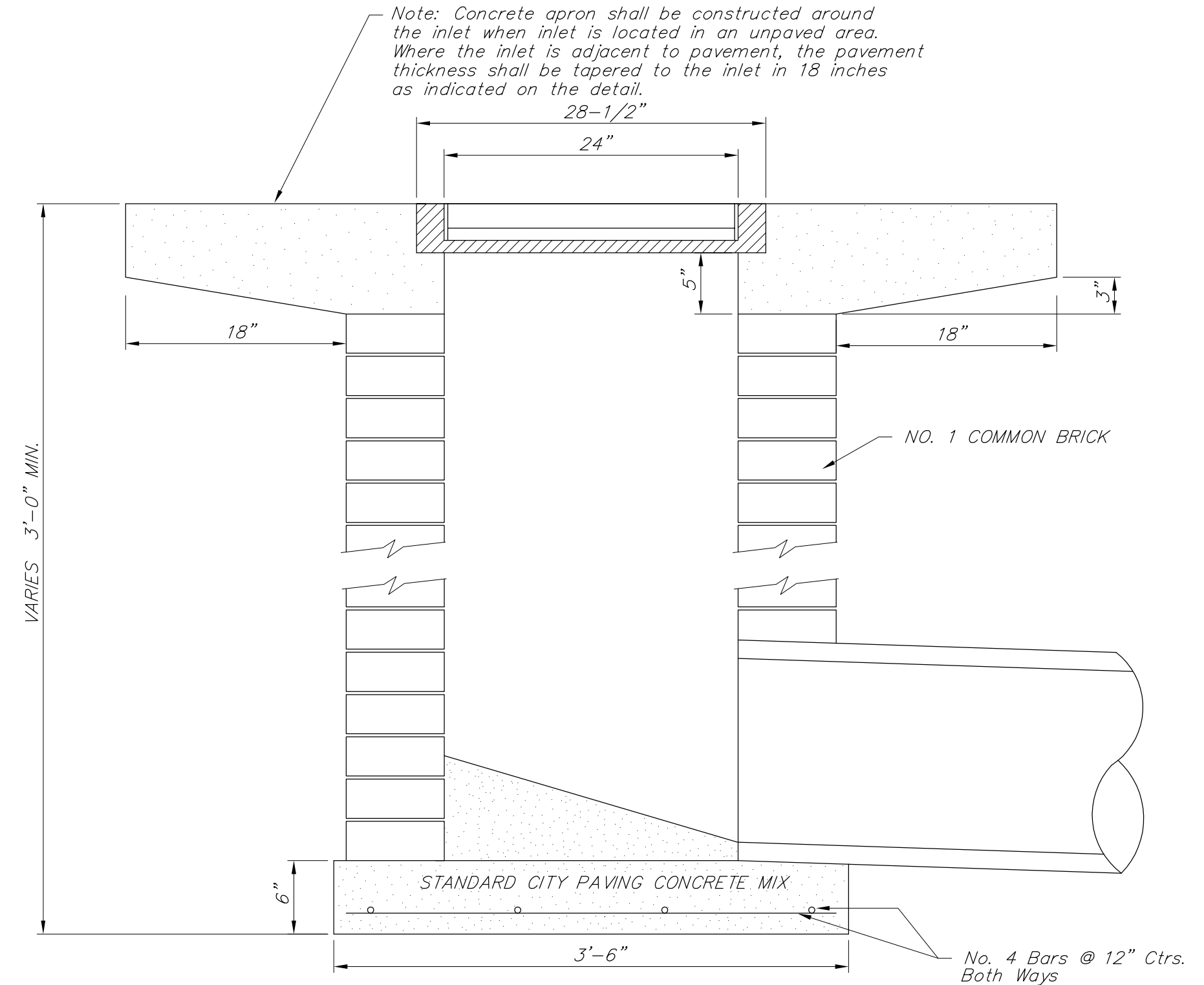
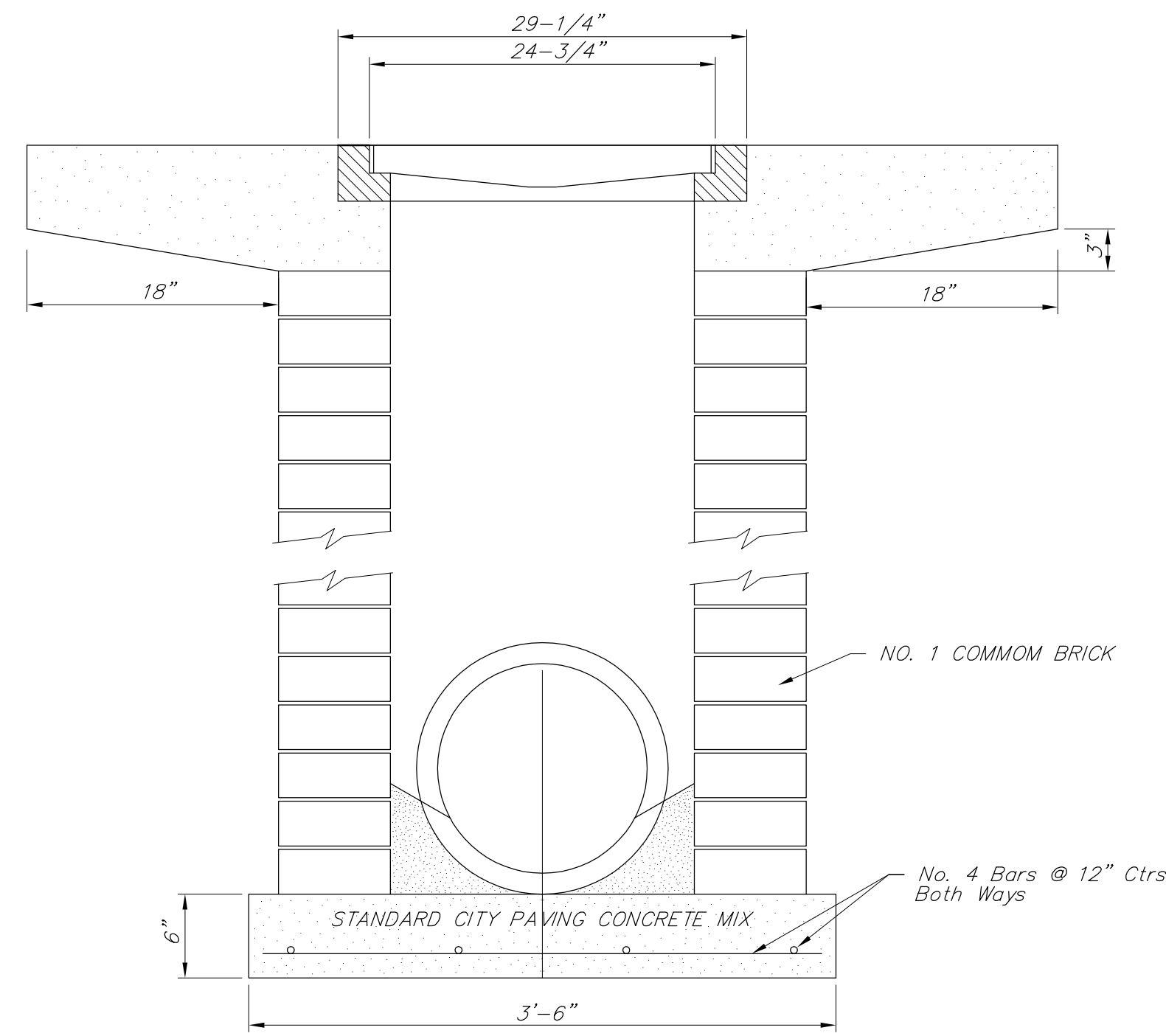

THE CITY OF WICHITA

CITY ENGINEER'S OFFICE
CITY HALL - SEVENTH FLOOR
455 NORTH MAIN STREET
WICHITA, KANSAS 67202
(316) 268-4501
(316) 268-4114 FAX

DROP INLET
2' X 2' / 2' X 4'

M. E. LINDEBAK P.E. - CITY ENGINEER

PROJECT NUMBER XXX-XXXXX	INDEX CODE XXXXXX
DATE MAR 96	SHEET X OF X

KANSAS GASTROENTEROLOGY DROP INLET DETAILS	CITY OF WICHITA, KANSAS JAMES L. ARMOUR, P.E. - CITY ENGINEER XXXX PPD (XXXXXX)	By	Approved	Revision
		Date		
POE & ASSOCIATES, INC. CONSULTING ENGINEERS 5940 E. Central, Suite 200 - Wichita, KS 67206-0242 Phone 316/685-4114 - FAX 316/685-4444		No.		
		Engineer: S. SERVIS		
		Designer: S. SERVIS		
		Drawing: P:\1109P\Kansas Gastro\dwg\sws\plans-rev.dwg		
		Date: 3/16/2012		
		Sheet		
		4	of	12