

LOUIS 4th ADDITION

LOUIS 2nd ADDITION

N 1661461.50 E 1654492.20
STA. 0+66.17 LINE 1
BL STA. 0+41.15, -18.61' L
CONSTRUCT SPECIAL TYPE 1A INLET (5'x3') W/ APRON
TOP ELEV. 1273.30
SEE SHEET 4

CONSTRUCT INLET CONNECTION
(BOTH SIDES)

CURB INLET PROTECTION
(BOTH SIDES)

CONSTRUCT 145 S.Y.
7" REINF. CONCRETE PAVEMENT
ON 5" REINF. ROCK BASE

GRADE 135 L.F. V BOTTOM
DITCH AT 0.60% GRADE.
PLACE 155 S.Y. CURLEX
EROSION CONTROL MAT

N 1661420.61 E 1654511.37
STA. 0+00 ELLIS =
STA. 3+00 ALTA

N 1661402.85 E 1654552.39
BM #1 SQ. CUT ON INLET TOP
ELEV. 1273.02 NAVD 88

N 1661440.75 E 1654549.33
STA. 0+00.00 LINE 1
BL STA. 3+38.27, -19.55' L
CONNECT TO EXISTING INLET
CORE DRILL AND GROUT

GRADE 110 L.F. V BOTTOM
DITCH AT 0.80% GRADE.
PLACE 132 S.Y. CURLEX
EROSION CONTROL MAT

- NOTES:
1. GRADE EXISTING GROUND SURFACE TO MATCH PROPOSED CONCRETE.
 2. PROPOSED PAVEMENT TO BE DOWELED INTO EXISTING PAVEMENT.
 3. CONTRACTOR IS ENCOURAGED TO VISIT SITE PRIOR TO BIDDING.
 4. CONTRACTOR SHALL VERIFY UTILITY CONFLICTS PRIOR TO BIDDING AND CONSTRUCTION.
 5. KANSAS GAS SERVICE IS SCHEDULED FOR RELOCATION PRIOR TO CONSTRUCTION. VERIFY PRIOR TO BEGINNING WORK.

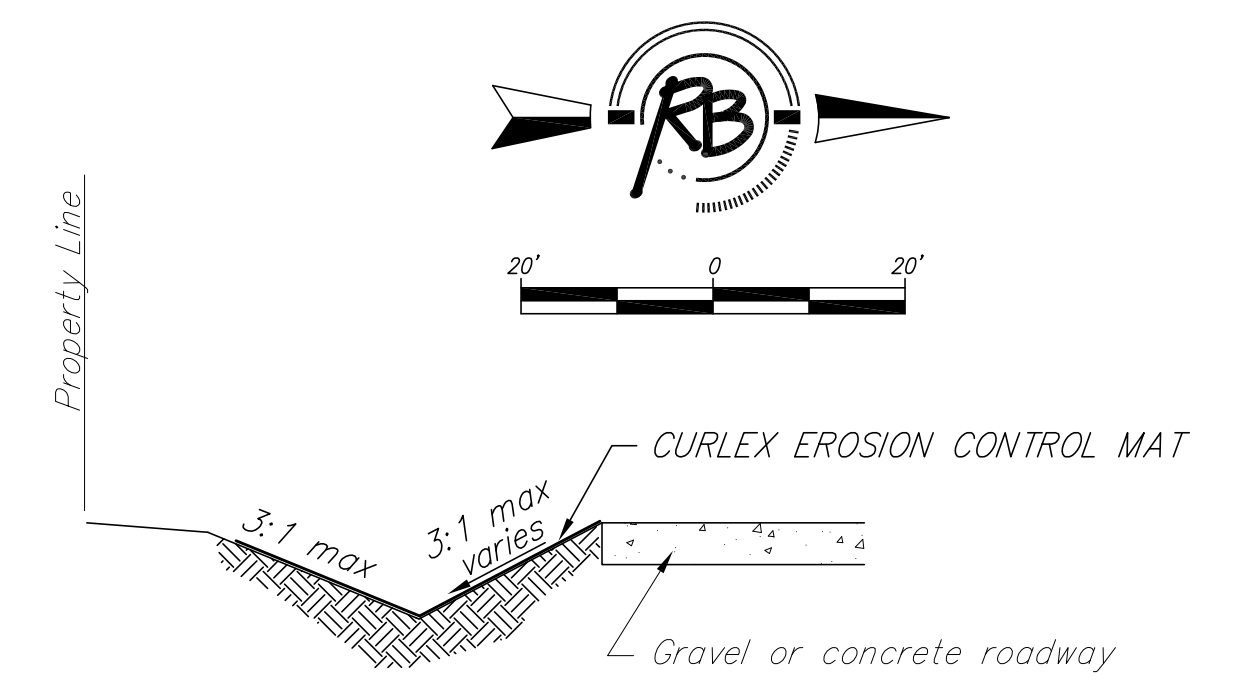
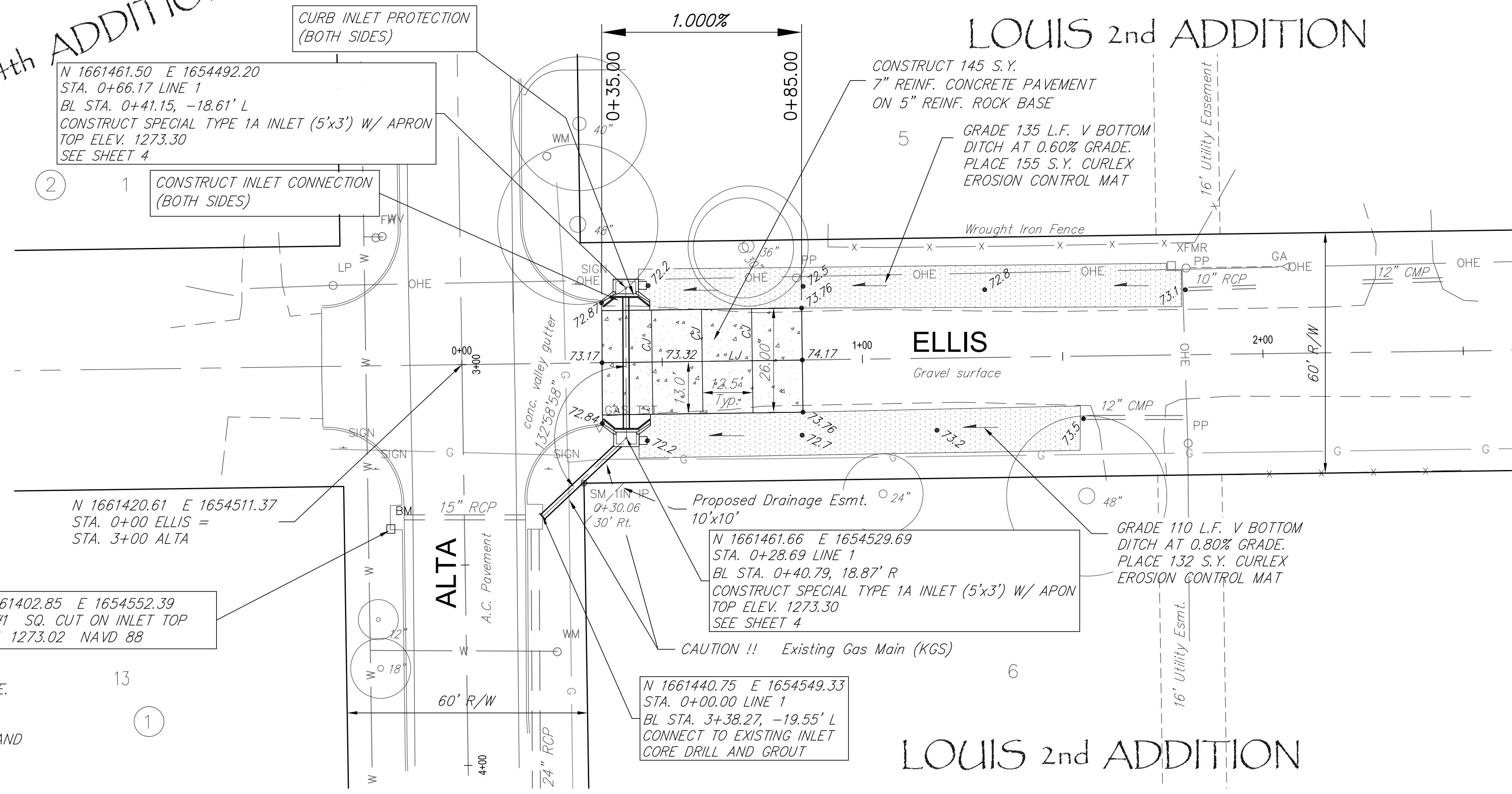

DITCH SECTION



Kuggles & Dohm, P.A.
Engineering, Surveying, Land Planning
222 North Main
Wichita, Kansas 67203
www.kdpe.com
Phone: 316.264.4008
Fax: 316.264.4021
Email: kdpe@kdpe.com

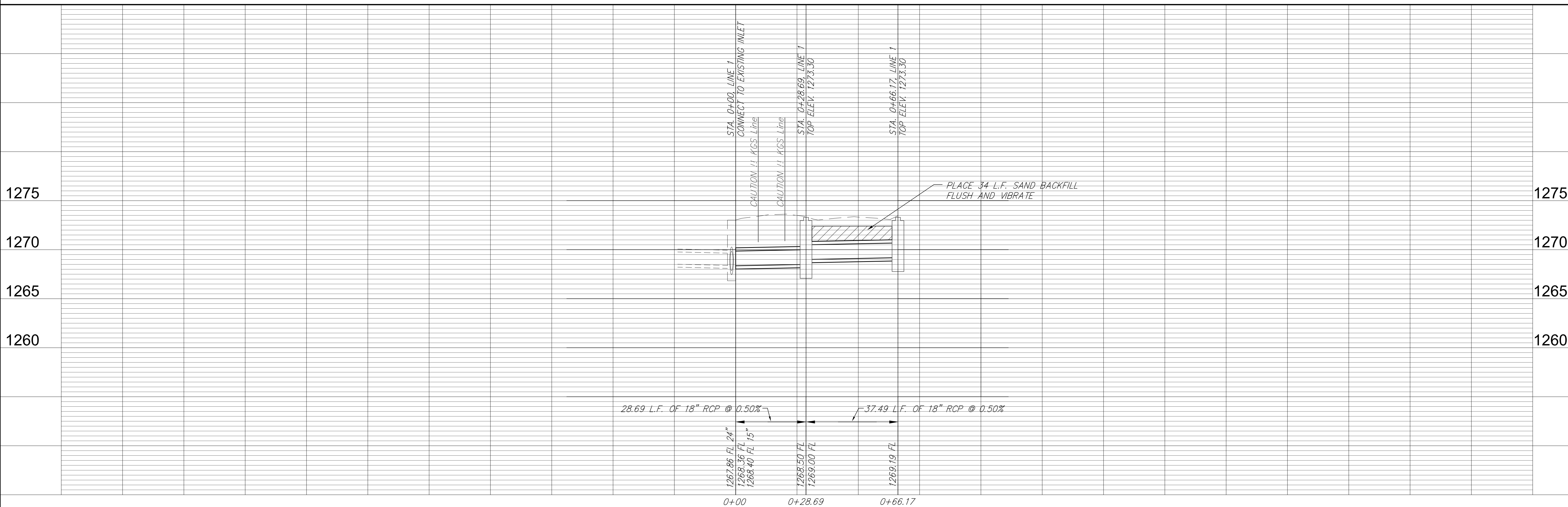

REVISION	REVIEW
DESIGN	DATE
UTILITY	May 22, 2012
PROJECT NUMBER	DRAWING FILE
STORM DRAIN & PAVING IMPROVEMENTS	
STORM DRAIN PLAN	
WICHITA, KANSAS	
RB JOB	3885P
SHEET	2
	OF 7