

PRIVATE FIRE SERVICE LINE LAWRENCE ELEMETNARY SCHOOL Lot 1, Mayberry Lawrence School Addition PROJECT NUMBER 1616 PPW (607853)

INDEX OF SHEETS

(CITY SUBMITTAL INDEX)

- C1.11 TITLE SHEET
- C1.12 WATER PLAN & PROFILE
- C1.13 WATER ASSEMBLY DETAILS
- C1.14 WATER VAULT DETAILS

BENCHMARKS

BENCH MARK #1: "□" CUT AT THE INTERSECTION OF THE BACK OF WALK & THE BACK OF CURB, 34' SOUTH & 5' EAST OF EXISTING S.E. COR. OF LAWRENCE ELEM. SCHOOL BLDG.

ELEV.= 1304.76 (NAVD 88)

GENERAL NOTES

1. Contractor will be required to provide a minimum notice of 72 hours to utility companies prior to starting any excavation as follows:

Kansas One-Call	687-2470
-----------------	----------

The Contractor must notify the following in case of an emergency:

Cox Communications	262-0661
Kansas Gas Service	383-8600
Westar Energy	383-8600
AT&T	1-800-286-8313
City of Wichita Water Utility	268-6000
Black Hills Energy	1-800-303-0357
2. All water mains and appurtenances shall be installed in accordance with City of Wichita, Kansas, Standard Specifications for the Construction of City Projects, and current policy on construction of public works improvements by private contract.
3. Opening and closing water valves shall be done slowly to prevent damage to the water distribution system from water hammer. All valves closed by the Contractor must be reopened as new construction permits. Project inspector must ascertain that any valve closed by the Contractor is reopened. Contractor will be permitted to operate water valves only when the project inspector assigned to the project is present.
4. The Contractor shall give all property owners and/or tenants of developed property directly abutting the construction of this project a minimum of ten (10) days advance notice prior to start of construction.
5. The Contractor shall be responsible for preserving property irons. The Contractor will be required to re-establish any property irons which are damaged or destroyed by his construction operations. Such irons shall be re-established by a licensed land surveyor in accordance with state laws.
6. The Contractor shall reimburse the Wichita Water Utilities for cost of tap and materials.
7. No work shall be done on this project until the project inspector has been notified and that Project Bonds have been received and approved by the City of Wichita.

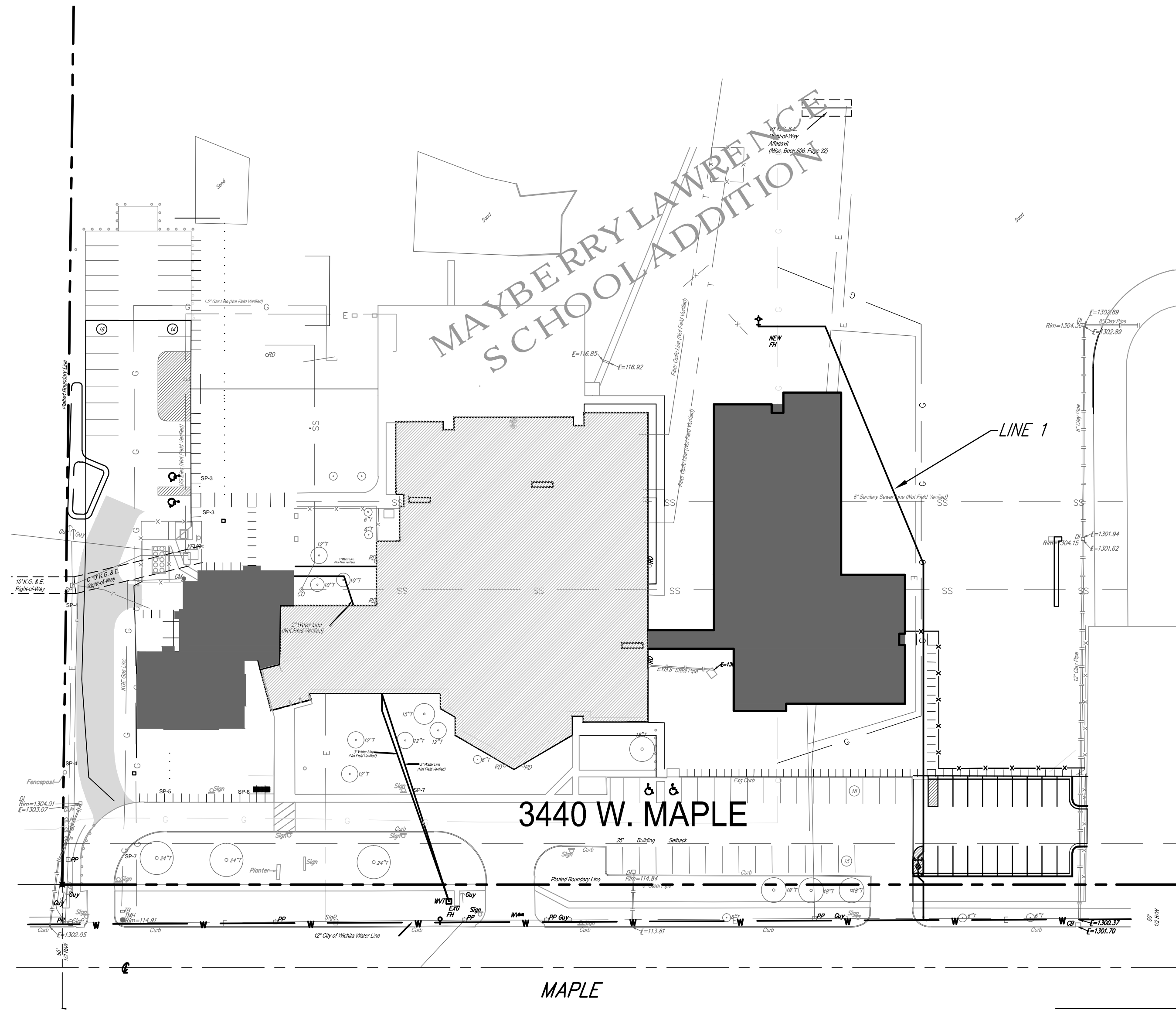

AS BUILTS	
Contractor: Boardman Enterprises	Project Inspector: Tom Jones
06/01/2012	

APPROVED AS NOTED
BY CITY ENGINEER OF WICHITA

Engineering *Julianne Kallman* 10-18-11

Water *Greg Gole* 10-19-11

Fire *Benjamin* 10-24-2011

NOTE TO CONTRACTORS

Inspection and testing for this project are to be provided by a Licensed Consulting Engineering Firm under contract with the Owner/Developer. Said inspection to be in accordance with the City of Wichita standard construction engineering practices and certified by a Licensed Professional Engineer. No work shall be performed in dedicated easements or public right-of-way by the Contractor without such inspection, nor shall any work be commenced without written authorization by the City Engineer.

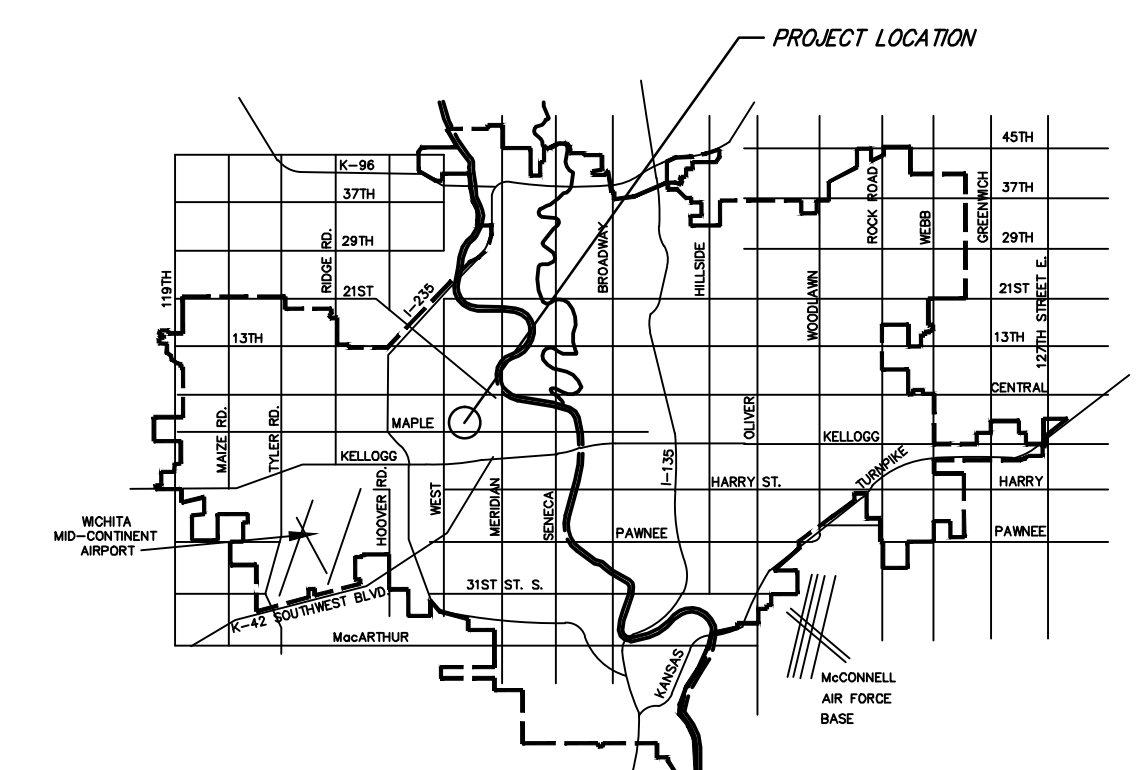

VICINITY MAP

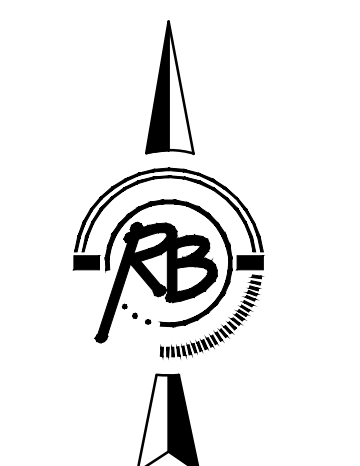
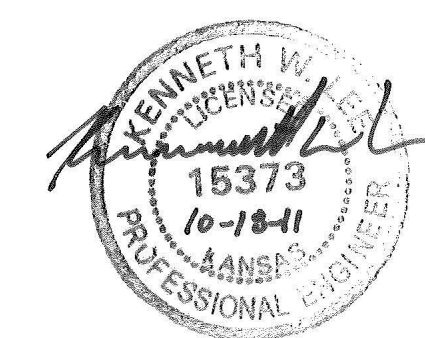

CITY OF WICHITA, KANSAS
JAMES L. ARMOUR, P.E., CITY ENGINEER

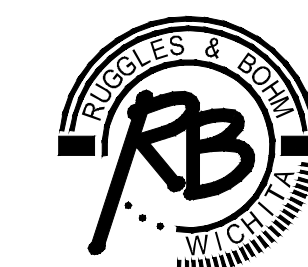

Ruggles & Bohm, P.A.
Engineering, Surveying, Land Planning

924 North Main
Wichita, Kansas 67203
www.rbkansas.com

(316) 264-8008
(316) 264-4621 fax
E-mail: info@rbkansas.com