

Benchmarks

Benchmark-1
Chiseled "X" cut on rim of curb
inlet, 23' Northwest of NE corner
of Proposed Building.
Elev. = 1313.66 (NAVD 88)

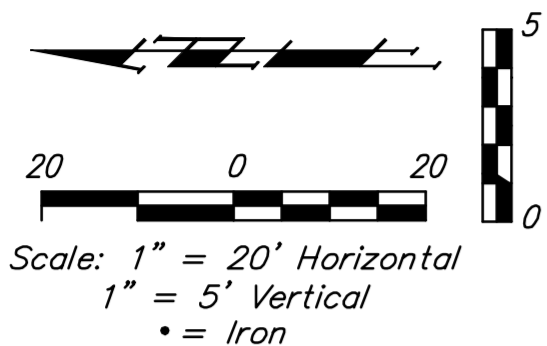

Sta 78.64 Water Line 1,
B.L. Sta. 10+54.15, 50.18' Rt.
City Maintenance Ends.

Caution!
Ex. 15" SS Crossing

Saw cut & remove existing pavement
as necessary for construction.
Pavement to be replaced by City's
Contractor. Call Linda Firsching @
268-4418 for unit prices. Cost to be
subsidiary to "Site Clearing & Restoration."

W.L. Sta. 0+00, Begin Line 1
B.L. Sta. 10+54.15, 28.47' Lt.
Tap Existing 12" Water Main
• 1-12" x 8" Tapping Sleeve
Install 1 - CIMJ 90 Bend (Dn) 1-8" Tapping Valve
Install 1 - CIMJ 90 Bend (Up) 1-8" Valve Box
Valve Box Elev. = 1315.6
To Be Furnished & Installed by City of Wichita
Water Dept. Contractor to Verify Depth &
Location of Existing 12" Water Line Prior
to Construction. (Contractor to Reimburse
Water Dept. \$1830.00 for Tapping Sleeve,
Valve & Installation.)

Install 55lf of 8" Rj Water
Line Pipe by Directional Drill.

Caution!
Ex. UGT
AT&T Crossing

Caution!
Ex. 10"x7" SWS
RCB Crossing

W.L. Sta 1+40.00, Line 1,
B.L. Sta. 10+54.15, 111.54' Rt.
1-Fire Hydrant Assembly (L = 5')
1 - 8" CIMJ Cap (S)
Bury Line Elev. = 1315.38
Top of Valve Box = 1315.10

Profile View of Line 1

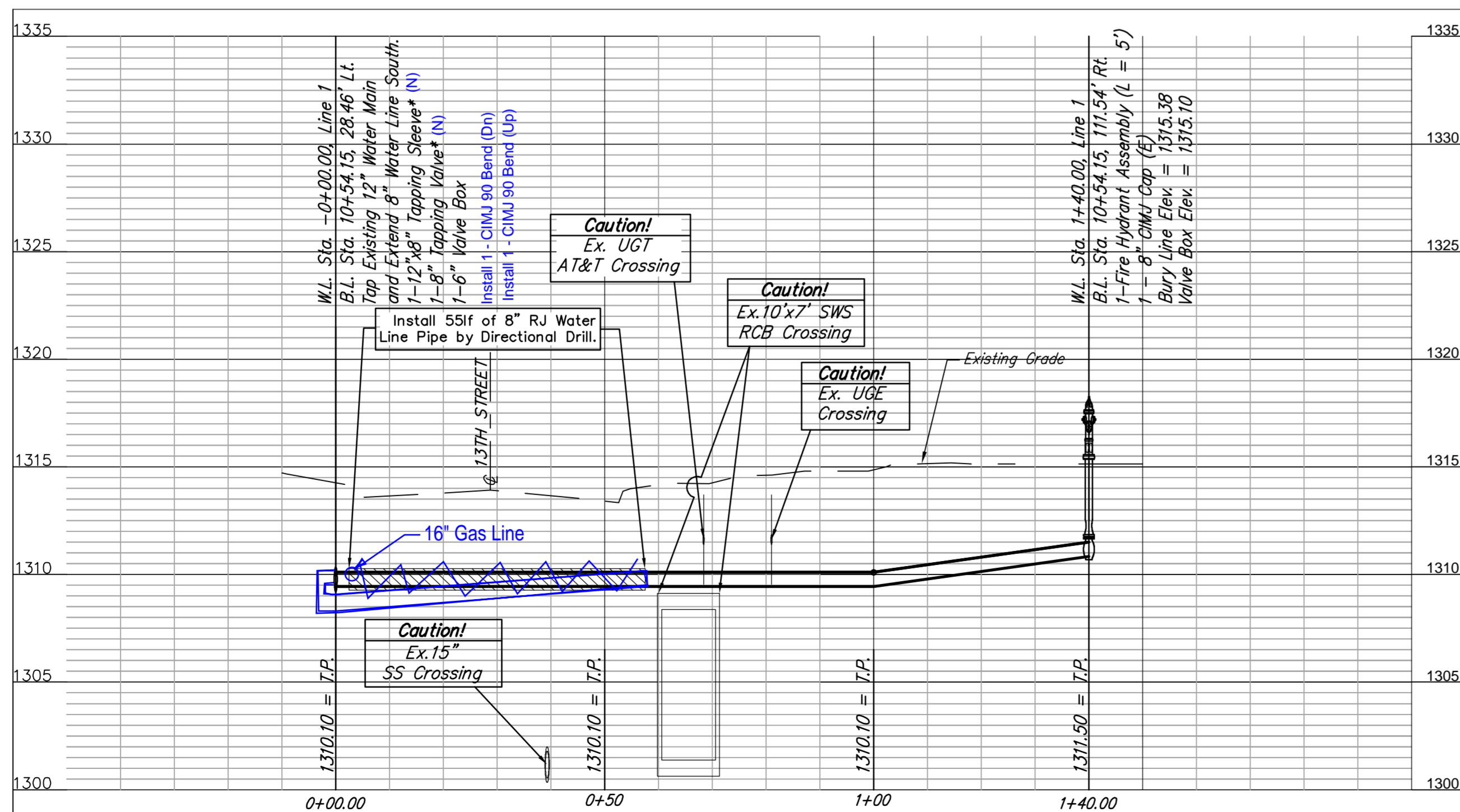

W.L. Sta. 0+00.00, Line 1
B.L. Sta. 10+54.15, 28.46' Lt.
Tap Existing 12" Water Main
and Extend 8" Water Line South
1-12"x8" Tapping Sleeve (N)
1-8" Tapping Valve (N)
1-8" Valve Box
Install 1 - CIMJ 90 Bend (Dn)
Install 1 - CIMJ 90 Bend (Up)
W.L. Sta. 1+40.00, Line 1
B.L. Sta. 10+54.15, 111.54' Rt.
1-Fire Hydrant Assembly (L = 5')
1 - 8" CIMJ Cap (S)
Bury Line Elev. = 1315.38
Valve Box Elev. = 1315.10

Caution!
Ex. UGT
AT&T Crossing

Caution!
Ex. 10"x7" SWS
RCB Crossing

Caution!
Ex. UGE
Crossing

Caution!
Ex. 15" SS Crossing

Existing FH COW #4,526 to be
removed after Water Valve #14,310
is closed on capped.

6" Water Line to be
Removed and/or Abandoned.



Baughman Company, P.A.
Professional Engineer
Travis Shawn Baughman
License # 16976
State of Kansas
4/9/12

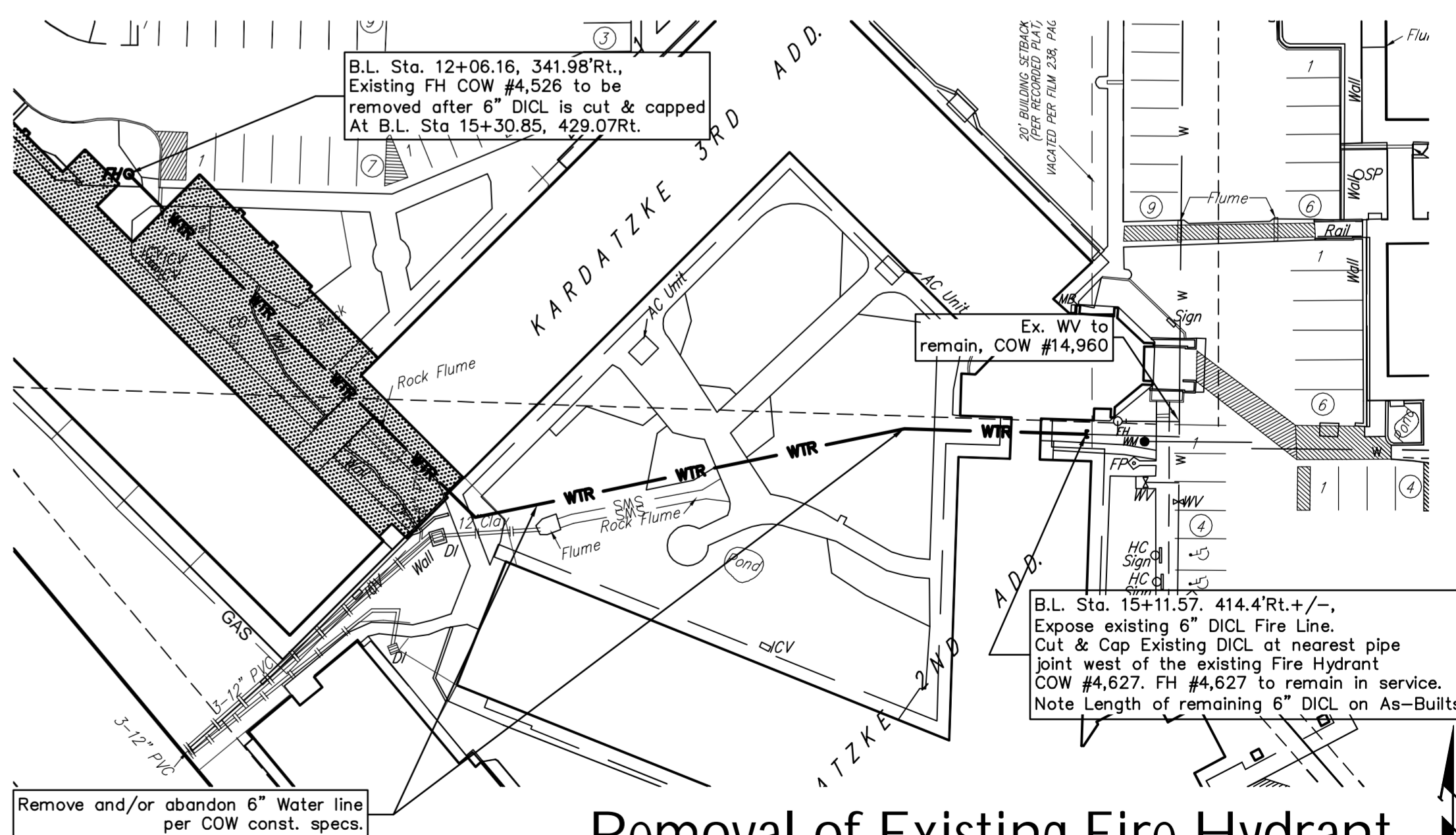

B.L. Sta. 12+06.16, 341.98' Rt.
Existing FH COW #4,526 to be
removed after 6" DI CL is cut & capped
At B.L. Sta 15+30.85, 429.07' Rt.

B.L. Sta. 15+11.57, 414.4' Rt. +/-,
Expose existing 6" DI CL Fire Line.
Cut & Cap Existing DI CL at nearest pipe
joint west of the existing Fire Hydrant
COW #4,627. FH #4,627 to remain in service.
Note Length of remaining 6" DI CL as-Built.

Remove and/or abandon 6" Water line
per COW const. specs.

Removal of Existing Fire Hydrant

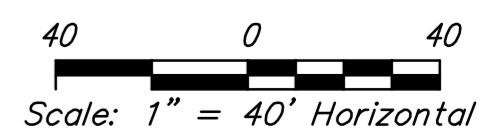

KARDATZKE THIRD ADDITION
LINE 1
1658PPW (607853) Water Distribution System