

STORM WATER SEWER NO. 663

84819

TO SERVE
GLENVIEW

OCA NO. 751509

CITY OF WICHITA PROJECT NO. 468-84819

CITY OF WICHITA, KANSAS

GARY JANZEN, P.E. - INTERIM CITY ENGINEER

DEVELOPER CONTACT

MR. DAVID HAMBRICK
SLAWSON COMPANIES
727 N. WACO, SUITE 400
WICHITA, KANSAS 67203
(316) 263-3201

INDEX OF SHEETS

1. TITLE SHEET
2. KEY MAP AND GENERAL NOTES
3. PLAT
4. PLAT COORDINATE POINTS
5. FOUR CORNER LOT GRADING PLAN
6. PLAN/PROFILE-SWS LINE NO. 1
7. PLAN/PROFILE-SWS LINE NO. 2
8. PLAN/PROFILE-SWS LINE NO. 3
9. STD. TYPE 1A CURB INLET
10. CURB INLET PAVEMENT UNDERDRAIN DETAIL
11. SINGLE/DOUBLE DROP INLET
12. PRECAST CONCRETE MANHOLE (STORM SEWER)
13. MANHOLE/INLET FRAME AND COVER (STORM SEWER)
14. MISCELLANEOUS DETAILS
15. HEADWALL DETAILS FOR 15, 18" AND 24" PIPE
16. EROSION CONTROL PLAN
- 17-20. EROSION CONTROL DETAILS

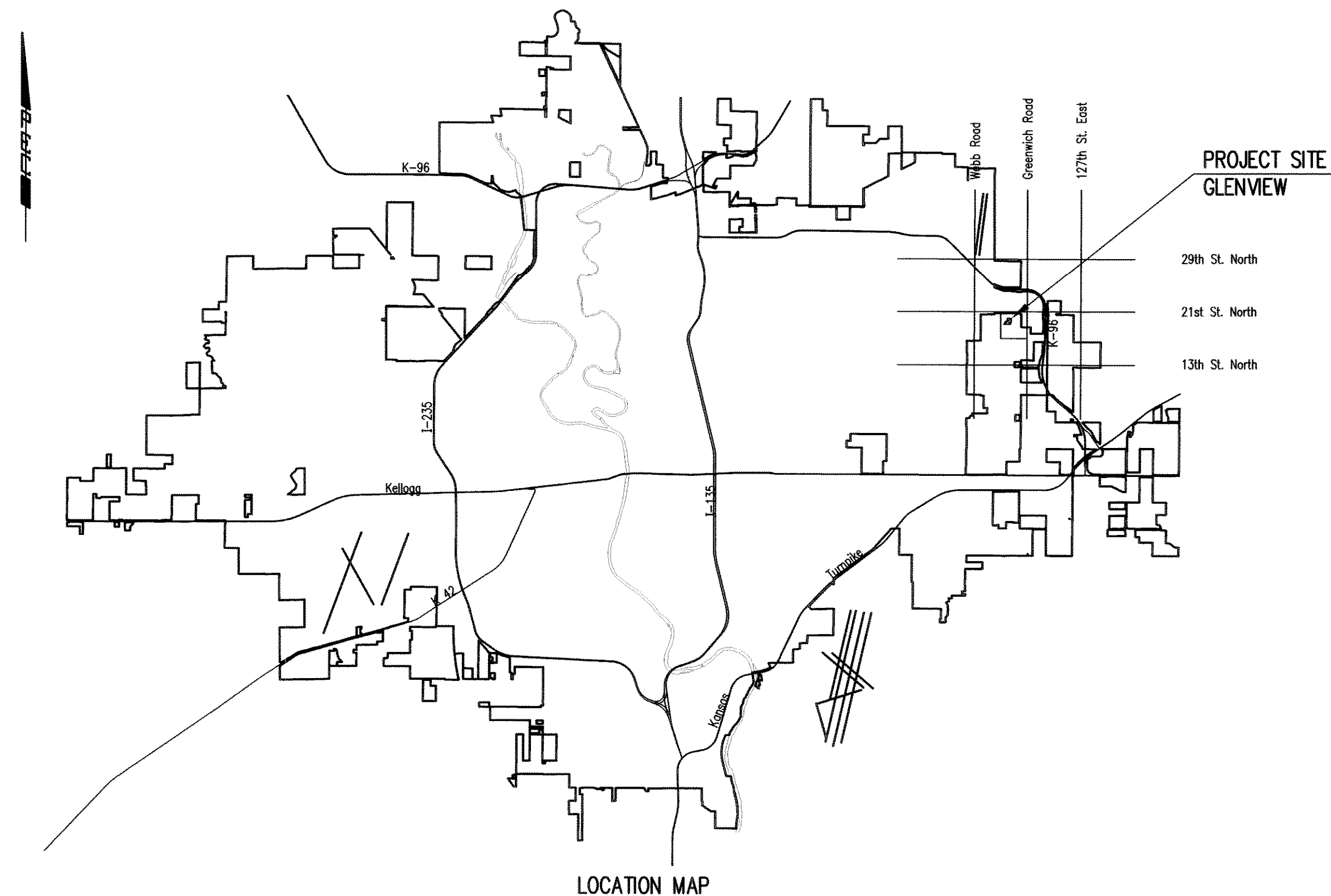

CONSTRUCTION SCHEDULE/COORDINATION

THE CONTRACTOR(S) FOR THE FOLLOWING PROJECTS SHALL COORDINATE THEIR EFFORTS SUCH THAT ANY NECESSARY SIMULTANEOUS CONSTRUCTION (INCLUDING PRIVATE PAVING IMPROVEMENTS) CAN PROCEED CONCURRENTLY WITHOUT CAUSING UNDUE DELAYS SO THAT CONSTRUCTION CAN BE COMPLETED WITHIN THE TIME FRAME AS NOTED. THE CONTRACTOR(S) SHALL COMPLETE THE FOLLOWING PUBLIC IMPROVEMENTS PROJECTS BY SEPTEMBER 10, 2012 UNLESS OTHERWISE INDICATED IN THE PROJECT SPECIAL PROVISIONS.

468-84818 LATERAL 13, MAIN 16 of the FOUR MILE CREEK SEWER
448-90552 WATER DISTRIBUTION SYSTEM
468-84819 STORM WATER DRAIN #663

JUNE 2012

PLANS PREPARED BY
PROFESSIONAL ENGINEERING CONSULTANTS, P.A.
ENGINEERS
WICHITA, KANSAS

