

PLAN	CHECKED	BY	DATE
	CHECKED		

PROFILE	CHECKED	BY	DATE
	CHECKED		

Sowed 06-04-2012 7:24:03 AM by BUS
 Plot Scale 1:20 06-04-2012 5:30:37 PM by BUS
 C:\2011\1339\004\11339-004-06C-PLAN AND PROFILE-SWS LINE NO 1

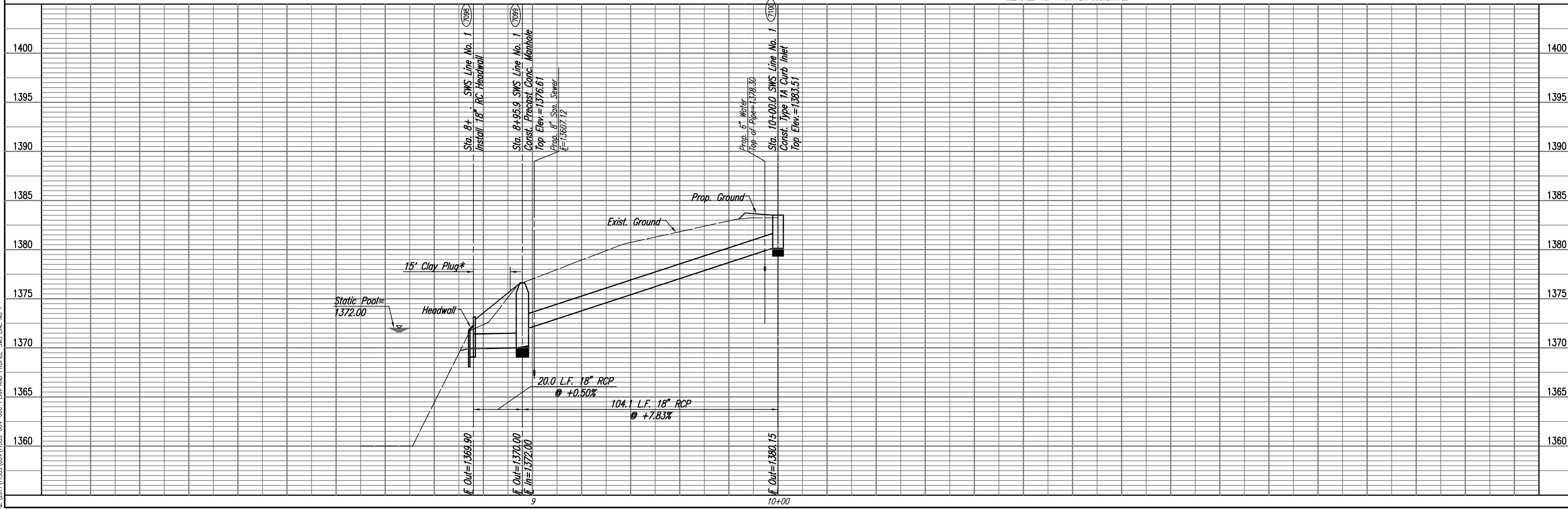

Sta. 8+75.9 SWS Line No. 1
 Begin 18" RCP Construction
 Const. 18" Reinf. Conc. Headwall
 Install 20.0 L.F. 18" RCP (W)
 First 2 Sections of RCP Pipe
 Shall have Restraining Joints.
 See Sheet Nos. 14 & 15.

Sta. 8+95.9 SWS Line No. 1
 Const. Precast Concrete Manhole
 Dia.=4'-0"
 Top Elev.=1376.61
 Install 104.1 L.F. 18" RCP (W)
 See Sheet No. 12.

Sta. 10+00.0 SWS Line No. 1=
 @ Glegate Cir. Sta. 17+73.56, 5.67' Rt.
 Const. Std. Type 1A Curb Inlet
 L=5'-0", W=3'-0"
 Top Elev.=1383.51
 See Sheet No. 9.

POINT	NORTH	EAST
7098	386,421.4297	2,372,506.0620
7099	386,424.3444	2,372,486.2756
7100	386,439.5203	2,372,383.2544
7101	386,439.5676	2,372,381.7551

7098 = COORDINATE POINT NO.
 SEE SHEET NO. 4 FOR PLAT COORDINATES

OAK CREEK 3RD

Install 87 S.Y.
 Erosion Control Mat

CAUTION !!!
 Proposed 8" San. Sewer
 City of Wichita

CAUTION !!!
 Proposed 6" Water
 City of Wichita

CAUTION !!!
 Irrigation Valve
 (Private)

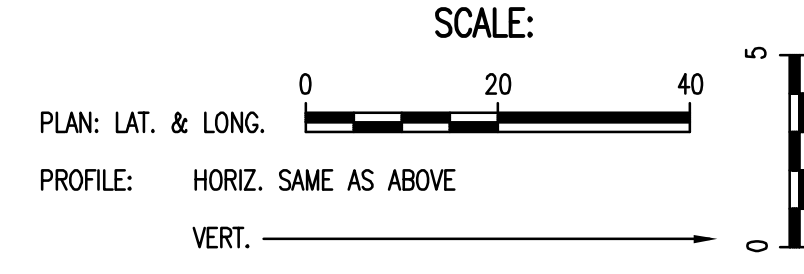

Note A: Construct Suitable Cofferdam as Necessary to Construct Storm Sewer. Cofferdam may be of Compacted Earth Material or Sheet Piles. Upon Completion of Drainage Improvements, Remove Cofferdam and Restore Pond Banks to Pre-Construction Condition. This work shall be Subsidiary to "18" RCP".

1. Construct 12 inches of clay liner.
2. High plasticity clay (PI>25) shall be used.
3. Construct liner in two 6-inch lifts.
4. Compact to 95% of Standard Proctor Density (ASTM D-698).
5. Control moisture within minus 3% to plus 3% of optimum moisture content.

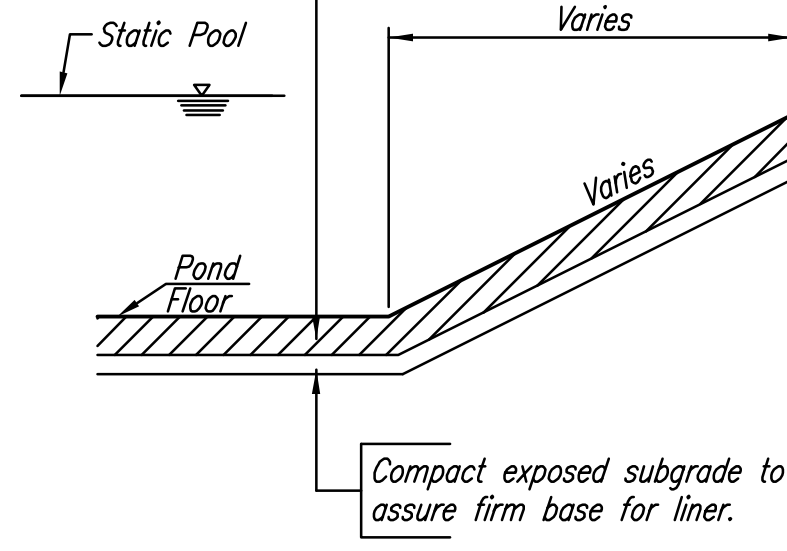

CLAY LINER CONSTRUCTION PROCEDURE FOR POND SEALING

LEGEND

EROSION CONTROL MAT

EROSION CONTROL MAT SHALL BE LANDLOK TRM 450, NORTH AMERICAN GREEN C350 OR EQUIVALENT. INSTALLED PER MANUFACTURER'S RECOMMENDATIONS.

PAID FOR AS S.Y. "EROSION CONTROL MAT" AS INDICATED IN PLANS. THE BID PRICE SHALL BE CONSIDERED FULL COMPENSATION FOR ALL MATERIALS, LABOR, EQUIPMENT, TOOLS, AND INCIDENTALS NECESSARY TO COMPLETE THE WORK.

* THE TRENCH ZONE INDICATED SHALL BE BACKFILLED ENTIRELY WITH CLAY MATERIAL MEETING THE SAME REQUIREMENTS AS POND LINING. NO GRANULAR BACKFILL WILL BE ALLOWED IN THIS AREA, EXCEPT THAT THE TOP 4" OF BACKFILL SHALL BE ON-SITE TOPSOIL. ANY COSTS ASSOCIATED WITH THIS WORK SHALL BE SUBSIDIARY TO THE PRICE BID FOR 18" RCP.

GLENVIEW
 STORM WATER SEWER NO. 663

SWS LINE NO. 1

GARY JANZEN, P.E. - INTERIM CITY ENGINEER
 CITY OF WICHITA PROJECT NO. 468-84819

PROFESSIONAL ENGINEERING CONSULTANTS, P.A.
 303 SOUTH TOPEKA WICHITA, KS 67202
 316-262-2681 www.pec.com

Designed By BMM, JAG
 Drawn By BUS
 Job No. 35-11339-004
 Date March 2012