

PLAN	CHECKED	BY	DATE
	CHECKED		

PROFILE	CHECKED	BY	DATE
	CHECKED		

Saved: 06-04-2012 7:49:44 AM by BUS
 Plot Scale: 1:20 06-04-2012 5:31:39 PM by BUS
 G:\2011\1339\004\11339-004-07C-PLAN AND PROFILE-SWS LINE NO 2

INLET CONNECTION:
 PRIOR TO CONSTRUCTION CONTRACTOR SHALL VERIFY HORIZONTAL AND VERTICAL LOCATION AND SIZE OF EXISTING SWS STRUCTURE AND CONNECTIONS AND REPORT THESE FINDINGS TO THE ENGINEER SO THAT ANY NECESSARY ADJUSTMENTS CAN BE MADE. INSTALL NEW PIPE, CUT FLUSH WITH INSIDE WALL OF INLET, AND GROUT IN PLACE WITH NON-SHRINK GROUT. THIS WORK SHALL BE SUBSIDIARY TO "15" RCP".

Area to be Graded at Lump Sum Cost for "Easement Grading".

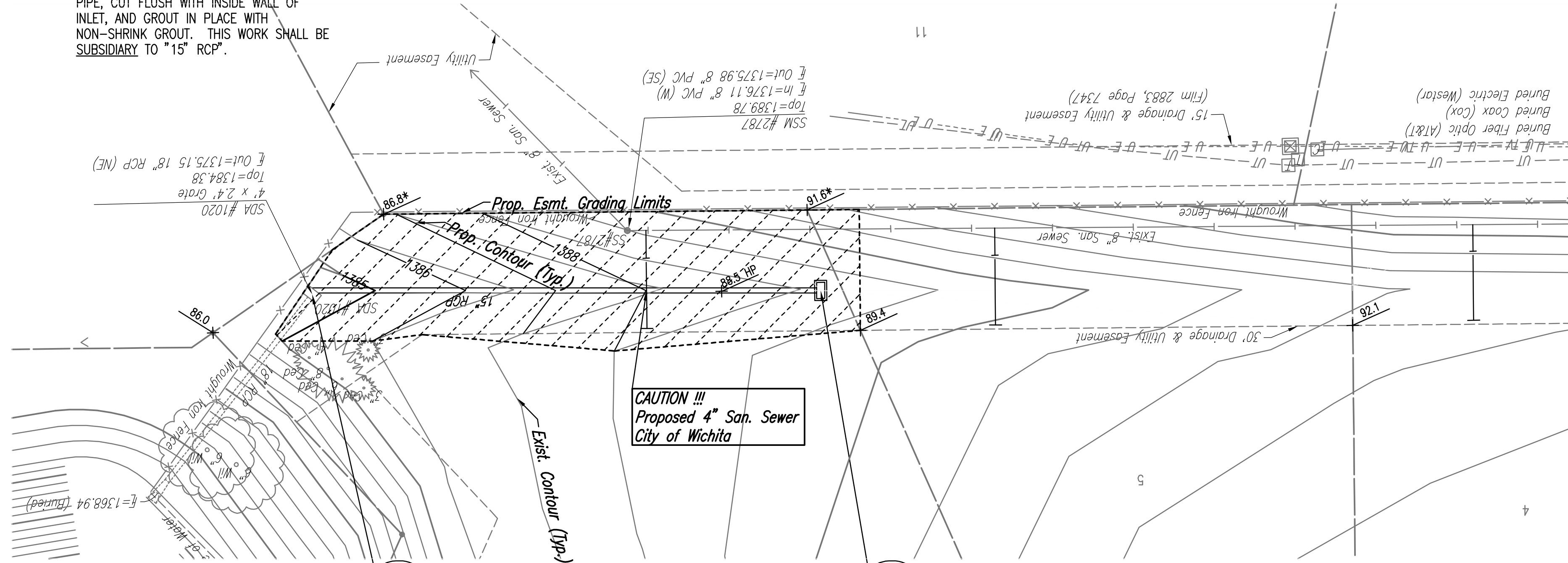

Sta. 18+73.9 SWS Line No. 2
 Exist. Area Inlet
 Exist. Top Elev.=1384.38
 Install 126.1 L.F. 15" RCP (W)
 See Inlet Connection Note,
 This Sheet.

Sta. 20+00.0 SWS Line No. 2
 Const. Double Drop Inlet
 L=4'-0", W=2'-0"
 Top Elev.=1388.1
 See Sheet No. 11.

COORDINATE LIST		
POINT	NORTH	EAST
7199	386,016.6440	2,372,436.7431
7200	386,018.7689	2,372,310.6641

7199 = COORDINATE POINT NO.
 SEE SHEET NO. 4 FOR PLAT COORDINATES

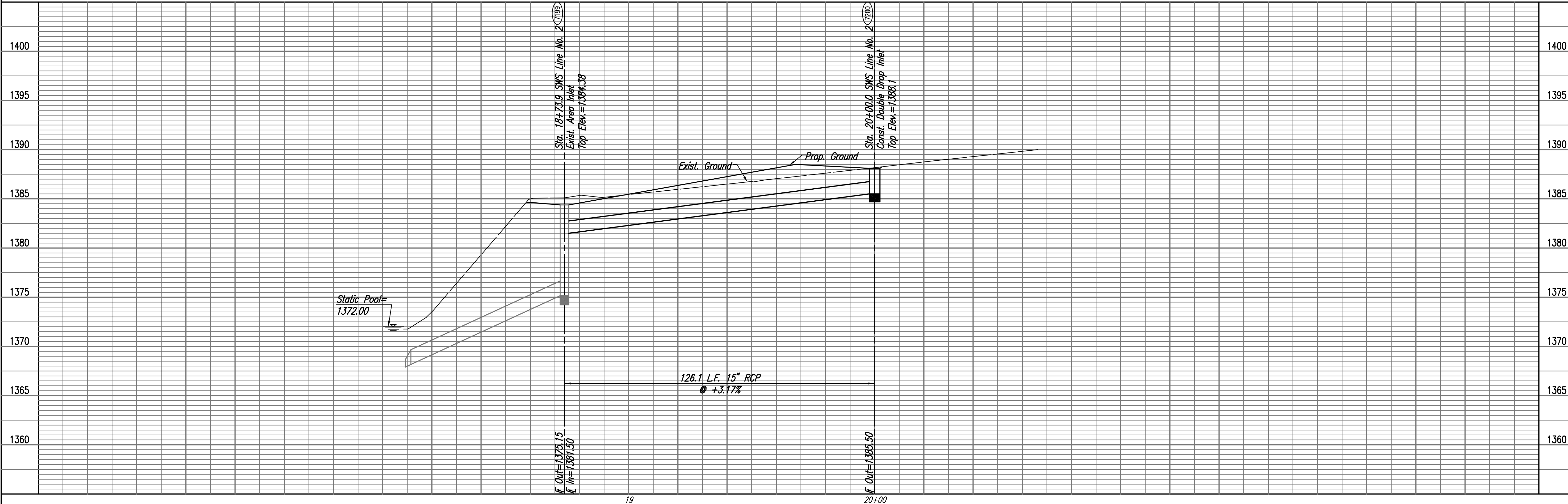
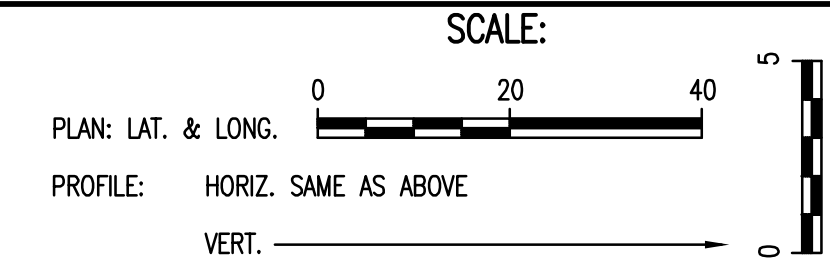

GLENVIEW
 STORM WATER SEWER NO. 663

SWS LINE NO. 2

PROFESSIONAL ENGINEERING CONSULTANTS P.A.
 303 SOUTH TOPEKA WICHITA, KS 67202
 316-262-2691 www.pec1.com

Designed By: BMM, JAG
 Drawn By: BUS

Job No. 35-11339-004
 Date March 2012

GARY JANZEN, P.E. - INTERIM CITY ENGINEER
 CITY OF WICHITA PROJECT NO. 468-84819

Sheet 7 of 20