

Sierra Hills 2nd Addition

Sierra Hills 2nd Addition

N 17974.36, E 18943.98
 STA. 5+72.00 SWS LINE 7
 CONSTRUCT STANDARD TYPE P MH
 WITH BEEHIVE INLET TOP
 DIAMETER = 5.0'
 TOP ELEV. 1312.33

N 18107.51, E 19094.73
 STA. 7+73.13 SWS LINE 7
 CONSTRUCT STANDARD TYPE P MH
 WITH BEEHIVE INLET TOP
 DIAMETER = 5.0'
 TOP ELEV. 1310.36

N 18107.51, E 19094.73
 STA. 7+73.13 SWS LINE 7
 CONSTRUCT STANDARD TYPE P MH
 WITH BEEHIVE INLET TOP
 DIAMETER = 5.0'
 TOP ELEV. 1310.36

N 18309.37, E 19095.78
 STA. 9+75.00 SWS LINE 7
 CONSTRUCT STANDARD TYPE P MH
 WITH BEEHIVE INLET TOP
 DIAMETER = 5.0'
 TOP ELEV. 1311.68

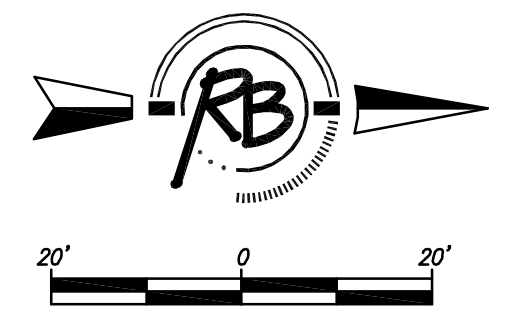
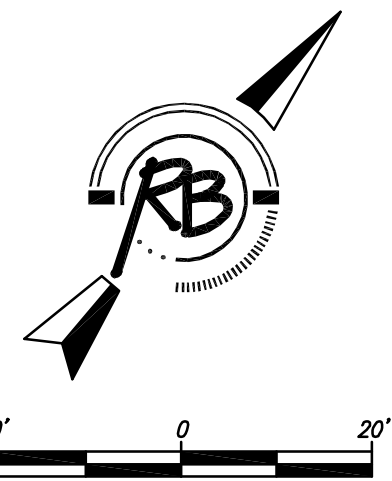

Unplatted

Unplatted

This Sheet is not Included with this Contract

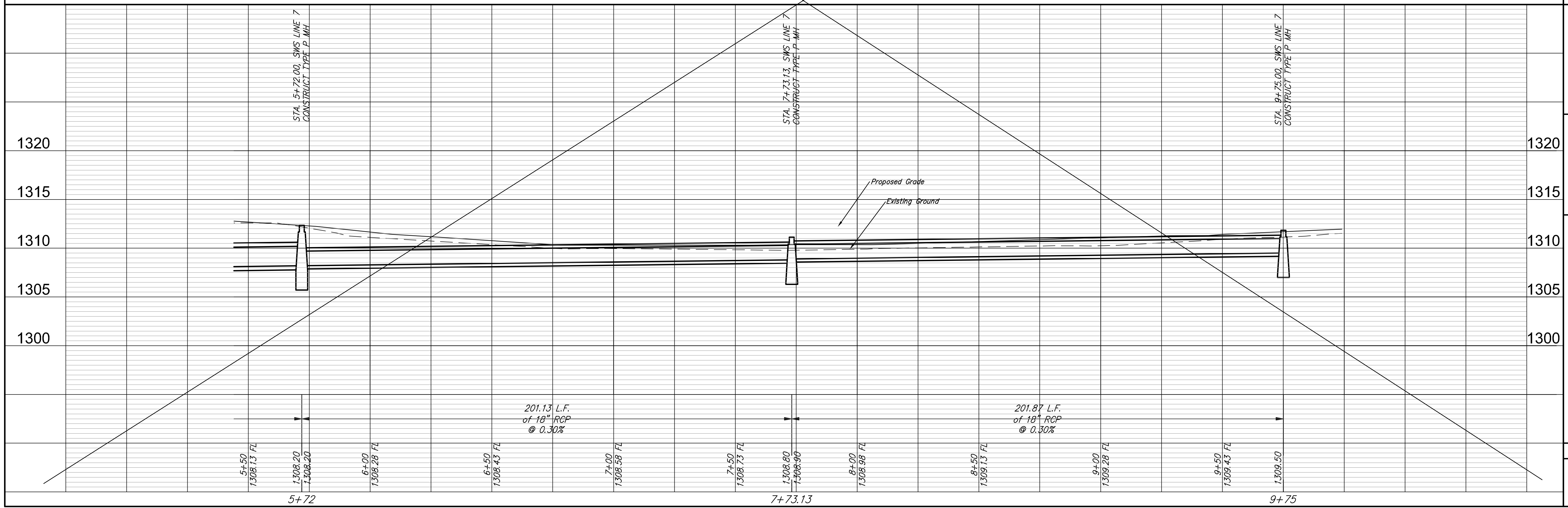

REVISIONS

REVISED	DATE	BY

PROJECT NUMBER: 462-94615
 DRAWING FILE: Engineering Bases [SWS Line 3]
 DESIGN: EUG
 CHECK: EUG
 DATE: June 7, 2012
 REVIEW: EUG
 DATE: May 9, 2012

SIERRA HILLS 2ND ADDITION
 SWS Line 7 (2)
 WICHITA, KANSAS

RB JOB: 3268E
 SHEET: 19 OF 43

Ruggles & Bohm, P.A.
 Engineering, Surveying, Land Planning
 604 North Main
 Wichita, Kansas 67203
 www.rugglesandbohm.com
 (316) 264-4501 fax
 Email: rb@rugglesandbohm.com