

W/4 Section Corner 12-T27S-1E
 Fnd. 3/4" IP in Thimble
 46.55' NE to the NW corner of signal manhole vault
 59.30' ESE to ctr. Top FH
 55.80' SW to hilti nail and washer in signal manhole vault
 On centerline of 17th. Street to west

W/4 Section Corner 13-T27S-1E
 Fnd. 3/4" IP in Thimble
 45.73' NE to + cut in center of C of W BM disk
 46.91' SE to mag nail in PP40.
 74' SW to ctr. Top FH
 On centerline crossroads

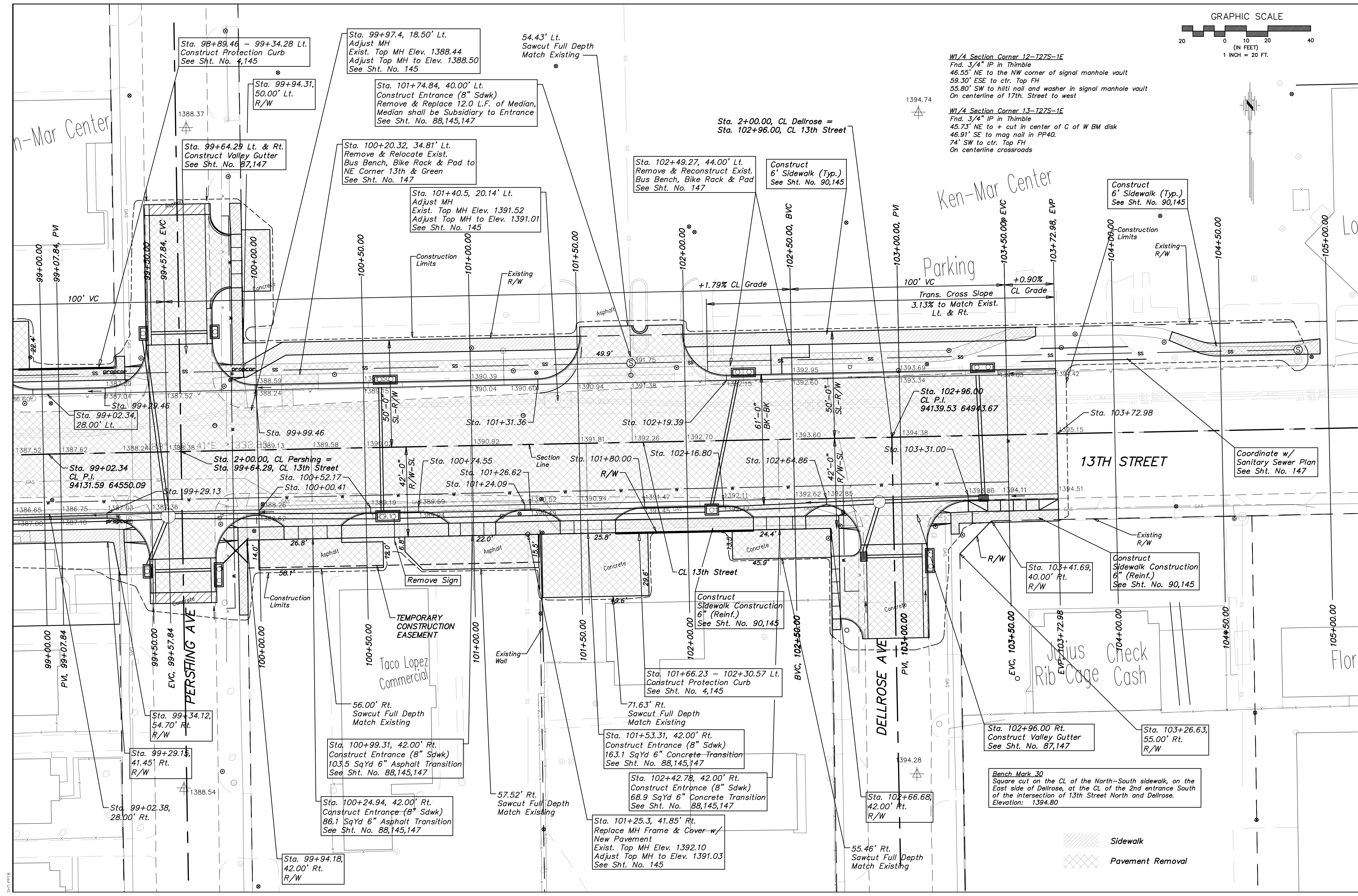

13th STREET NORTH FROM HYDRAULIC TO OLIVER
 STREET & DRAINAGE IMPROVEMENTS
 13th Street Sta. 99+00.00 to Sta. 105+00.00
CITY OF WICHITA, KANSAS
 JAMES L. ARMOUR, P.E. - CITY ENGINEER

POE & ASSOCIATES, INC.
 CONSULTING ENGINEERS
 5940 E. Central, Suite 200 • Wichita, KS 67208-4242
 Phone: 316/685-4111 • FAX: 316/685-4444

FINAL
 Designed By: PAF / JUU
 Drawn By: JUU
 P.O. Job No.: 1871A
 Date: July 2008
 Sheet 28 of 374