

Parking

Sta. 2+00.00, CL Dellrose  
Sta. 102+96.00, CL 13th Street

13TH STREET

CL 13th Street

Section Line

Construct  
Sidewalk Ramps (2 Loc.)  
See Sht. No. 90,145

$\Delta=90^{\circ}00'00''$   
 $R=19.50'$   
 $L=30.63'$   
 $T=19.50'$

Construct  
6" Reinforced Concrete  
See Sht. No. 3

Sta. 0+50.00,  
35.00' Lt.  
Center Pt.

+0.77% CL Grade

R/W

Existing  
R/W

Julius Che  
Rib Cage Co

DELLROSE AVE

CL Dellrose Ave

Sta. 0+93.82  
END CONSTRUCTION

Sawcut  
Full Depth  
Match Exist.

$\Delta=78^{\circ}34'30''$   
 $R=19.50'$   
 $L=26.74'$   
 $T=15.95'$

Sta. 0+50.00,  
35.00' Rt.  
Center Pt.

Sta. 0+69.66, 25.70' Rt.  
Construct Entrance  
See Sht. No. 88,145

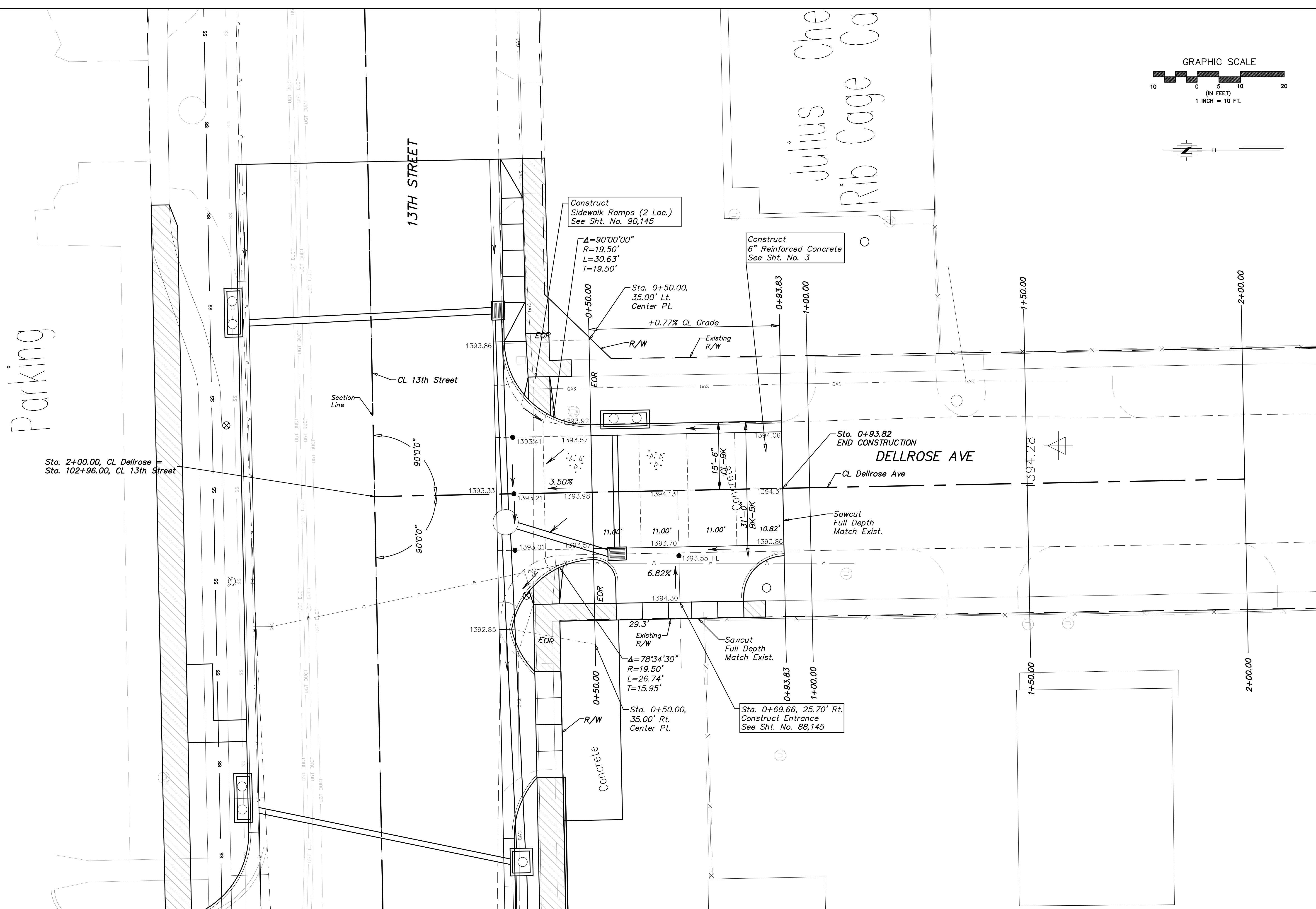
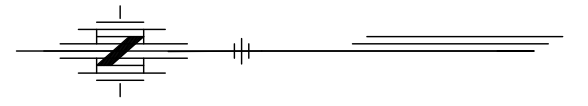
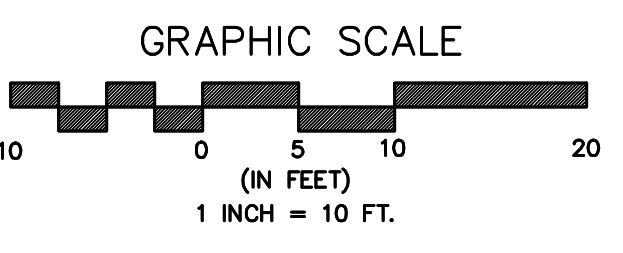

13th STREET NORTH FROM HYDRAULIC TO OLIVER  
STREET & DRAINAGE IMPROVEMENTS

POE & ASSOCIATES, INC.  
CONSULTING ENGINEERS  
5940 E. Central, Suite 200 • Wichita, KS 67208-4242  
Phone 316/685-4111 • FAX 316/685-4444



FINAL

Designed By: PAF / JUU  
Drawn By: JUU  
Poe Job No.: 1871A  
Date: July 2008

Sheet  
59 of 374

Dellrose Avenue  
CITY OF WICHITA, KANSAS  
JAMES L. ARMOUR, P.E. - CITY ENGINEER