

13th Sta. 68+00 to 68+97

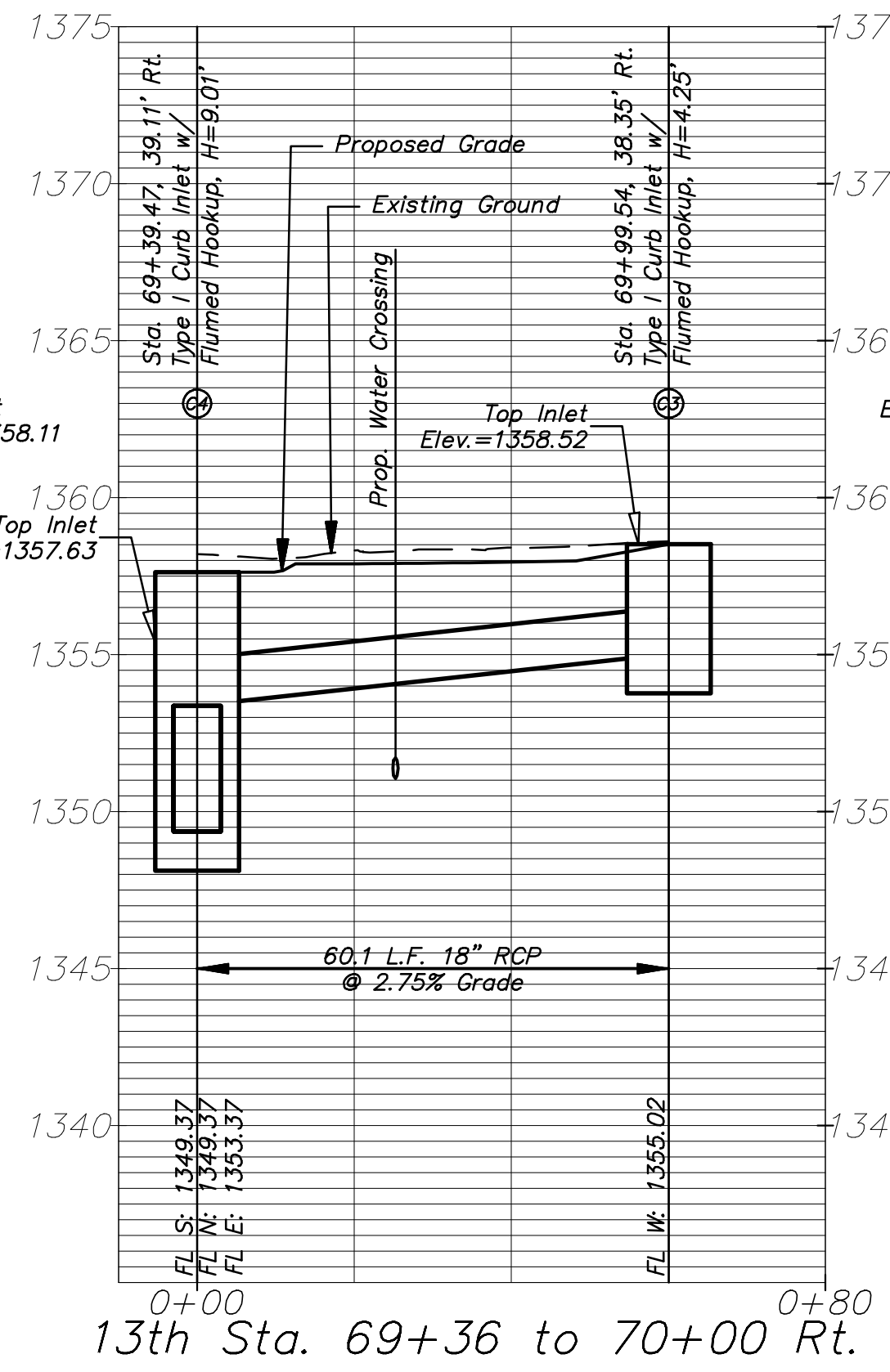

13th Sta. 69+36 to 70+00 Rt.

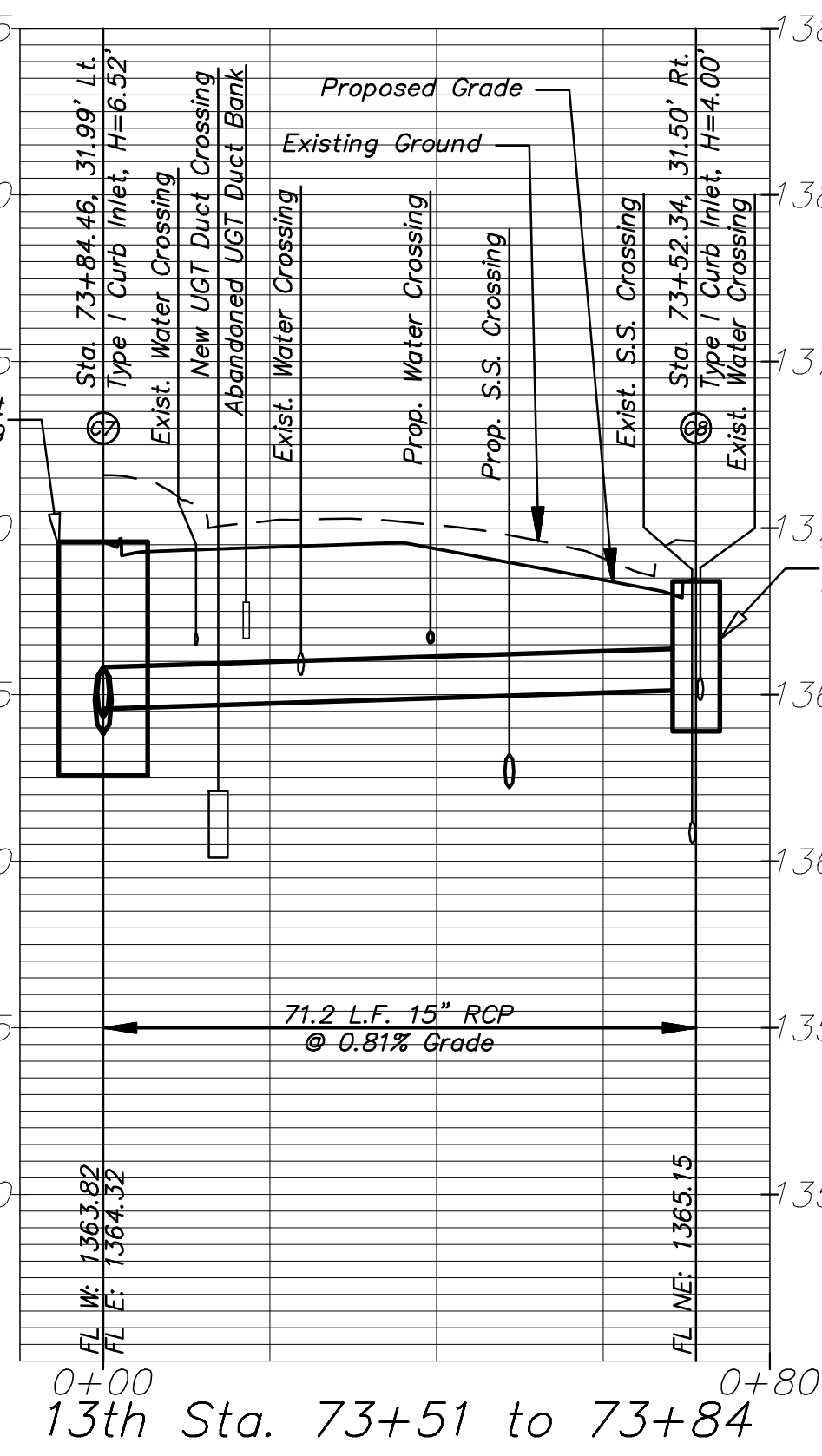

13th Sta. 73+51 to 73+84

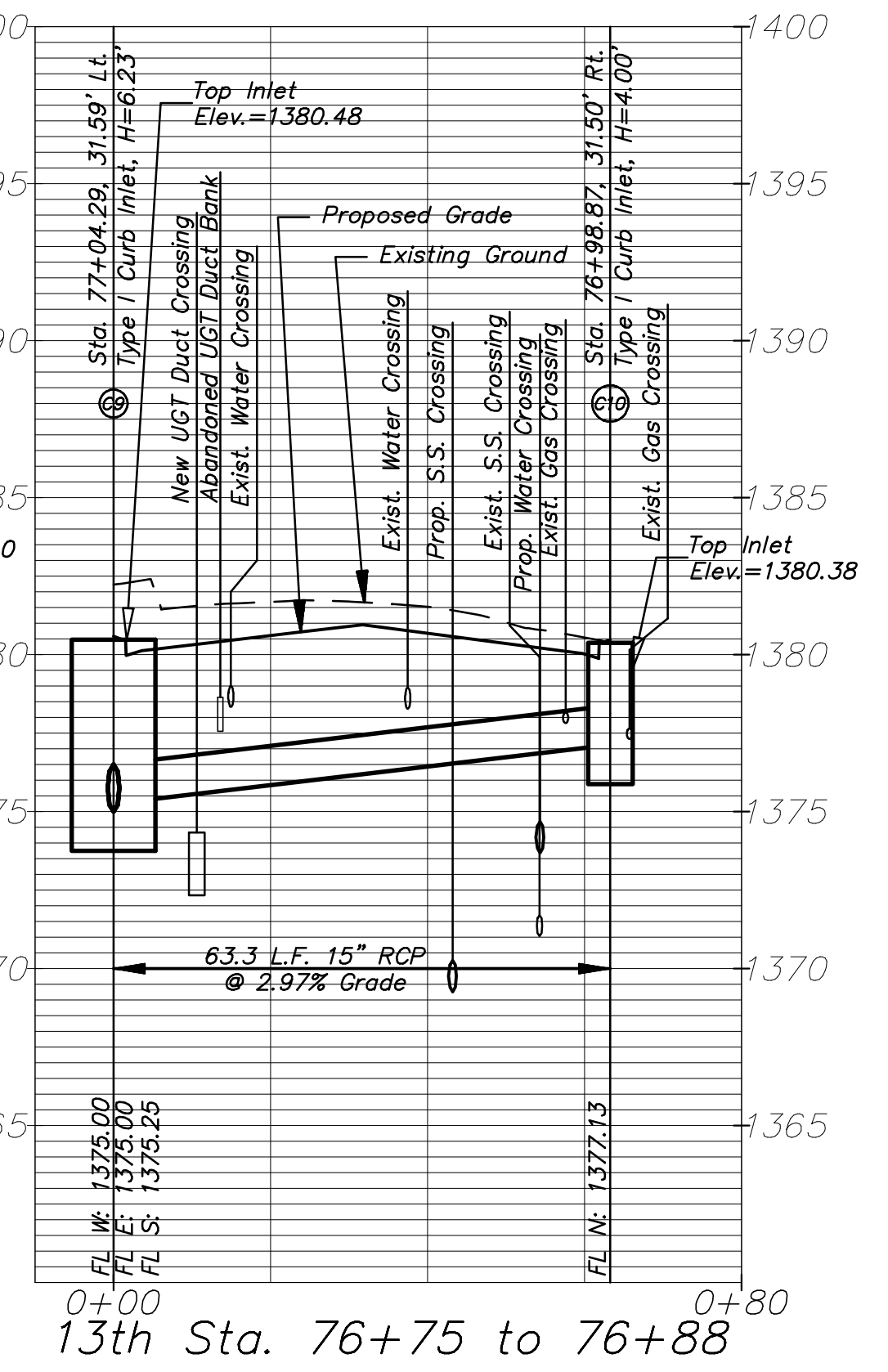

13th Sta. 76+75 to 76+88

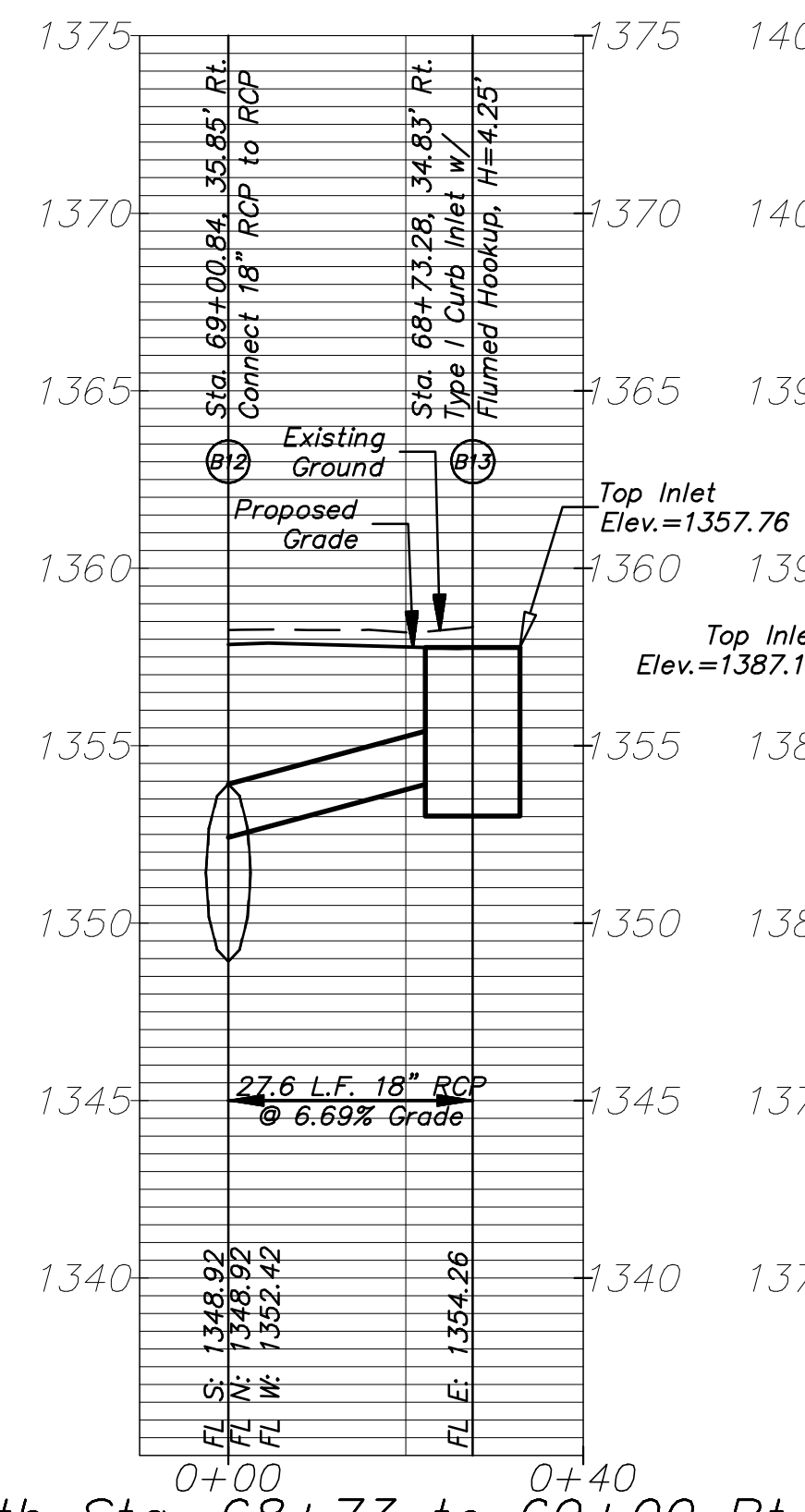

13th Sta. 68+73 to 69+00 Rt.

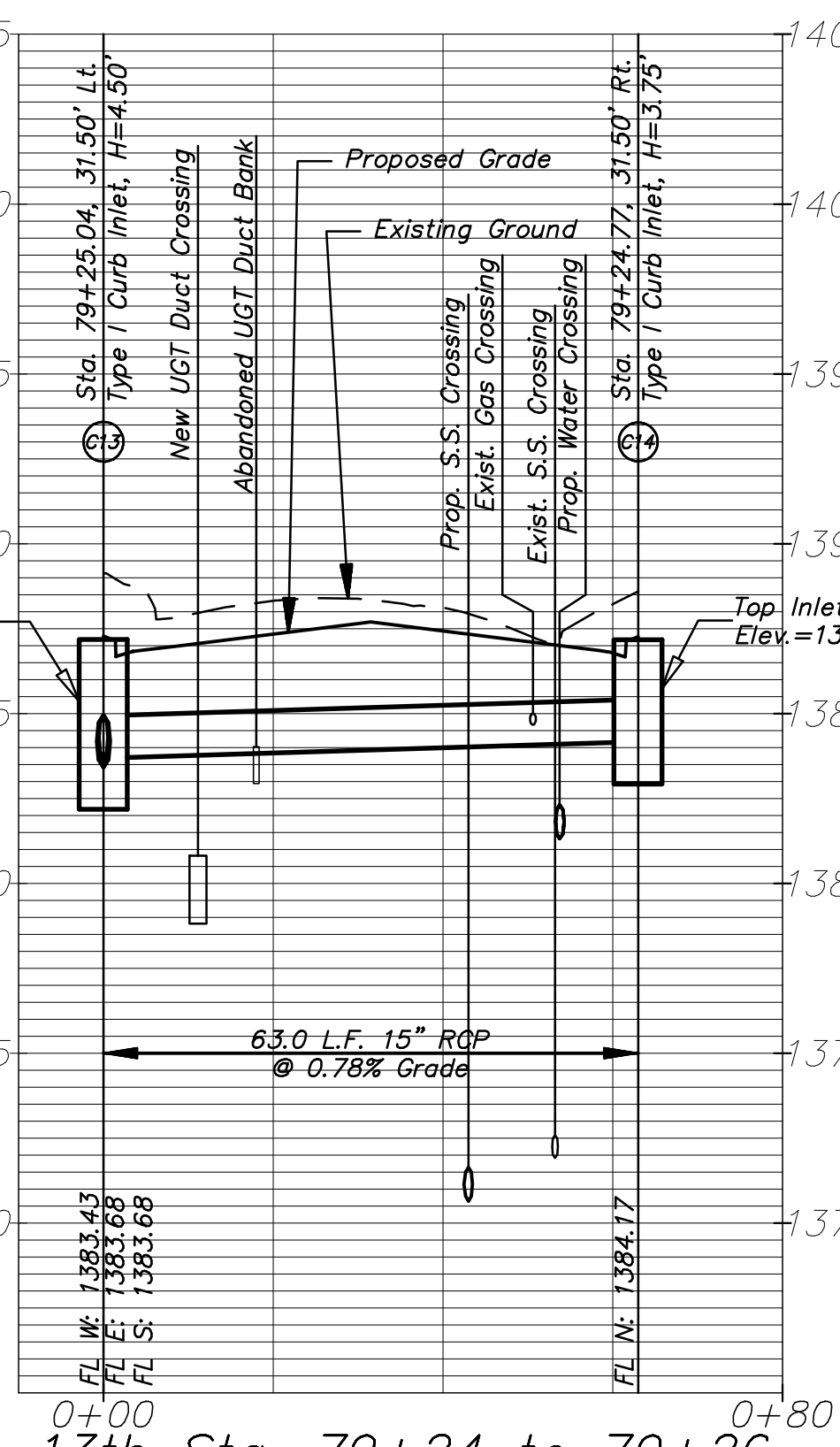

13th Sta. 79+24 to 79+26

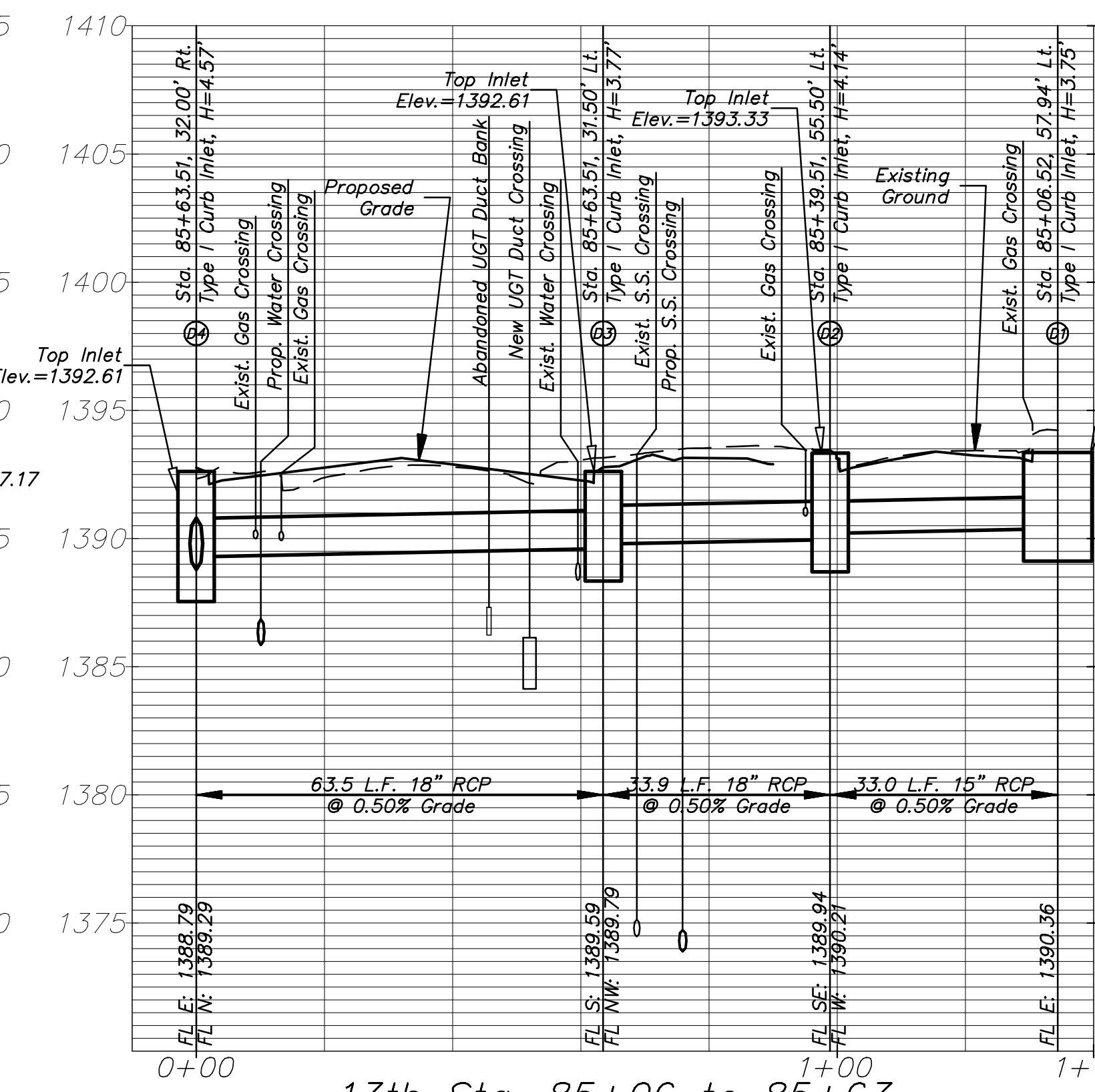

13th Sta. 85+06 to 85+63

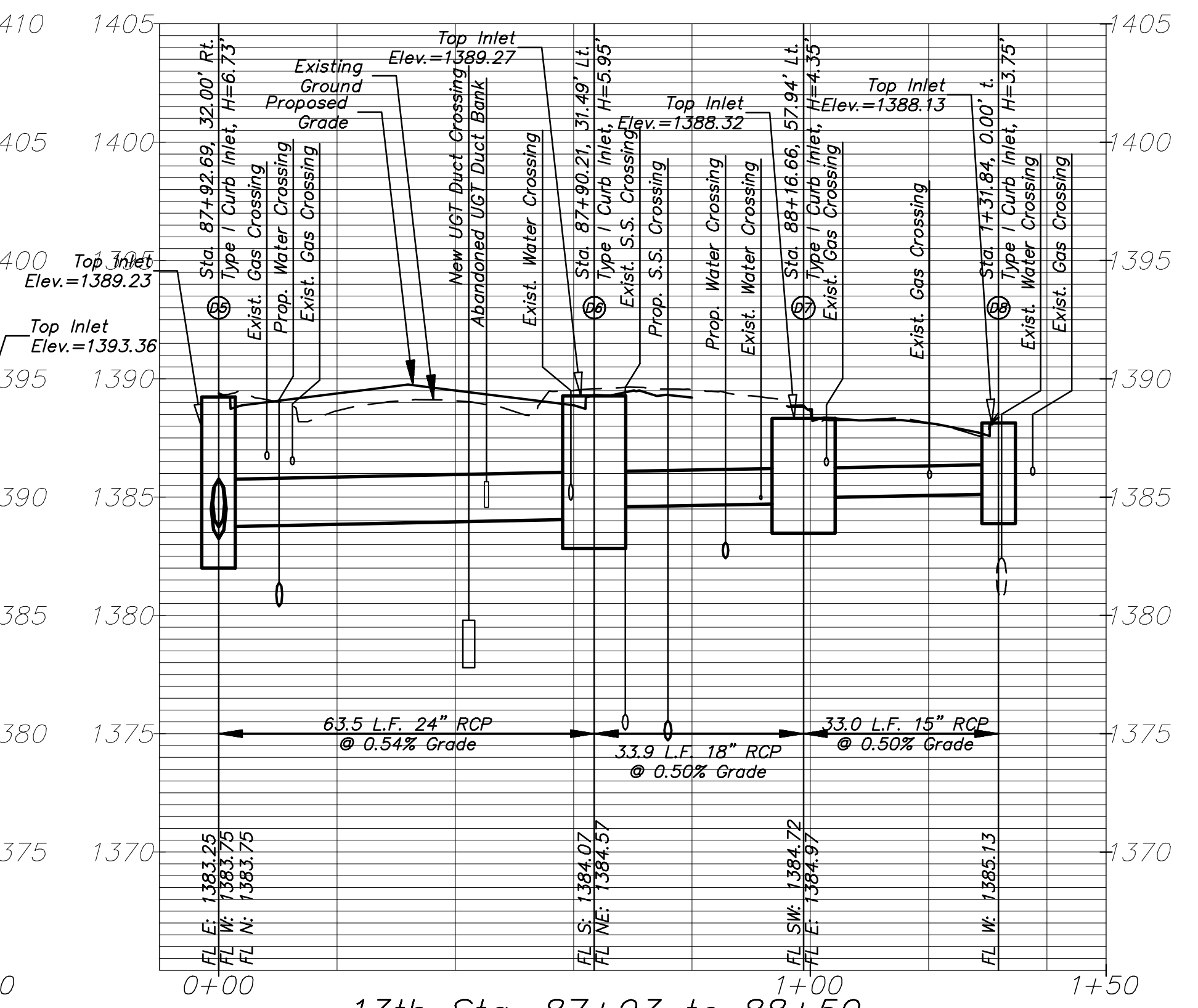

13th Sta. 87+93 to 88+50

FINAL

Designed By: J. DICKMAN
 Drawn By: M. TUCKER
 P.O. Job No.: 1871A
 Date: March 2012

POE & ASSOCIATES, INC.
 CONSULTING ENGINEERS
 5940 E. Central, Suite 200 • Wichita, KS 67208-4242
 Phone 316/685-4111 • FAX 316/685-4444

13TH STREET NORTH FROM HYDRAULIC TO OLIVER
 STREET & DRAINAGE IMPROVEMENTS
 STORM SEWER PLAN & PROFILE
 CITY OF WICHITA, KANSAS
 JAMES L. ARMOUR, P.E., L.S. - CITY ENGINEER
 C.O.W. Proj.# 472-84320 O.C.A.# 708933

No.	Date	By	Approved	Revision

Sheet
130 of 374